

ASSEMBLY INSTRUCTIONS

REFRESH HAND SANITIZER DISPENSER

TABLE TOP

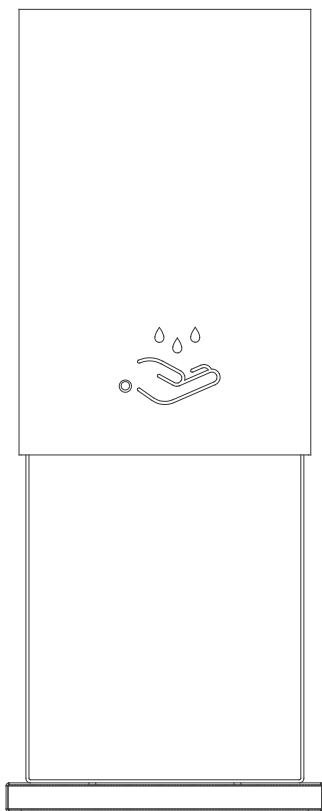

TABLE OF CONTENTS

Instructions

1. Important Safety Information 3

2. Package Contents 4

3. Installation 5

4. Start to use the device 8

5. Cleaning and Maintenance9

6. Troubleshooting 9

7. Warranty Information 10

IMPORTANT SAFETY INFORMATION

READ THIS INFORMATION BEFORE USING YOUR PRODUCT

Before you use your product, it is important that you read and understand the information found in this guide. Please follow the instructions in the order presented in this instruction and observe all notice.

- * This appliance is not intended for use by persons (including children) with reduced physical, sensory or mental capabilities, or lack of experience and knowledge, unless they have been given supervision or instruction concerning use of the appliance by a person responsible for their safety.
- * This product is not a toy. Intended for adult use only.
- * This product is for indoor use only.
- * Do not allow children to play with this product.
- * Ensure to keep the product in an upright position.
- * Cleaning and user maintenance shall not be made by children without supervision.

PACKAGE CONTENTS

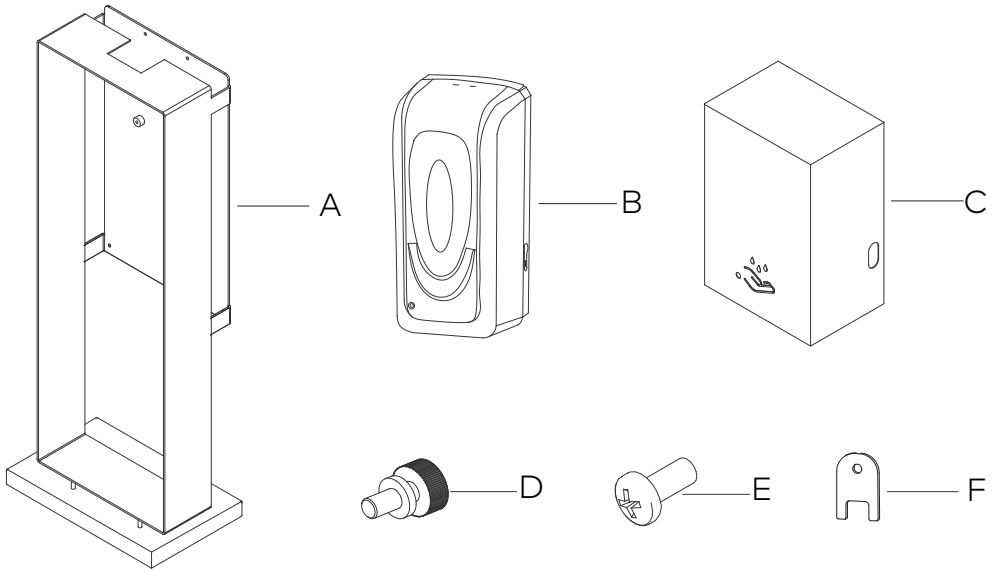

- Part A: Table Frame (1)
- Part B: Hand sanitizer dispenser (1)
- Part C: Metal cover (1)
- Part D: Knurled screws (4)
- Part E: Mounting screws (3)
- Part F: Key (1)

INSTALLATION

Carefully unpack your new product and lay out all the parts on a clear area. Take care not to lose any small parts necessary.

STEP 1

To open the dispenser, use the provided Key (F) to press down at the top of the front shell where the key slots are located. Hold the dispense shell from the top and gently pull the shell down and toward you. The front shell is hinged at the bottom of the dispenser.

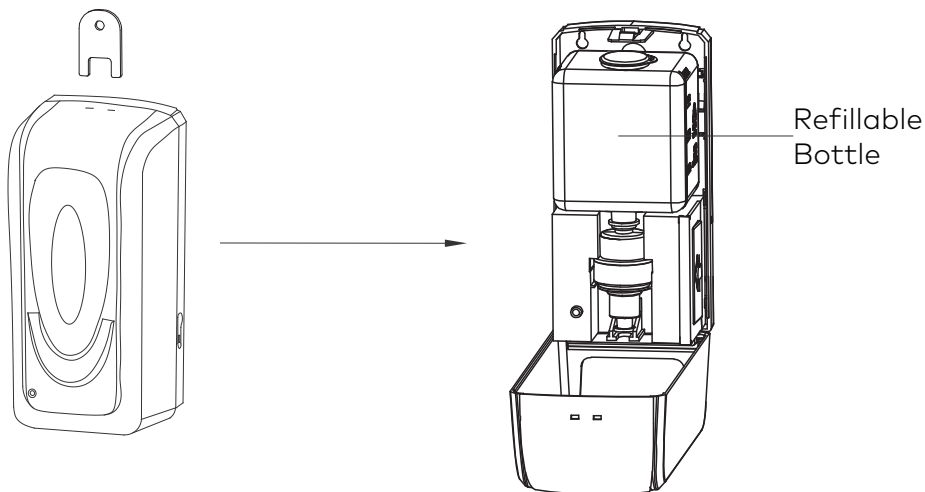

STEP 2

Take out the refillable bottle, align the holes on the dispenser back shell to the holes on the table frame, and secure with the provided mounting screws (E).

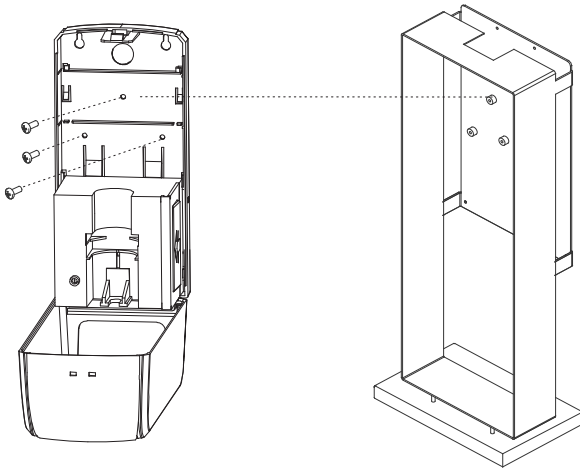

STEP 3

Locate the battery box, slide the battery box cover forward, place four (4) C cell alkaline batteries in the proper orientation and slide in the battery box cover.

Do not mix old and new batteries, and the use of re-chargeable batteries are not recommended.

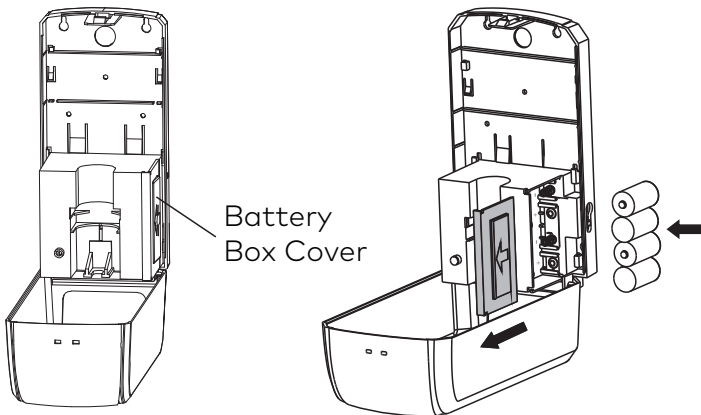

STEP 4

Insert the refillable bottle into the dispenser. Pour the sanitizer into the refillable bottle , and close the dispenser front shell.

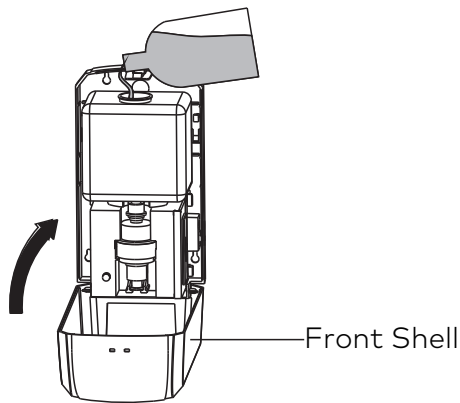

STEP 5

Place the Metal Cover (C) over the dispenser, and align the holes on metal cover to the holes on the back of the Table Frame, and secure with the provided Kunrled Screws (E).

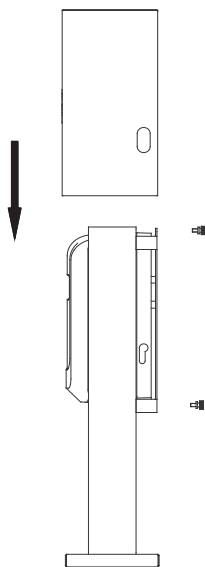

START TO USE THE DEVICE

1. Turn on the switch.
2. Place hand(s) underneath the dispenser within 8cm of the sensor. The LED will blink GREEN and dispense 0.8ml of sanitizer into your hand(s).
3. To receive additional sanitizer, remove hands from below dispenser and repeat 2.

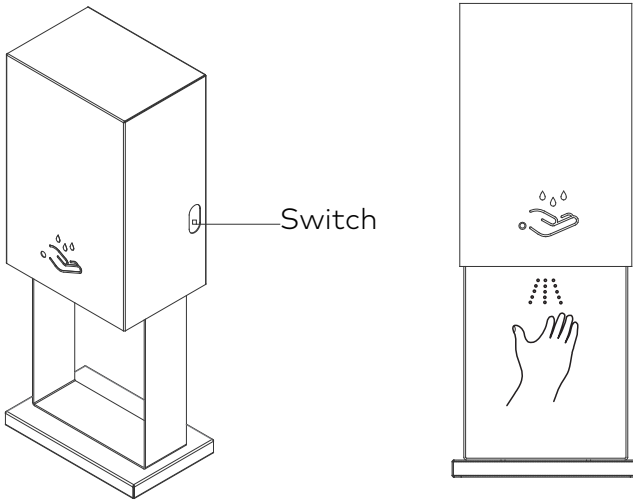

LED LIGHT

1. Green color 5 seconds flush: working condition;
2. Red color 5 seconds flush: low power for battery;
3. Red color 2 seconds flush: something under sensor and remove it.
4. Red color keeps flush: low volume sanitizer.

CLEANING AND MAINTENANCE

* To clean the outside of the product, use a dry or slightly dampened clean cloth (use clean water, never a solvent) to wipe the surface of the product.

* Do not use any cleaners with chemicals, solvents or harsh abrasives. Use only a dry soft cloth to dust or wipe carefully.

TROUBLESHOOTING

No Dispense, Motor Does Not Run

- * Hands are not directly underneath sensor
- * No refill is loaded
- * Incorrect refill is loaded
- * Batteries are not loaded, or are loaded incorrectly

No Dispense, Motor Runs

- * Refillable bottle is empty or is loaded improperly
- * Pump is not primed

WARRANTY INFORMATION