

Installation Manual

Calypso Luxury Steam Shower

L60" X W40" X H87.75"



Safety notice

1. The electrical installation should be performed by a qualified technician or professional.
2. The power supply should match the electric parameter of the product, certified GFCI Circuit . distance among outlets $\geq 3\text{mm}$.
3. Cutting any wire on this product is strictly prohibited in the process of handling installation. Do not take apart computer control box, control panel or remote control, or warranty will be void.
4. Before using, check whether power is sufficient? Whether control faucet is open.
5. Avoid Organic liquid like Acetone, ammonia, petrol and vitriol chemicals that will blemish the acrylic surface and plated parts.

Advice:

1. Pay attention to high temperatures to prevent burns when using the steam shower.
2. Person that are intoxicated, hypertensive, asthmatic, or have heart disease should avoid prolonged use of the steam shower.
3. Children should be accompanied with adult when using the steam shower.
4. close the door and do not enter the steam shower when the sterilization is on.
5. The massage bath tub can not be filled while using the steam shower.
6. Don't forget to cut water supply and power supply after done.
7. Unit must be properly grounded.
8. Outdoor use is not allowed.

Warning:

Users must operate according to the Safety Notice and installation requirements otherwise, personal injury may occur

The manufacturer reserves the right to modify this unit and technical parameters at any time .

Technical parameter

Product Features - Standard Configuration

MODEL	Function and device																
	Control Panel	Exhaust Fans	Ozone sterilization	Steam bath	FM Radio	Bluetooth	Telephone answer	Cold / Hot Water Switch	Hydraulic pressure adjustor	Multi-function shower	Acupuncture massage	Temperature detector	Temperature setting	Time setting	Top shower	Sliding handle shower	Top light
WG-U956	●	●	●	●	●	●	●	●	●	●	●	●	●	●	●	●	●

Electric Parameter:

Model	Size(mm)	Electrical source voltage (V)	Rated Power (Hz)	Rated current (A)	Steam generator (W)	Pump (W)	Blower (W)
WG-U956	1515X915X2250	220-240	50-60	≈ 16	3550		

The information of this table are only reference, our company has right to amend the technique parameter、specification 、model、collocate before any advance inform, the detail please inquire about dealer.

Water Parameter:

Work hydraulic pressure	Current capacity	Diameter of drainer	
Mpa	L/min	Cold/hot water	Drainer
0. 2-0. 4	8-12	DN15	DN40

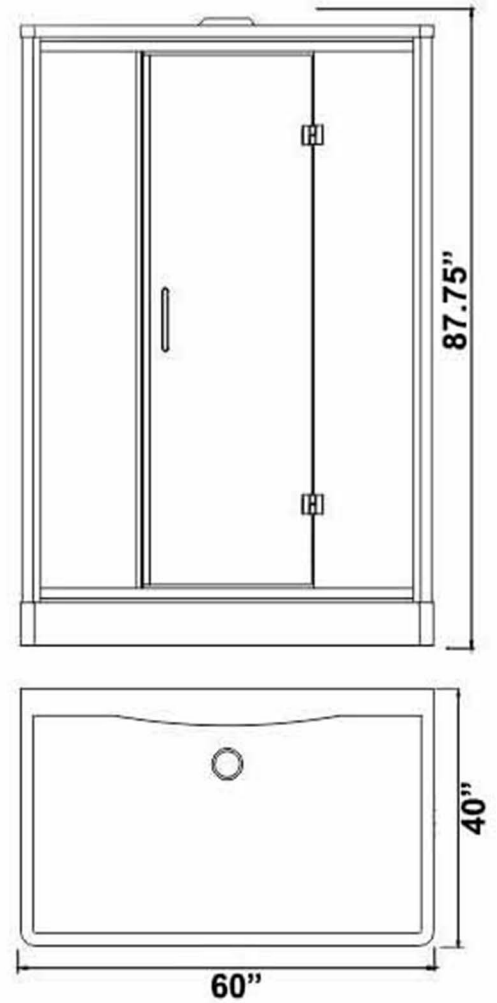
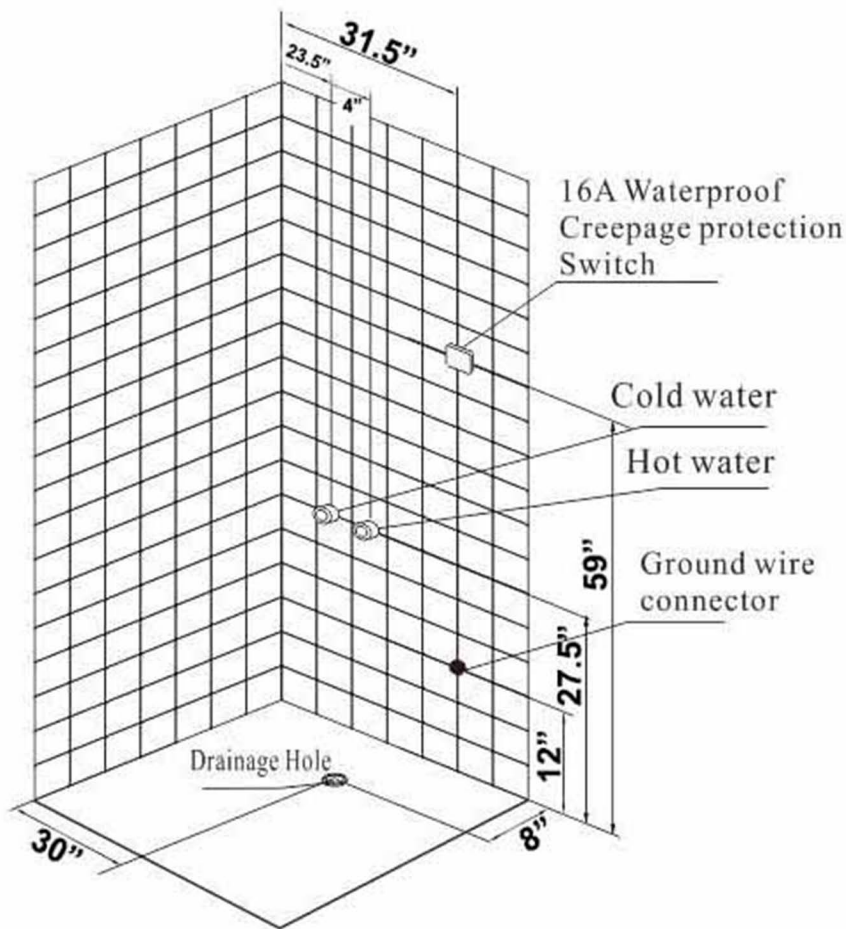

1. Water Supply: One Cold and one Hot pipe. Shut-off Valve with outside Yoke (DN15(G1/2)) shall be mounted on the wall which should be 27.5" above from the ground. 0.15mPa=Pressure=0.4mPa.
2. The steamer power: 3550W. Power supply voltage: AC230V \pm 10%. Frequency: 50Hz. Single Phase and Three Wire System with 3X4mm² rubber-insulated copper wire which is independent loop. The steamer is mounted with the Creepage Overload Protection device and must have the reliable ground wire.
3. Water Drainage: The floor drainage hole should be the same or bigger than DN50, and should be on a line with the ground.

Installation steps

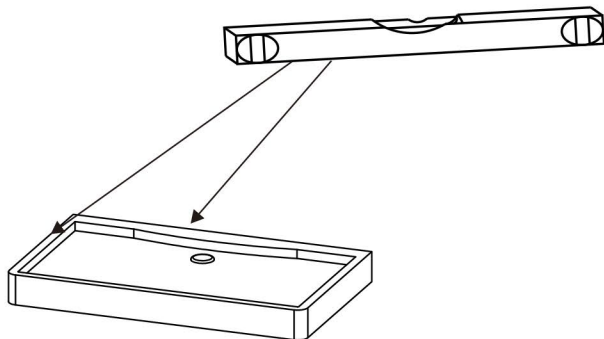

1. Install tray

Open the package, put the tray on the appropriate place. Use the level ruler to measure . Adjust the feet which under on the tray until adjust it in the horizontal, and then screw down the nut. The feet must adhere to the ground.

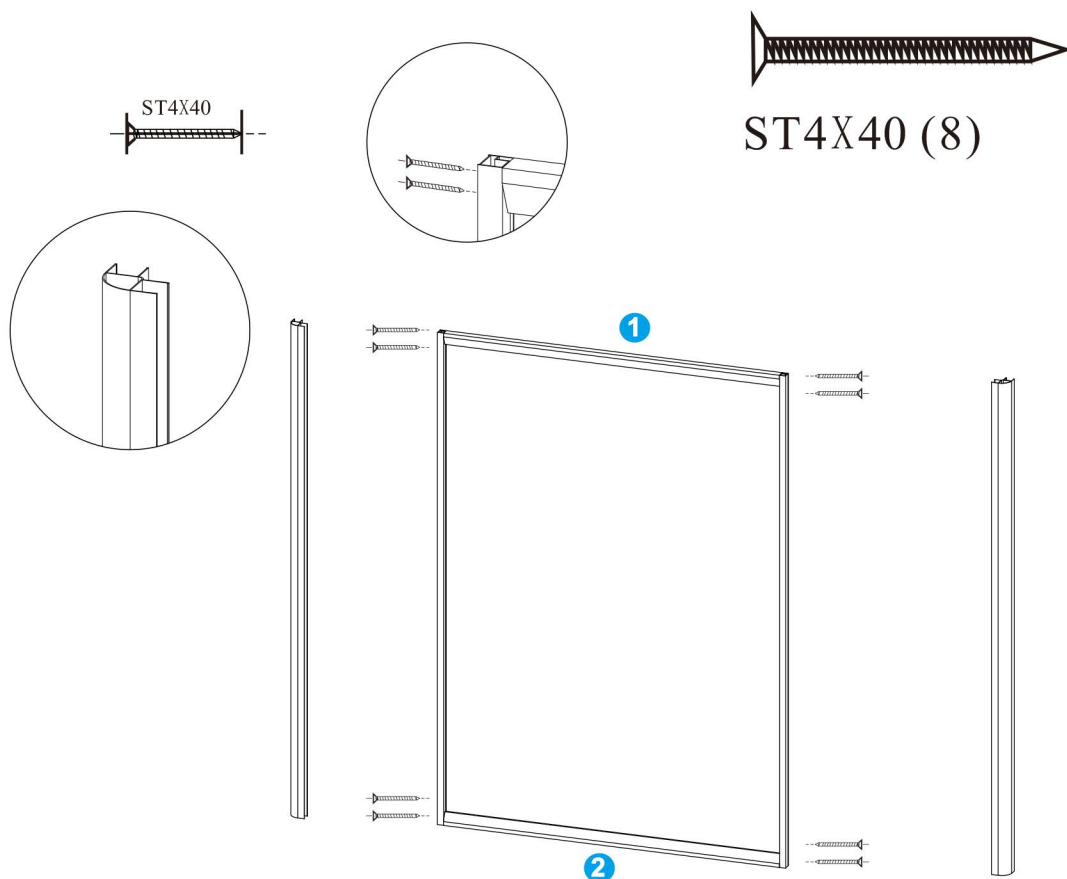

2. install the front frame

use 4x40mm KA to connect the al.profile(number 1,2 and two vertical al.profile), and then cover to both sides 90°angle al.profile.

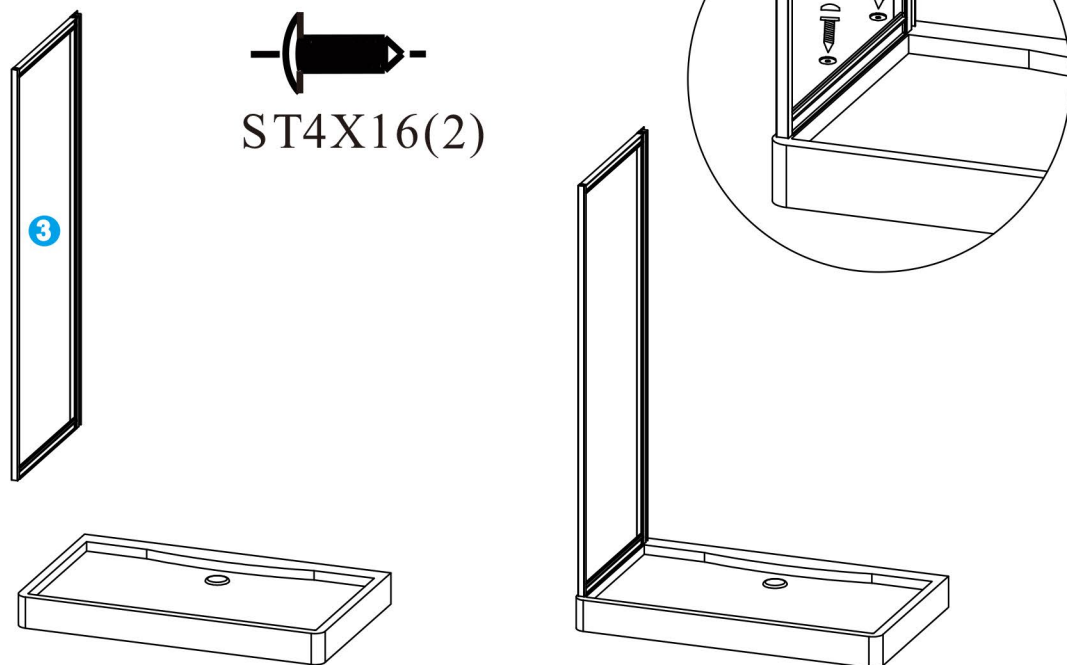

3.install the side glass
use the 4x16mm self-tapping screws to fix the parts (number 3)on the tray

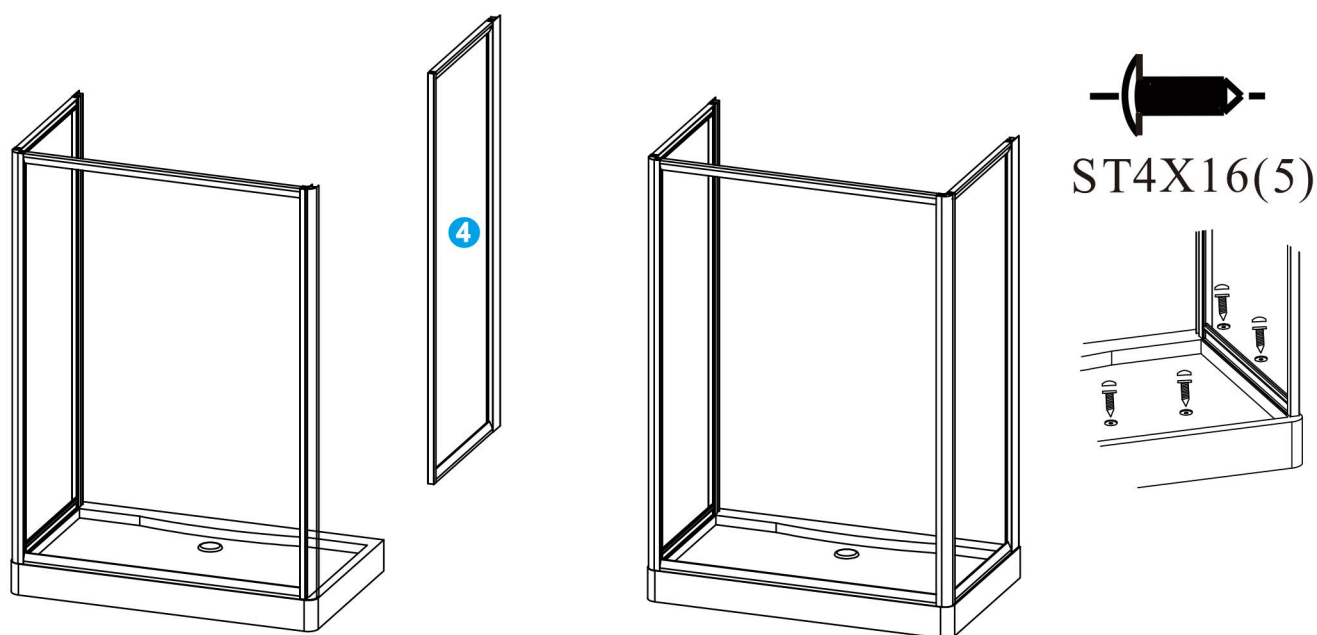

4. to be connected the front frame and side glass,next,according the step 3 to install the another side glass,and then use 4*16mm self-tapping screws to fix the parts on the tray



ST4*10(5)

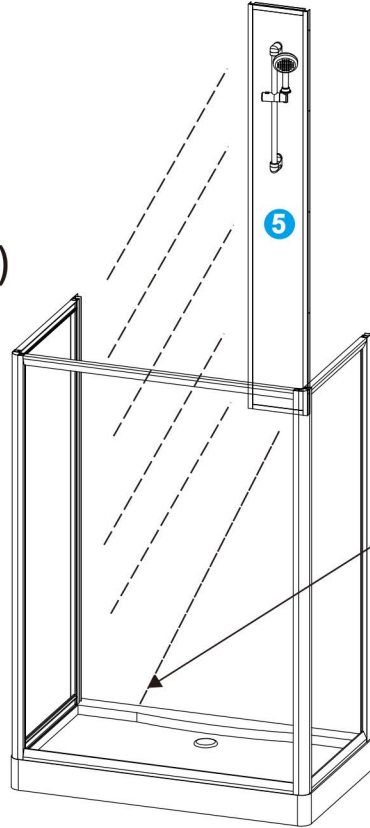

M6X25(1)

install the parts (number 5)
first, install the shower pole
second, use 4x10 self-tapping screws to be connected the side glass,
last, use 6x25 screws to fix on the tray

M4X20(5)

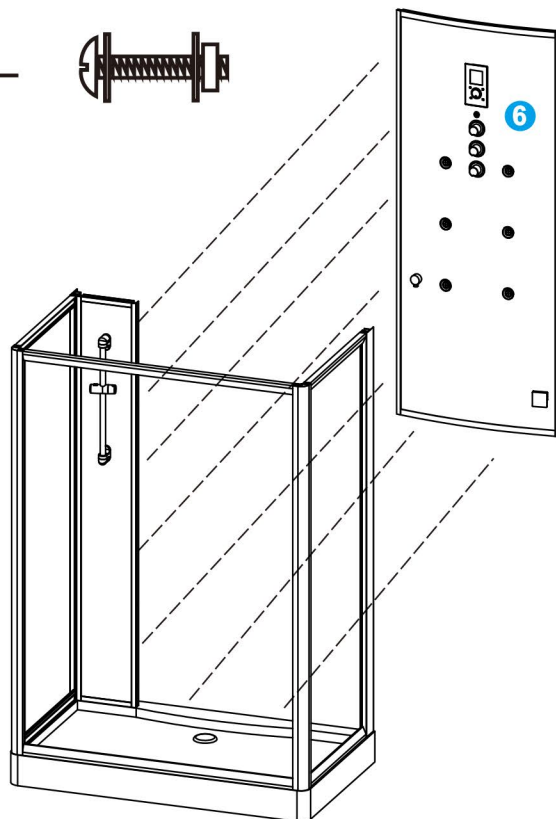
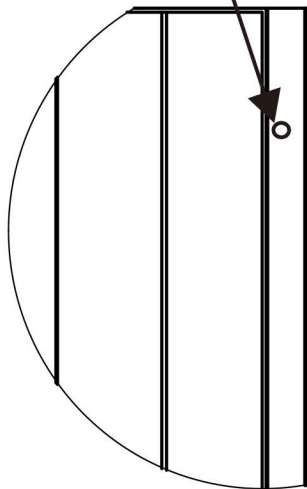

ST4*16(2)

6. install the parts (number 6)
use the 4x20 screws to be connected the parts 6 and parts 5, and then use 4x16 self-tapping screws to fix on the tray

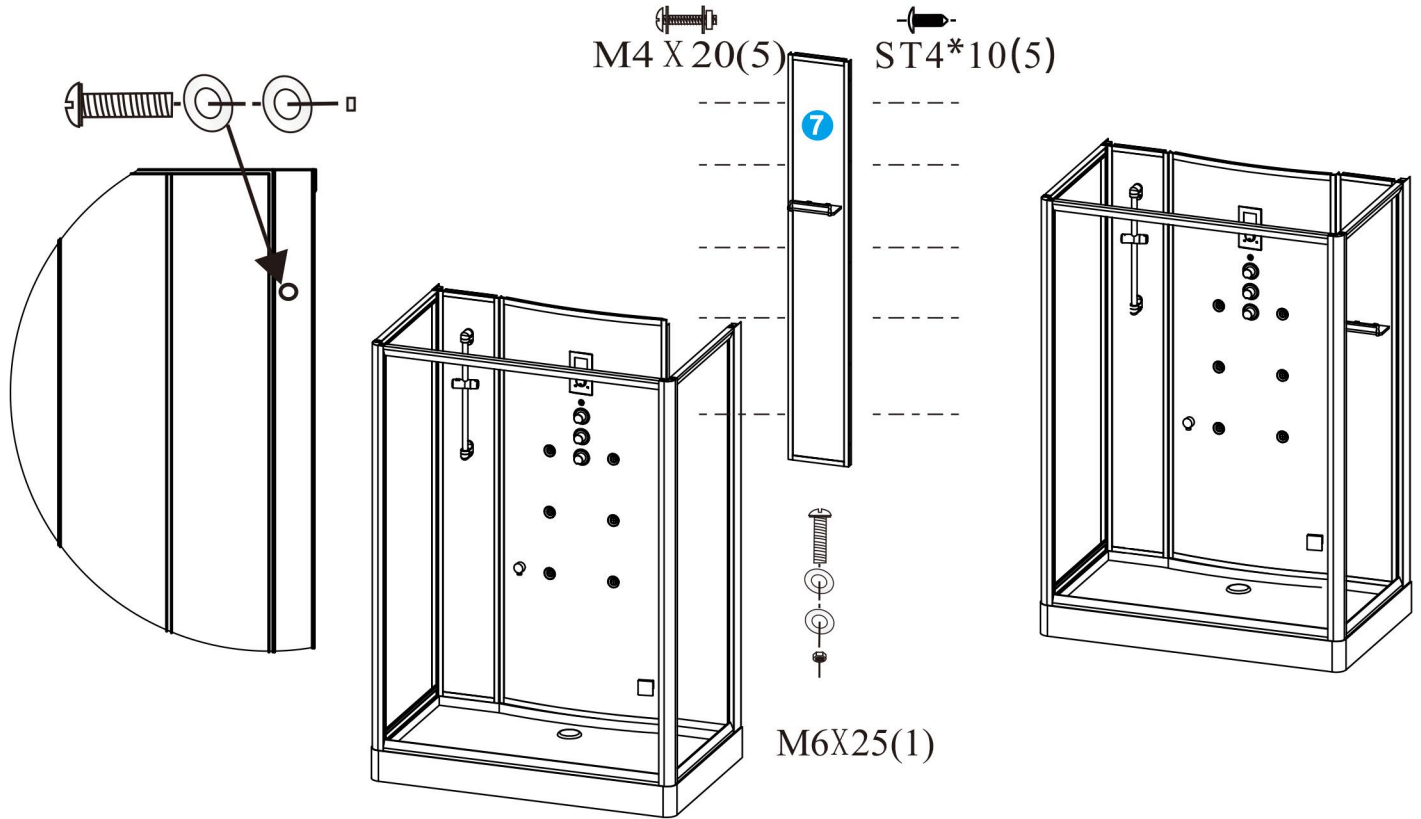

install the parts 7

use 4x20 screws to be fixed the parts 6, use 4x10 self-tapping screws to be fixed the side glass, use 6x25 screws to fix on the tray

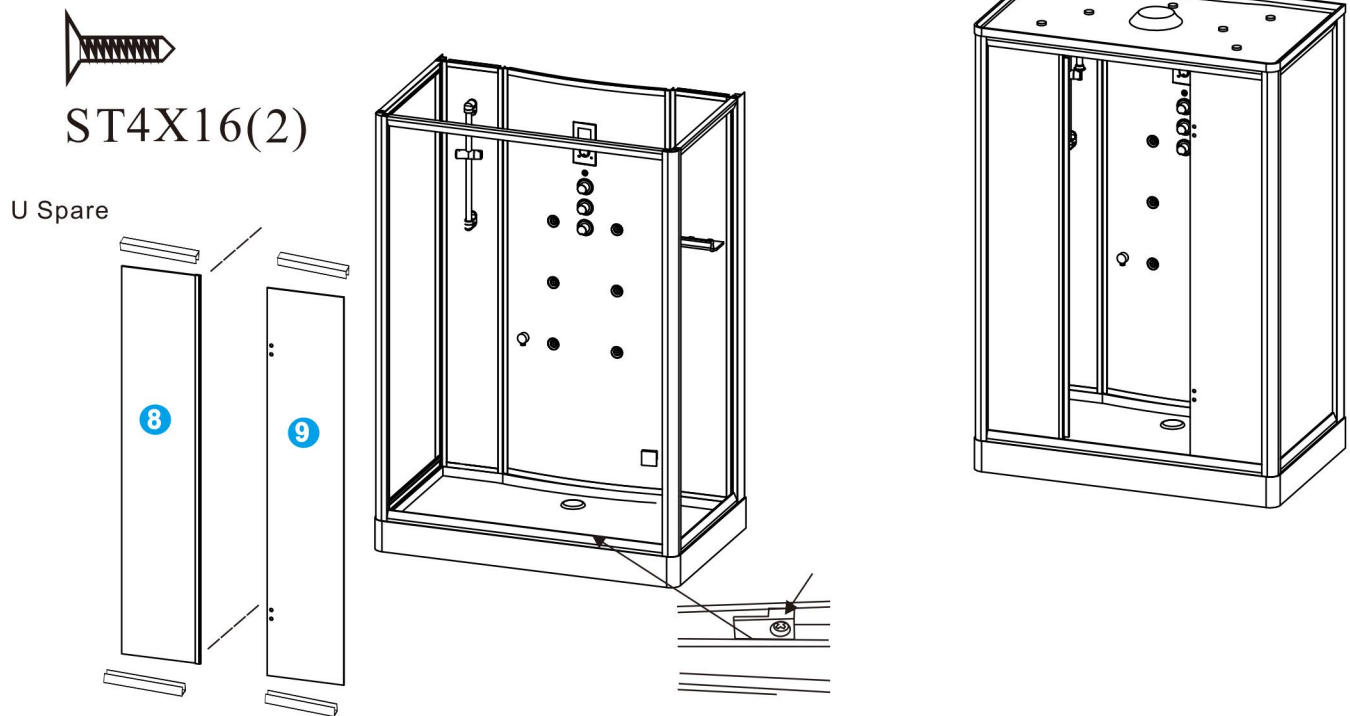

install parts 8 and parts 9

put the U shape rubber onto the bottom and top of the glass 8 and 9, use 4x16mm self-tapping screws to top and bottom of fix the front frame, loosen the fixture of the al. profile for parts 9, put the glass at the back of the front frame, and then use the fixture to fix

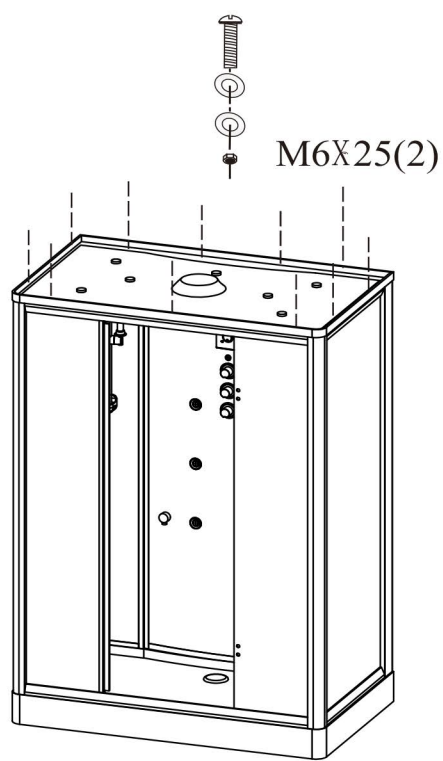

 ST4X16(9)

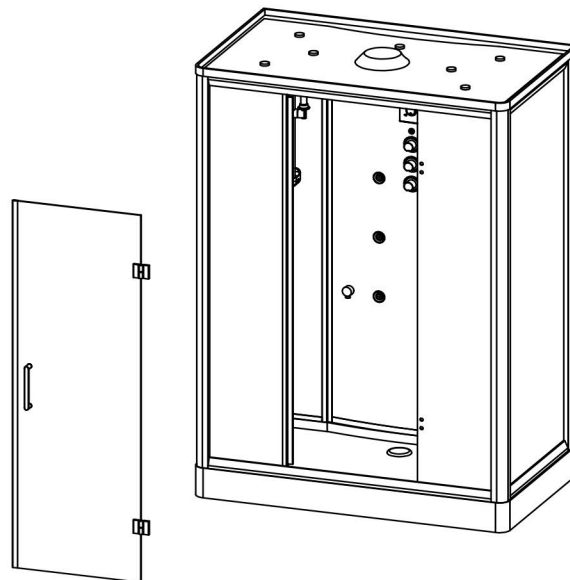

install the top glass
 use the 4x16 screws to fix the top glass, use the 6x25 screws to fix the small back glass

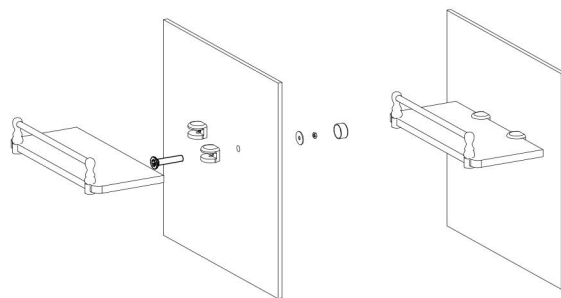
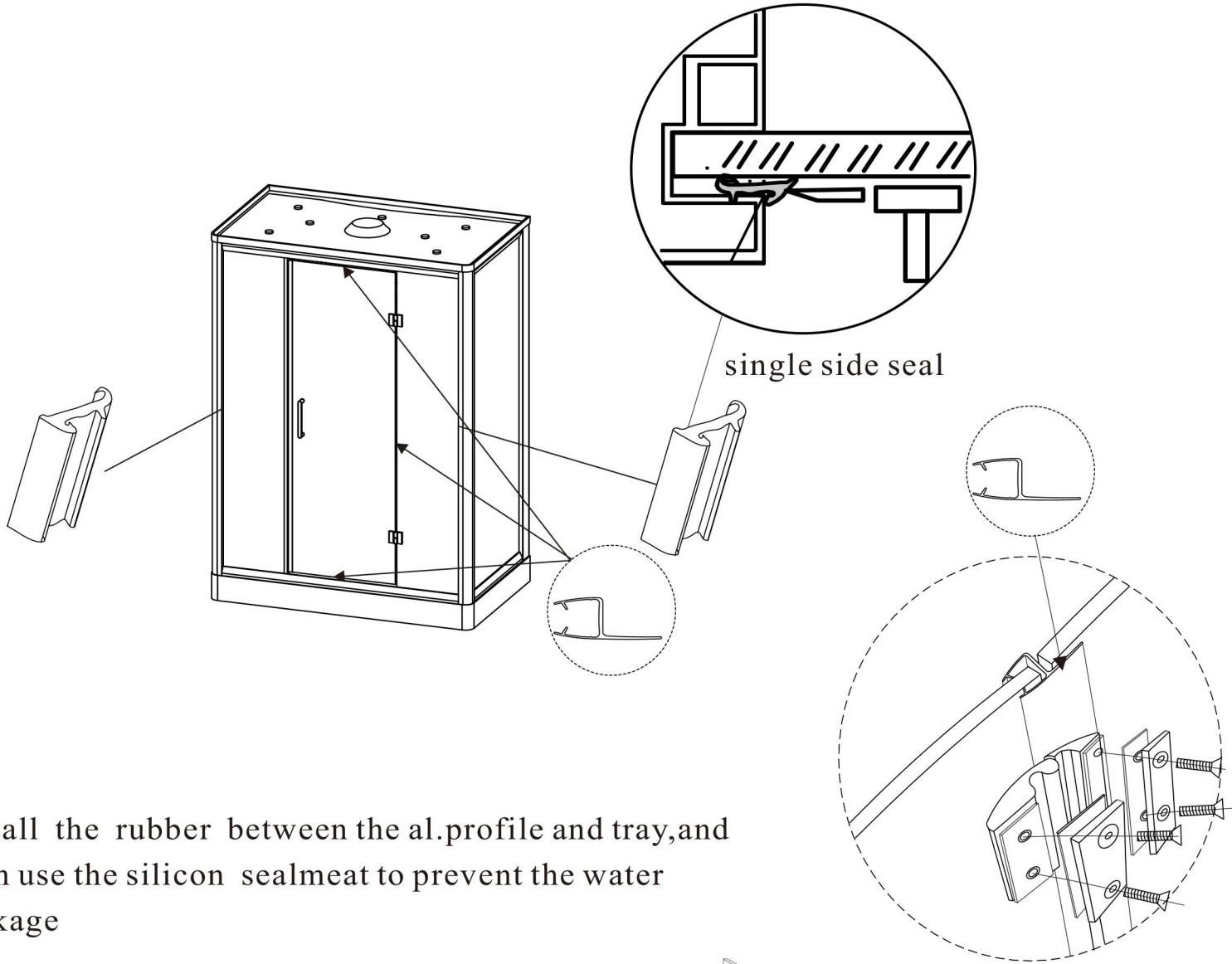

install the glass door
 install the handle
 install the hinges and adjust



install the handle

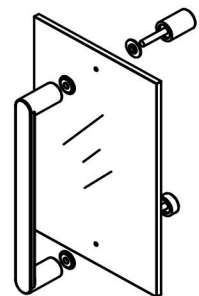

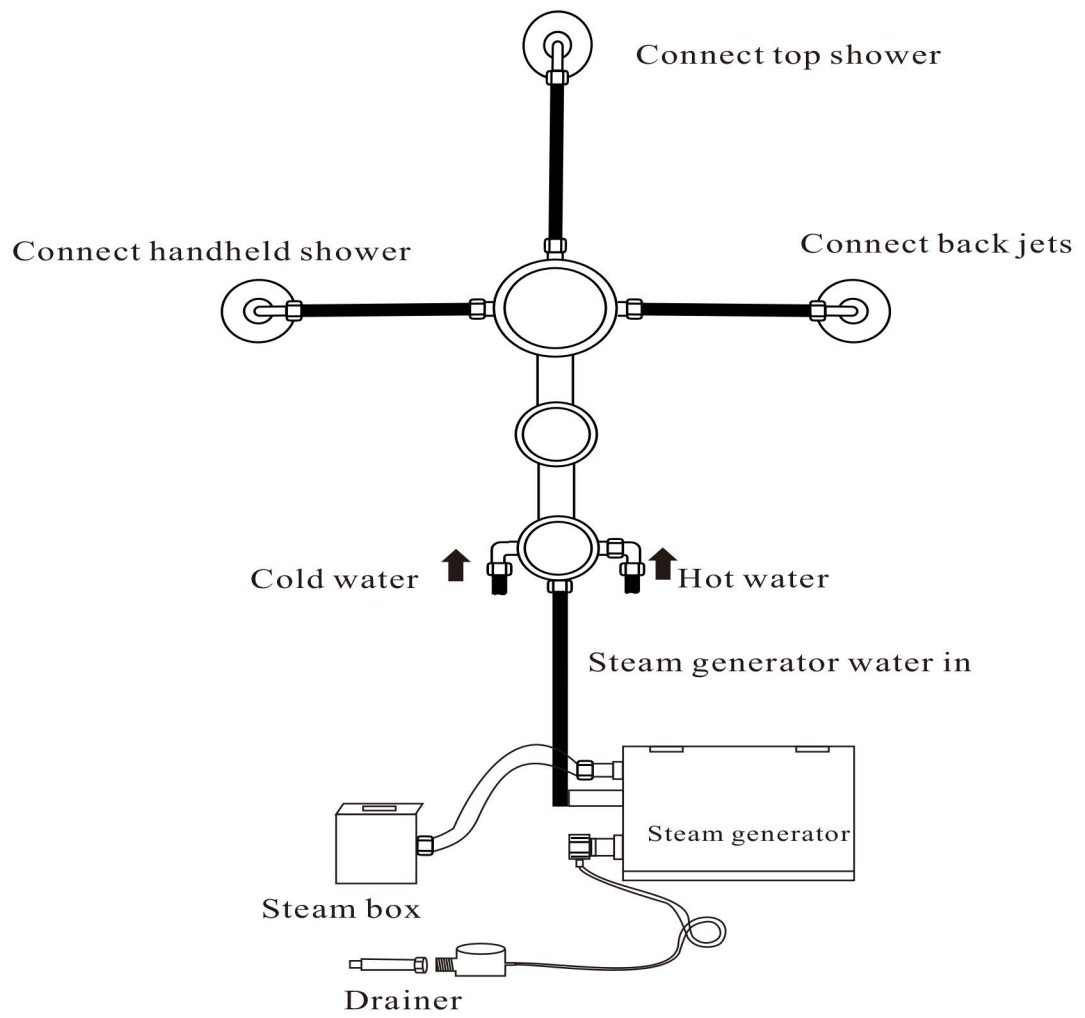

Hose diagram

Connect the wire to control box, fan to fan ,light to light, loudspeaker to loudspeaker.
ozone to ozone

