

BED ASSEMBLY INSTRUCTIONS

INCLUDE PARTS

(A)



HEADBOARD (1) PC

(C)



SIDE RAILS (2) PC

(G)



WINGS (2)PC*
ONLY APPLICABLE FOR BEDS
THAT REQUIRE WINGS

(D)



MATTRESS SUPPORT (3) PC

(E)

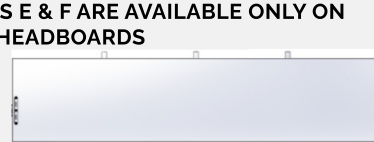

PLATFORM (1) PC

(F)



WALL CLEAT (1)PC*

(B)



FOOTREST (1) PC

PIECES E & F ARE AVAILABLE ONLY ON
87"H HEADBOARDS

ASSEMBLY INSTRUCTIONS

1

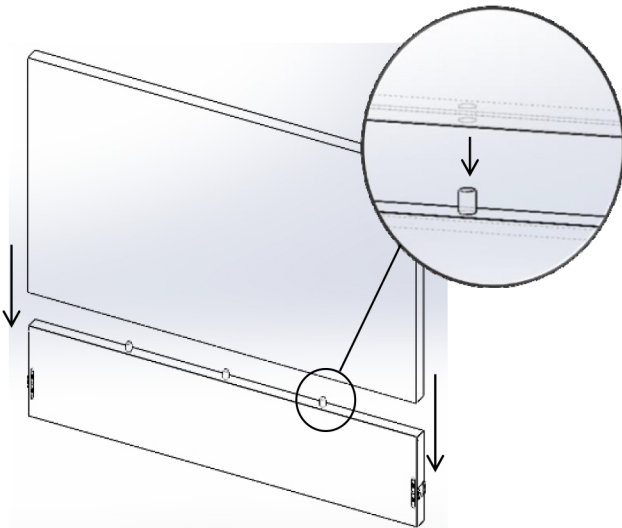

IF YOUR HEADBOARD IS 67"H SKIP THIS STEP.
IF YOUR HEADBOARD IS 87"H . ATTACH HEADBOARD (A) INTO
THE PLATFORM (E) BY ALIGNING NODES WITH THE HOLES &
PUSHING PIECES TOGETHER

2

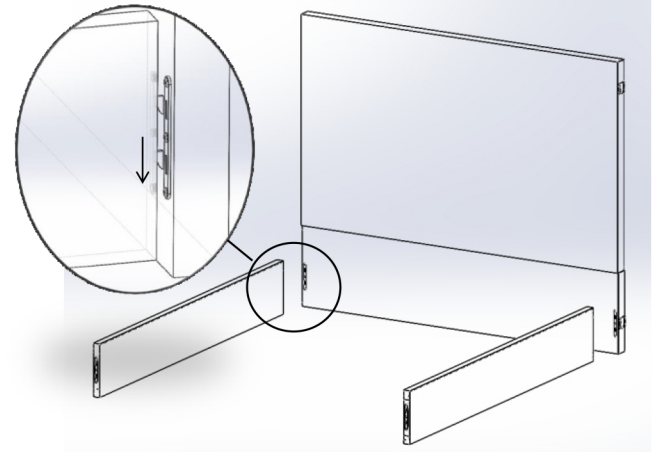

IF YOUR HEADBOARD IS 67"H ATTACH BOTH SIDE RAILS (C)
INTO THE HEADBOARD (A)
FOR 87"H HEADBOARD. ATTACH BOTH SIDE RAILS (C) INTO
THE PLATFORM (E)

3

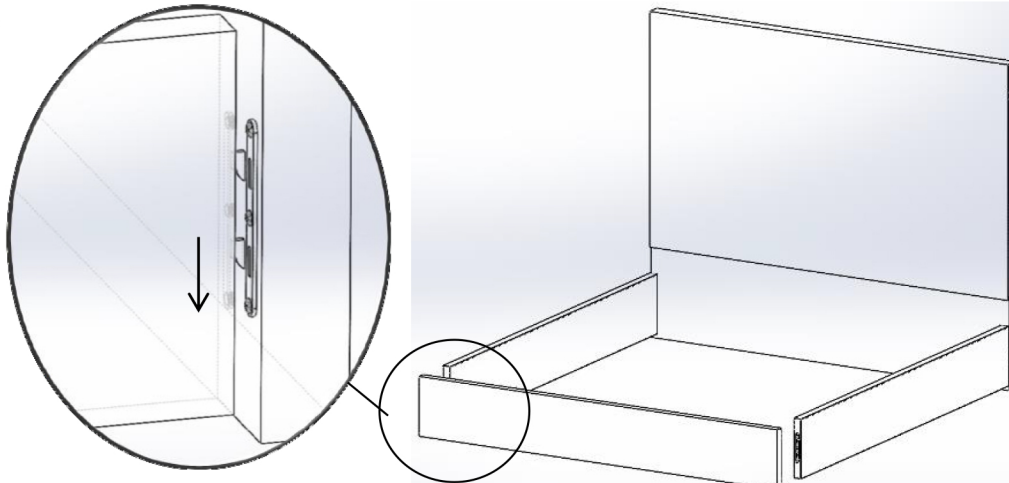

ATTACH THE FOOTREST (B)
INTO THE SIDE RAILS (C)

BED ASSEMBLY INSTRUCTIONS

4

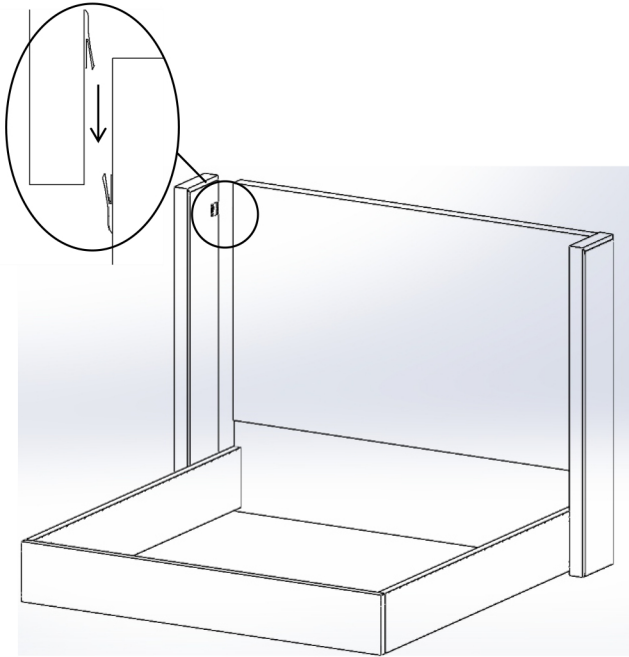

PLACE THE WINGS (G) AS SHOWN

5

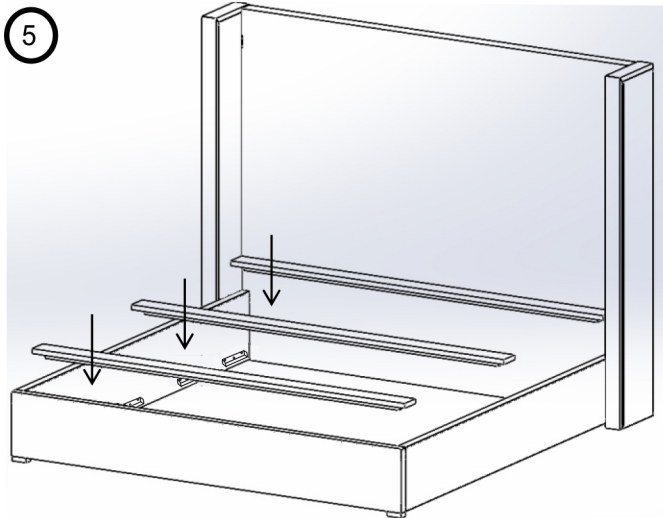

PLACE THE MATTRESS SUPPORT (D) AS SHOWN

FOR ADJUSTABLE BED

JUST REMOVE THE 6 BRACKETS WITH A SCREWDRIVER AND DO NOT USE THE MATTRESS SUPPORT (D)

**FOR 87"H HEADBOARDS ONLY
WE SUGGEST TO LEAVE THE HEADBOARD FIXED TO THE WALL**

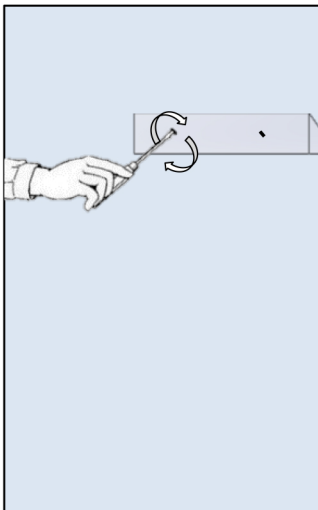

INSTALL THE WALL CLEAT (F)
TO THE WALL AND THEN
SET THE HEADBOARD ON IT.

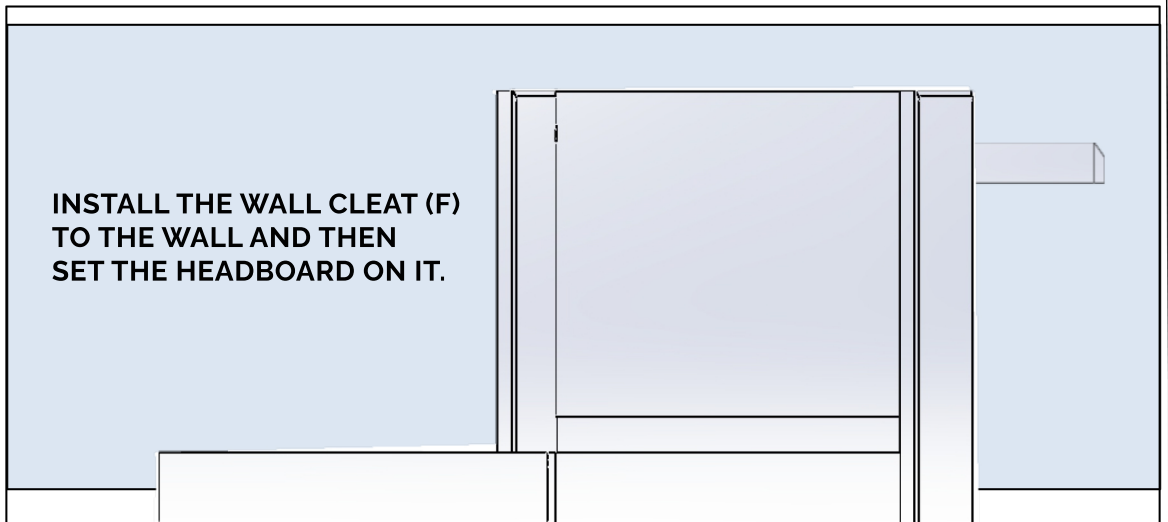

NATIVATM
INTERIORS

www.nativainteriors.com

WHERE LUXURY LIVES.