



PRODUCT MAINTENANCE:

1. To clean the outside of the lamp, use a dry or slightly dampened clean cloth (use clean water, never a solvent) to wipe the surface of the fixture. **DO NOT CLEAN THE LED CHIPS!**
2. Do not use any cleaners with chemicals, solvents or harsh abrasives. Use only a dry soft cloth to dust and wipe carefully.

LIMITED WARRANTY

The manufacturer warrants this lighting fixture to be free from defects in materials and workmanship for a period of three (3) years (except bulbs) from date of purchase. This warranty applies only to the original purchaser and only to products used in normal use and service. If this product is found to be defective, the manufacturer's only obligation, and your exclusive remedy, is the repair or replacement of the product at the manufacturer's discretion, provided that the product has not been damaged through misuse, abuse, accident, modifications, alterations, neglect or mishandling. This warranty shall not apply to any product that is found to have been improperly installed, set-up, or used in any way not in accordance with the instructions supplied with the product. This warranty shall not apply to a failure of the product as a result of an accident, misuse, abuse, negligence, alteration, or faulty installation, or any other failure not relating to faulty material or workmanship. This warranty shall not apply to the finish on any portion of the product, such as surface and/or weathering, as this is considered normal wear and tear. The manufacturer does not warrant and specially disclaims any warranty, whether expressed or implied, of fitness for a particular purpose, other than the warranty contained herein. The manufacturer specifically disclaims any liability and shall not be liable for any consequential or incidental loss or damage, including but not limited to any labor/expense costs involved in the replacement or repair of said product.

KEEP your receipt and these Instructions for Proof of Purchase.

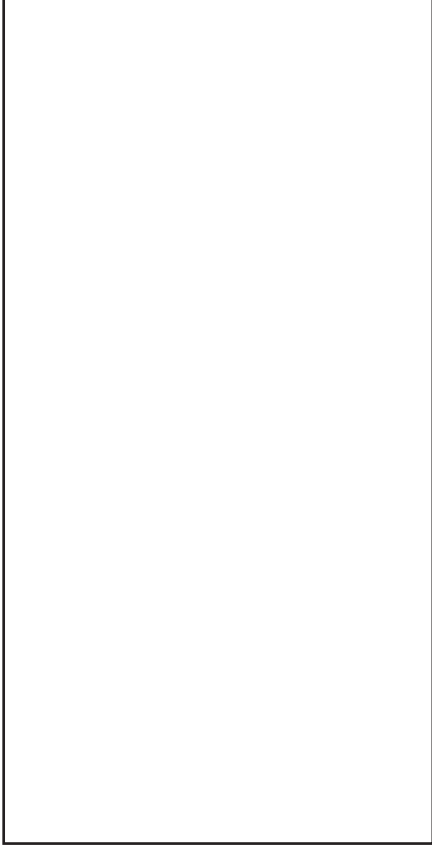



LED Vapor Tight Light

Model 6236

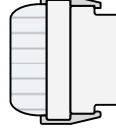
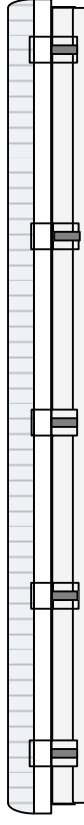
INSTALLATION MANUAL



Assembly and safety instructions

-  **DANGER:** Before installation, turn off the main power at the circuit breaker.
-  **WARNING:** Installation must be performed by a qualified licensed electrician.
-  **CAUTION:** To prevent electric shock, do not insert any objects through openings.

INSTALLATION INSTRUCTIONS:

1 Assembly of the light fixture

Remove the metal fixture pan from the base housing by rotating the top fixture retainers.

2 Connecting the wires

Connect the black supply wire to the black fixture wire.
Connect the white supply wire to the white fixture wire.
Connect the ground supply wire to the ground fixture wire.

3 Assembly of light fixture

Assemble the light fixture using the retainers.
Make sure the acrylic diffuser is seated correctly for a tight fit.
Install the T-8 LED tubes carefully.

4 Mounting the fixture

Mount the metal clips to the surface where light is to be placed.
The mounting clips should be spaced 31" apart
Snap the fixture into the clips making sure it is secure
Never drill through fixture to mount. This will compromise the water tight feature and could cause damage to the fixture.

Accessories included

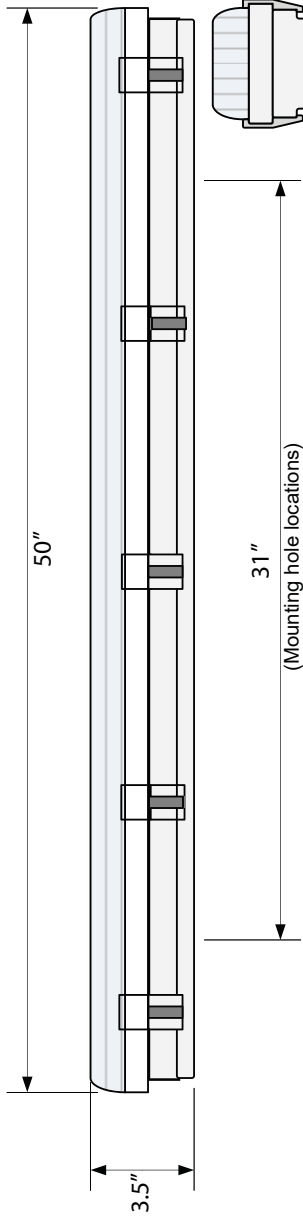

Install the diffuser retainer clips

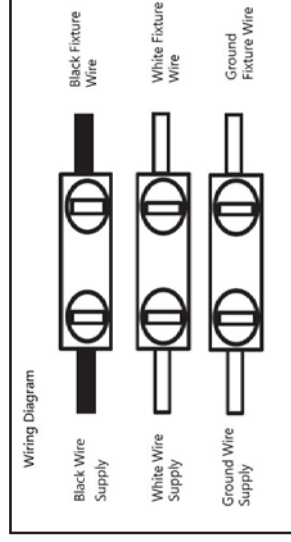

Install the T-8 LED tubes

Install the cover making sure the gasket is in place



CONSULT A QUALIFIED ELECTRICIAN IF YOU HAVE ANY QUESTIONS PRIOR TO INSTALLATION