

Instructions for electrician STEPS 2 - 21

WARNING: THIS LUMINAIRE MUST BE MOUNTED OR SUPPORTED INDEPENDENTLY OF AN OUTLET BOX.

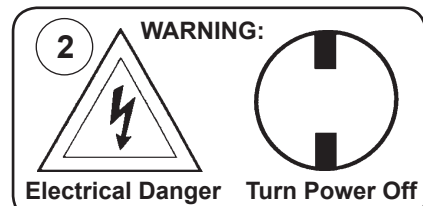

All electrical components must be installed by a licensed electrician in accordance with the National Electric Code and the appropriate local electrical codes.

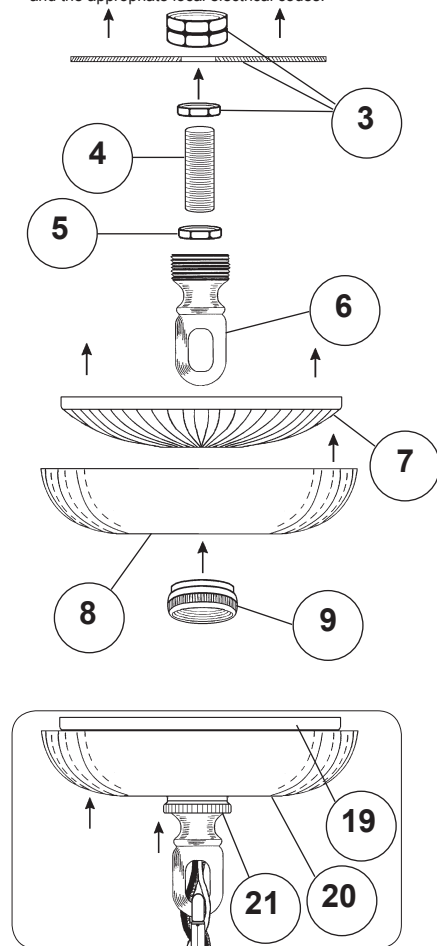

NOTE:
SLIDE LOOSE RING 2 ONTO
FRAME BEFORE ATTACHING
FRAME TO CHAIN!

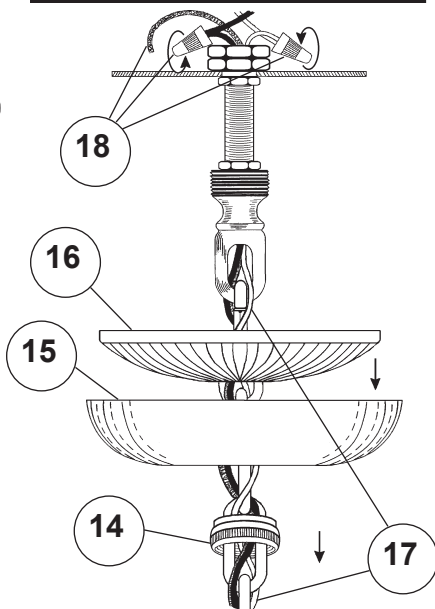

CHANDELIER 2643- _____ TRIM DIAGRAM

(Finish Option)

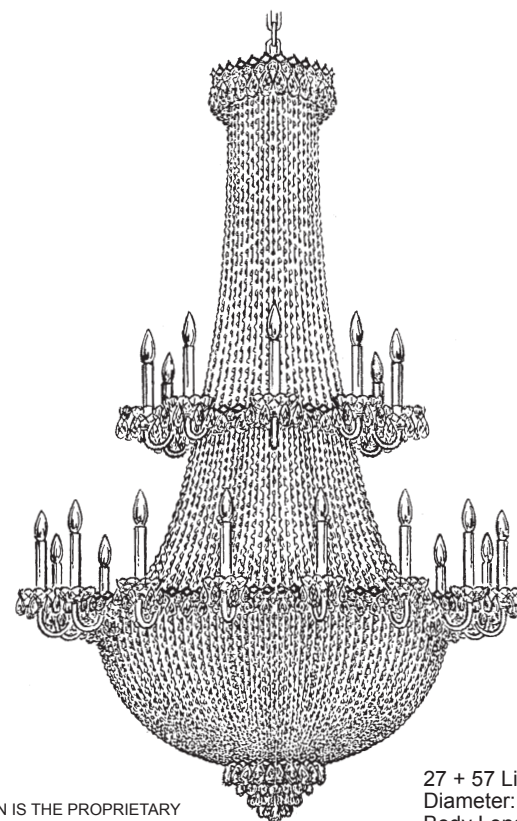

THIS DESIGN IS THE PROPRIETARY
TRADE DRESS/TRADEMARK OF
SWAROVSKI LIGHTING, LTD.

27 + 57 Lights
Diameter: 41-1/2"
Body Length: 65"
Hanging Weight: 85 lbs.

SCHONBEK®

See diagram on back page
Follow steps in exact order
Save this trim diagram for future reference

1

IMPORTANT

Person who opens carton should record the following information for future service.

CODE # _____ Four-digit number on outside of carton.
PACKER # _____ See crystal package label.
ORDER # _____ See crystal package label.

Instructions for crystal trimming STEPS 22 - 38

22

You will need 84 - B10
25 Watts Recommended
60 Watts Max

Install bulb and be sure
to test fixture **BEFORE**
trimming.

23

Attach the bottom
finial section by
attaching the jackchain into
the half ball located on the
bottom of the frame.

BOBECHÉ
9763/1 = Gold Pins
9763/2 = Silver Pins

NOTE: Hang drop "C"
from scallop, **NOT**
through the loop on the
gallery.

DIAGRAM 3

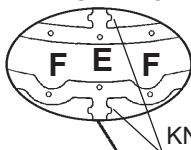

KNOTCH

DIAGRAM 4

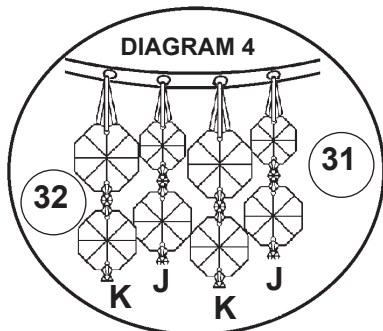

Large jewel at top and graduates
to a smaller jewel toward bottom of
chain.

34

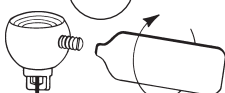

Tighten With
Tool Provided.

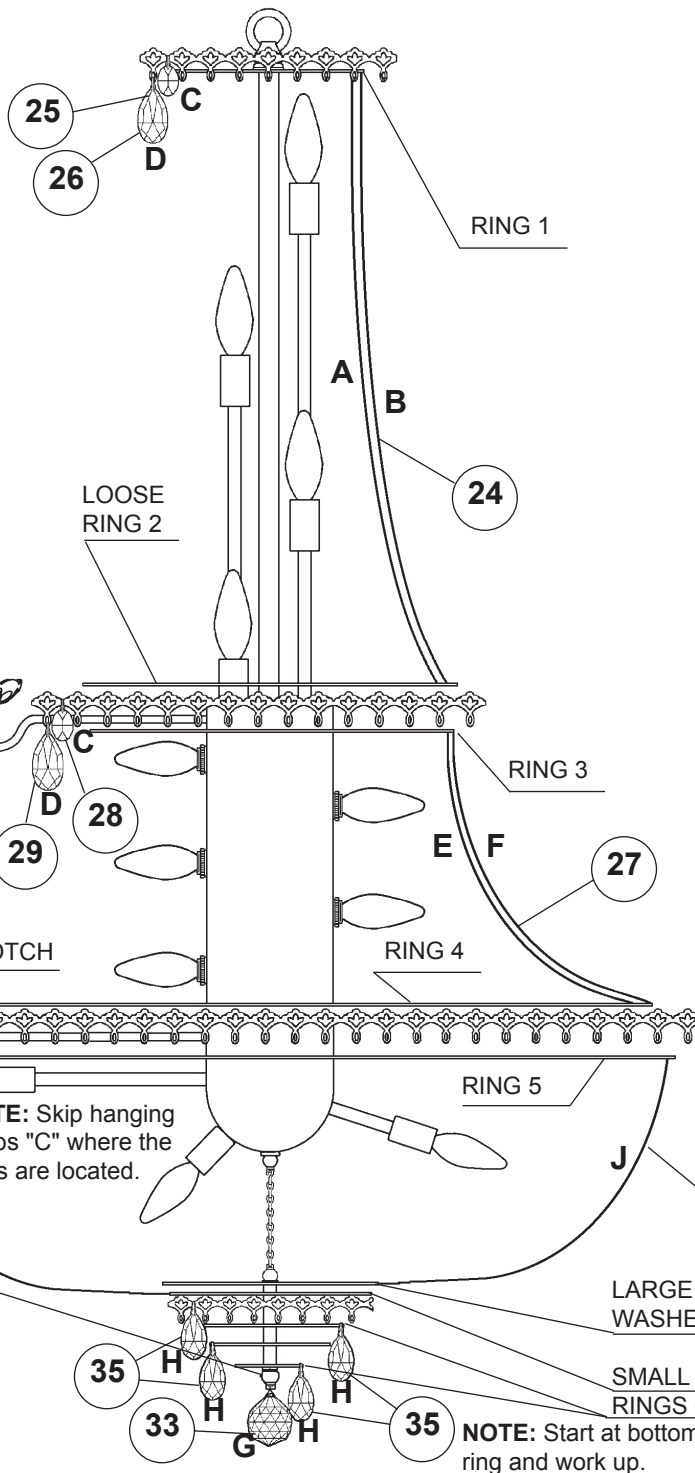
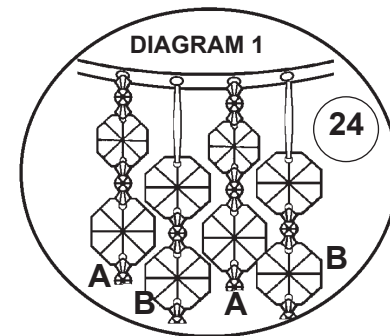
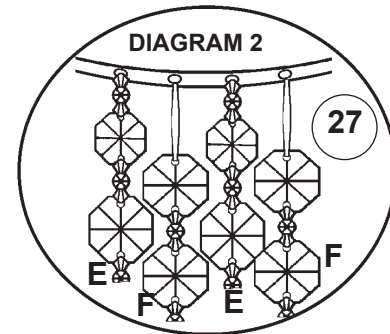

DIAGRAM 1



Small jewel at top and graduates
to a larger jewel toward bottom of
chain.

DIAGRAM 2



Large jewel at top and graduates
to a smaller jewel toward bottom of
chain.
Start Chains "E" in hole of knotch
on ring 3 and other end in hole of
knotch on ring 4 (see diagram 3).

NOTE: Raise the large
finial washer for easier
installation of Chains "K".

