

Fontana Adjustable Body Massage Shower Jets

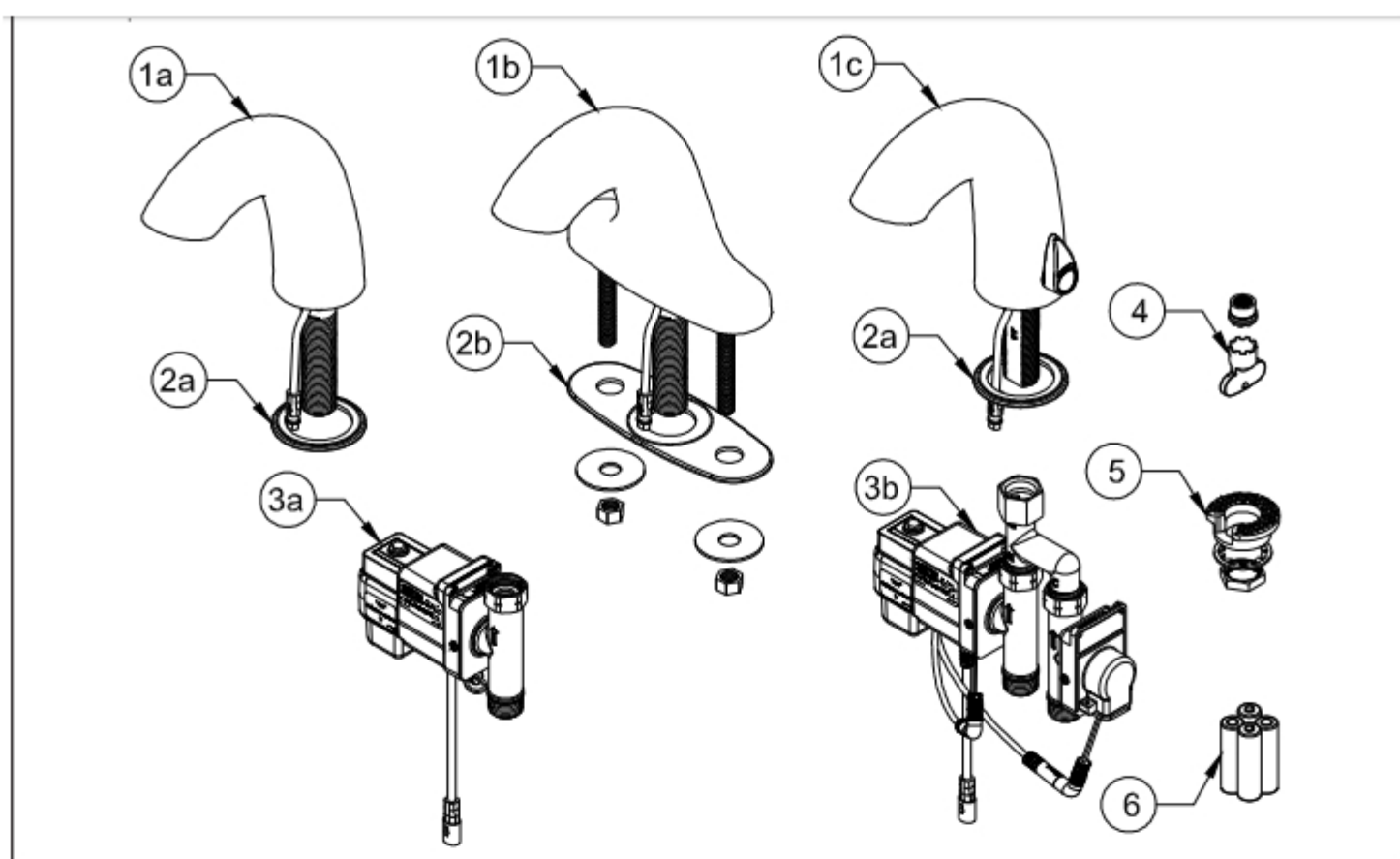

INSTALLATION INSTRUCTIONS



1a.	Z6950 Spout Assembly	3a.	Electronics Box with Solenoid - Z6950/55-XL
1b.	Z6955 Spout Assembly	3b.	Electronics Box with Solenoid - Z6950-XL-IM
1c.	Z6950-IM Spout Assembly	4.	Aerator and Key
2a.	Z6950 Spout base gasket	5.	Mounting Kit
2b.	Z6955 Spout base gasket	6.	Batteries

Step 1 - Spout Installation

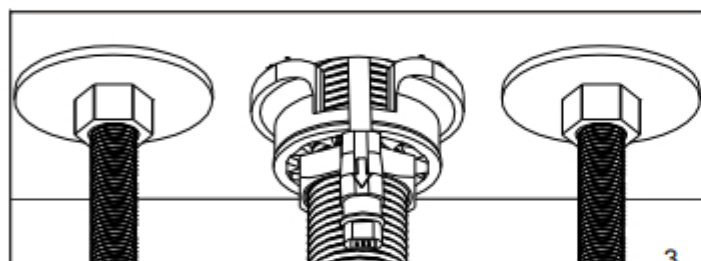
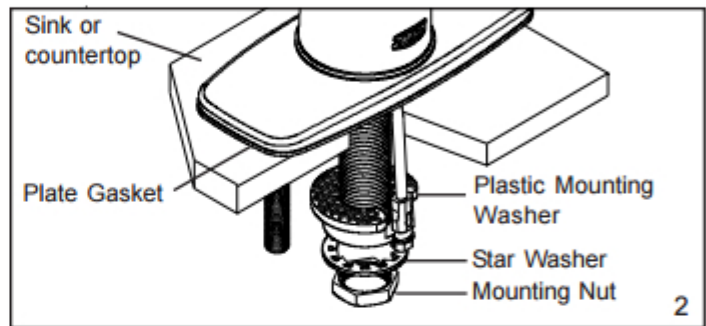
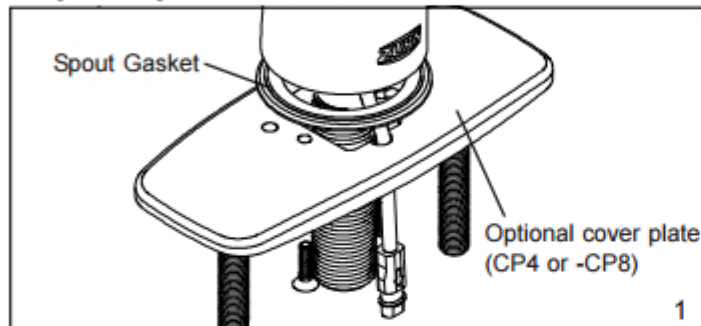

Step 2 - Electronics Module Installation

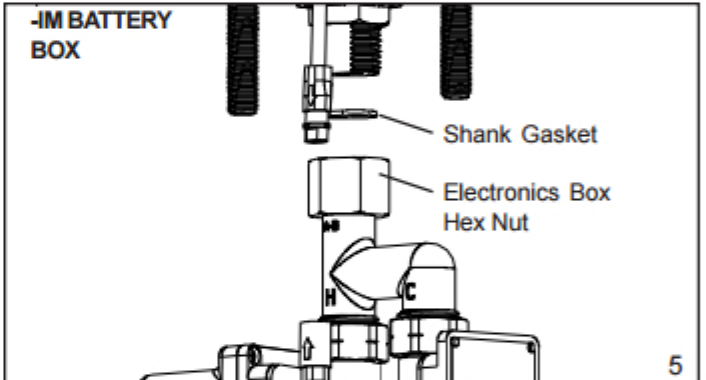
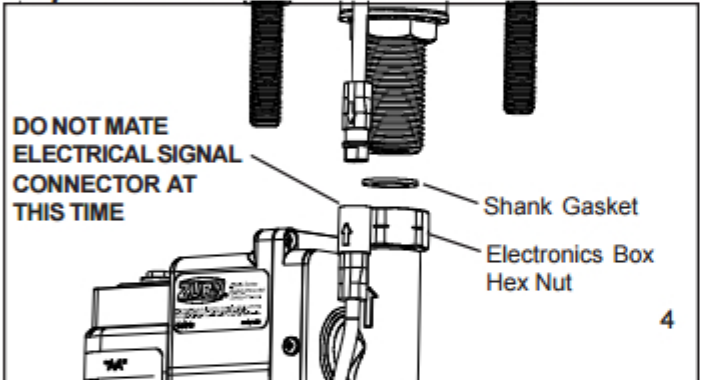

Step 3 - Filter or Mixing Tee or Mixing Valve Installation

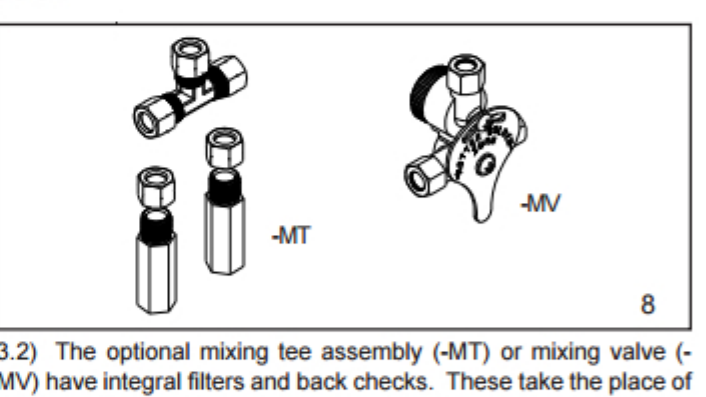
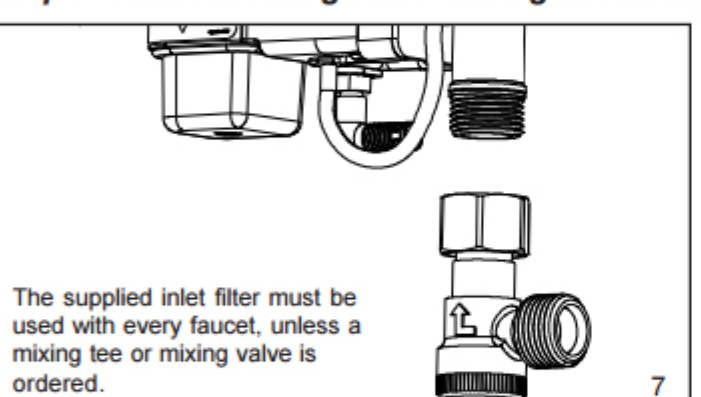

Step 4 - Connect Power

(Choose from the following: battery only, external ACA, P6000-HW6 with CWB, and/or External power with battery pack)

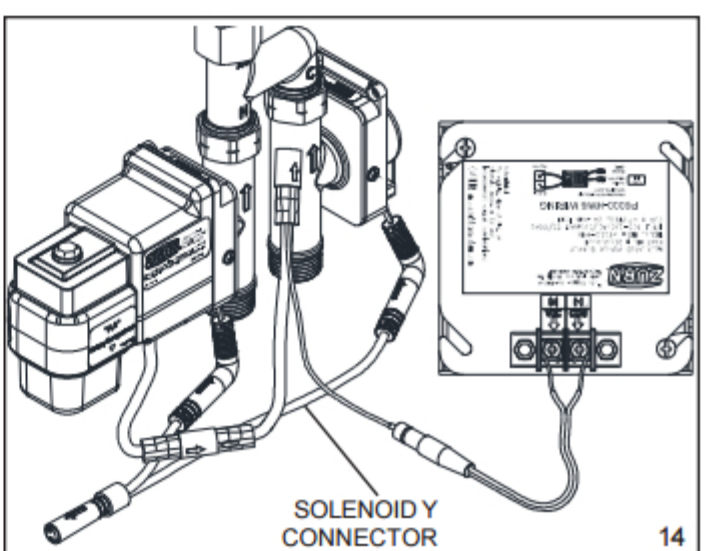
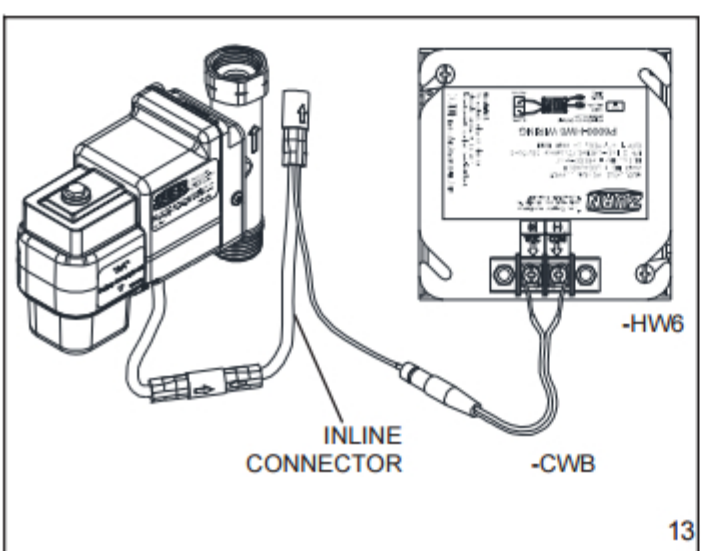
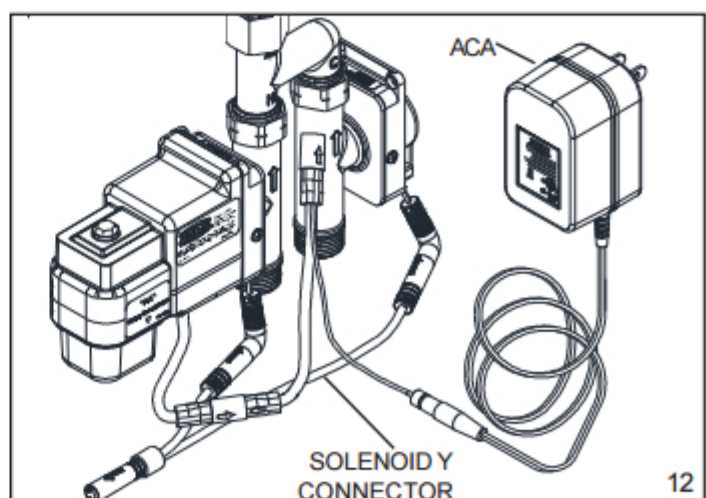
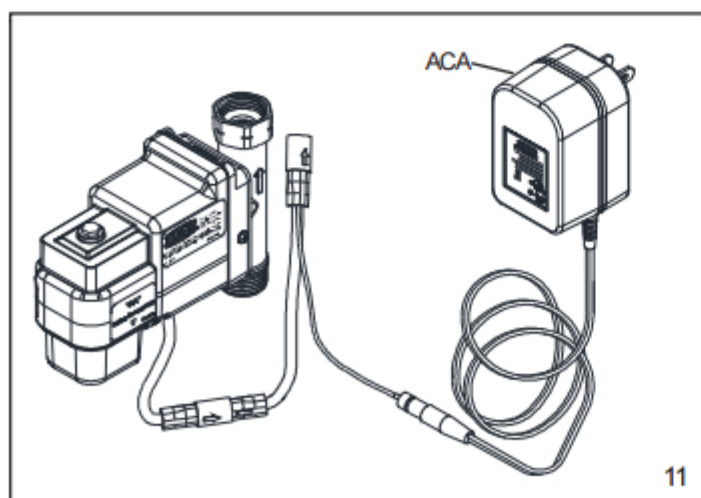
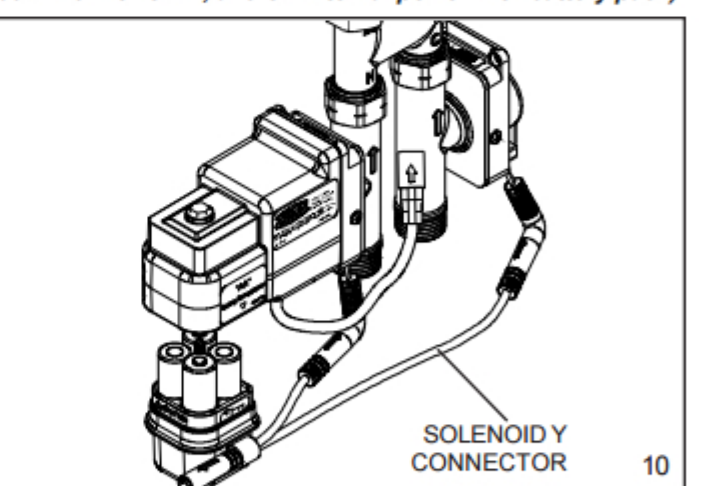
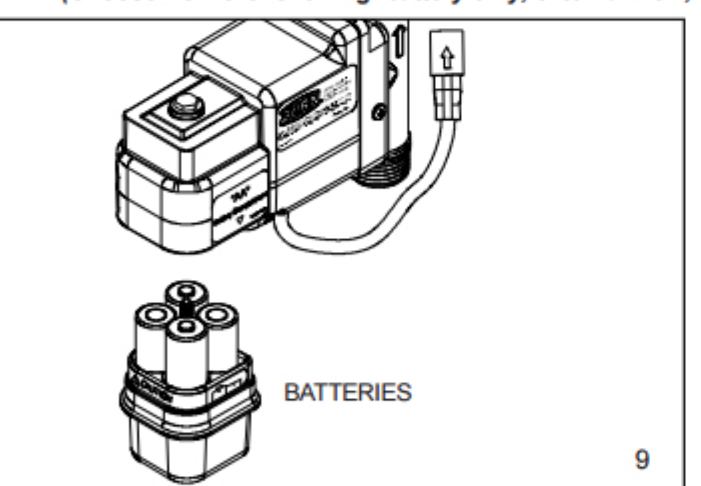

This General diagram and installation instructions are not intended for any specific model, but is presented as a general guideline for Installations!