



## INSTALLATION INSTRUCTIONS



## Product Description and Measurements

### Glass Vessel Sink and Waterfall Faucet Combo

- ☆ Exclusive Arsumo Collection
- ☆ Waterfall Faucet
- ☆ Glass Thickness: 12mm-19mm
- ☆ Diameter: 14"-17"
- ☆ For Above Counter Installation

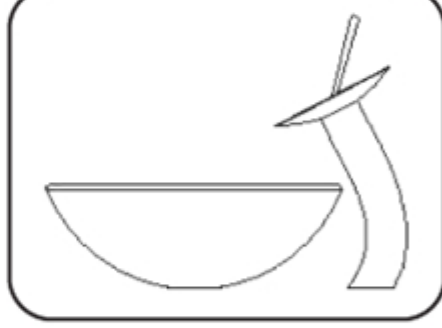

## Prior To Installation Steps

1. Unpack your new product and ensure that all the parts are included in the packing. keep the product in its original box until you ready to install it.
2. The counter top must be flat.
3. Shut off the water supply.
4. Observe all plumbing and building codes in your area.
5. It is recommended that installation of the product be done by a professional plumber.

## Waterfall Faucet Installation

Please remember to turn off the hot and cold valves prior to installation.

**STEP1** Check to see that your set contains the following parts:

- The faucet
- Hot and cold waterlines
- One rubber washer
- One brass washer
- Two mounting screws

**STEP2** While holding the faucet facing you, locate the two larger openings at the base of the facet.

**STEP3** The left opening is for the hot water supply line and the right opening is for the cold water supply line.

**STEP4** Gently screw in the hot and the cold water lines. Make sure the waterlines are tightly screwed in place.

**STEP5** Insert the waterlines through the facet opening in the counter top and place the faucet on the counter top. Make sure the faucet is facing forward and is aligned properly.

**STEP6** From underneath the counter top, place the rubber washer first so that it sits on top of the metal washer. Be sure to align the openings on the washers with the openings on the faucet.

**STEP7** Tighten the brass nuts (located on the mounting screws) until the faucet is held tightly in place.

**STEP8** Connect the hot and cold water supply lines to the corresponding waters supply valves.

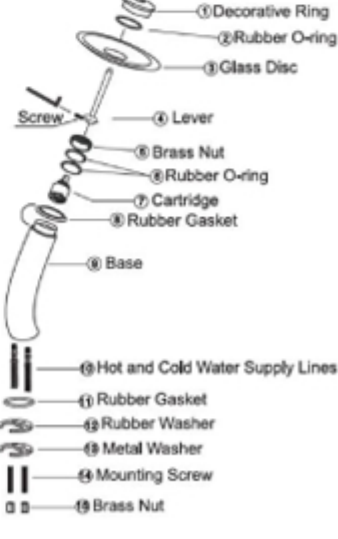

## Glass Vessel Sink and Waterfall Faucet Combo

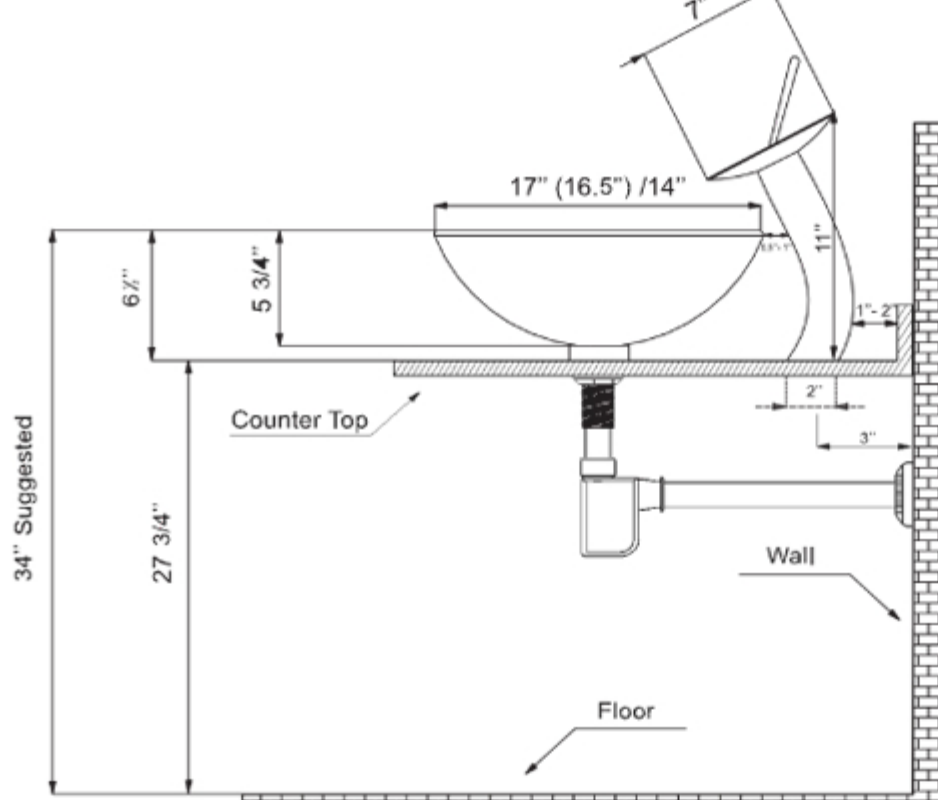

## Suggested Dimensions for 14" & 16.5" Vessel

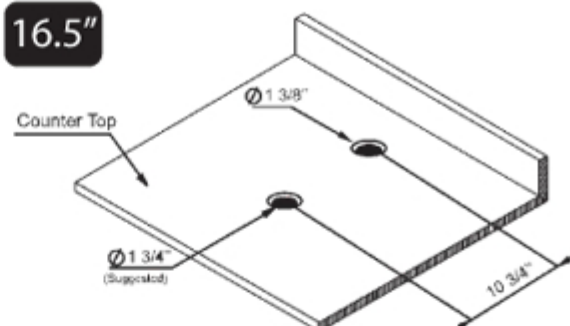
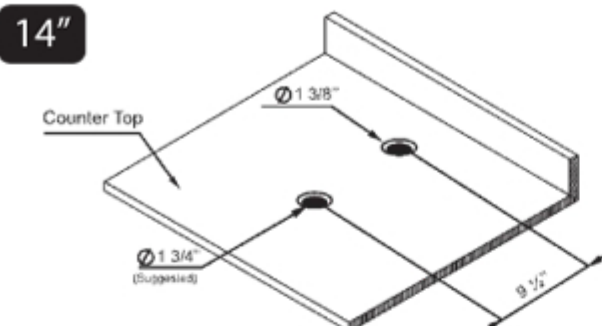

STEP1

## Installation Instructions

STEP1

Prepare the counter top by drilling a 1 3/4" diameter drain hole at the desired location. Prepare the counter top by drilling a 1 3/8" diameter faucet hole. Place the vessel on counter top as shown below.

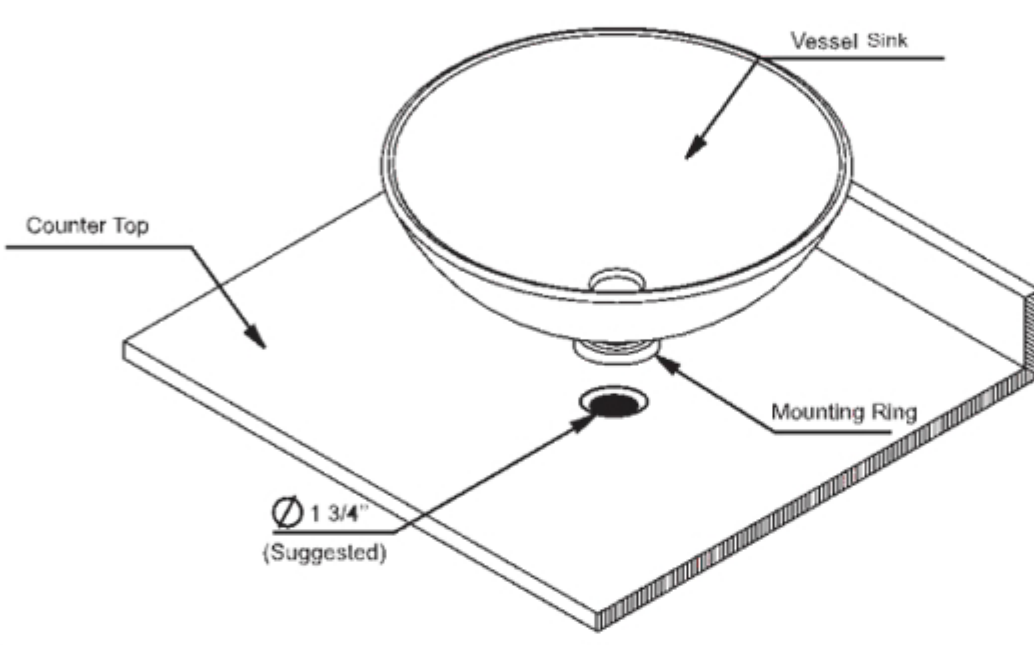

STEP2

## Pop Up Drain & Mounting Ring Installation (ONLY IF INCLUDED)

STEP2

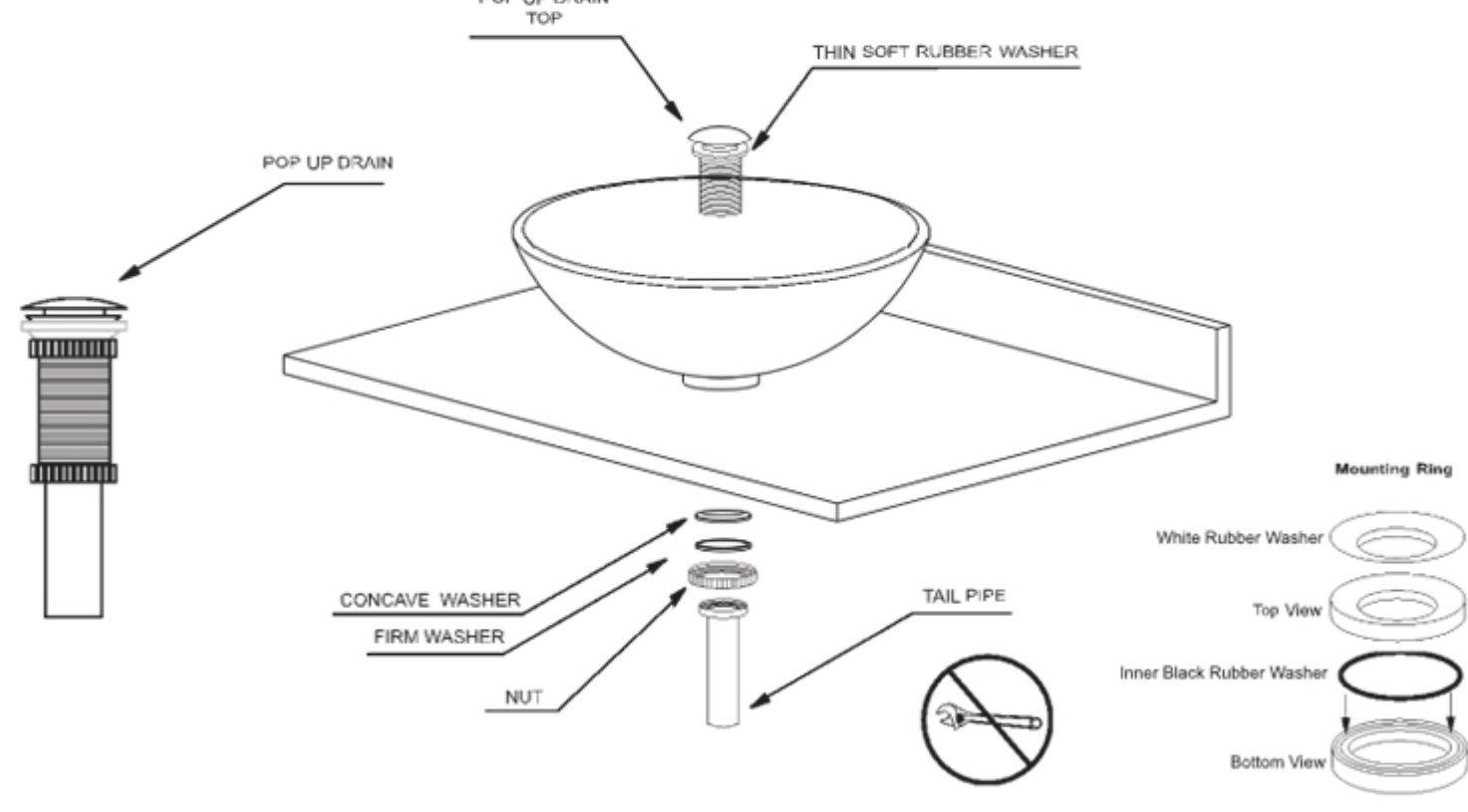

STEP3

STEP3

## Glass Vessel Sink and Waterfall Faucet Combo

