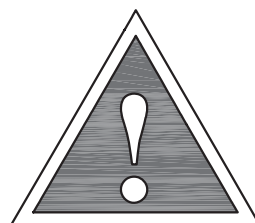
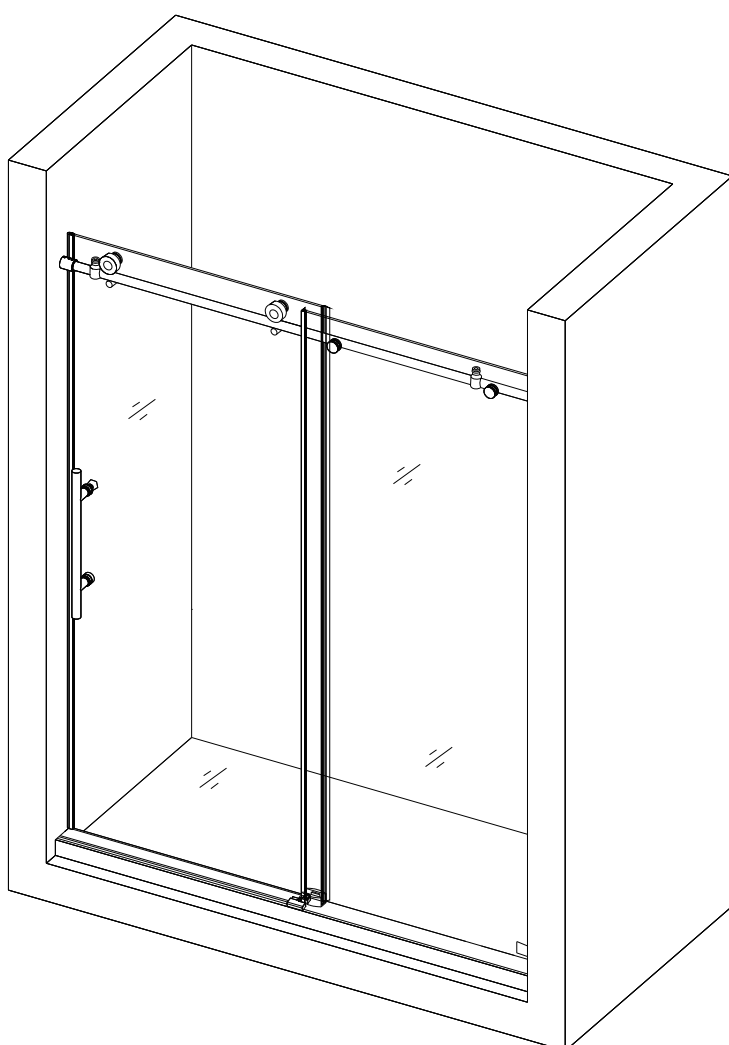

SHOWER ENCLOSURE HANGING WHEEL SLIDING DOOR INSTALLATION INSTRUCTIONS

**Model: SSD6076-08CH-nosoft / SSD6076CH-nosoft /
SSD6076-08BN-nosoft / SSD6076BN-nosoft /
SSD6076-08MB-nosoft / SSD6076MB-nosoft /
SSD6076-08BNG-nosoft / SSD6076BNG-nosoft**

**Maintenance tip:**

The following substances or articles may cause physical harm and/or damage the shower door.

Do not use them for cleaning:

Acid and alkaline solvents, chemicals such as hydrochloric acid, acetone thinner, solvents, cleansers, or polishers, nylon brooms or sandpaper.

Our product may have changes without prior notice

Important Note

Attention:

The Glass Shower doors include with anti-shatter film-on the reverse side of the certification printed logo.

See the Fig1 & Fig2

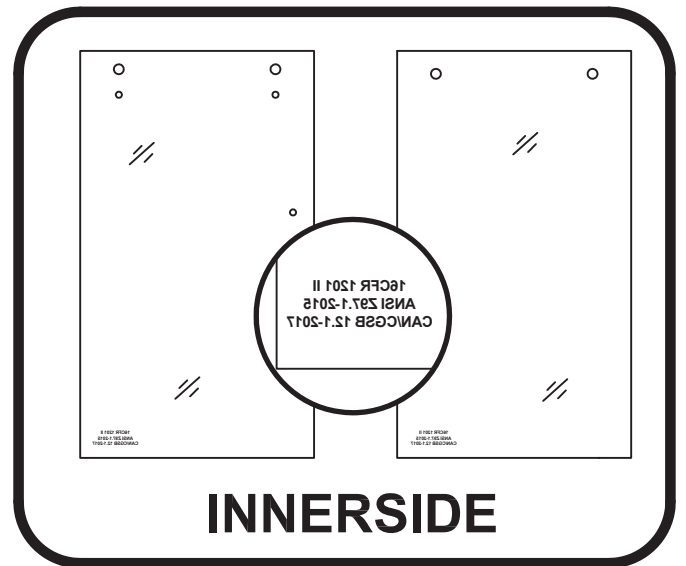

Fig 1

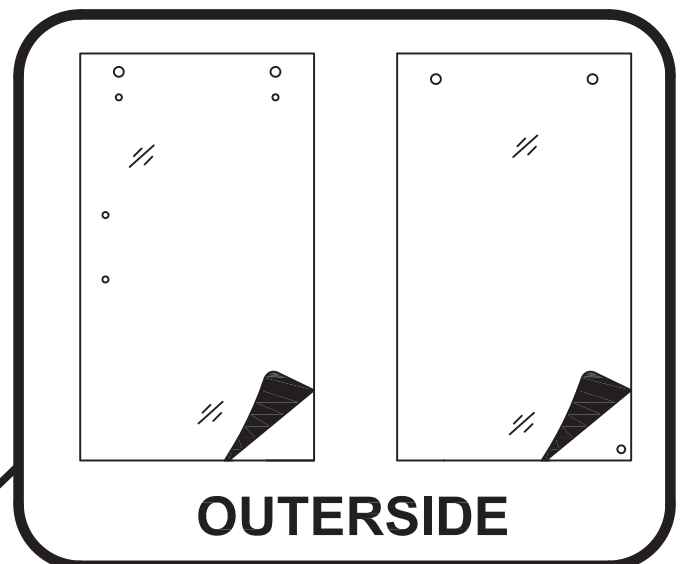
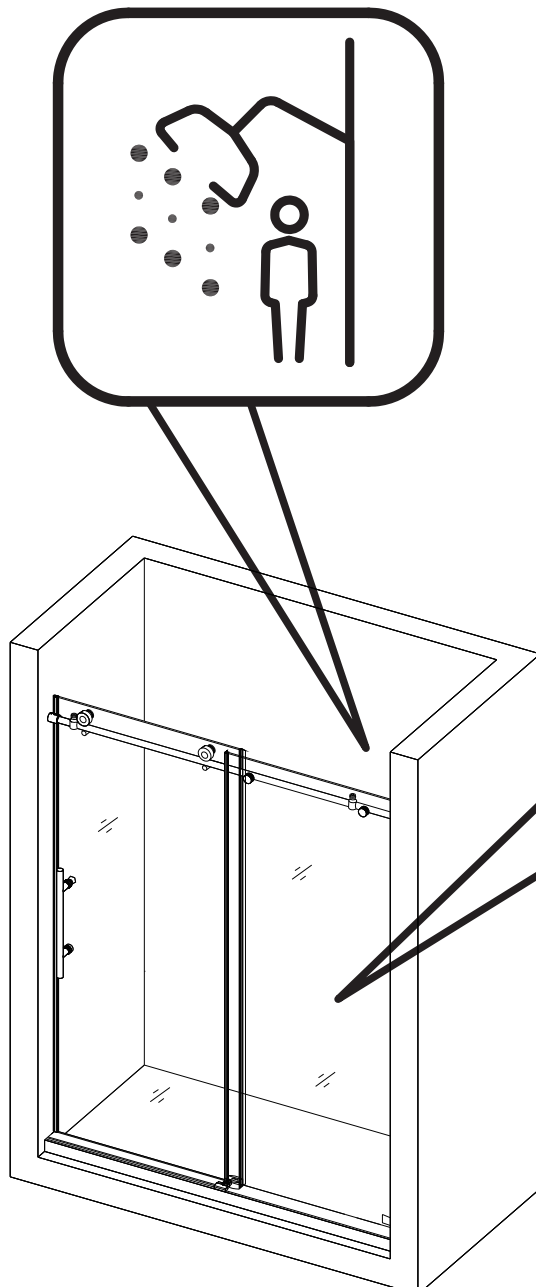
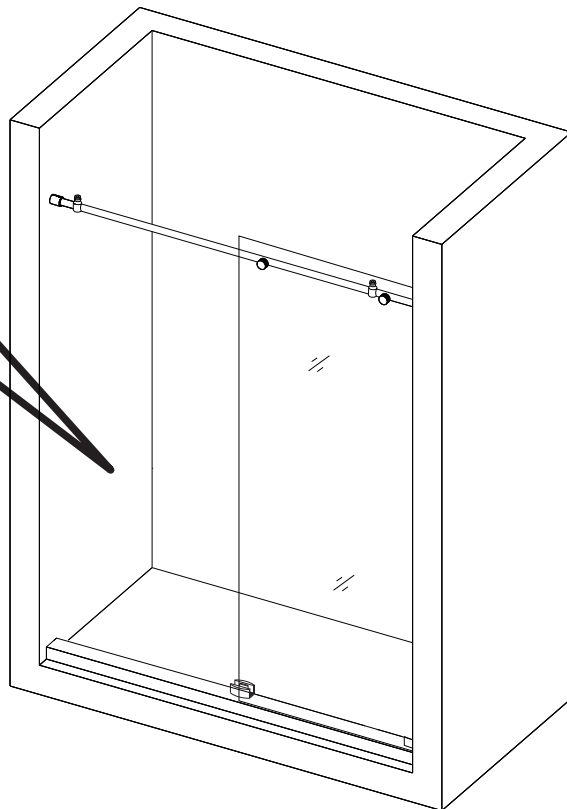
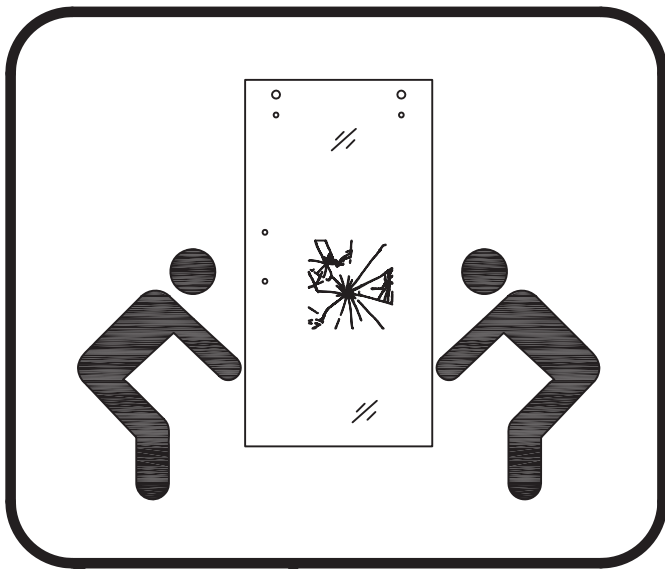

Fig 2

With anti-shatter film helps to hold glass in place in the event of breakage. So as to prevent the glass shatter will hurt the user. Allowing the panel to be carefully removed by a professional at a later date.



In the event of breakage please follow the steps below.

- 1. If someone is inside the shower, move the panel slowly out of the way and exit the bathroom as soon as possible. Do not allow anyone to re-enter bathroom until prepared to remove and dispose of broken panel.**
- 2. Utilize safety precautions such as a hard-hat, safety glasses, leather gloves, proper footwear and moving blankets to minimize risk of injury.**
- 3. It is recommended that two people assist in the removal of the panel. One person to hold panel steady, and the other to un-install the hardware. Then carefully remove glass from shower and lay flat on cardboard or plywood until it can be removed. Once laying flat, a razor knife or box cutter can be utilized to cut the film and remove in smaller pieces.**

PREPARATION

1. WE STRONGLY RECOMMEND THAT A LICENSED AND INSURED PROFESSIONAL CONTRACTOR TO INSTALL THIS PRODUCT INCLUDING THE ASSISTANCE OF A SECOND PERSON DURING INSTALLATION.
2. After opening all boxes and packages, read this introduction carefully. Check that all of the needed parts are included in the package by marking all the components on the "Detailed Diagram of Shower Door Components". Examine boxes and packages for shipping damage. If the unit has been damaged, has a finishing defect, or is missing parts, please contact our customer support department to be served immediately. Please note that We will not replace any damaged products or missing parts free of charge after 5 business days or if the product has been installed. Feel free to contact your local distributor if you have any questions.
VERY IMPORTANT: Please double check the glass corner and four edges of the glass door and fixed panel to make sure that all the glass are in perfect condition and without any breakage. Please do not try to install the shower door, if there is breakage to the glass corner.
3. Please note that you should consult your local building codes with questions on installation compliance standards. Building and plumbing codes may vary by location, and We are not responsible for code compliance standards for your project and will not accept any returns.
4. Prior to installation, ensure that the installation surface is leveled and solid and will be able to support the total weight of the unit. Also, make sure the walls are at the right angles. Irregular installation surface level or improper angle of side walls will result in serious problems during installation. Please, note that some adjustments and drilling might be necessary during the installation process.
5. **NOTE!** This door does not have out-of-plumb adjustment. Make sure your walls are at right angles.
6. This door requires a minimum 2 3/4" wide threshold, base or installation space. Please note that Step 6 calls for installation of the door to the wall using anchors. However, the manufacturer strongly recommends installing these heavy doors to the studs or to preinstalled 2" x 4" wood reinforcements behind the wall and attach the Wall brackets to it.

ATTENTION: THIS DOOR IS EXTREMELY HEAVY AND REQUIRES PROFESSIONAL INSTALLATION. INSTRUCTIONS ARE GIVEN FOR THE SHOWER DOOR INSTALLATION. PLEASE, FOLLOW THE SAME INSTRUCTIONS TO INSTALL THE GLASS DOOR. INSTRUCTIONS THAT, IF IGNORED, COULD RESULT IN DEATH OR SERIOUS PERSONAL INJURY CAUSED BY INCORRECT HANDLING OR INSTALLATION OF THE PRODUCT. THESE INSTRUCTIONS MUST BE OBSERVED FOR SAFE INSTALLATION.

TOOLS REQUIRED



Soft Cloth
or Blanket

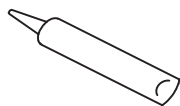

Caulk

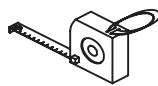

Tape
Measure

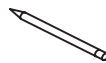

Pencil

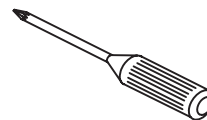

Phillips
Screwdriver



Drill Bit
=ø8



Safety Glass



Level

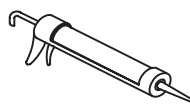

Caulk Gun



Drill

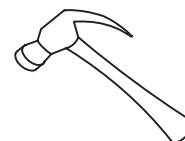

Hammer

OTHER TOOLS MAY BE REQUIRED

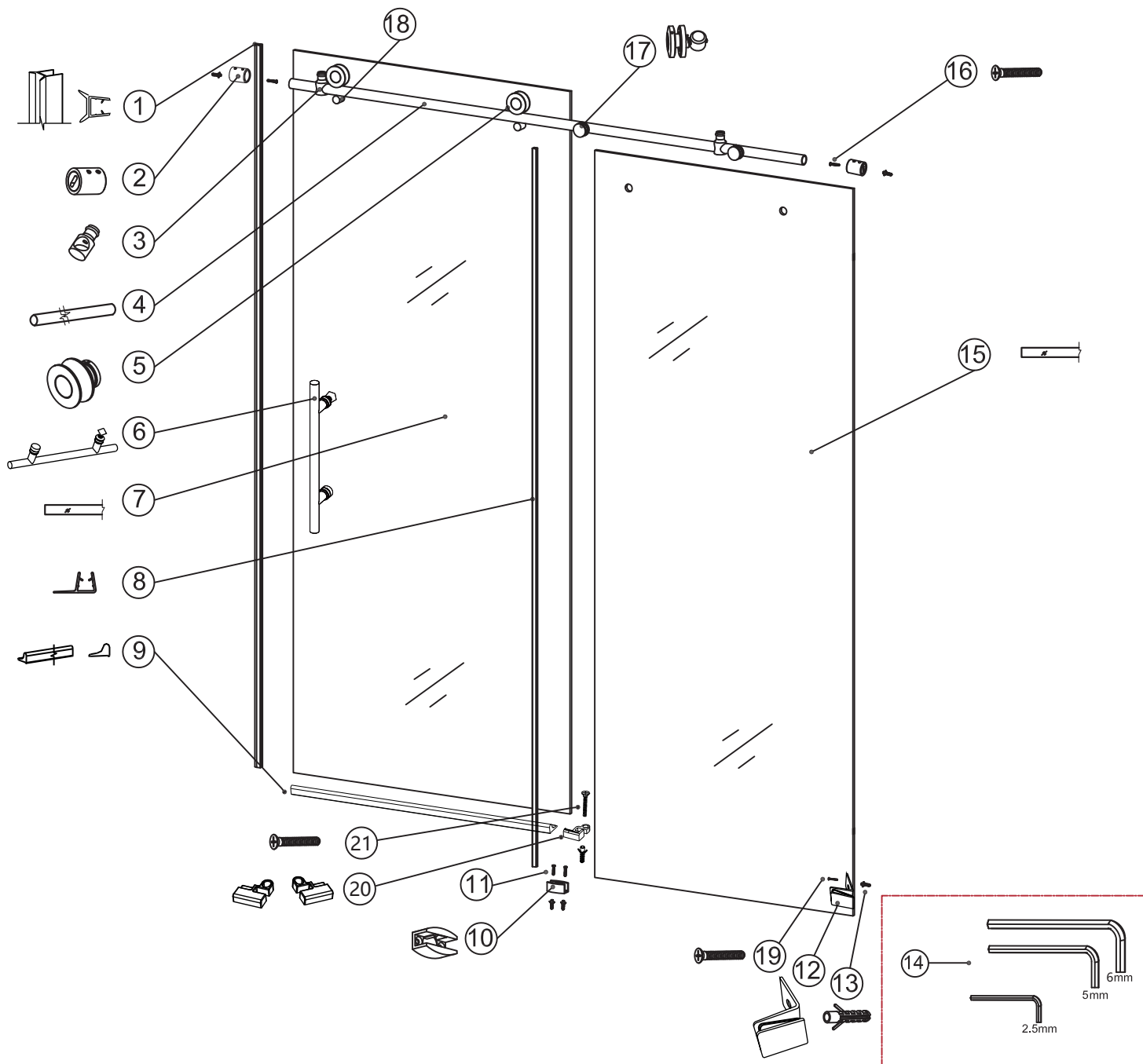

| No. | Description | QTY | No. | Description | QTY |
|-----|-----------------------|-------|-----|---|-------|
| 1. | Bumper Strip | 1 pc | 12. | Floor Mount Clamp | 1 pc |
| 2. | Guide Rail Bracket | 2 pcs | 13. | Wall Anchor (Corresponding to screw size) | 7 pcs |
| 3. | Glass Door Stopper | 2 pcs | 14. | Allen Key | 3 pcs |
| 4. | Upper Guide Rail | 1 pc | 15. | Fixed Glass | 1 pc |
| 5. | Roller | 2 pcs | 16. | Screw M5X40 | 2 pcs |
| 6. | Handle | 1 pc | 17. | Glass Bracket | 2 pcs |
| 7. | Door Glass | 1 pc | 18. | Safety Pin | 2 pcs |
| 8. | Side Anti-Water Strip | 2 pcs | 19. | Screw M4.8X32 | 1 pc |
| 9. | Anti-splash Threshold | 1 pc | 20. | Cover(optional) | 2 pcs |
| 10. | Guide Block | 1 pc | 21. | Screw M4X25 | 2 pcs |
| 11. | Screw M4X30 | 2 pcs | 22. | | |

TEAR OFF THE PROTECTIVE SOFT FILM ON THE GLASS WITH LABEL STICKERS BEFORE INSTALLATION

If there are no structural limitations in the shower room,
we recommend the installation as shown " ✓ " below

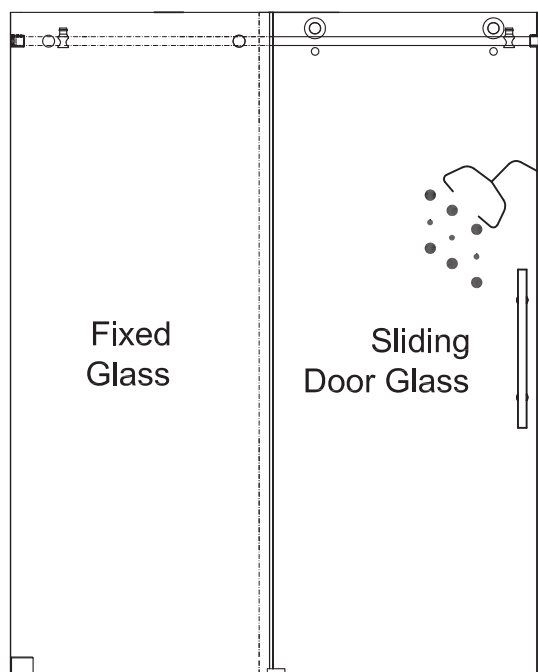
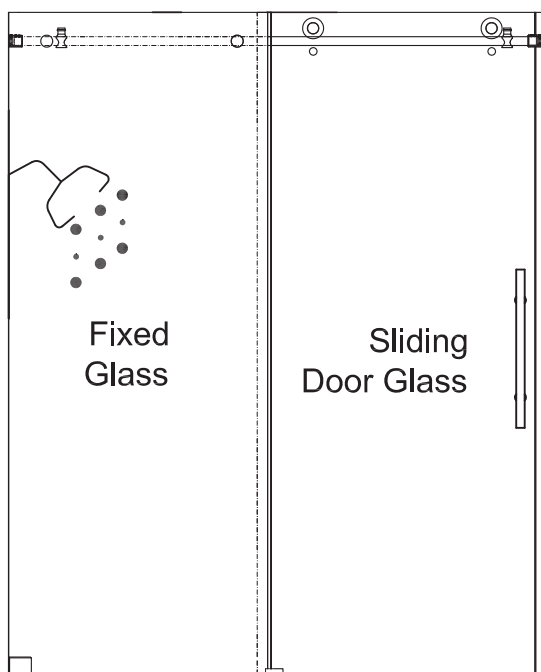
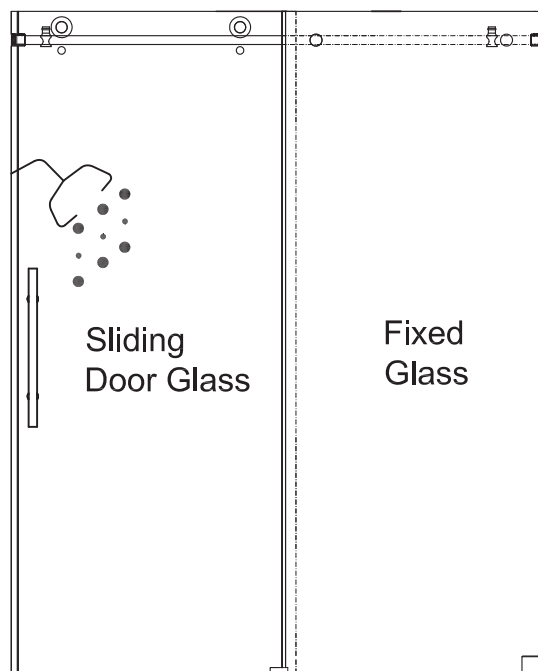
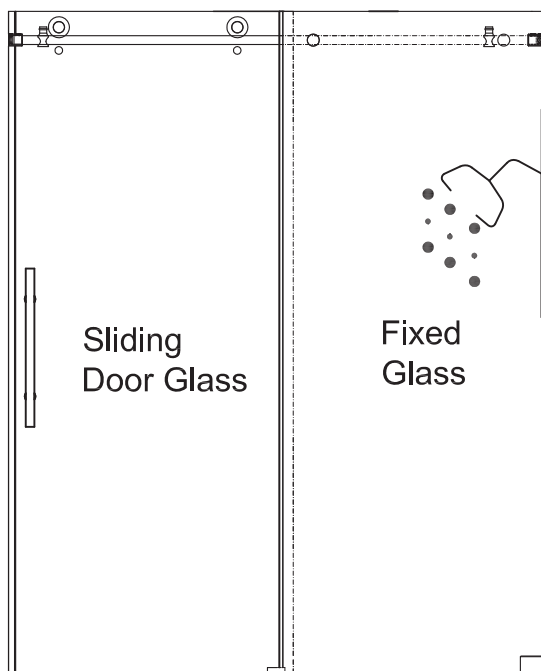

TIPS

01:

Open the packaging carefully and inspect all the necessary parts using detailed diagram and component list in your manual as a reference. Before discarding the carton, check for small hardware bags that tend to fall to the bottom of the box. If any parts are damaged or missing, please contact us for replacement.

02:

Retain these installation instructions for future use if in need.

1. Measure the distance between two finished walls. This distance is marked as W.

Please see Fig 1 for details:

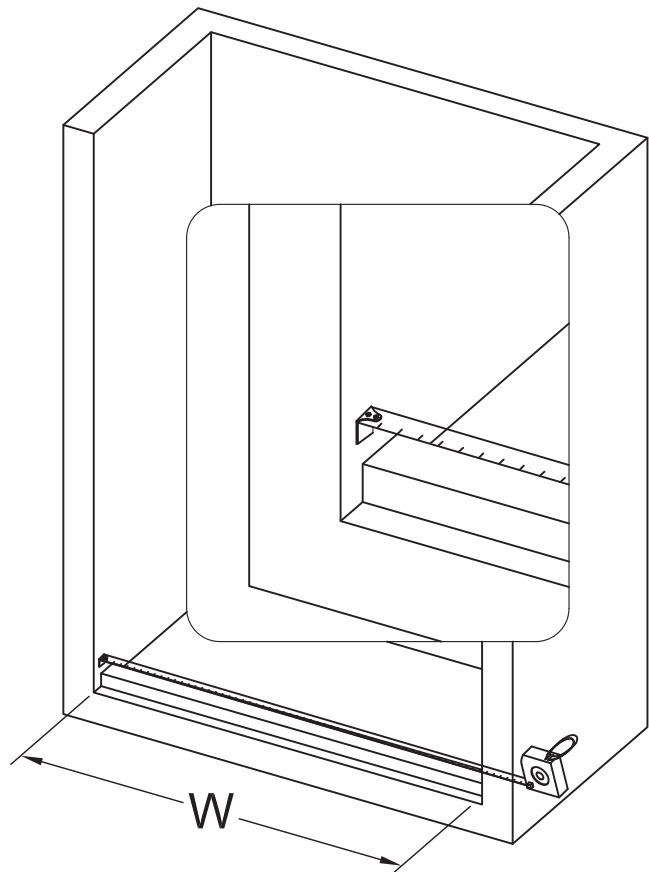
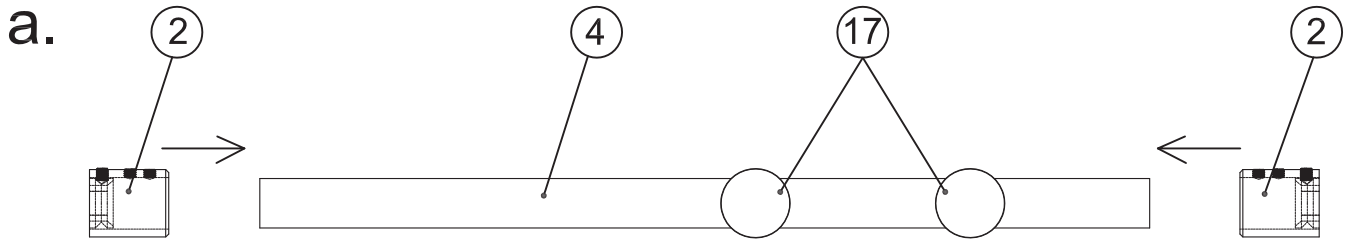
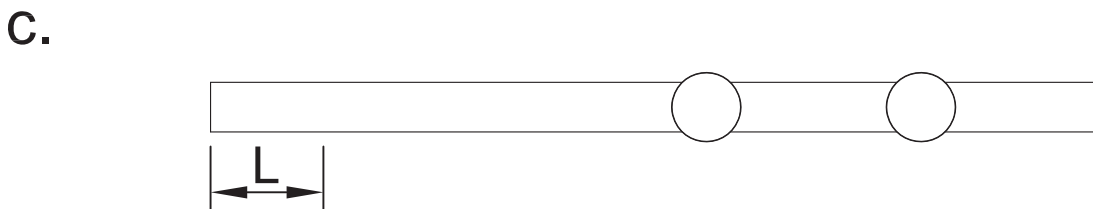
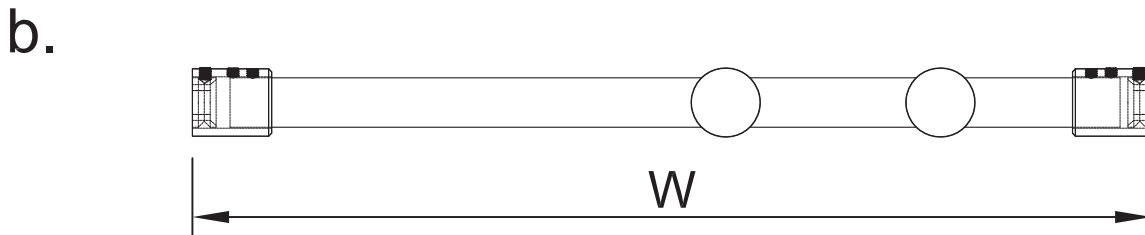

Fig 1



Note: The Glass Brackets(17) have been pre-installed to the Upper Guide Rail(4).



2. Your Upper Guide Rail (04) has been precut for your Shower model opening width, eg. 60" for shower width.

If W-width of your wall-to-wall opening is equal to the size of your Shower model, it is unnecessary to cut the Upper Guide Rail and you can continue to Step 3.

If W-width of your wall-to-wall opening is less than the size of your Shower model, you will need to cut the Upper Guide Rail from the end which is farther from the Glass brackets (17) holes.

The length to cut off will be L:

$L = \text{Shower model size} - W$
 $L = \text{Subtract } W \text{ from the size of your Shower model.}$

FOR EXAMPLE

If your wall opening $W = 59"$. Your shower model is 60".

$L = 60" - 59" = 1"$,

You have to cut 1" off from the rail.

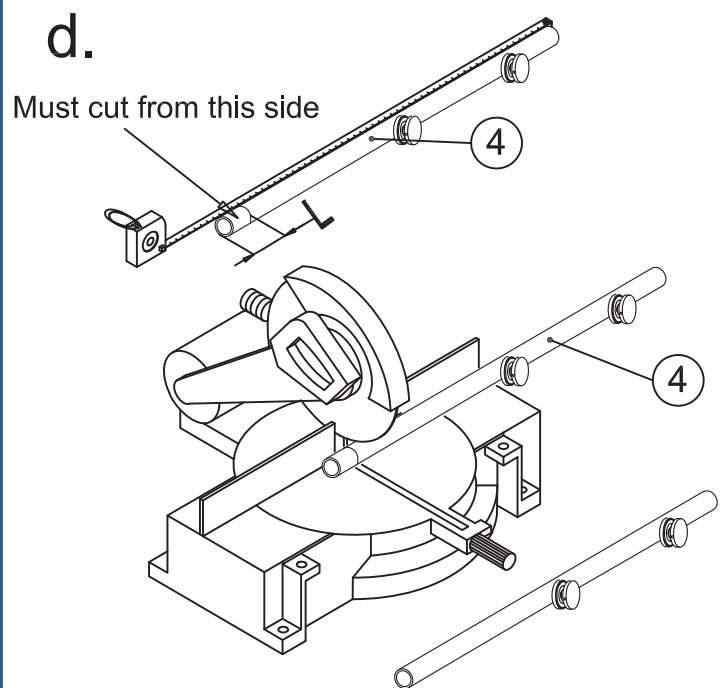

Fig 2

Please see Fig 2 for details

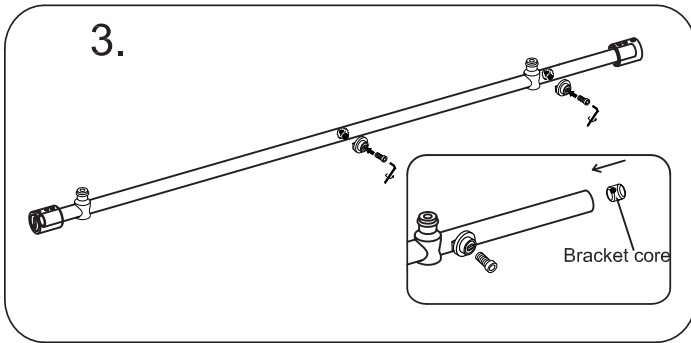
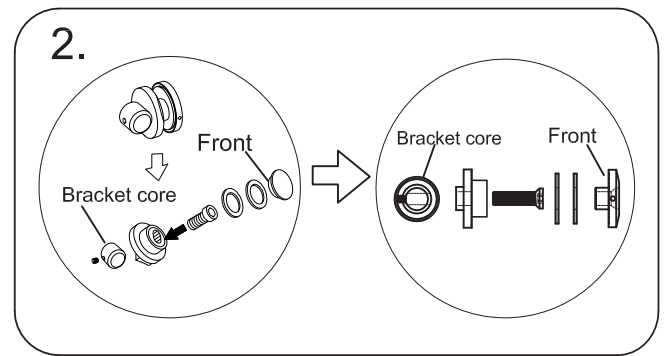
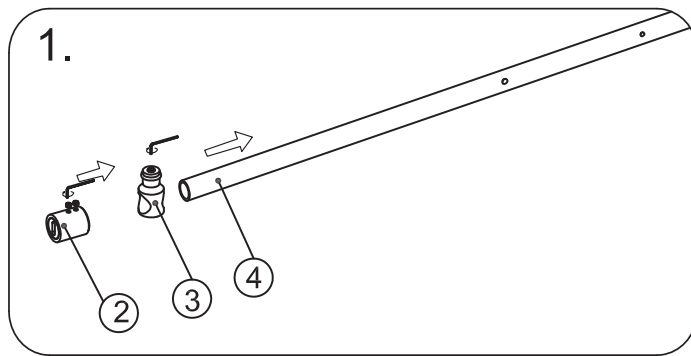

Fig 3

3. Use the Allen key (14) to loose the screw on the Guide Rail Bracket (02) and Glass Door Stopper (03). Slide the stopper and then the bracket to the Guide Rail (04), use the allen key to tighten the parts to the guide rail temporarily.

Disassemble the Glass Bracket (17), insert the bracket core inside the guide rail tube, push it slowly to make the hole on the core match the hole on the tube, then lock the bracket back side with Allen Key(14) .

See Figure 3 for details.

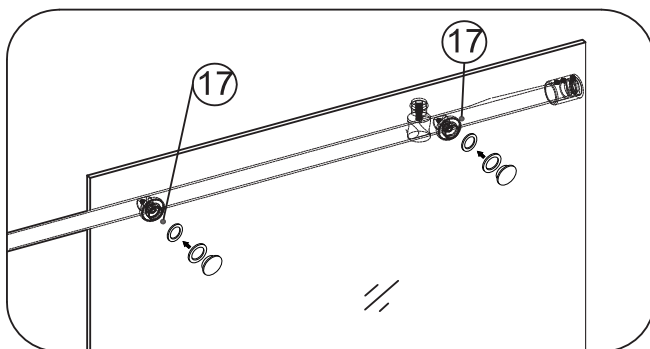

Fig 4

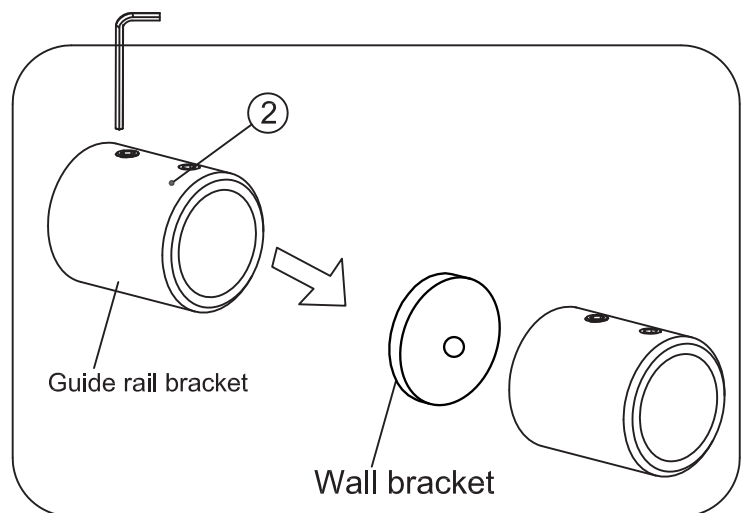

Fig 5

4. After finished installing the Upper Guide Rail(04), lock the glass bracket(17) so as to lock the Fixed Glass(15) to the Upper Guide Rail(04).

Please see Fig 4 for details

5.Install guide rail

5.1. Loosen the screw on Guide Rail Bracket (02), pull out the wall bracket.

Please see Fig 5 for details

6. Make a mark on a wall perpendicular to the ground at a height of 72.84 inches, then drill holes in the determined position and apply silicone into the holes, insert the Wall anchors (13) for the Guide Rail Bracket.

Mount the Wall Bracket of the Guide Rail Bracket (2) to the wall by using the Screw M5X40 (16). The other side of the Guide Rail bracket (2) is installed in the same way.

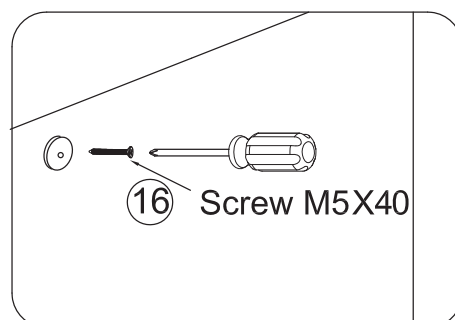
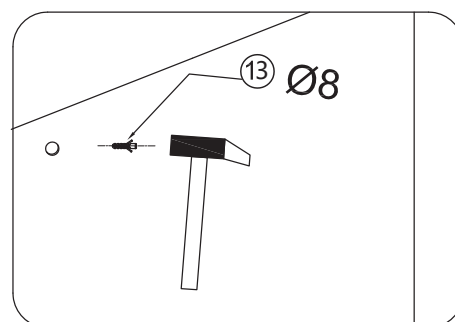
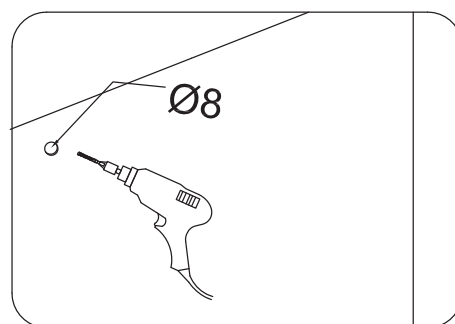
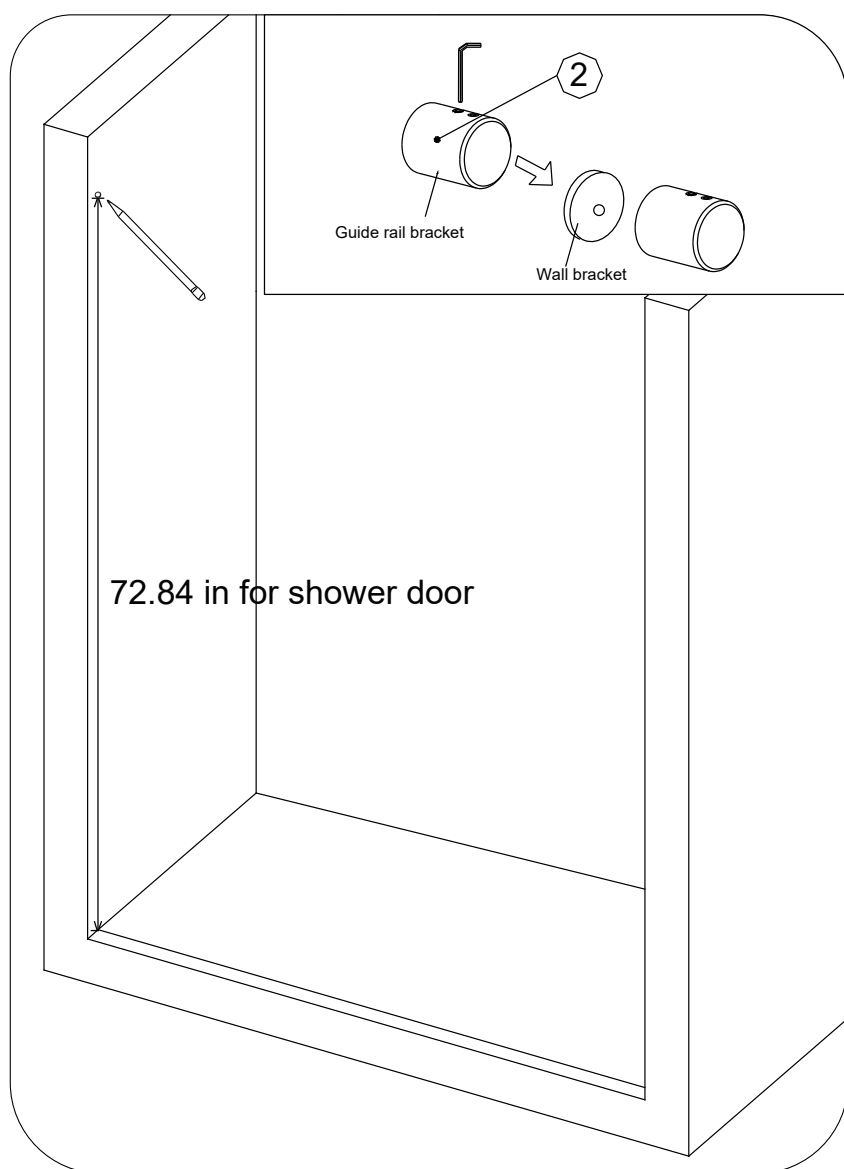

Tips: The other wall bracket is installed in the same way

7. Slide the guide rail bracket (02) to the two end sides of the guide rail, fixed the guide rail bracket to the wall bracket with hexagon spanner(14).

Please see Fig 6 for details

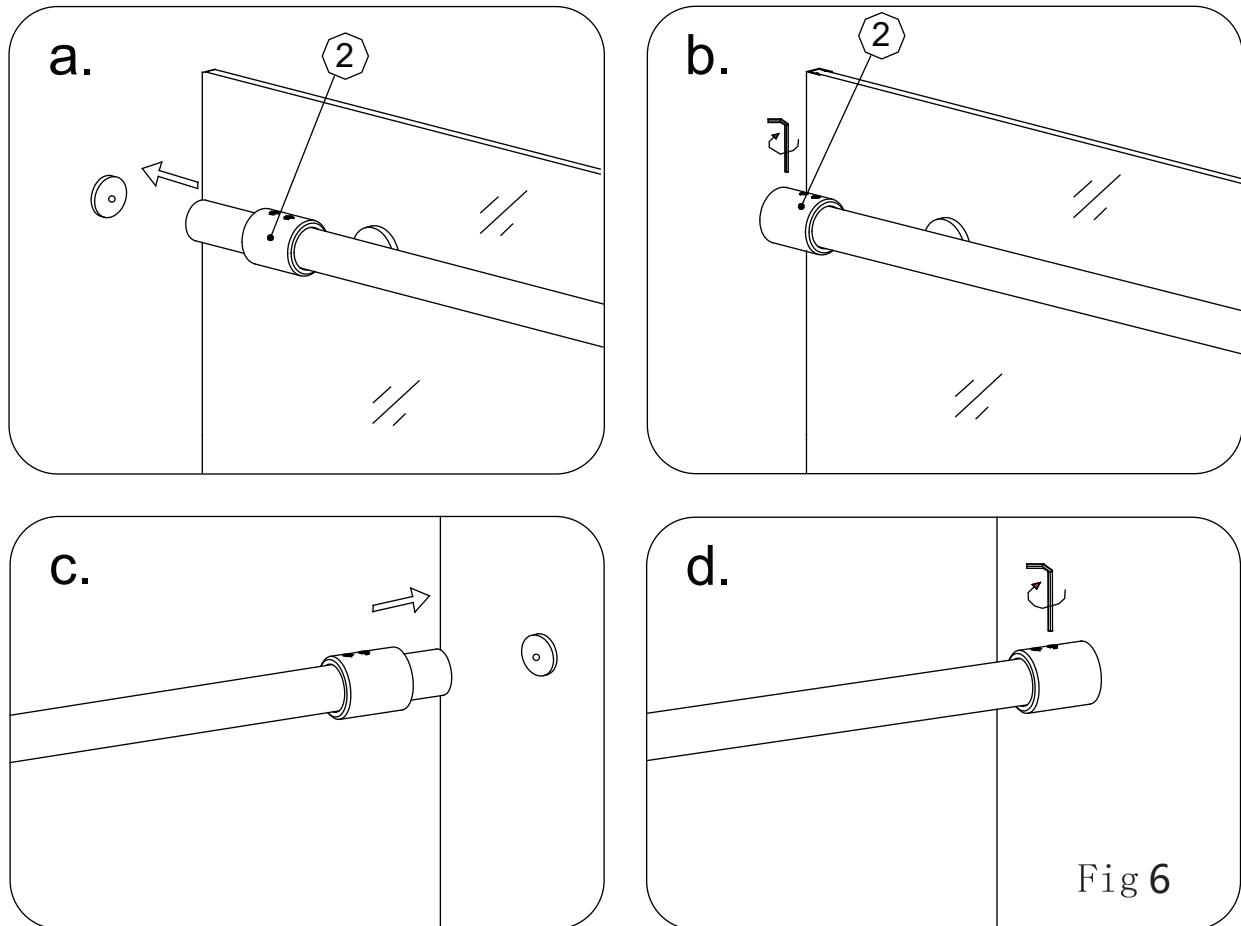

Tips:

1. the other side of the guide rail and guide rail bracket are installed in the same way.

8. Install Fixed Glass

8.1. Install Side Anti-Water Strip (8) on the side of Fixed Glass (15).

8.2. Disassemble the Floor Mount Clamp (12) and install the Floor clamp under the Fixed Glass (15).

8.3. Place the Fixed glass to the wall, level it and draw holes on the shower base/threshold and knock in Wall Anchors (13), then lock the Fixed glass to the wall by Philip's Screw M4.8*32(19).

Please see Fig 7 for details

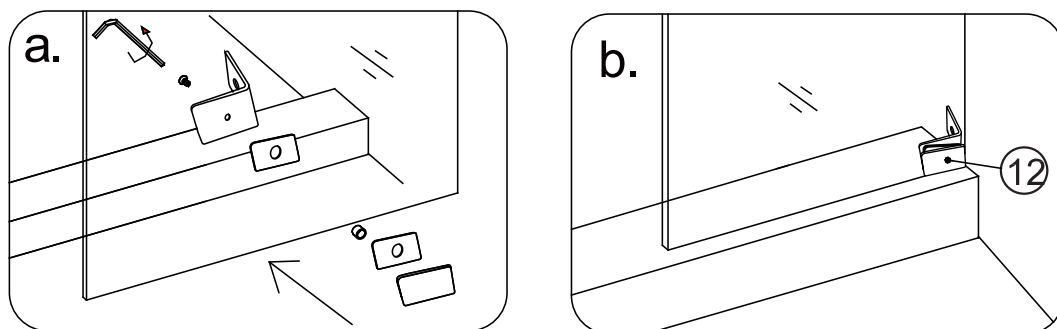

Fig7

9. Use drill bit to drill holes on the shower base/threshold and knock in Wall Anchors (13), then lock the Fixed glass to the wall by Philip's Screw M4.8*32(19).

Please see Fig 8 for details

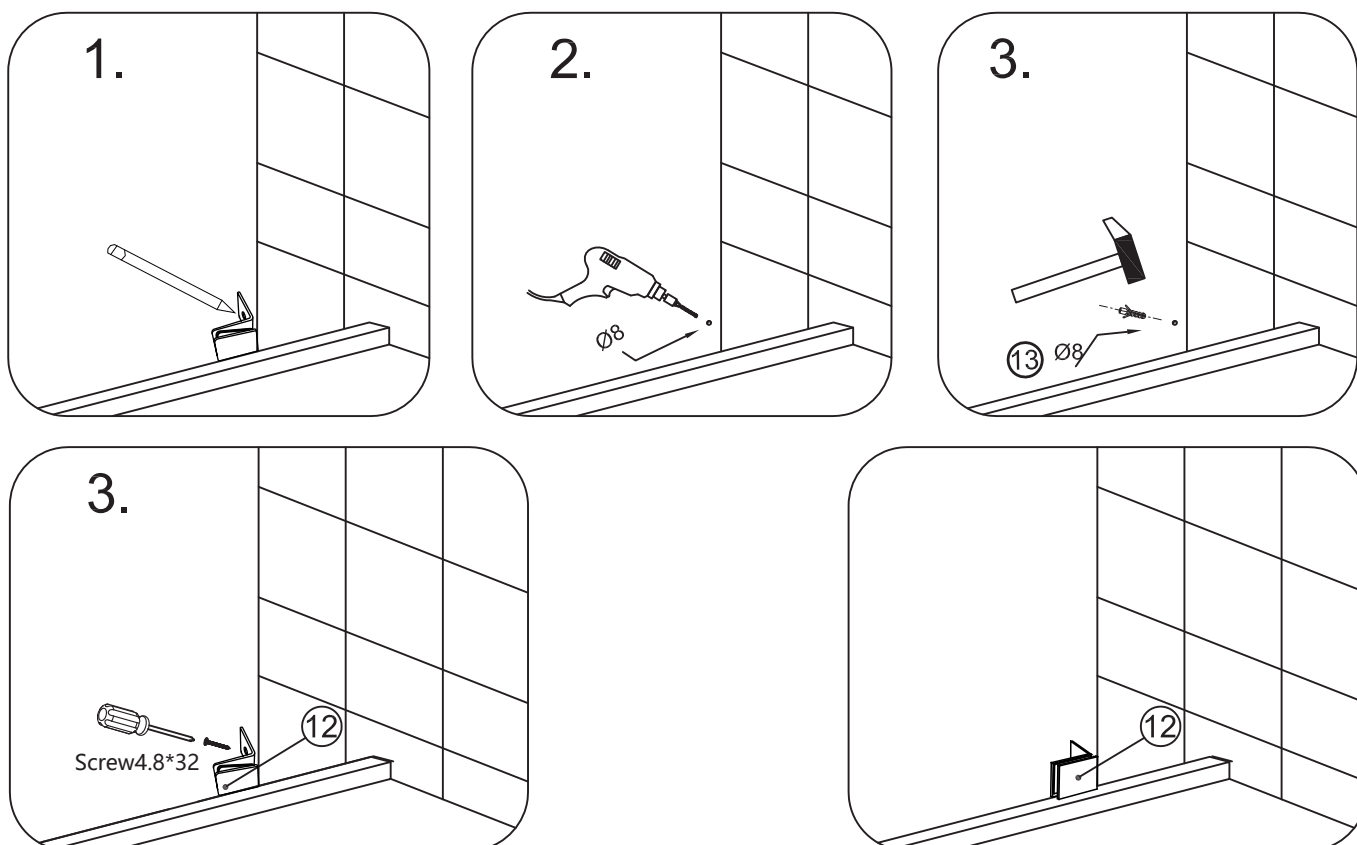
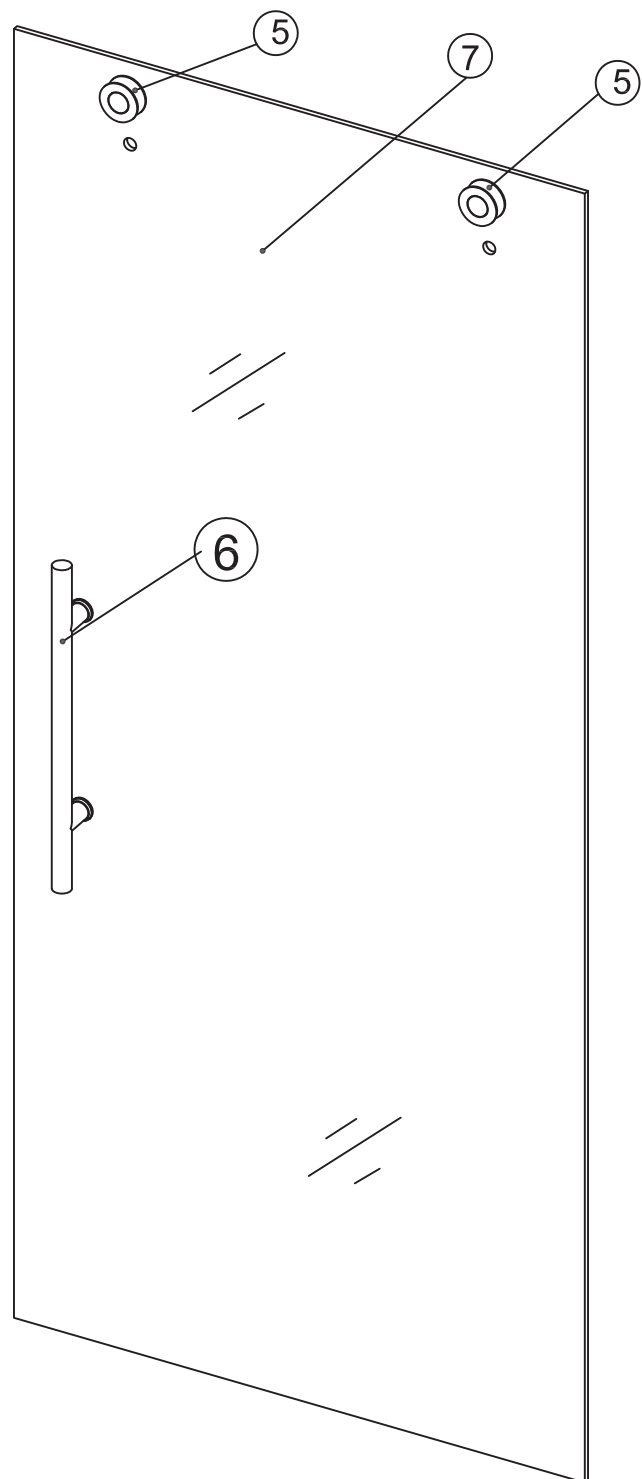
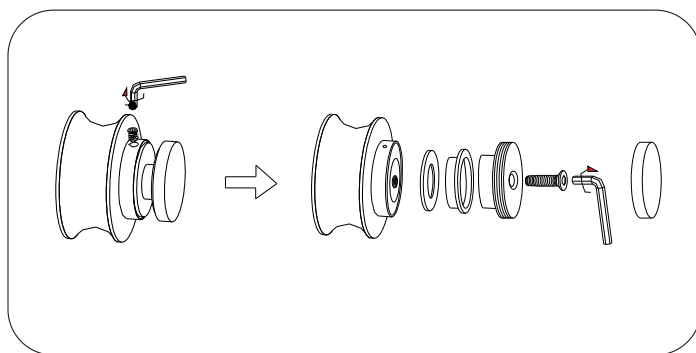
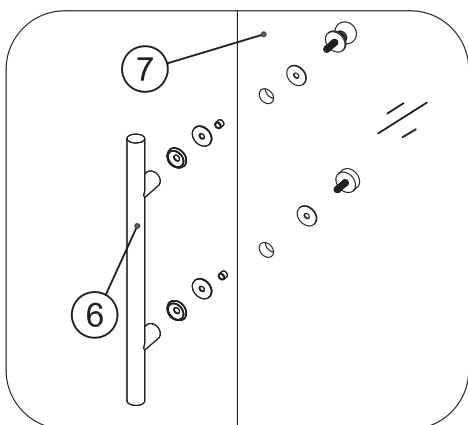
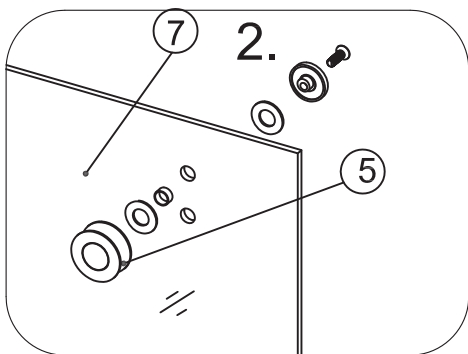
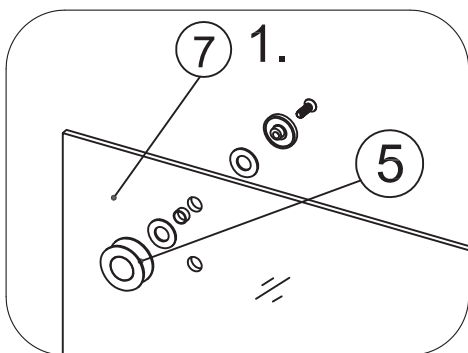

Fig8



10. Install Door Glass
 10.1. Install Rollers (05)
 10.2. Install Handle (06)

Please see Fig 9 for details

Fig 9

11. Rise the Door Glass(7) to make rollers hang to the top guide rail and place the glass bottom side to the Guide Block (10) slowly.
Make sure that the Glass Door (07) will slide in the guide block, outline the drilling position, install the guide block to the shower base/threshold.

Please see Fig 10 for details

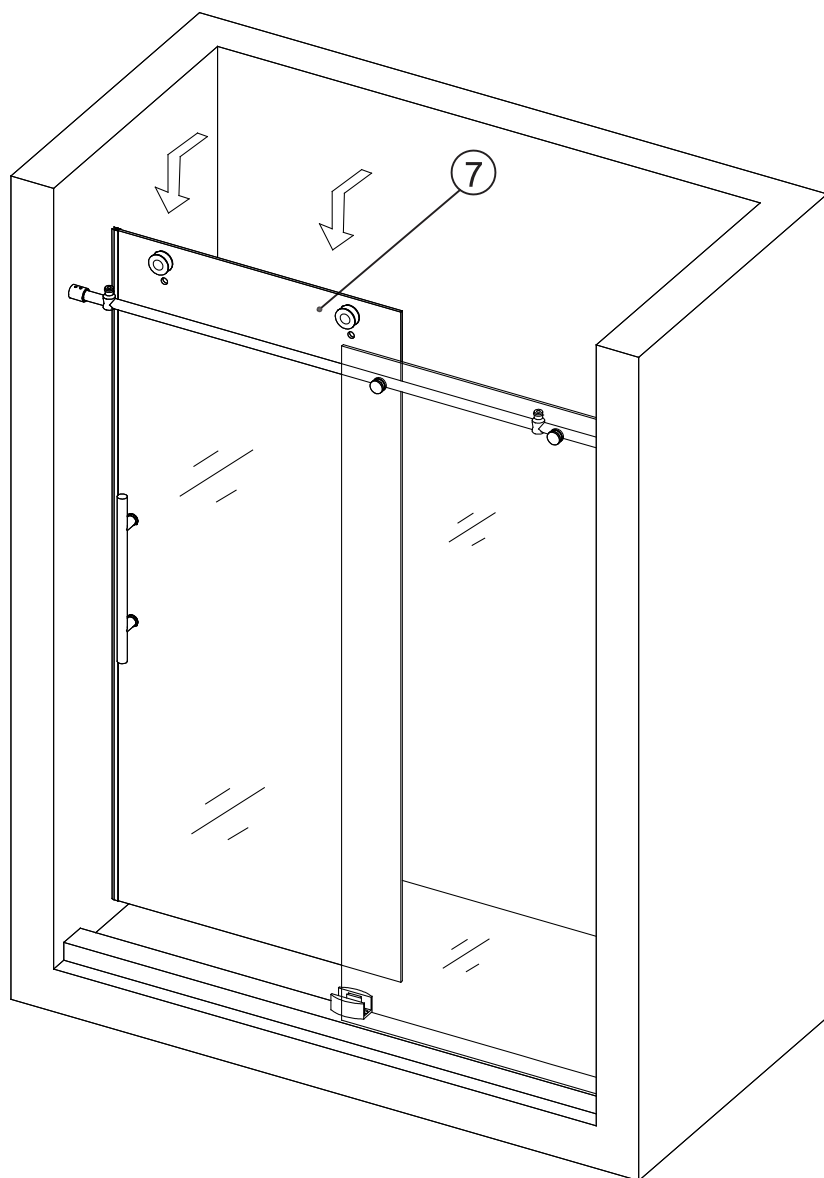
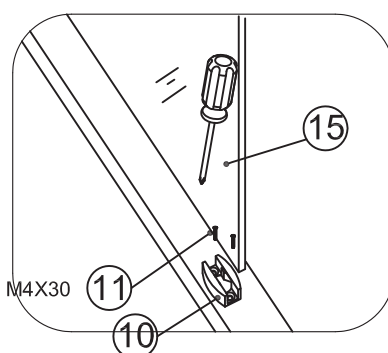
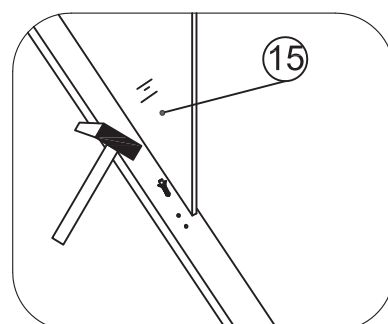
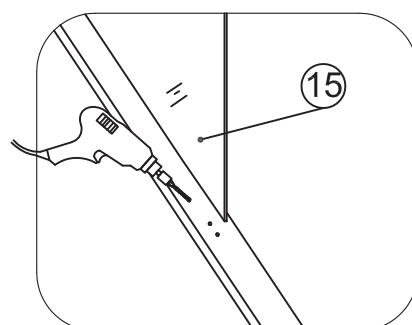
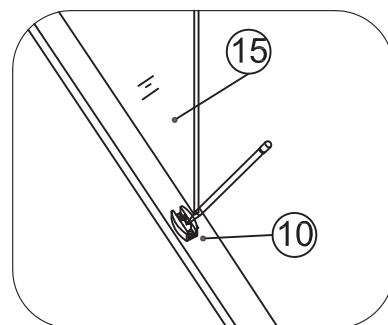
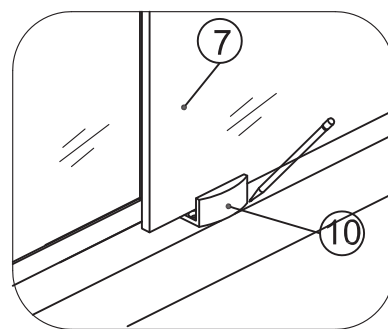

Fig 10



Screw M4X30

12. Install the Anti-Splash Threshold (9) in front of the Glass Door (7), and then put the Cover (20) with slot on head of the Anti-splash threshold (9), slot corresponds to the end of the Stationary Glass and inserts the Stationary Glass into the slot.

Mark down the predrilled holes, drill the holes with drill bit, put the wall anchor (13). Use M4x25 Screw (21) to install the Cover (20) at the drilling position then put silicone sealant to the bottom of the Anti-splash threshold (9), secure it to the floor.

Please see Fig 11 for details

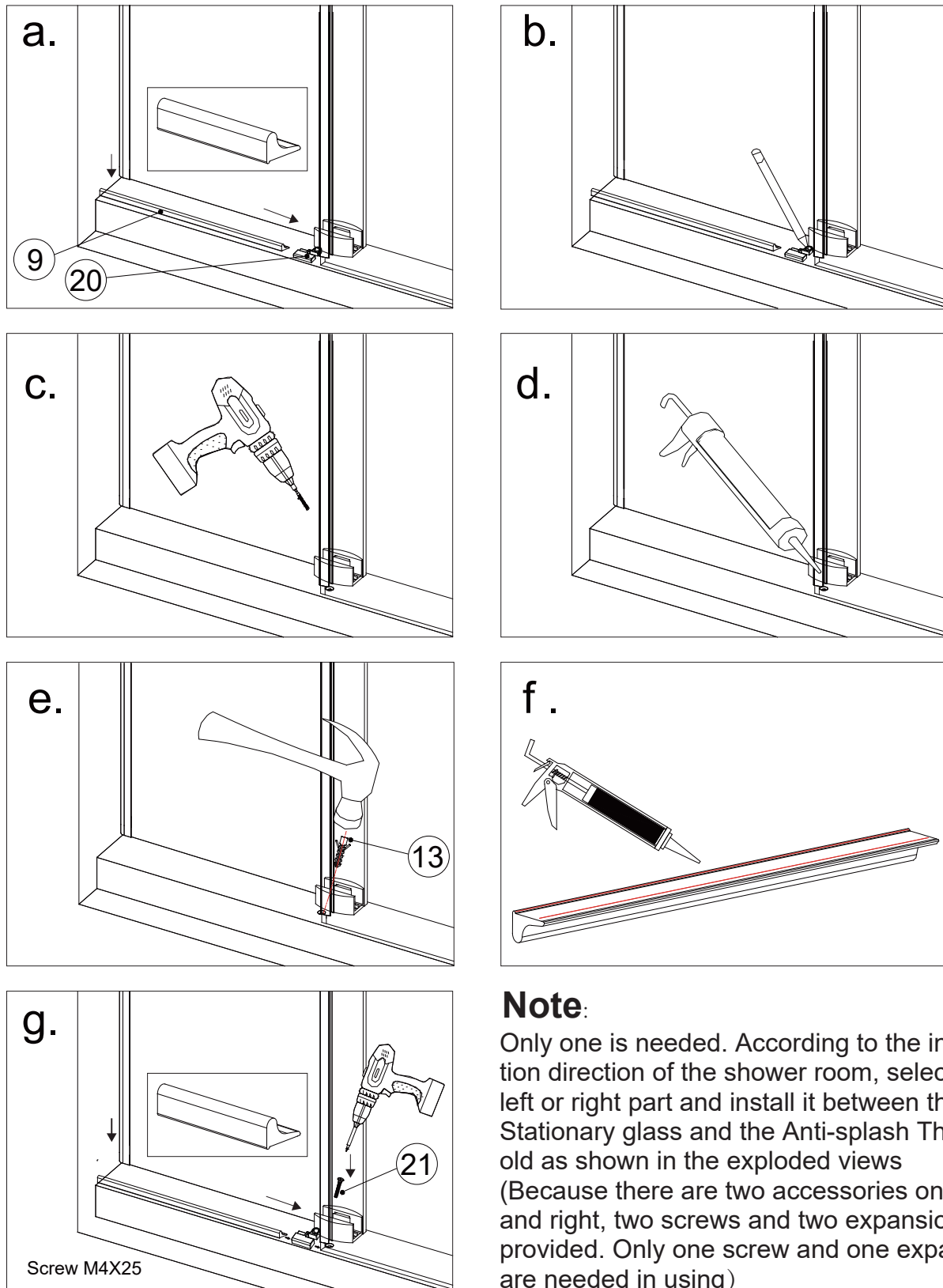

Fig 11

13. Install strips

Please see Fig 12 for details

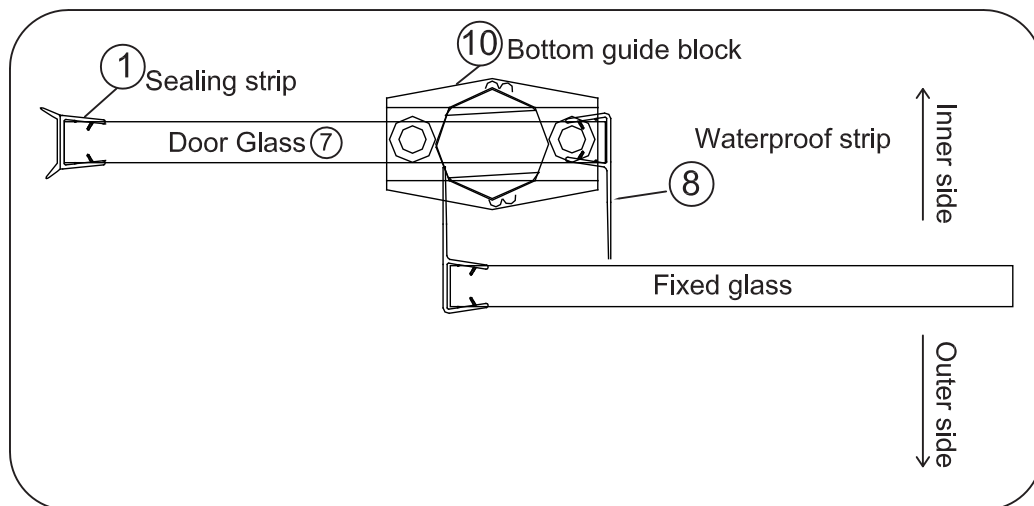

Fig 12

14. Install the safety pin

14.1. Make sure that the Glass Door with Rollers hangs to the Upper Guide Rail (04), and the glass bottom is inside the Guide Block (10), now adjust glass to vertical and then lock the Safety Pin (18).

Please see Fig 13 for details

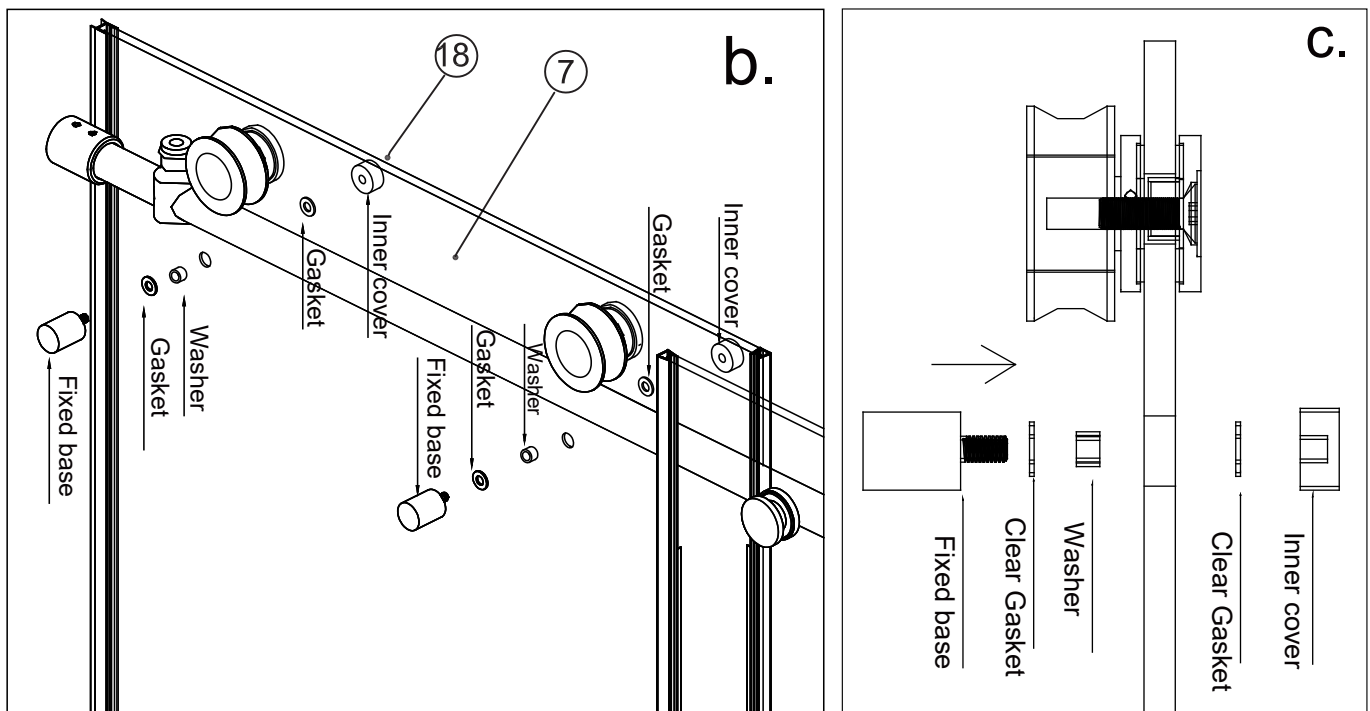

Fig 13

15. Adjust the roller and fix the Door Glass Stopper

15.1. Adjust the fasteners on both Rollers (05) to ensure that the bottom edge of the Door Glass (07) will not touch the bottom of the Guide Block (10).

8.2. Push the Door Stopper (03) close to the wall side, slide the Door Glass(7) to make Roller contact to the stopper and get perfect space then lock the stopper bottom screw.

Please make sure that the glass door especially the door corners will not hit the walls when closed and opened

Please see Fig 14 for details

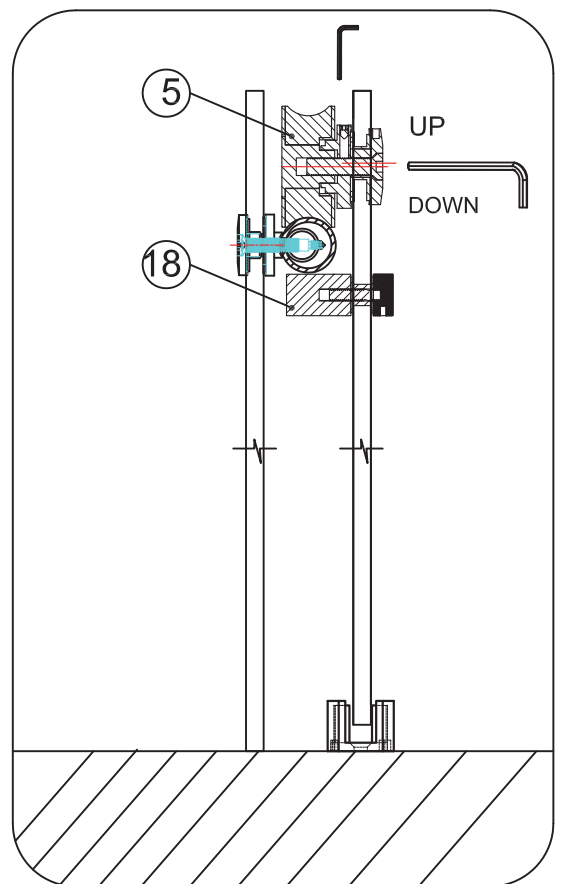
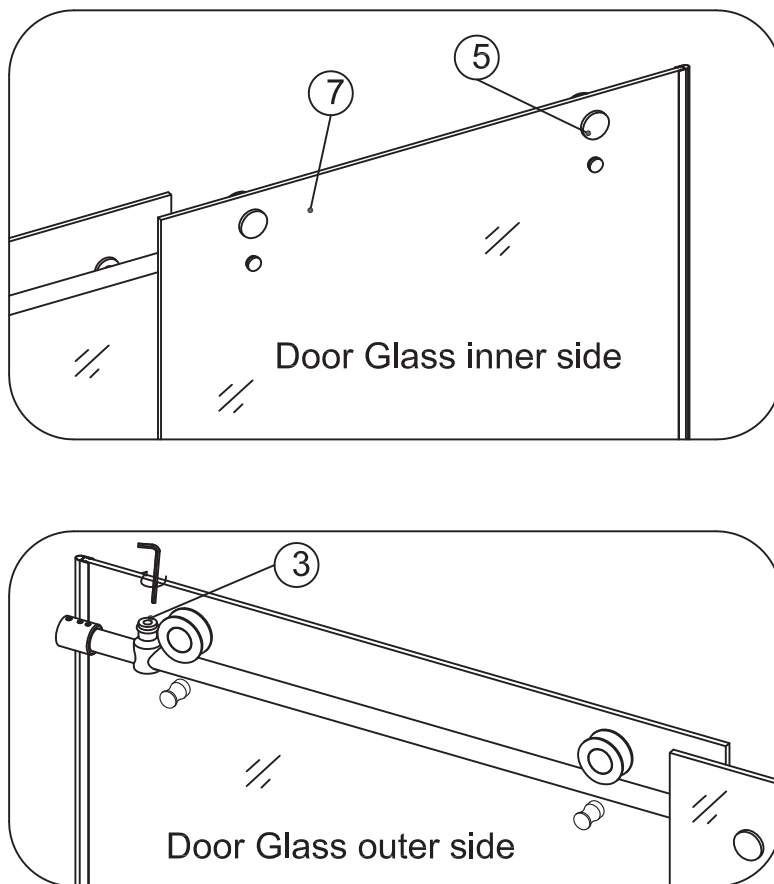

Fig 14

16. Install the anti-splash threshold

Put the Anti-splash Threshold (09) in front of the Door Glass (07) on the shower base/threshold, seal it to the shower base/threshold with silicone.

Please see Fig 15 for details

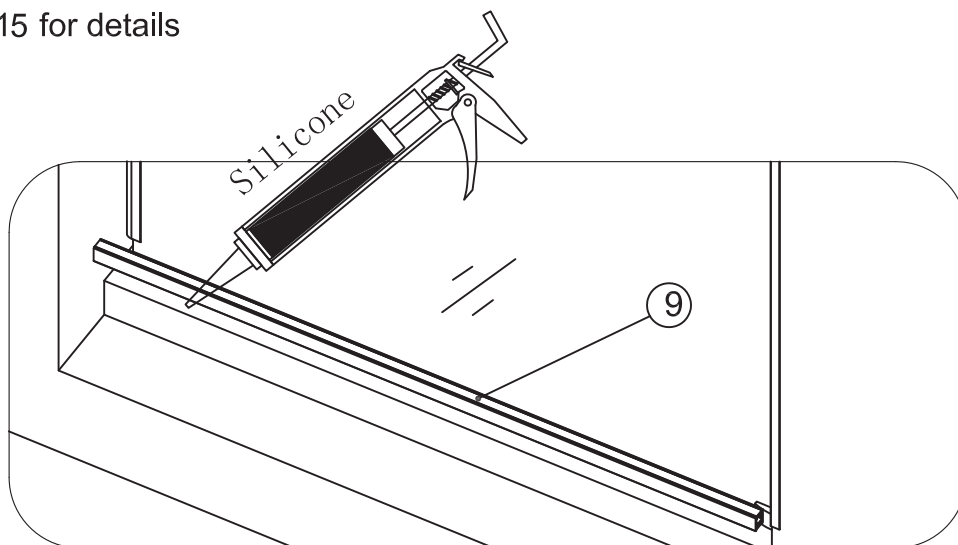

Fig 15

17. Apply the sealant on the seams between the bottom sealing strip and the shower base/threshold; and between the Fixed glass and wall.

Please see Fig 16 for details

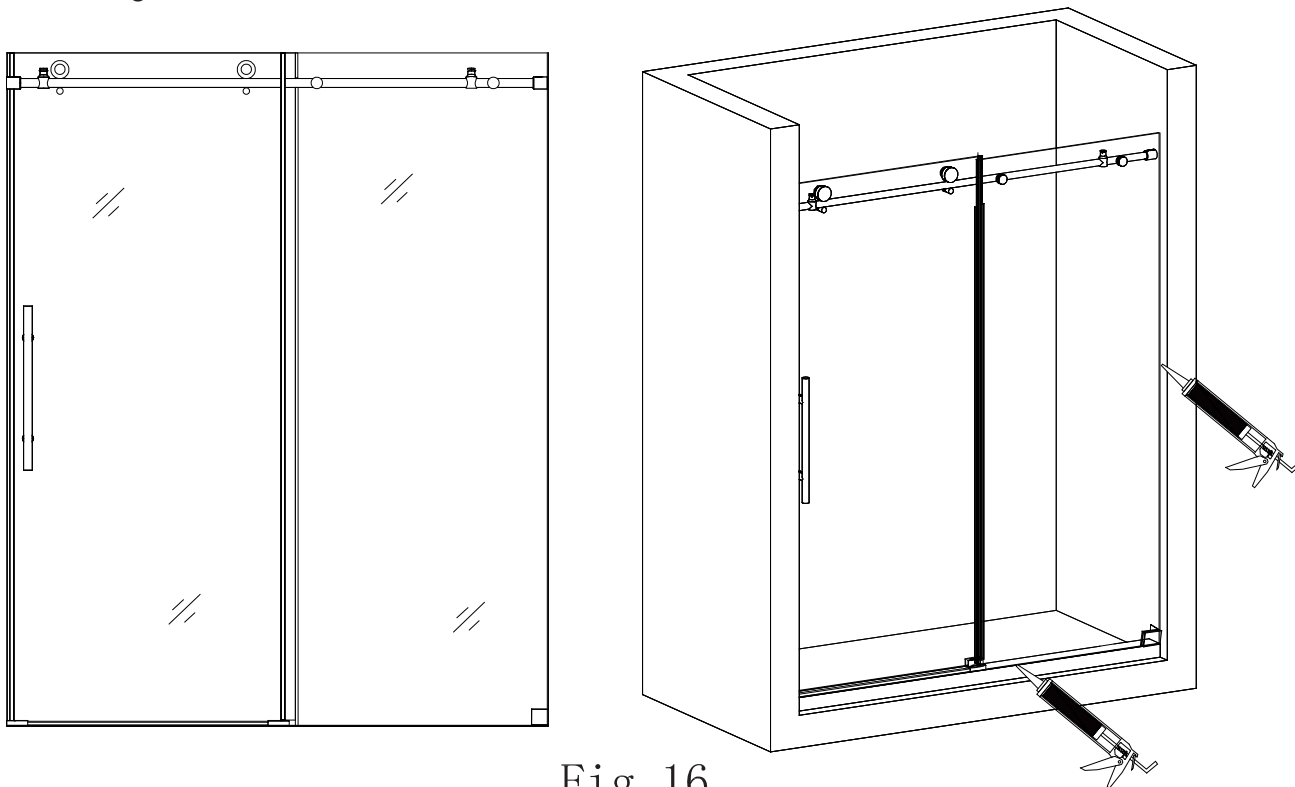

Fig 16

IMPORTANT:

MUST ALLOW SILICONE TO DRY FOR 24 HOURS BEFORE STARTING USING THE SHOWER ENCLOSURE