

# Annaba Wall Mounted Double Joint Kitchen Sink Faucet

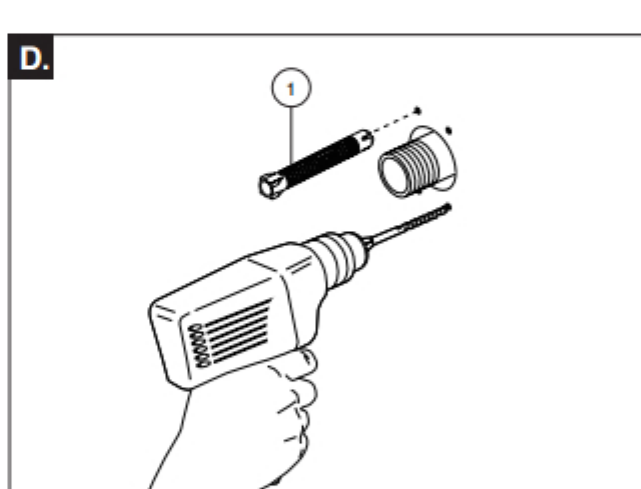

## INSTALLATION INSTRUCTIONS

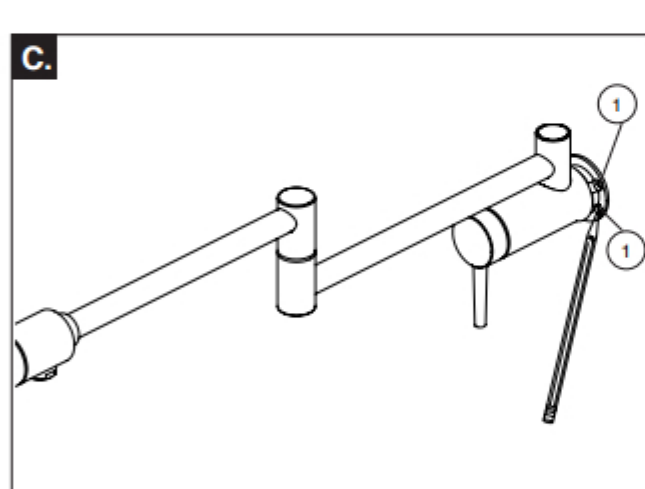
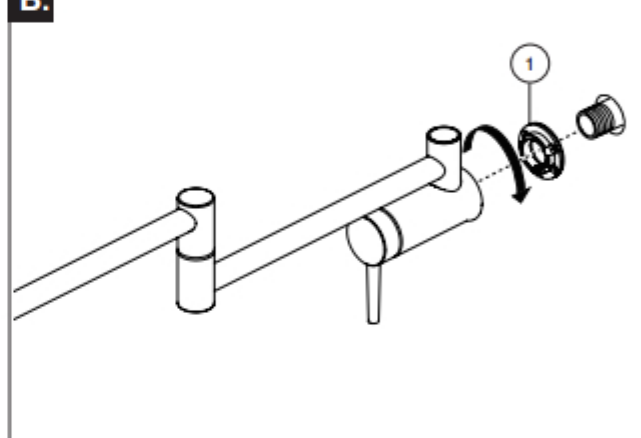
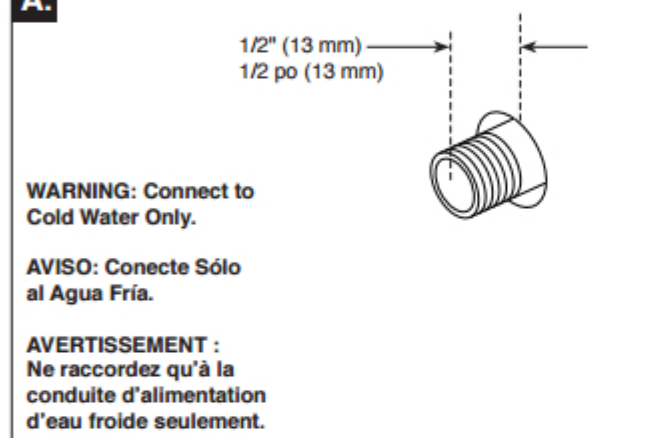
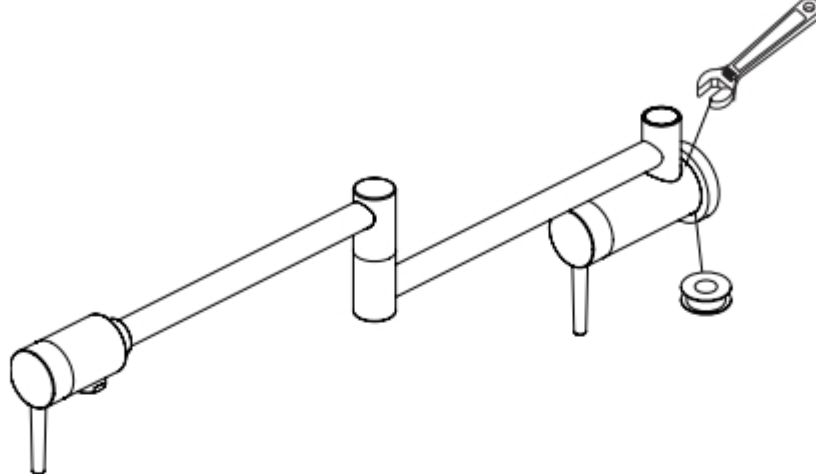

**Wall Mount Models**  
Use of stringers is recommended for a secure mounting.

**A.** Connect to 1/2" IPS supply line. The pipe should extend 1/2" past the finished wall surface.

**B.** Place wall flange (1) onto the faucet as shown. Thread faucet onto pipe.

**C.** Mark the screw holes (1) in the flange. Unthread the faucet from the pipe.

**D.** Drill 3/32" (2.38 mm) holes where marked. If using the provided anchors (1), drill 1/4" (6.35 mm) holes.

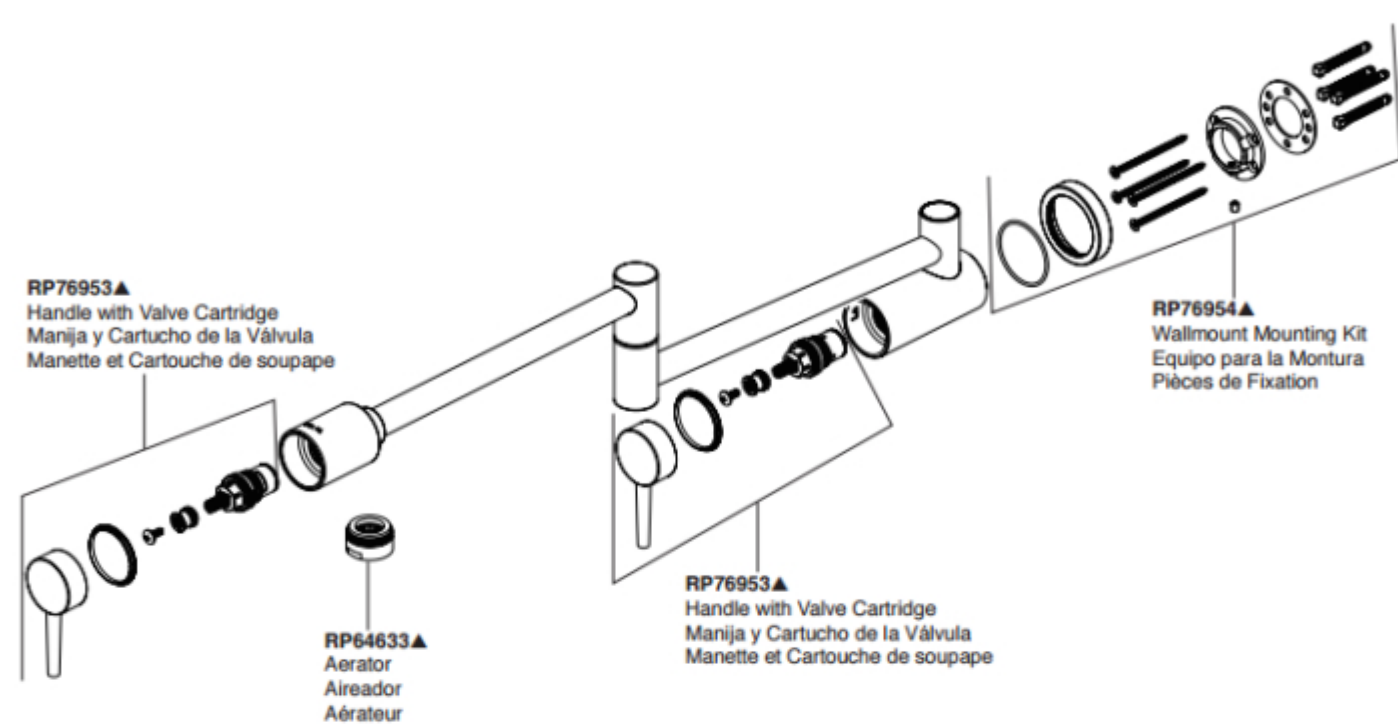
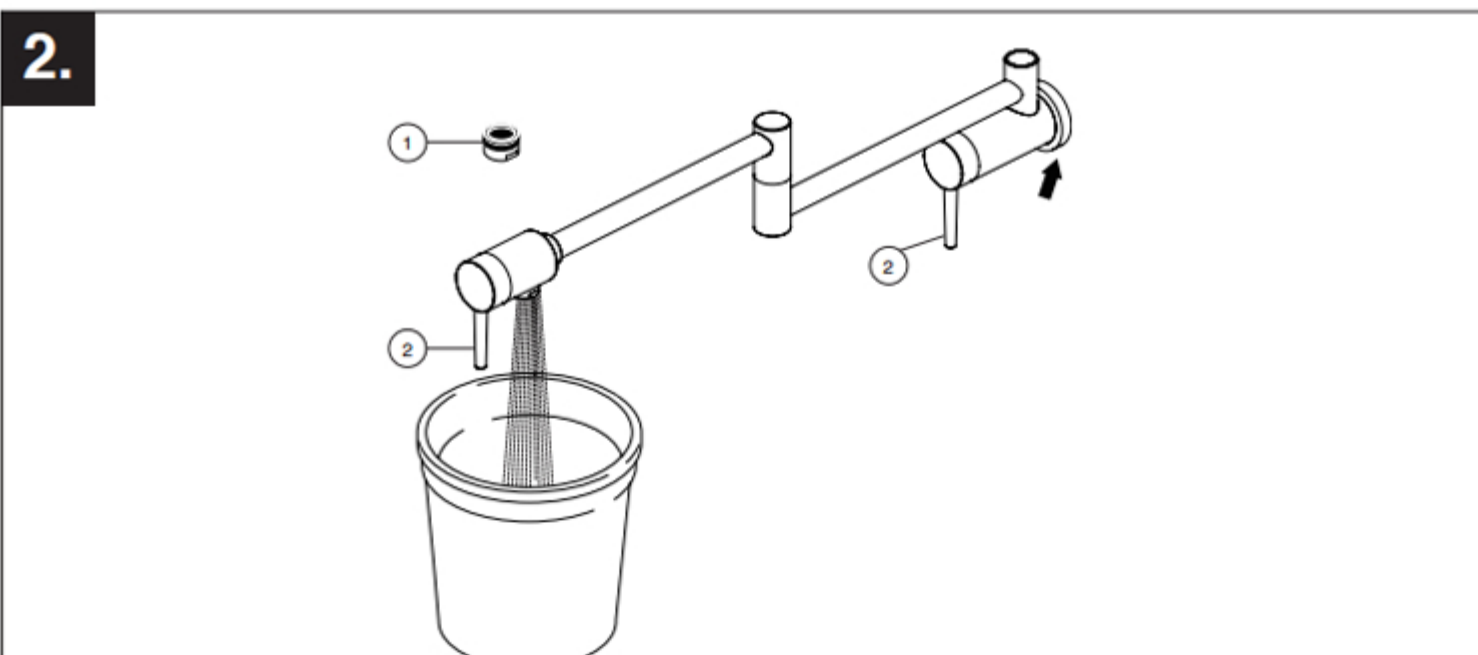
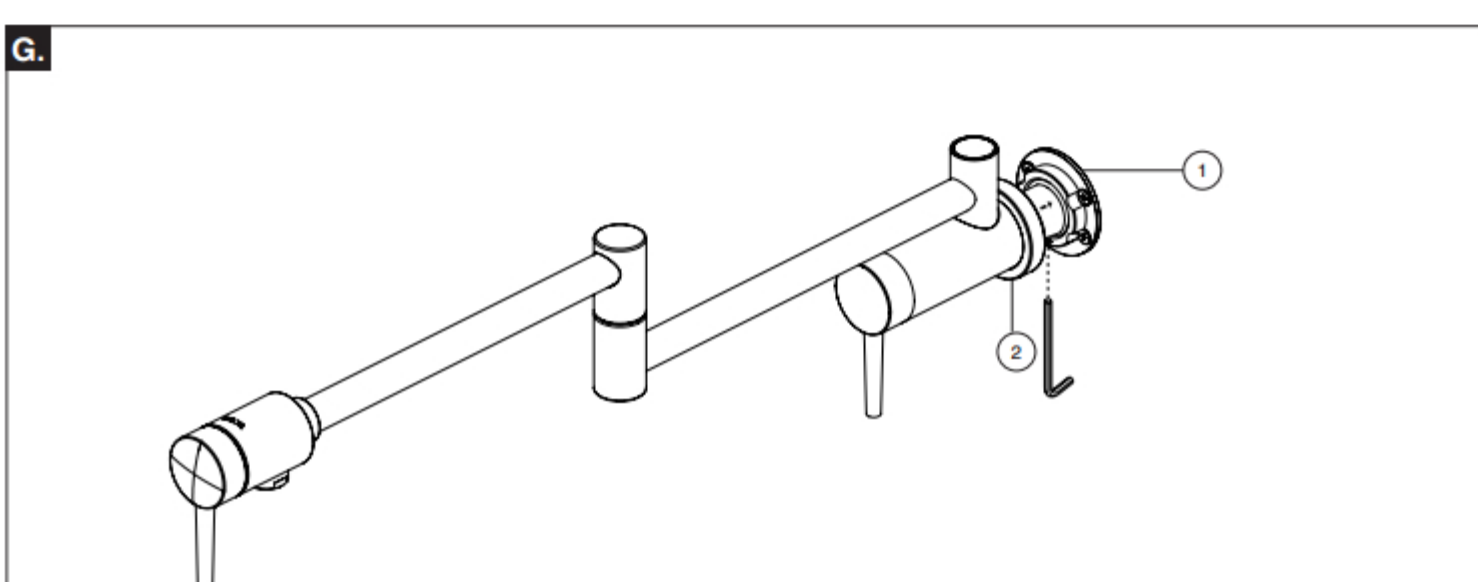
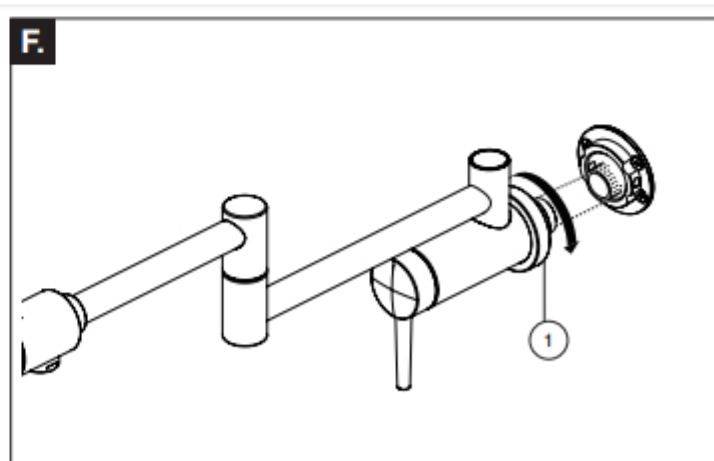
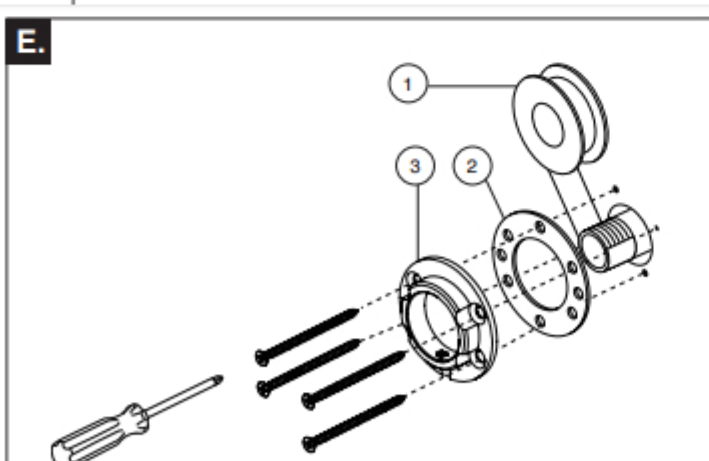

▲ Specify Finish  
▲ Especifica el Acabado  
▲ Précisez le fini

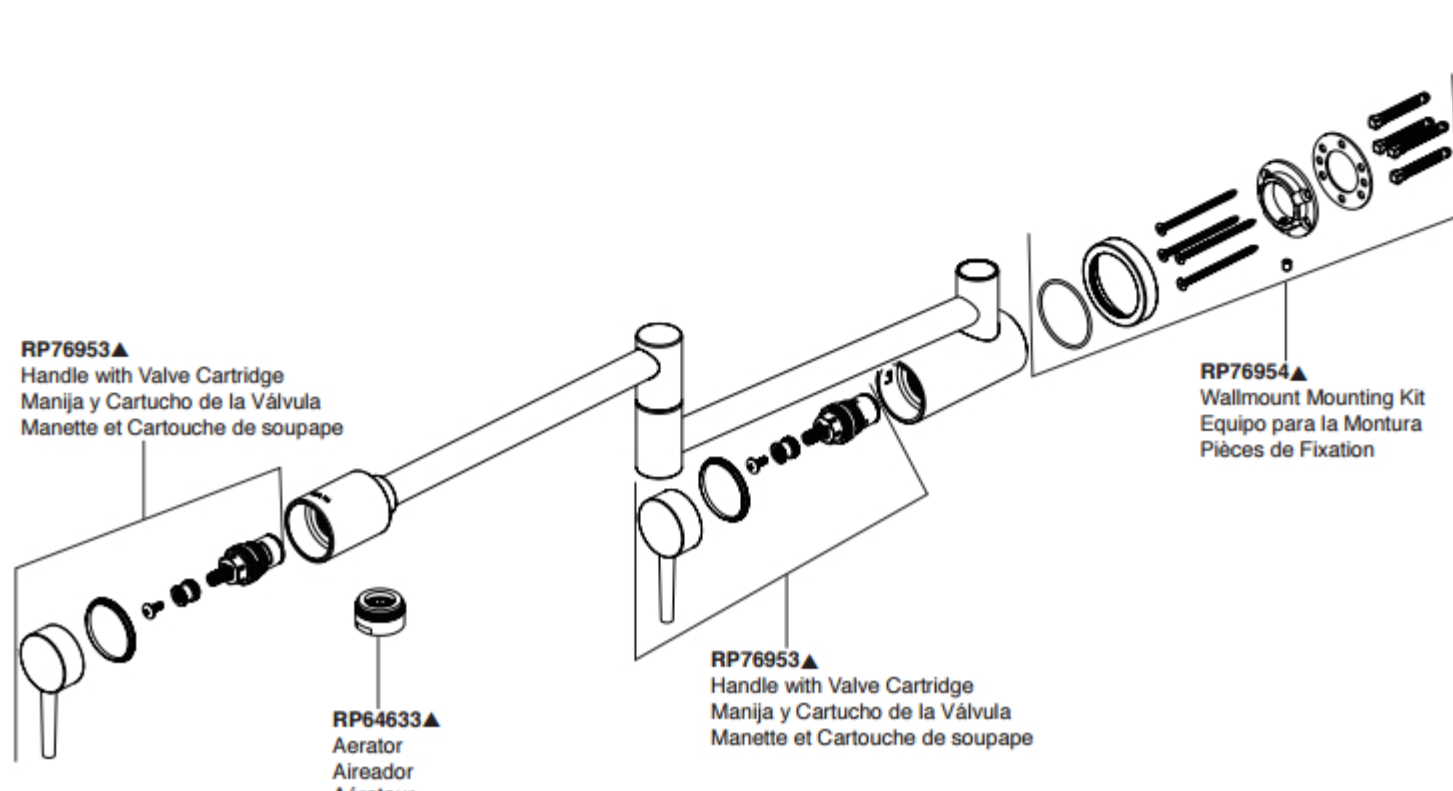
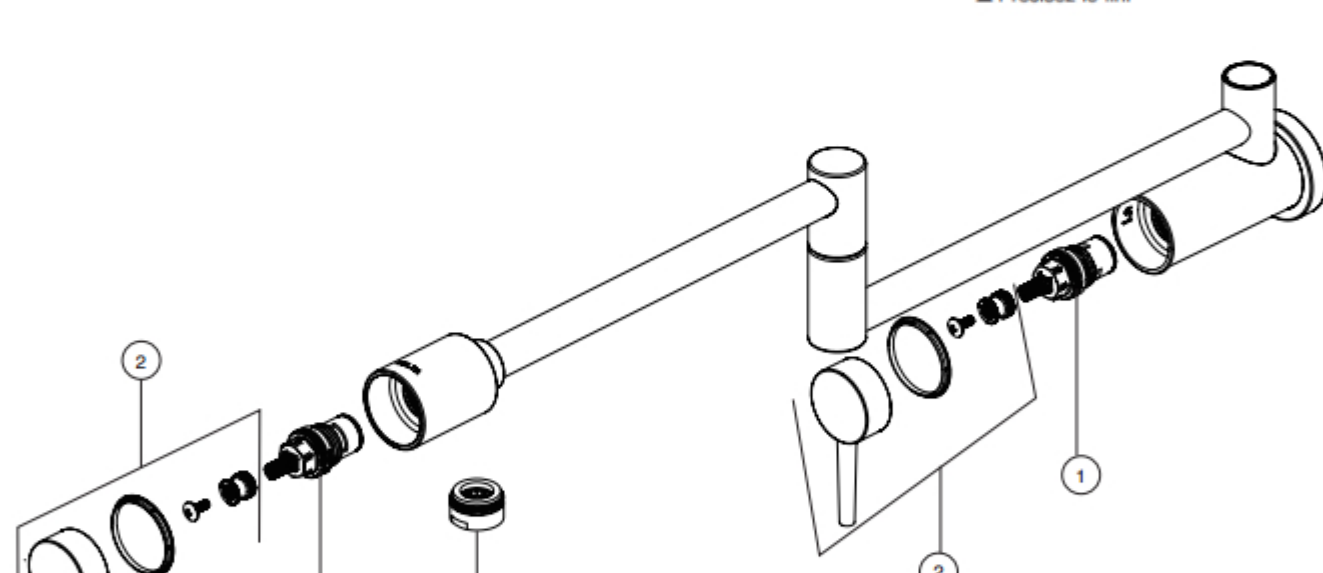

This General diagram and installation instructions are not intended for any specific model, but is presented as a general guideline for Installations!