

CHECK YOUR PARTS

| ITEM | CODE | DESCRIPTION | DIMENSIONAL (mm) | QTY. |
|------|--------------|-------------------|------------------|------|
| 1 | CC0406011000 | BACK | 406x601x1,5 | 1 |
| 2 | LTQ604711000 | BACK SIDE PANEL | 475x601x13 | 2 |
| 3 | LFQ603111000 | FRONT SIDE PANEL | 316x301x58 | 2 |
| 4 | TFQ521011000 | TOP/BOTTOM PANEL | 1064x523x19 | 2 |
| 5 | PRQ511011000 | SHELF | 1060x515,5x18 | 1 |
| 6 | CLQ006011000 | DOOR SUPPORT | 56x561,5x17 | 2 |
| 7 | 35PRT1012 | DOOR | 595x595x18 | 1 |
| 8 | 34DBR005 | MOUNTING PLATE | | 2 |
| 9 | 34DBR005 | HINGE | | 2 |
| 10 | 34PXD004 | HANDLE | | 1 |
| 11 | 34BCH001 | BUSHING Ø8 mm | | 8 |
| 12 | 34PRF004 | SCREW Ø4,8x45mm | | 8 |
| 13 | 34PRF003 | SCREW Ø3,5x25mm | | 2 |
| 14 | 34PRF002 | SCREW Ø4,2x9,5mm | | 24 |
| 15 | 34PRF001 | SCREW Ø3,16"x1/4" | | 14 |
| 16 | 34PRC001 | NUT 3/16" | | 14 |
| 17 | 34TPF001 | HOLE COVER | | 6 |
| 18 | 34CAP001 | SCREW COVER | | 8 |
| 19 | 34BTN001 | SILICONE STOP | | 2 |

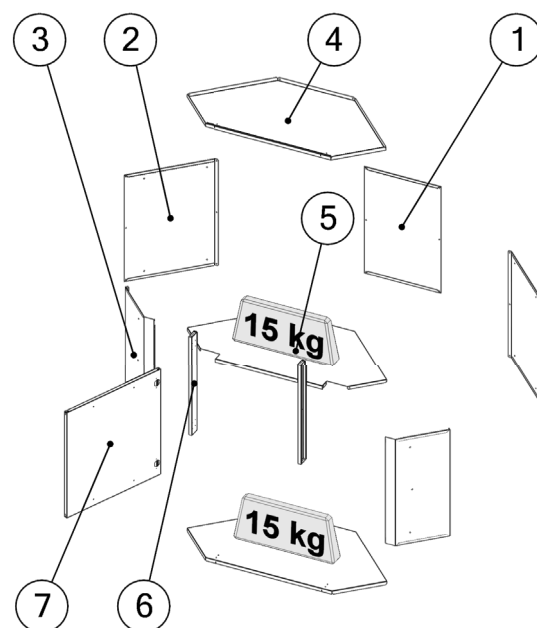

* Maximum weight supported, evenly distributed.

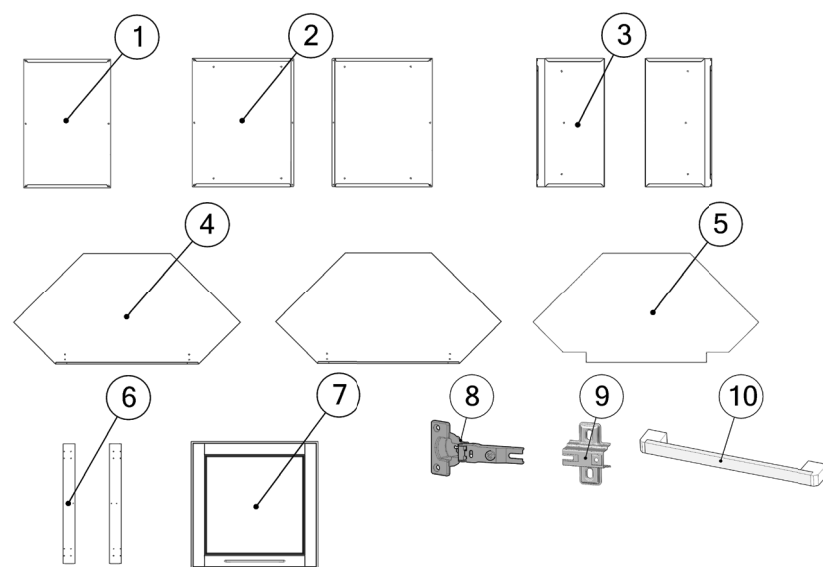
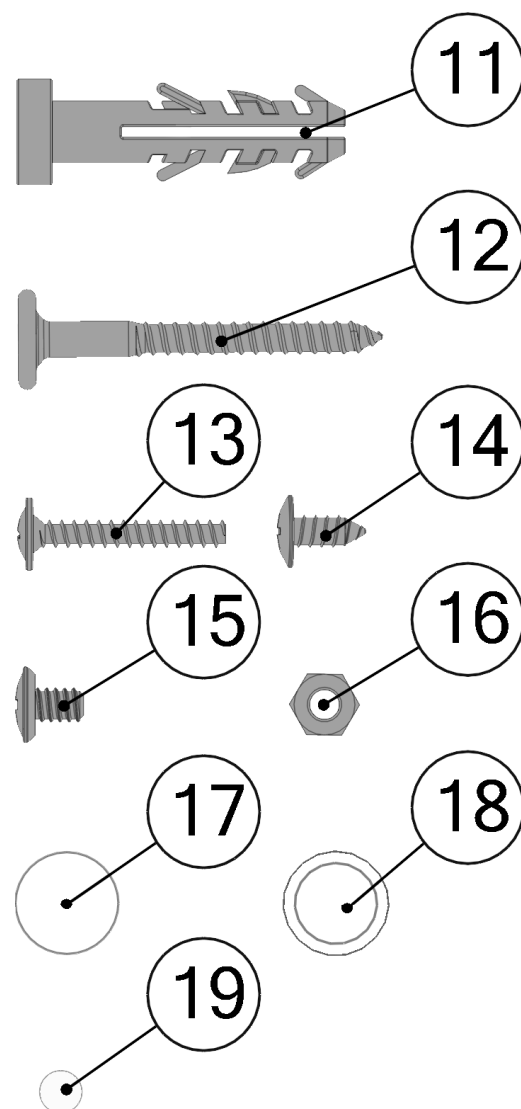

WALL CABINETE 45° 760X760X600 1P

Assembly Instructions

INSTRUCTIONS CODE CABINET CODE
32MNL1021 GIAC75601P0001

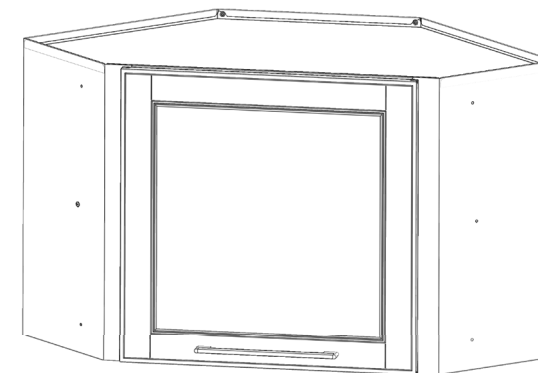

The presented images are merely illustrative.

ATTENTION

Before starting assembly, follow the procedures below:

1. In case the kitchen set has a corner closet start assembly with this closet to ensure proper alignment.
2. Open the package and use the cardboard box to cover the floor. This prevents possible scratches both on the product and on the floor.
3. Wear gloves for safe handling of parts. Next, set hardware and parts aside so that they are easy to find during assembly.
4. Remove the protective film from the parts before starting assembly.
5. Make sure to secure all closets and cabinets to the wall on all attachment points indicated.

CERTIFICATE OF WARRANTY

CONGRATULATIONS FOR ACQUIRING A PRODUCT WITH CASAMOB QUALITY!

We make sure that our furniture is manufactured with cutting edge equipment, following the most stringent quality standards. All that to provide you a modern, long-lasting product with innovative design. To guarantee your full satisfaction, we are granting you this certificate of warranty with the following terms and conditions.

SUBJECT-MATTER: The warranty is valid against defects in workmanship.

TERM: The product acquired is warranted for one (01) year as from the invoice date.

WARRANTY PROCEDURE: In case a problem with the product is identified, user shall proceed to the store where the product was purchased bringing its original invoice. On its turn, the store shall call the manufacturer so that, after confirming that the problem is a defect in workmanship, the replacement of the defective parts may be arranged within thirty (30) days.

EXCLUSIONS: The following is expressly excluded from the warranty: • Damages resulting from product installation when installation is performed in disagreement with the instructions contained in the Assembly Instructions. • Damages resulting from alterations or changes to the product. • Damages resulting from failure to follow the instructions regarding proper product use • Damages resulting from accident, loss, natural causes or any other external causes (e.g.: flood, explosion, fire, and fall). • Damages resulting from the installation of glass, marble, granite or other materials of similar function, ceramic or metal sink. • Damages resulting from improper conditions of the installation site, such as improper walls. • Damages resulting from services procured by user. • Damages resulting from water, electricity and gas installations, which are the responsibility of user. • Damages resulting from the use of the products on an environment containing corrosive agents. • Damages resulting from failure to remove the protective film following assembly. • Damages resulting from failure to observe the weight limit stated in the Assembly Instructions. • Damages resulting from improper product cleaning with abrasive, acid, alkaline, chlorine-based, ammonia-based or any other corrosive product. • Damages resulting from contact of objects and/or utensils at a temperature exceeding 120°C with the product countertop. • Damages resulting from product exposure to corrosive sea air in regions located at a radius of less than 1000 meters from the seacoast.

TERRITORY: The warranty covers the entire U.S.A territory.

LIMITATIONS OF WARRANTY: The warranty does not apply to expenses incurred due to removal, reinstallation, package, transportation, insurance and accommodation, and eventual losses/damages resulting from product being render useless for reasons attributable to customer will not be reimbursed.

ADDITIONAL INFORMATION: CasaMob reserves the right to change, add or remove any item from its product line without prior notice.

