



MANUAL DE MONTAGEM  
ASSEMBLY INSTRUCTIONS  
INSTRUCCIONES DE MONTAJE

COD BR: 27000  
COD US: 24900

Sumário  
Summary  
Resumen

Introdução Introduction Introducción	3
Antes de começar Before starting Antes de comenzar	4
Evite acidentes Avoid accidents Evitar accidentes	4
Identificação de peças Identifying parts Identificación de las piezas	5
Dimensões e ferramentas Dimensions and tools Dimensiones y herramientas	5
Montagem da estrutura do móvel Furniture assembly Montaje del muebles	6

Introdução  
Introduction  
Introducción

Leia atentamente este manual e siga os passos indicados para uma perfeita montagem.

Read this manual and follow the steps for the perfect fit.

Lea este manual y siga los pasos para el ajuste perfecto.

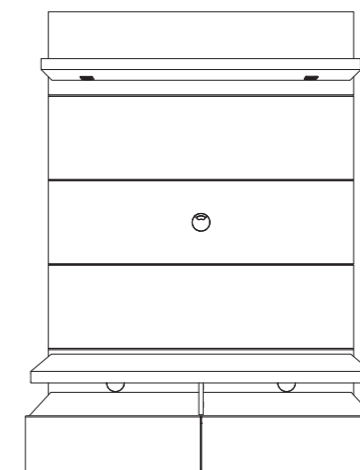

**Antes de começar**  
Before starting  
Antes de comenzar

**Antes de começar a montagem prepare o ambiente, deixando-o completamente limpo e com bom espaço para iniciar o trabalho.**

Prepare the room before starting the assembly, leaving it completely clean and the area in good condition to start the work.

Antes de comenzar el montaje preparar el ambiente, dejándolo completamente limpio y con buen espacio para comenzar el trabajo.

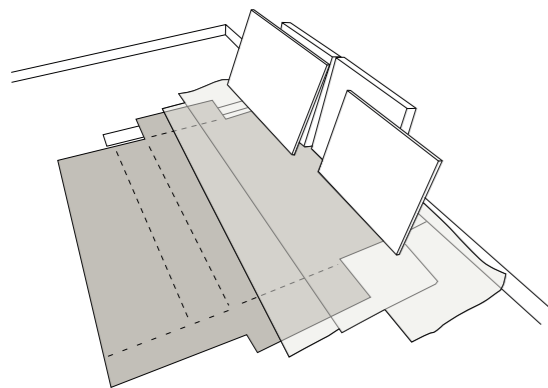

**Utilize o papelão da própria embalagem, bem como a isomanta de proteção para separar e apoiar as peças retiradas das caixas.**

Use the cardboard of the packaging and the foam sheets protection to separate and support the parts removed the boxes.

Utilice el cartón de la embalaje y la espuma protectora para separar y apoyan las pizas desmontadas de las cajas.

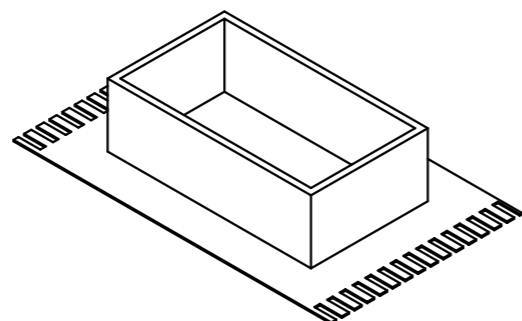

**Forre a área de montagem com um cobertor ou tapete. Assim, você evita avarias nas peças durante o processo de montagem.**

Cover the assembly area with a blanket or carpet. Thus, you avoid damages on the parts during the assembly process.

Cubrir la zona de ensamble con una manta o alfombra. De este modo, se evitan danos en las piezas durante el proceso de montaje.

**Evite acidentes**  
Avoid accidents  
Prevenir accidentes

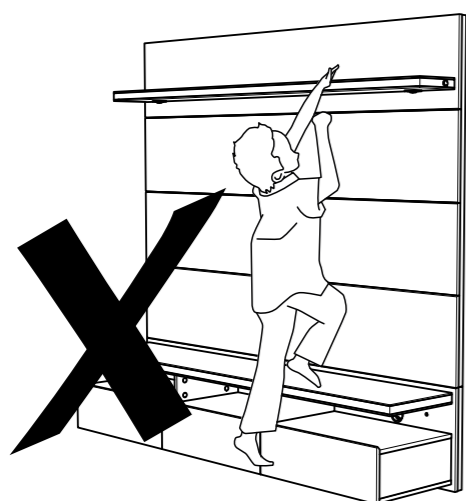

**Não escale ou se apoie no móvel.**

Do not climb or lean on the closet.

No se suba ni se apoye en el closet.

**Identificação das peças**  
Identifying parts  
Identificación de las piezas

Para identificar o número da peça, verifique o verso da mesma, lá você encontra informações do lote de fabricação, código de identificação do produto e do número da peça.

To identify the part number, check its back, you can find information from the production batch, product reference code and part number.

Para identificar el número de pieza, compruebe en la parte posterior de cada una, ahí también se puede encontrar información del número de lote de producción, el código de identificación del producto y el número de la pieza.

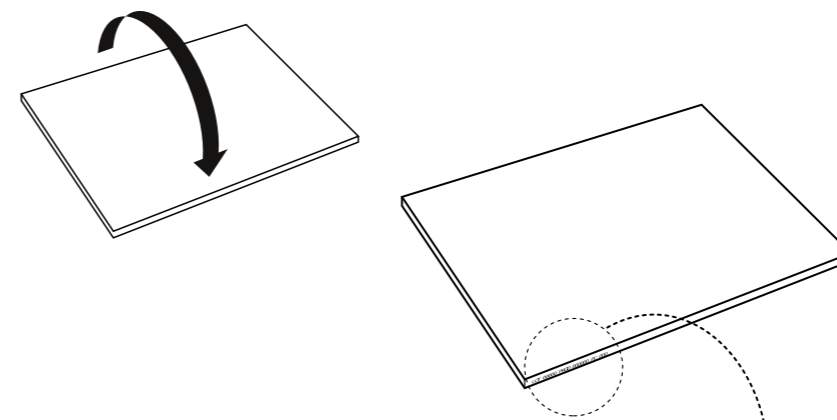

**Número do lote de fabricação do seu produto.**  
Manufacturing batch number of the product.  
Numero de lote fabricación de su producto.

**Número de identificação do seu produto.**  
Code number of the product.  
Numero de identificación de su producto.

**Número da peça.**  
Part number.  
Número de pieza.

**Dimensões e Ferramentas**  
Dimensions and Tools  
Dimensiones y Herramientas

**Dimensões:**

L: 1200 A: 1708 P: 435 mm

**Dimensions:**

W: 47,24 H: 67,24 D: 17,12 inches

**Dimensiones:**

L: 1200 A: 1708 P: 435 mm

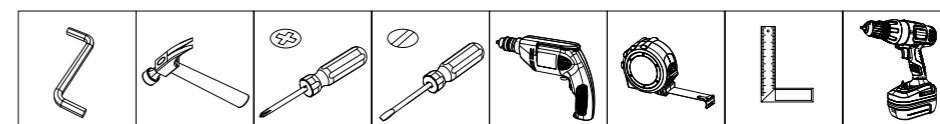
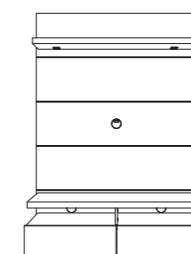

PEÇA	DESCRIÇÃO	QUANT.	CAIXA	PART	DESCRIPTION	QTY.	BOX	PIEZA	DESCRIPCIÓN	CANTIDAD.	CAIXA
012	PAINEL SUPERIOR	1	2	012	TOP PANEL	1	2	012	PANEL SUPERIOR	1	2
013	PAINEL CENTRAL	1	2	013	CENTRAL PANEL	1	2	013	PANEL CENTRAL	1	2
014	PAINEL PASSA FIO	1	2	014	PANEL WIRE CHANNEL	1	2	014	PANEL PASAJE ALAMBRE	1	2
015	PAINEL INFERIOR	1	2	015	BACK PANEL	1	2	015	PANEL INFERIOR	1	2
016	PRATELEIRA	1	2	016	TOP SHELF	1	2	016	ESTANTE	1	2
017	SARRAFO LATERAL	2	2	017	SIDE BATTEN	2	2	017	SOPORTE LATERAL	2	2
022	TAMPO SUPERIOR	1	1	022	TOP BOARD	1	1	022	CUBIERTA SUPERIOR	1	1
023	TAMPO CENTRAL	1	1	023	CENTER BOARD	1	1	023	CUBIERTA CENTRAL	1	1
024	TAMPO INFERIOR	1	1	024	BOTTON BOARD	1	1	024	CUBIERTA INFERIOR	1	1
025	DIVISÓRIA SUPERIOR	1	1	025	SIDE TOP	1	1	025	LATERAL SUPERIOR	1	1
026	DIVISÓRIA INFERIOR	1	1	026	SIDE BOTTON	1	1	026	LATERAL INFERIOR	1	1
027	LATERAL ESQUERDA	1	1	027	LEFT SIDE	1	1	027	LATERAL IZQUIERDA	1	1
028	LATERAL DIREITA	1	1	028	RIGHT SIDE	1	1	028	LATERAL DERECHA	1	1
029	FRENTE GAVETA	2	1	029	FRONT OF DRAWER	2	1	029	FRENTE DEL CAJÓN	2	1
030	LATERAL GAVETA	4	1	030	SIDE OF DRAWER	4	1	030	CAJÓN LATERAL	4	1
031	CONTRA FUNDO	4	1	031	BACK PANEL DRAWER	4	1	031	CAJÓN INFERIOR	4	1
032	FUNDO GAVETA	2	1	032	BOTTON OF DRAWER	2	1	032	FONDO CAJÓN	2	1
036	PAINEL TRASEIRO	1	1	036	BACK PANEL	1	1	036	PANEL TRASERO	1	1
042	SARRAFO LATERAL	2	1	042	SARRAFO LATERAL	2	1	042	SOPORTE LATERAL	2	1

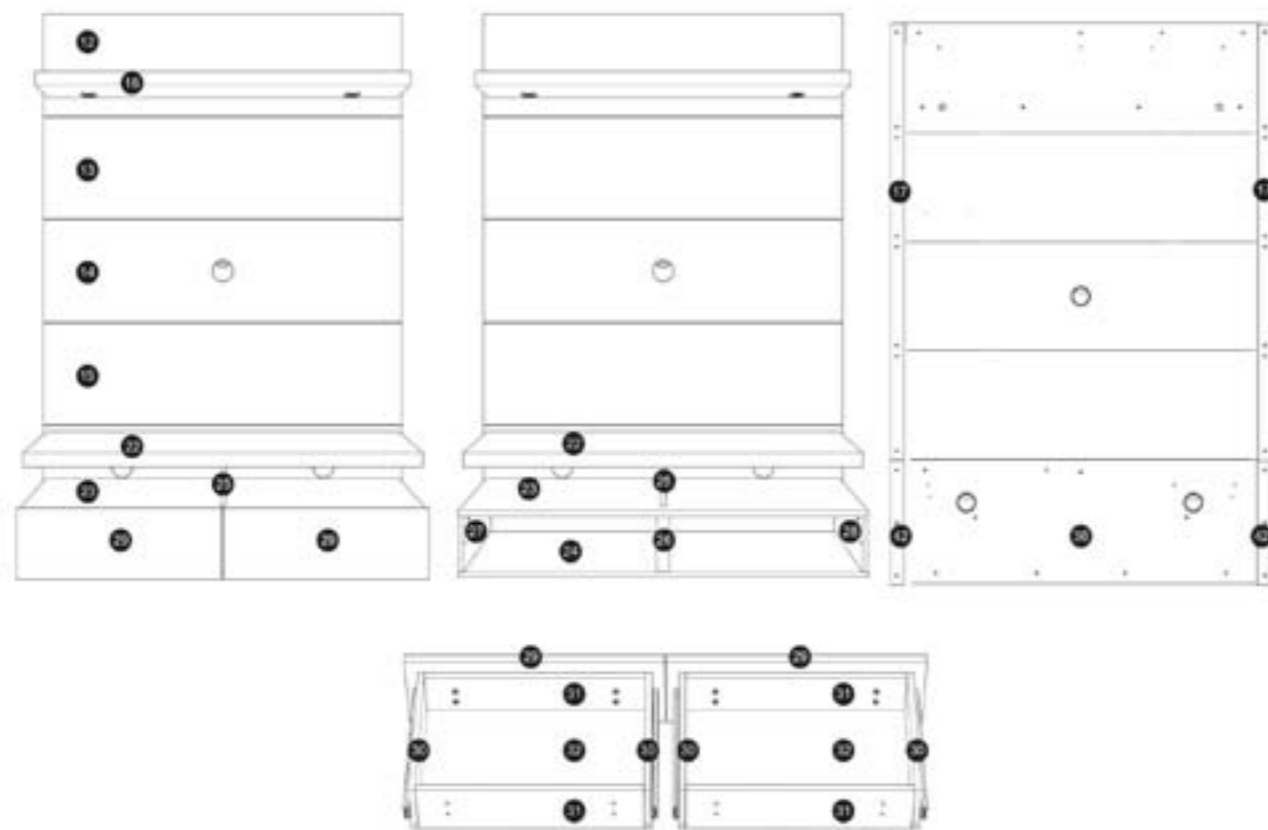

ACESSÓRIOS INCLUIDOS NA CAIXA 01 - ACCESSORIES INCLUDED IN BOX 01 - ACCESORIOS INCLUIDOS EN LA CAJA 01

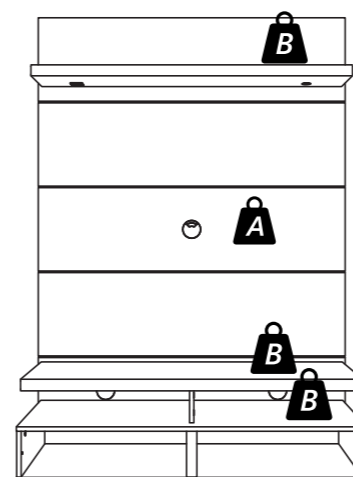
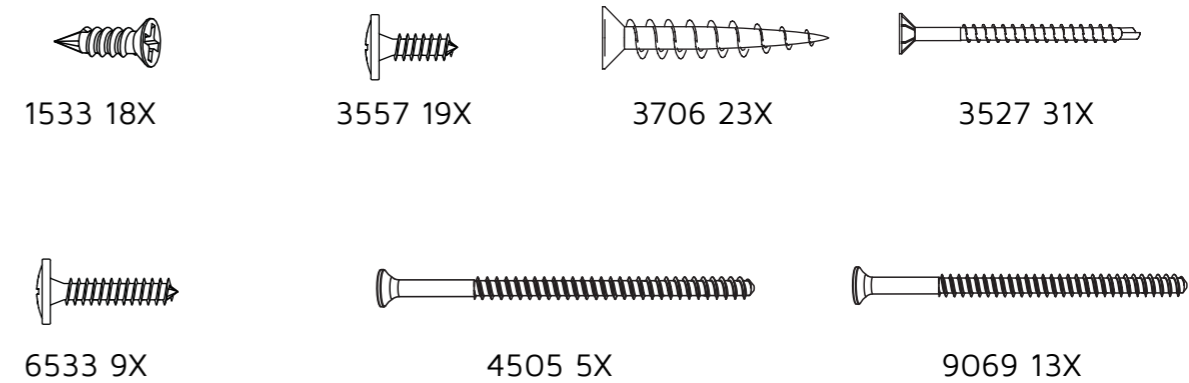
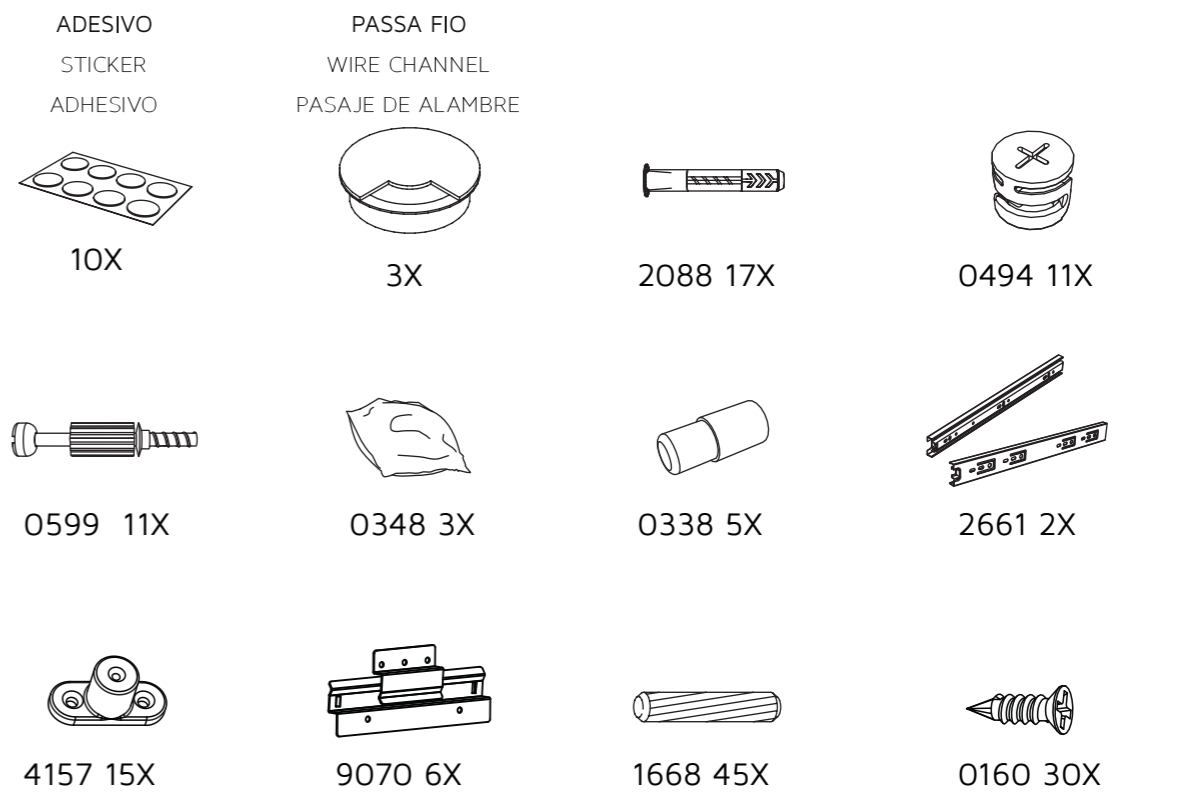

SUPORTE TV  
 SUPORT TV  
 SOPORTE TV  
 1X

**A** = 30KG - 66LB  
**B** = 5KG - 11LB

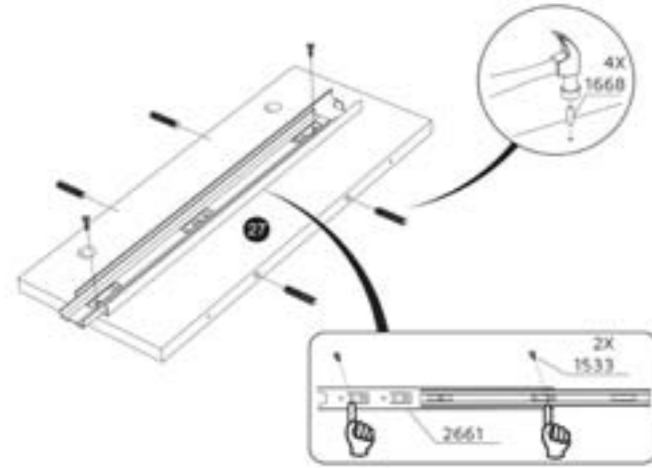

**PASSO 1**

Encaixar cavilhas 4x1668, parafusar 2x1533 fixando as corredeiras 1x2661 na Lateral Esquerda 27.

**STEP 1**

Insert dowels 4x1668, screw 2x1533 to fix the slide 1x2661 on the Left Side 27.

**PASO 1**

Clavijas de ajuste 4x1668, atornillar 2x1533 fijando las corredeira 1x2661 en Lateral Izquierda 27.

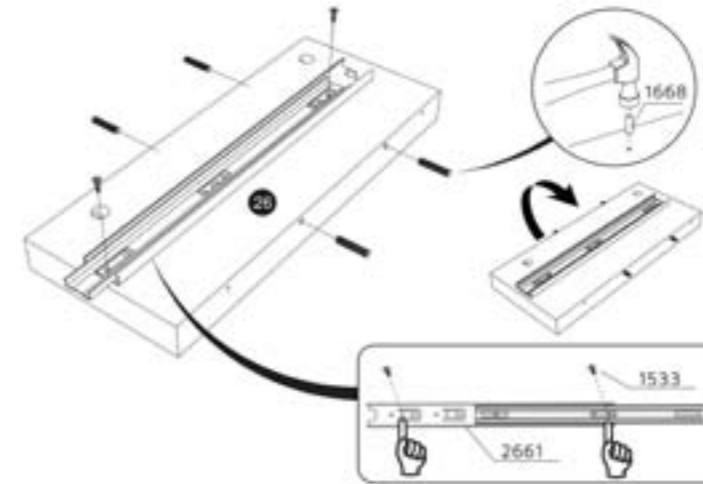

**PASSO 4**

Encaixar cavilhas 4x1668, parafusar 2x1533 fixando as corredeiras 1x2661 na Divisória Inferior 26.

**STEP 4**

Insert dowels 4x1668, screw 2x1533 to fix the slide 1x2661 on the Side Bottom 26.

**PASO 4**

Clavijas de ajuste 4x1668, atornillar 2x1533 fijando las corredeira 1x2661 en Lateral Inferior 26.

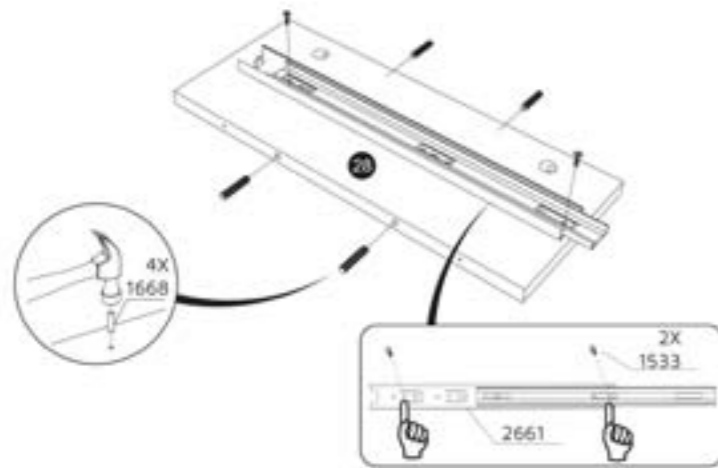

**PASSO 2**

Encaixar cavilhas 4x1668, parafusar 2x1533 fixando as corredeiras 1x2661 na Lateral Direita 28.

**STEP 2**

Insert dowels 4x1668, screw 2x1533 to fix the slide 1x2661 on the Right Side 28.

**PASO 2**

Clavijas de ajuste 4x1668, atornillar 2x1533 fijando las corredeira 1x2661 en Lateral Derecha 28.

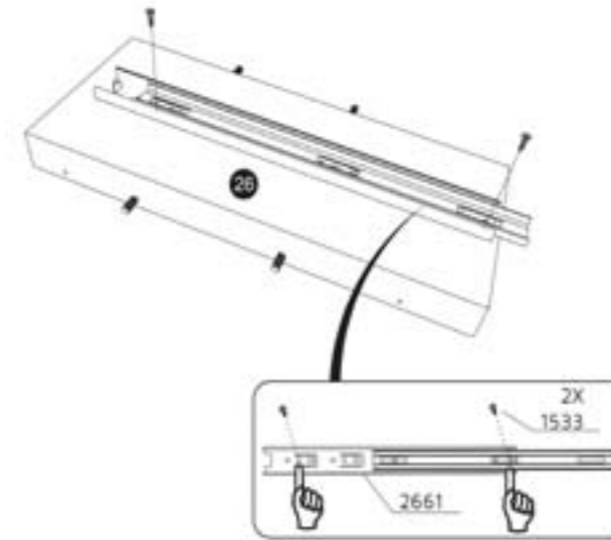

**PASSO 5**

Parafusar 2x1533 fixando as corredeiras 1x2661 na Divisória Inferior 26.

**STEP 5**

Screw 2x1533 to fix the slide 1x2661 on the Side Bottom 26.

**PASO 5**

Atornillar 2x1533 fijando las corredeira 1x2661 en Lateral Inferior 26.

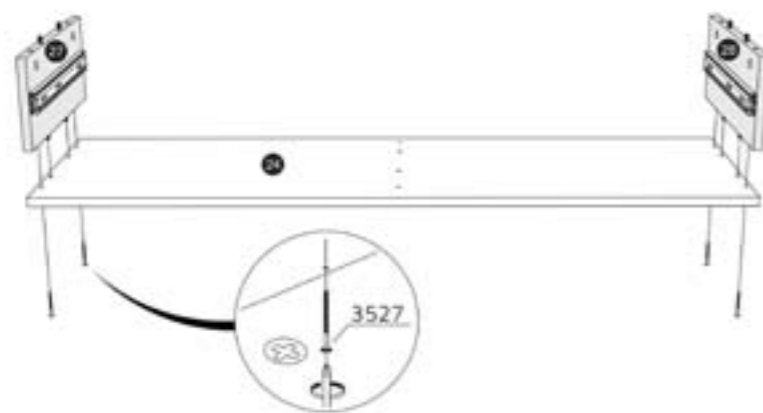

**PASSO 3**

Encaixar Laterais 27 e 28 na Base 24. Parafusar 4x3527.

**STEP 3**

Attach the Side 27 and 28 in Base 24. Screw 4x3527.

**PASO 3**

Montar el Laterais 27 y 28 el Base 24. Atornillar 4x3527.

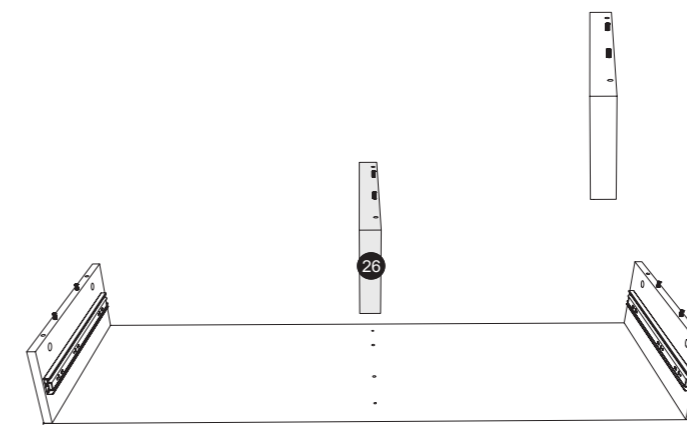

**PASSO 6**

Peça com furo deslocados.

**STEP 6**

Holes displaced to insed of the part.

**PASO 6**

Pieza con agujeros desplazados.



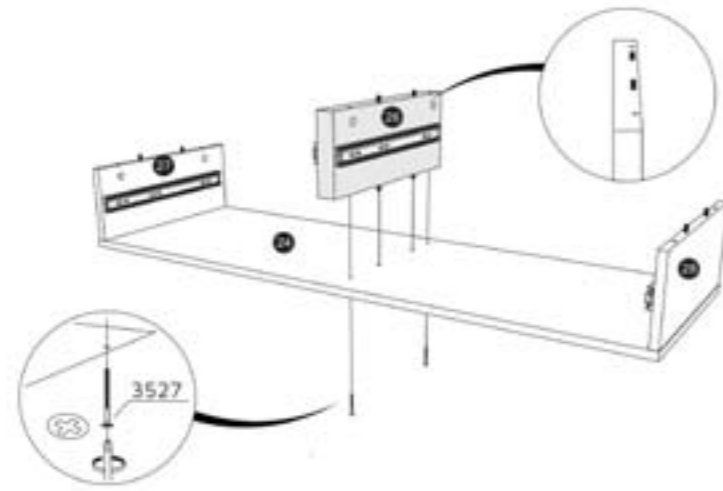

**PASSO 7**  
Parafusar 4x**3527** fixando a Divisória Inferior **26** na Base **24**.

**STEP 7**  
Screw 4x**3527** to fix the Side Botton **26** on the Base **24**.

**PASO 7**  
Atornillar 4x**3527** fijando las Laterals Inferior **26** en el Base **24**.

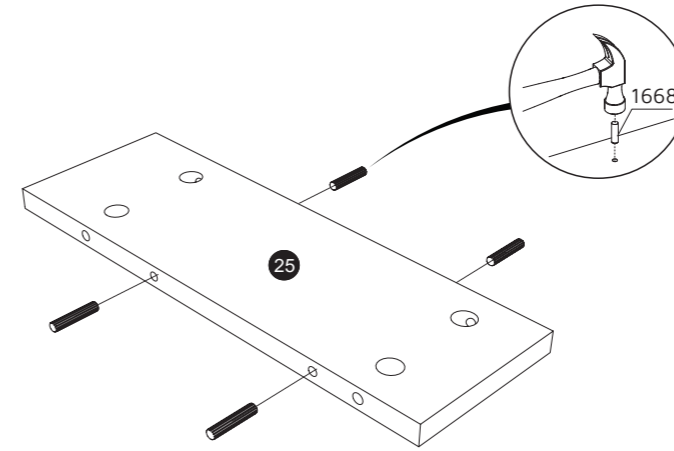

**PASSO 10**  
Encaixar cavilhas 4x**1668** na Divisória Superior **25**.

**STEP 10**  
Insert dowels 4x**1668** to Side Top **25**.

**PASO 10**  
Clavijas de ajuste 4x**1668** en Lateral Superior **25**.

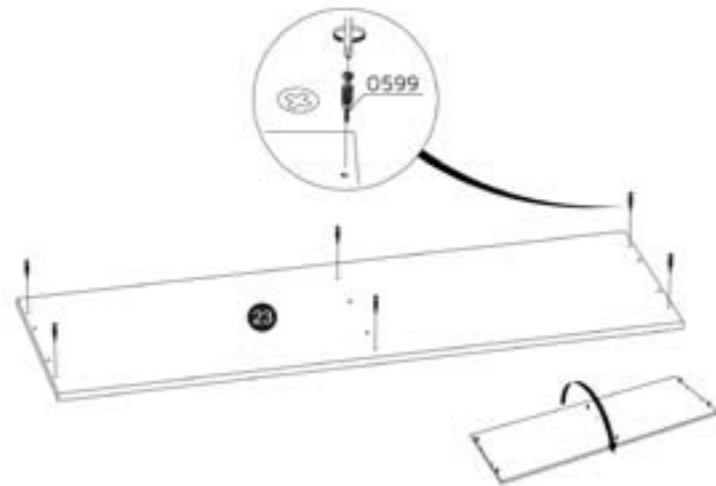

**PASSO 8**  
Parafusar 6x**0599** no Tampo Central **23**.

**STEP 8**  
Screw 6x**0599** to Center Board **23**.

**PASO 8**  
Atornillar 6x**0599** en Cubierta Central **23**.

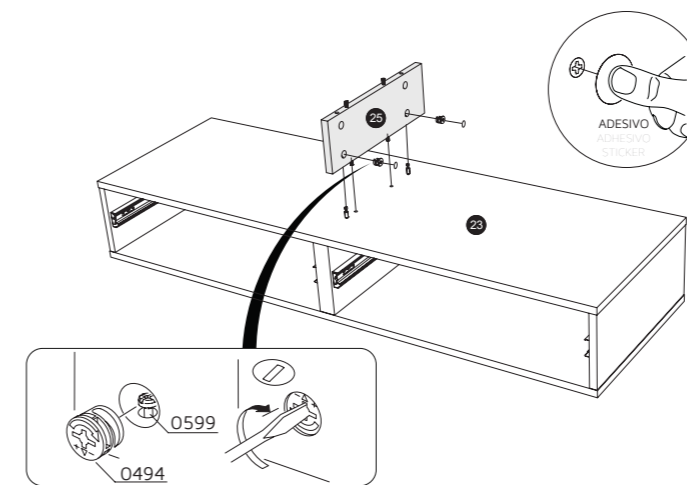

**PASSO 11**  
Parafusar 2x**0494**.  
Colar 2x adesivos.

**STEP 11**  
Screw 2x**0494**.  
Paste 4x stickers.

**PASO 11**  
Atornillar 2x**0494**.  
Pegar 2x adhesivos.

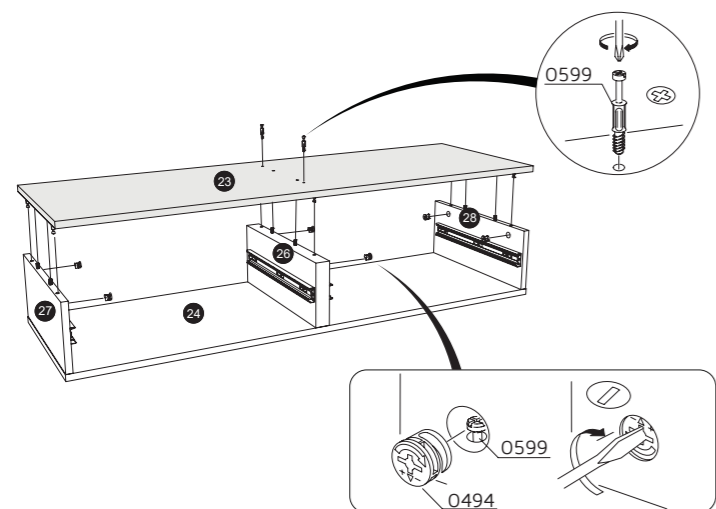

**PASSO 9**  
Encaixar Tampo Central **23**.  
Parafusar 2x**0599**.  
Parafusar castanhas 6x**0494**.

**STEP 9**  
Attach the Center Board **23**.  
Screw 2x**0599**.  
Screw nuts 6x**0494**.

**PASO 9**  
Montar el Cubierta Central **23**.  
Atornillar 2x**0599**.  
Atornillar las tuercas 6x**0494**.

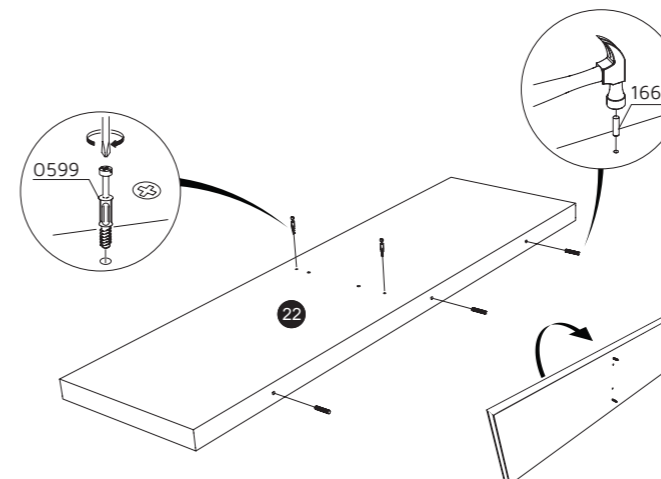

**PASSO 12**  
Parafusar 2x**0599** no Tampo Superior **22** e encaixar cavilhas 3x**1668**.

**STEP 12**  
Screw 2x**0599** to Top Board **22** and insert dowels 3x**1668**.

**PASO 12**  
Atornillar 2x**0599** en el Cubierta Superior **22** y clavijas de ajuste 3x**1668**.

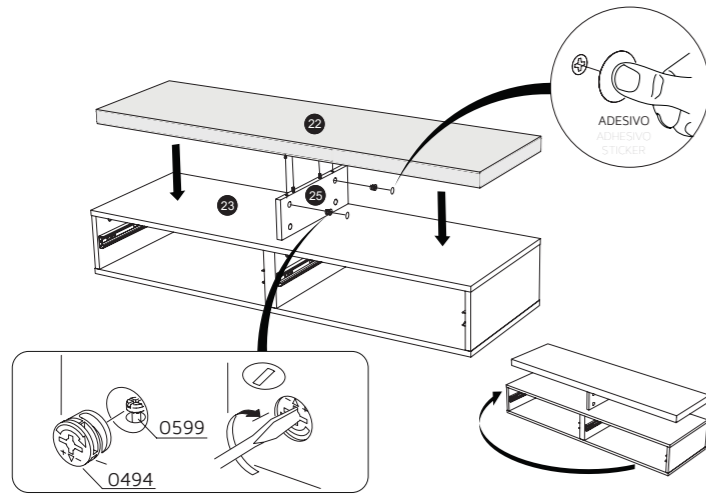

**PASSO 13**  
Encaixar Tampo Superior **22** e parafusar **2x0494**.  
Colar 2x adesivos.

**STEP 13**  
Insert Top Board **22** and screw **2x0494**.  
Paste 2x stickers.

**PASO 13**  
Ajuste Cubierta Superior **22** y atornillar **2x0494**.  
Pegar 2x adhesivos.

2mm / 0,07 inches

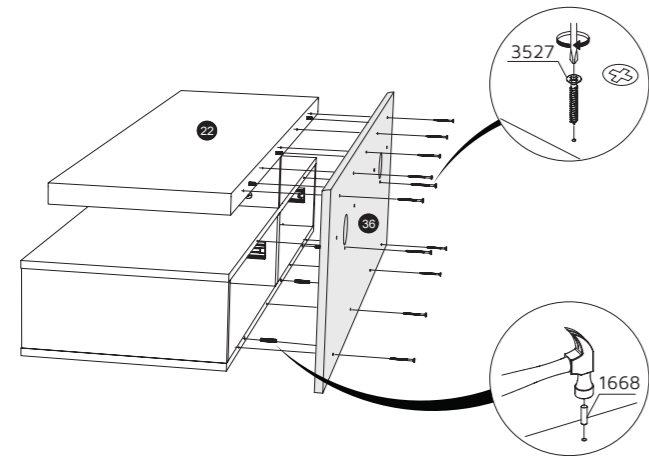
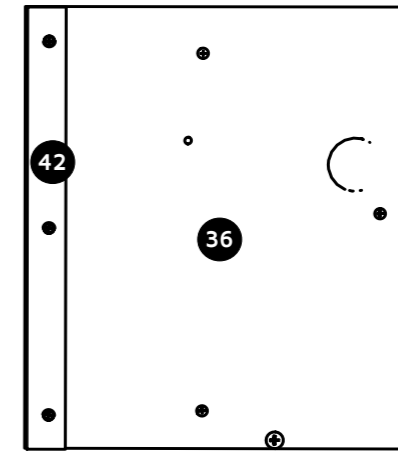

**PASSO 14**  
Parafusar **11x3527** no Painel Traseiro **36**.  
Encaixar cavilhas **3x1668**.

**STEP 14**  
Screw **11x3527** in the Back Panel **36**.  
Insert dowels **3x1668**.

**PASO 14**  
Atornillar **11x3527** en el Panel Trasero **36**.  
Clavijas de ajuste **3x1668**.

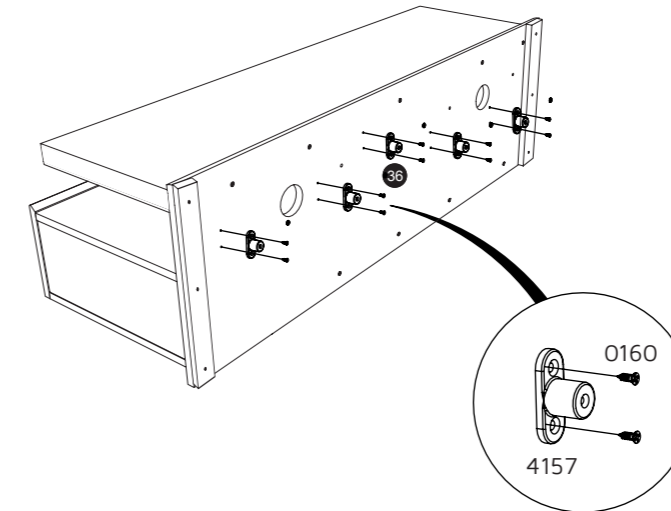

**PASSO 16**  
Encaixar **5x4157** e parafusar **10x0160**.

**STEP 16**  
Attach **5x4157** and screw **10x0160**.

**PASO 16**  
Montar **5x4157** y atornillar **10x0160**.

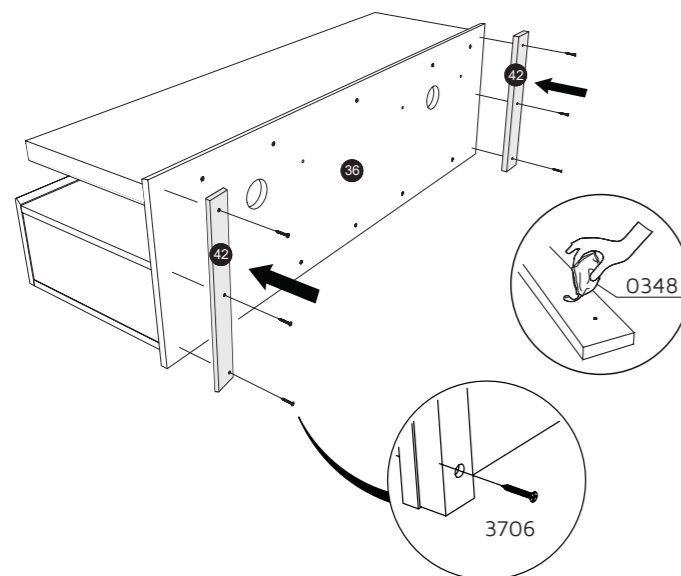

**PASSO 15**  
Passar cola **0348** e posicionar o Sarrafo **42**.  
Parafusar **6x3706**.

**STEP 15**  
Pass glue **0348** and attach the Batten **42**.  
Screw **6x3706**.

**PASO 15**  
Aplicar cola **0348** y montar el Soporte **42**.  
Atornillar **6x3706**.

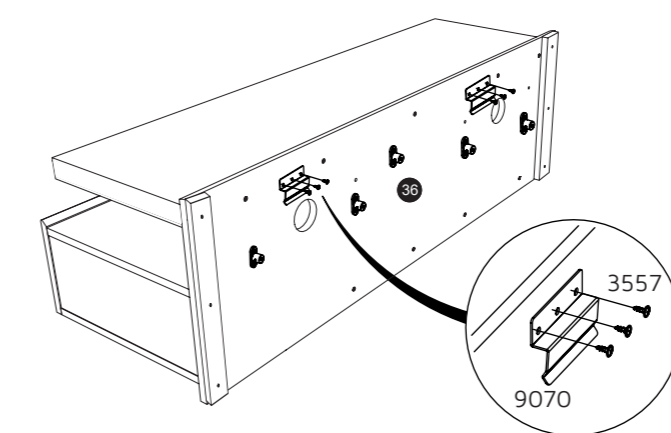

**PASSO 17**  
Encaixar **2x9070** e parafusar **6x3557**.

**STEP 17**  
Attach **2x9070** and screw **6x3557**.

**PASO 17**  
Montar **2x9070** y atornillar **6x3557**.

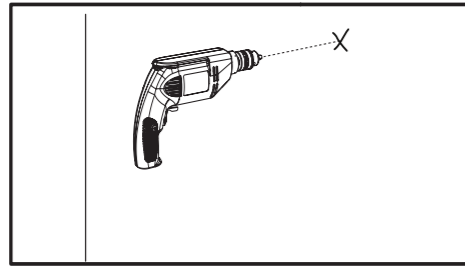

**PASSO 18**  
Furar parede com Ø8mm, conforme medidas indicadas abaixo.

**STEP 18**  
Drill wall with Ø5/16, according measure below.

**PASO 18**  
Perfurar pared con Ø8mm, de acuerdo con las medidas abajo.

As medidas superiores são referentes ao painel e as medidas inferiores são referentes ao home.

The upper measures are related to the panel and the lower measures are related to the tvstand.

Las medidas encima son para el panel y las medidas más bajos están relacionados el a la rack.

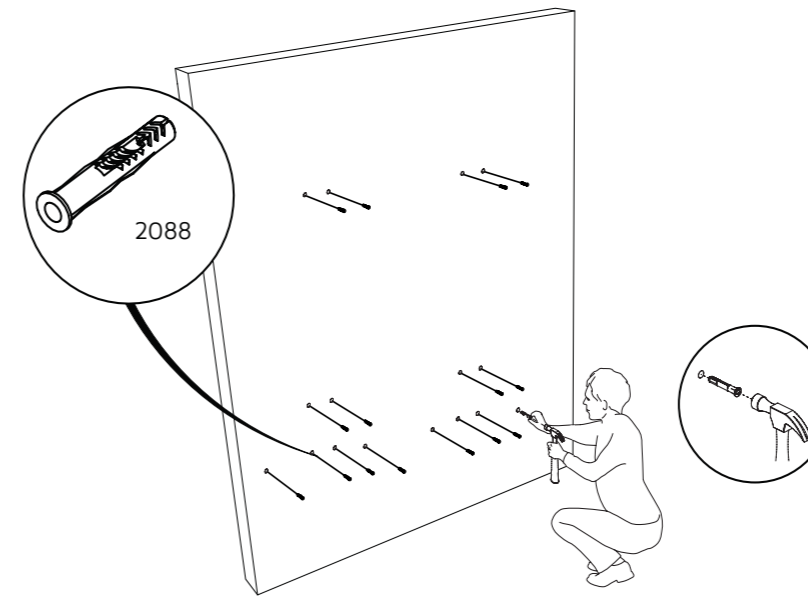
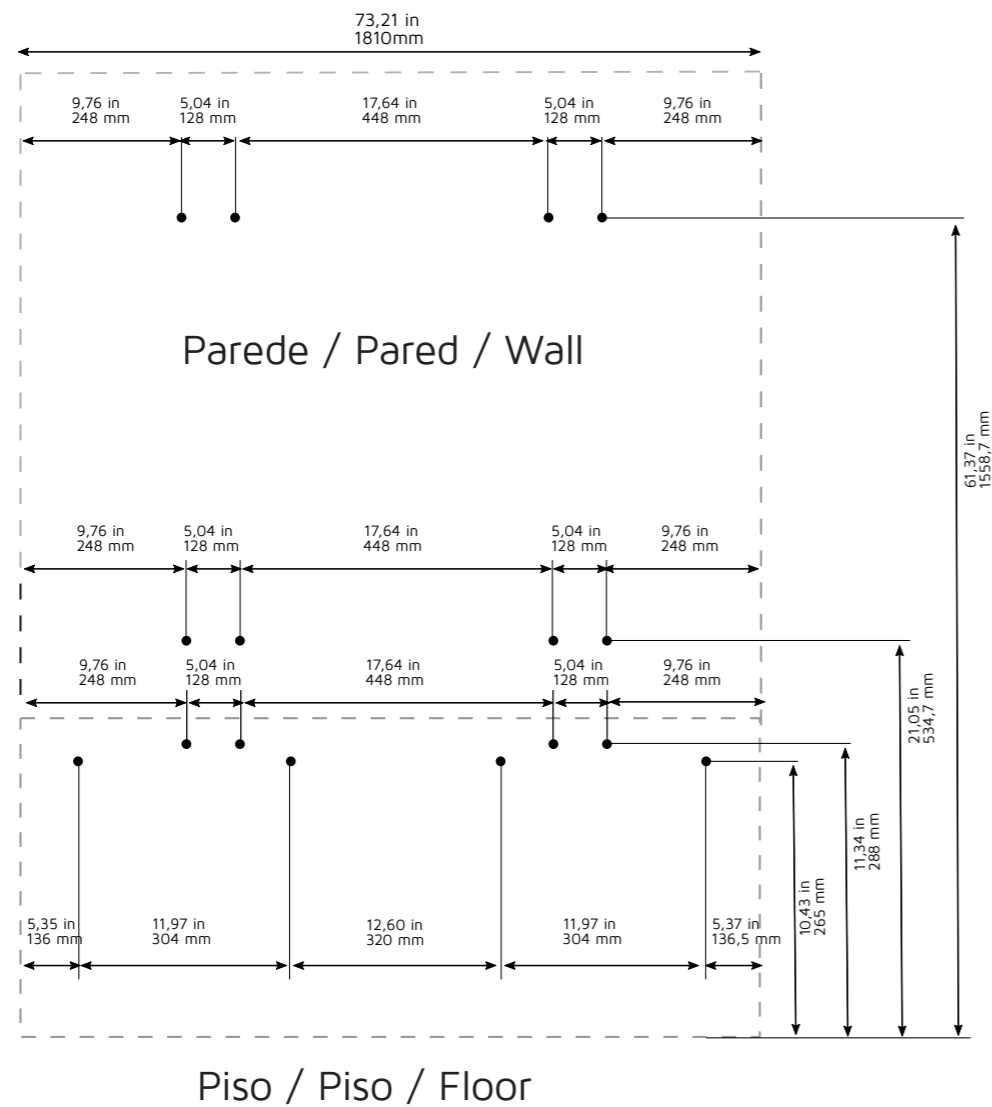

**PASSO 19**  
Encaixar buchas 16x2088 nos furos.

**STEP 19**  
Fit wal plugs 16x9088 in the holes.

**PASO 19**  
Encajar tacos de pared 16x2088 en la perforacion.

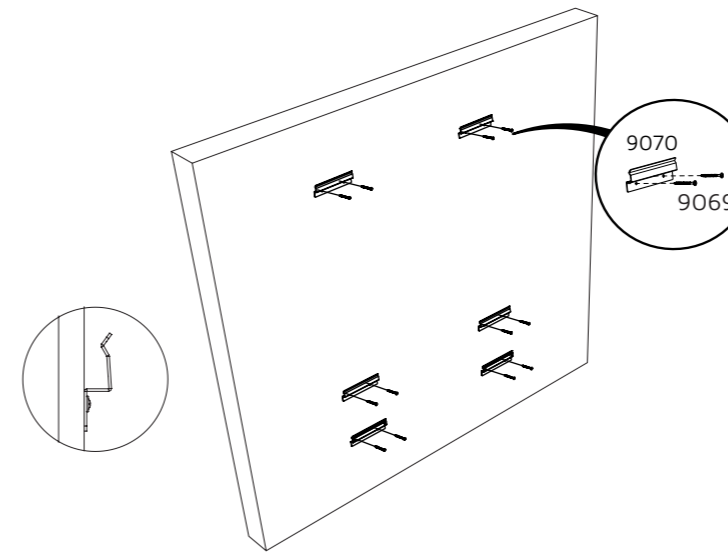

**PASSO 20**  
Posicionar 6x9070 e parafusar 16x9069.

**STEP 20**  
Place 6x9070 and screw 16x9069.

**PASO 20**  
Colocar 6x9070 y atornillar 16x9069.

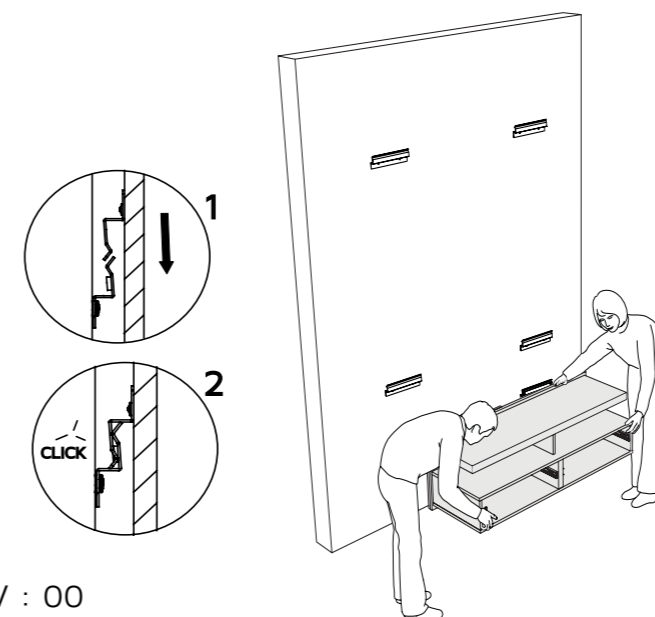

**PASSO 21**  
Encaixe o Rack na Parde.

**STEP 21**  
Attach Rack on the wall.

**PASO 21**  
Engachar el Rack en la pared.



Furar apenas uma peça por gaveta.

Drill one piece per drawer.

Perforar apenas una pieza por cajón.

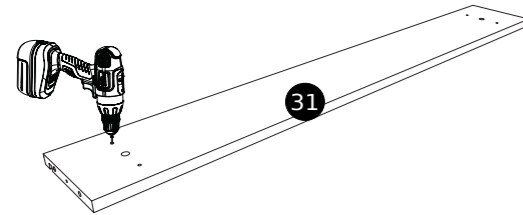

**PASSO 22**

Com a parafusadeira, termine de furar a peça **31** com broca de Ø3.0 mm.

**STEP 22**

With the screwdriver, drill trough the front of drawer **31** using Ø1/8 inch drill bit.

**PASO 22**

Use un destornillador, con 3mm para completar la perforación de la parte frontal del cajón **31**.

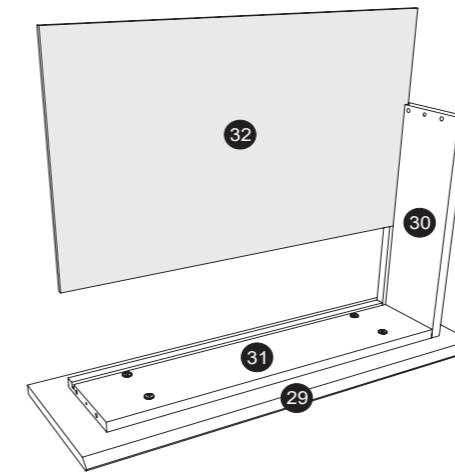

**PASSO 25**

Encaixar Fundo de Gaveta **32**.

**STEP 25**

Attach Drawer Botton **32**.

**PASO 25**

Montar Fondo del Cajón **32**.

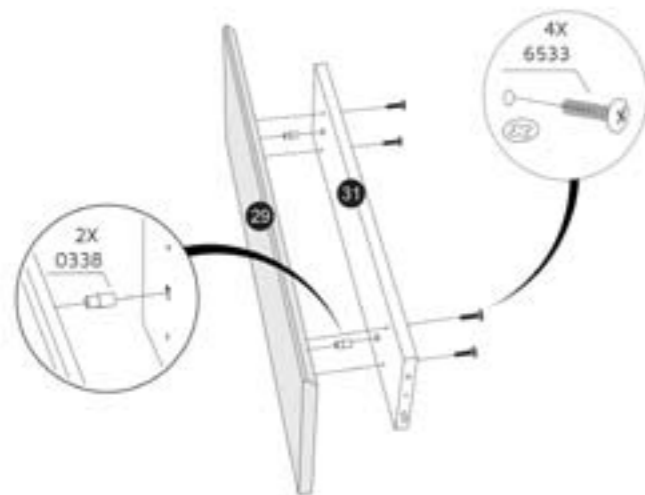

**PASSO 23**

Encaixar Contra Fundo **31** na Frente da Gaveta **29** usando 2x**0338** e parafusar 4x**6533**.

**STEP 23**

Attach Drawer Back Panel **31** to Drawer Front **29** using 2x**0338** and screw 4x**6533**.

**PASO 23**

Montar Cajón Inferior **31** en la Frente del Cajón **29** utilizando 2x**0338** y atornillar 4x**6533**.

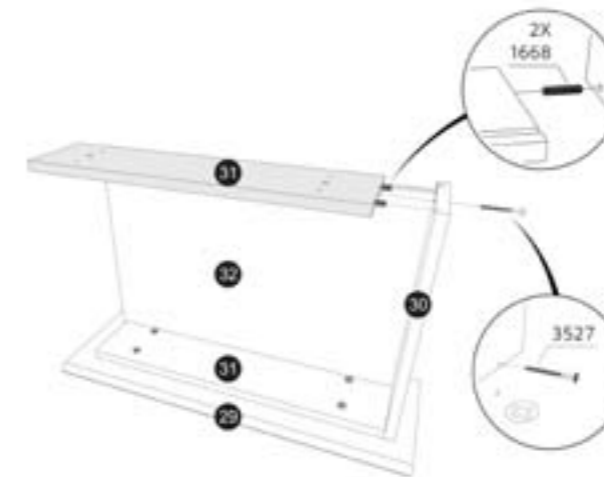

**PASSO 26**

Encaixar Contra Fundo **31** na Lateral **30** usando 2x**1668** e parafusar 1x**3527**.

**STEP 26**

Attach Drawer Back Panel **31** to Drawer Side **30** using 2x**1668** and screw 1x**3527**.

**PASO 26**

Montar Cajón Inferior **31** en Cajón Lateral **30** utilizando 2x**1668** y atornillar 1x**3527**.

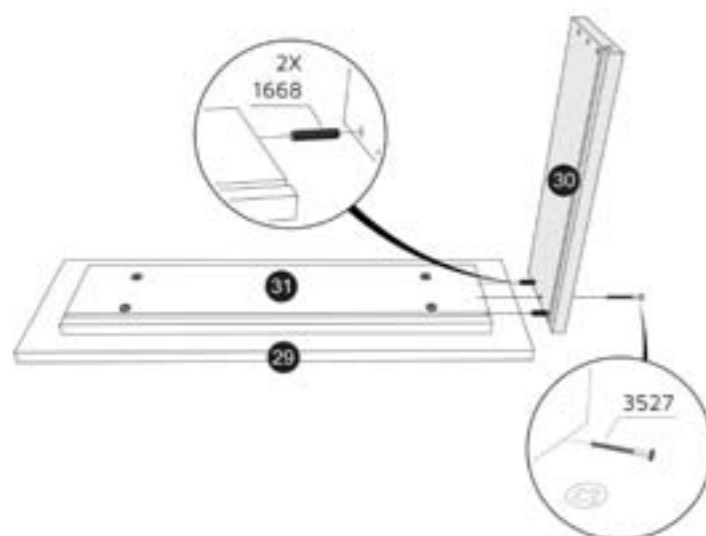

**PASSO 24**

Encaixar Lateral **30** no Contra Fundo **31** usando 2x**1668** e parafusar 1x**3527**.

**STEP 24**

Attach Drawer Side **30** to Drawer Back Panel **31** using 2x**1668** and screw 1x**3527**.

**PASO 24**

Montar Cajón Lateral **30** en Cajón Inferior **31** utilizando 2x**1668** y atornillar 1x**3527**.

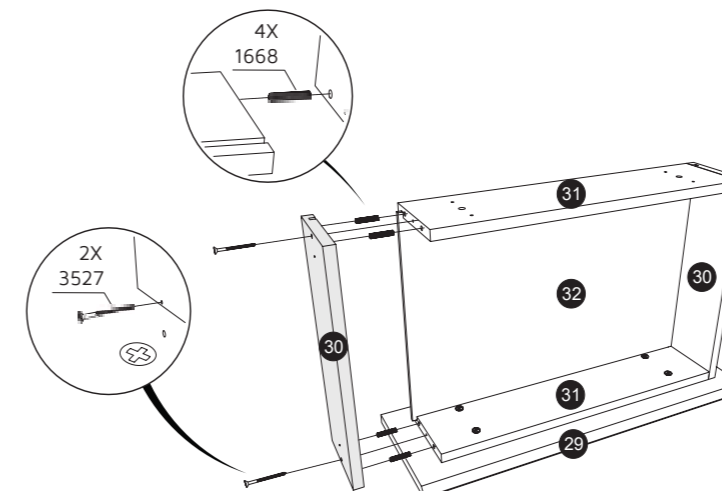

**PASSO 27**

Encaixar Lateral **30** no Contra Fundo **31** usando 4x**1668** e parafusar 2x**3527**.

**STEP 27**

Attach Drawer Side **30** to Drawer Back Panel **31** using 4x**1668** and screw 2x**3527**.

**PASO 27**

Montar Cajón Lateral **30** en Cajón Inferior **31** utilizando 4x**1668** y atornillar 2x**3527**.

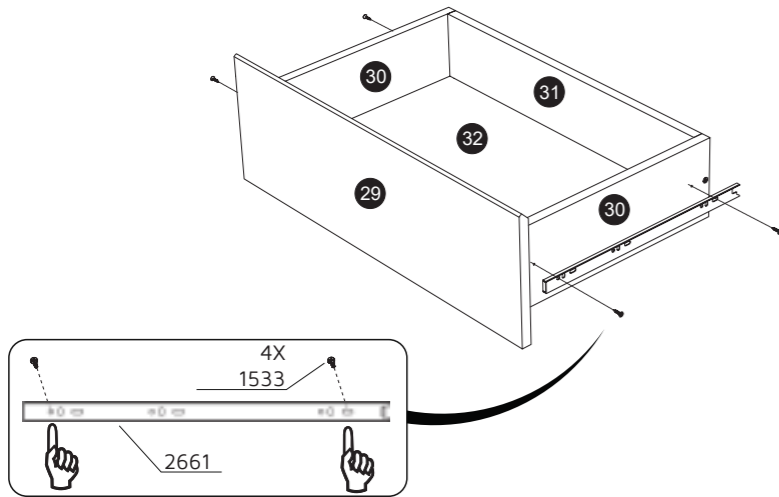

**PASSO 28**  
Parafusar 4x1533 fixando as corrediças 1x2661 nas Laterais 30.

**STEP 28**  
Screw 4x1533 to fix the slide 1x2661 on Drawer Side 30.

**PASO 28**  
Atornillar 4x1533 fijando las corrediza 1x2661 en Cajón Lateral 30.

PAINEL / PANEL / PANEL

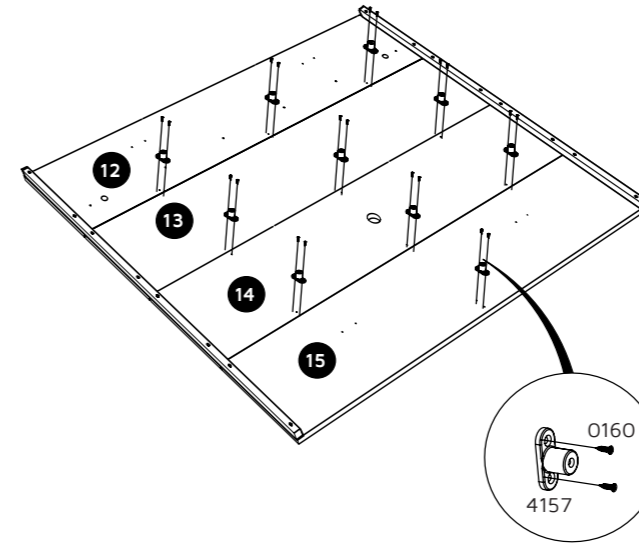

**PASSO 30**  
Encaixar 10x4157 e parafusar 20x0160.

**STEP 30**  
Attach 10x4157 and screw 20x0160.

**PASO 30**  
Montar 10x4157 y atornillar 20x0160.

PAINEL / PANEL / PANEL



PAINEL / PANEL / PANEL

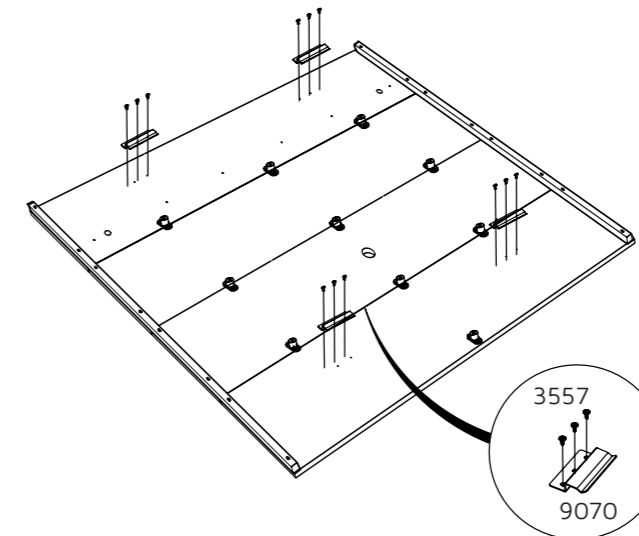

**PASSO 31**  
Encaixar 4x9070 e parafusar 12x3557.

**STEP 31**  
Attach 4x9070 and screw 12x3557.

**PASO 31**  
Montar 4x9070 y atornillar 12x3557.

PAINEL / PANEL / PANEL

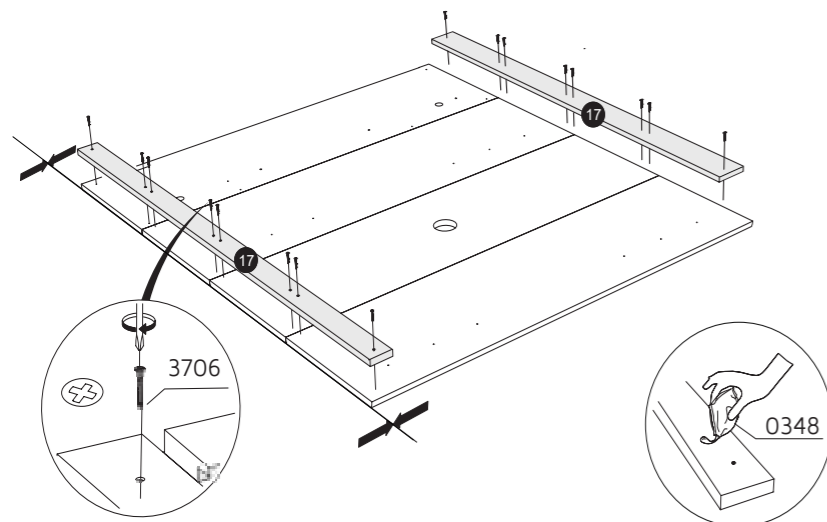

**PASSO 29**  
Passar cola 0348 e parafusar 16x3706 fixando os sarrafos 17 nos Paineis.

**STEP 29**  
Apply glue 0348 and screw 16x3706 to fix the Batten 17 on Panels.

**PASO 29**  
Aplicar cola 0348 y atornillar 16x3706 fijando el Soportes 17 in Panels.

PRATELEIRA / TOP SHELF / ESTANTE

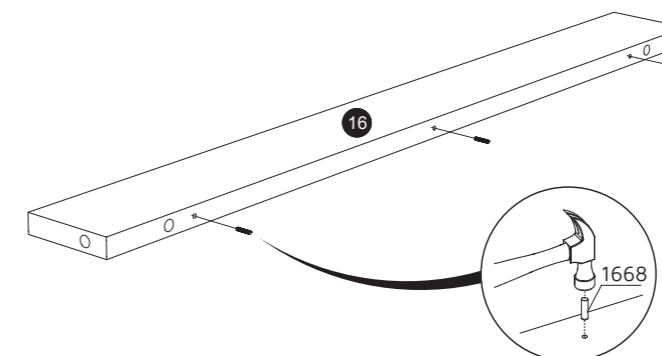

**PASSO 32**  
Encaixar cavilhas 3x1668 na Prateleira 16.

**STEP 32**  
Insert dowels 3x1668 on Top Shelf 16.

**PASO 32**  
Clavijas de ajuste 3x1668 en Estante 16.

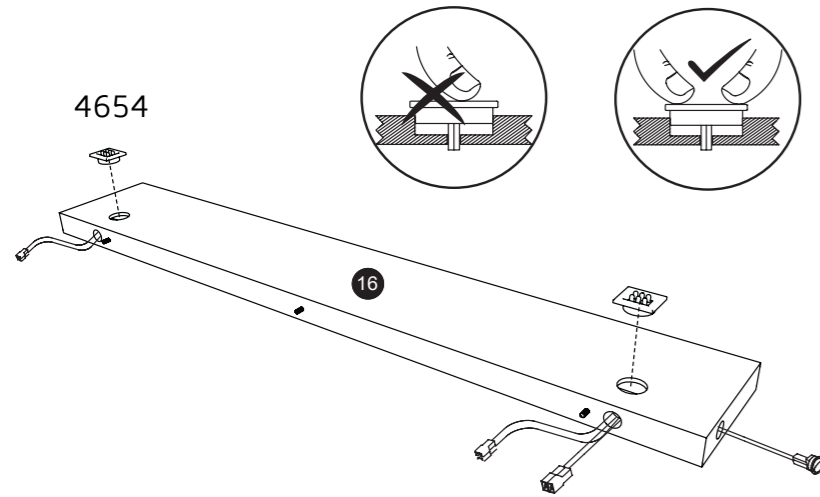

**PASSO 33**  
Encaixar 1x4654 na Prateleira 16.

**STEP 33**  
Attach 1x4654 in Top Shelf 16.

**PASO 33**  
Montar 1x4654 en la Estante 16.

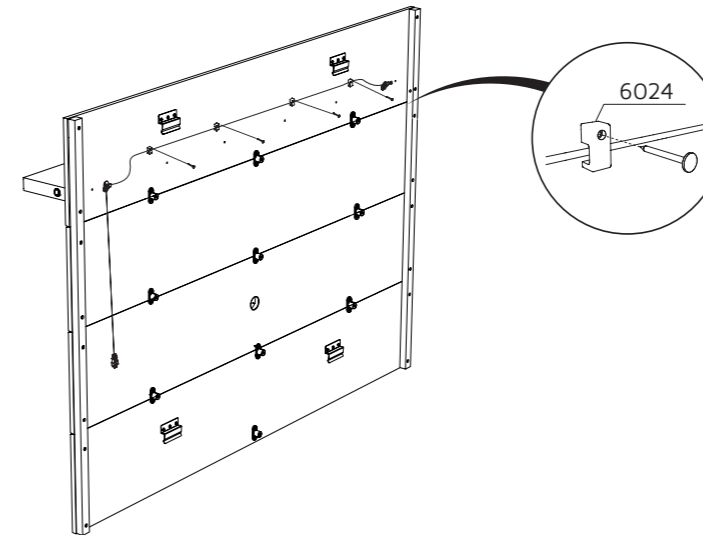

**PASSO 35**  
Pregar 4x6024 para fixar fio no Painel.

**STEP 35**  
Attach 4x6024 to fix wire Panel.

**PASO 35**  
Montar 4x6024 para la fijación de alambre en el Panel.

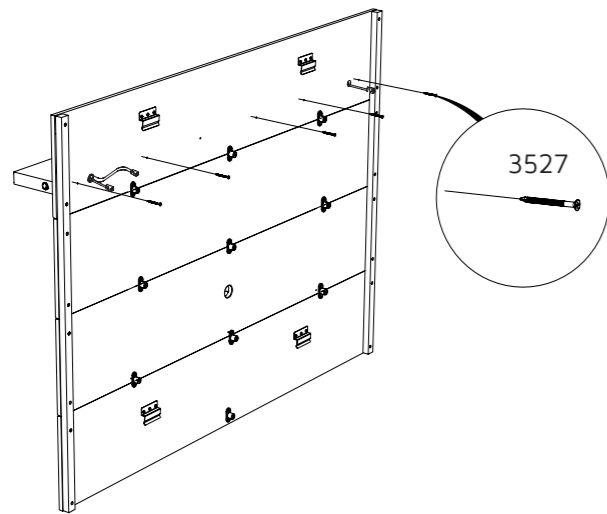

**PASSO 34**  
Encaixar Prateleira 16 e parafusar 4x3527.

**STEP 34**  
Attach Top Shel 16 and screw 4x3527.

**PASO 34**  
Montar Estante 16 y atornillar 4x3527.

Passar cabos antes de aparafusar.  
Apply cables before screwing.  
Lleve el cables antes atornillar.

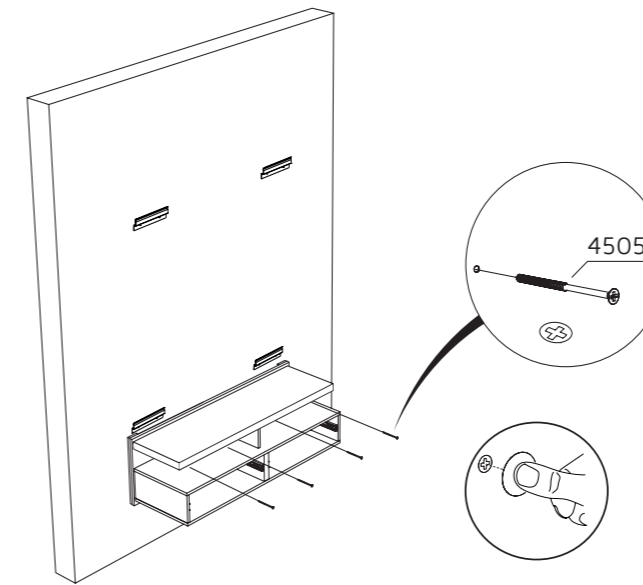

**PASSO 36**  
Parafusar 4x4505 e colar 4 adesivos.

**STEP 36**  
Screwing 4x4505 and paste 4 stickers.

**PASO 36**  
Atornollar 4x4505 y pegar 4 adhesivos.

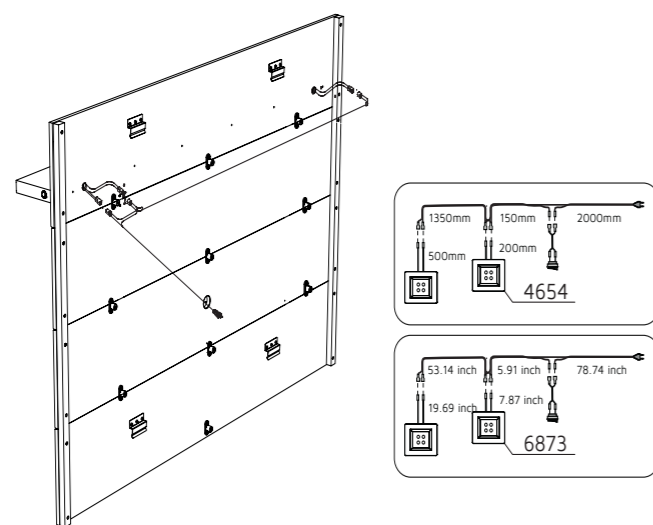

**PASSO 37**  
Encaixar 2x8717.

**STEP 37**  
Attach 2x8717.

**PASO 37**  
Montar 2x8717.

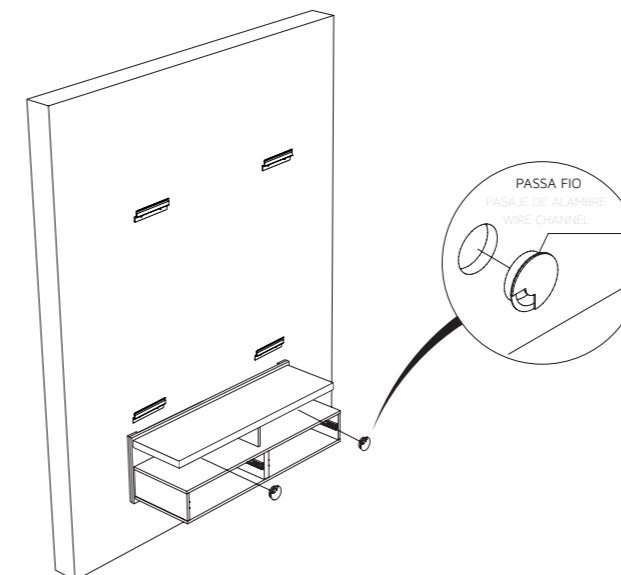

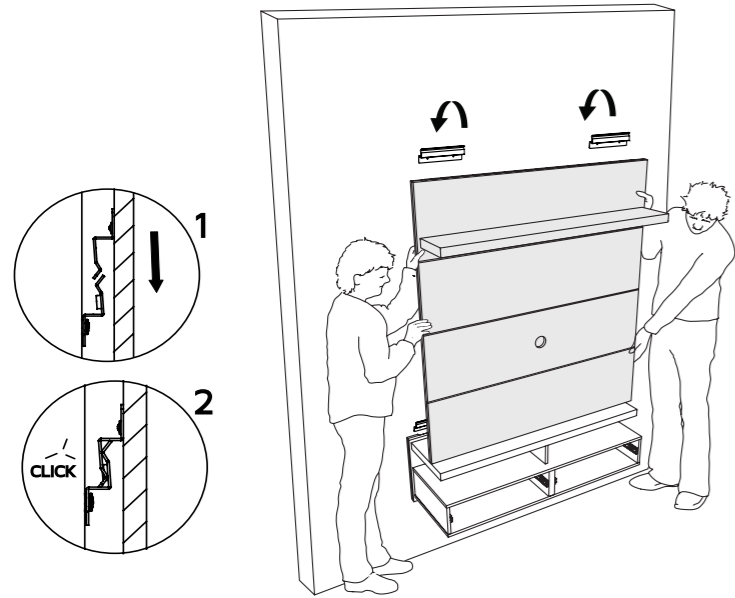

**ATENÇÃO / ATTENTION / ATENCIÓN**

Passar cabos antes de aparafusar.  
Apply cables before screwing.  
Lleve el cables antes atornillar.

**PASSO 38**  
Encaixe Painel na Parede.

**STEP 38**  
Attach Panel on the wall.

**PASO 38**  
Engachar el Panel en la Pared.

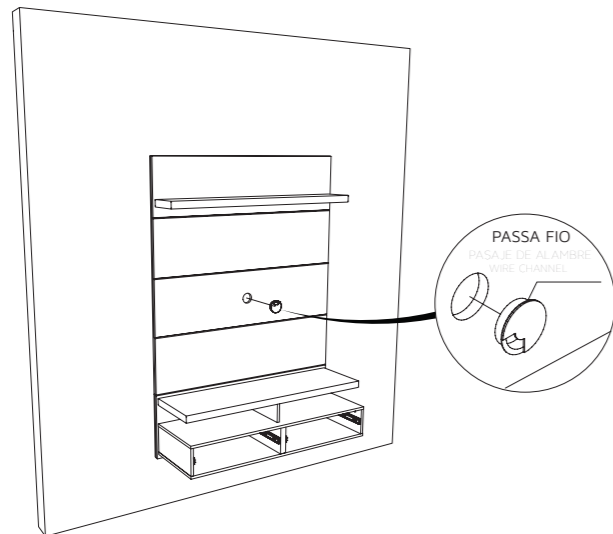

**PASSO 39**  
Encaixe 1x8717.

**STEP 39**  
Attach 1x8717.

**PASO 39**  
Enganchar 1x8717.

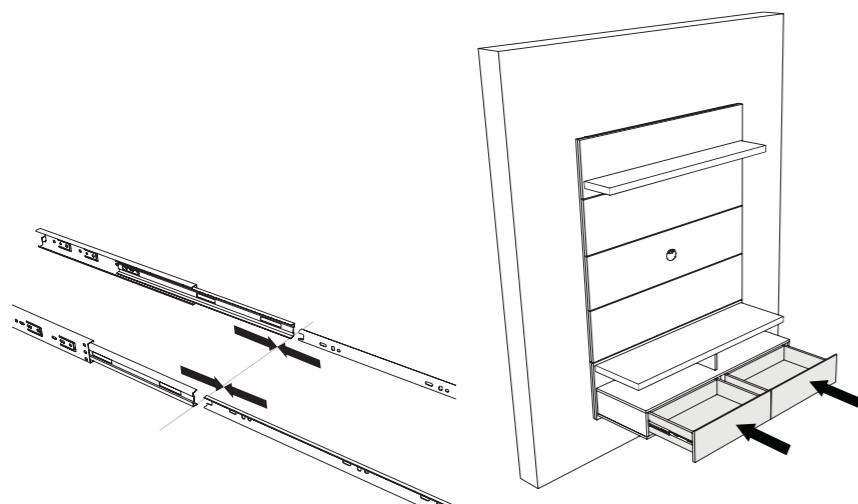

**PASSO 40**  
Encaixar a gaveta.

**STEP 40**  
Attach Drawer.

**PASO 40**  
Montar Cajón.



