

Redi Slide™...Opening Doors to Stunning Showers!™

SERIES: 2000

CONFIGURATION: Door-Door

MOUNTING PACKAGE: Frameless Sliding Door

FRAMELESS BYPASS SLIDING SHOWER ENCLOSURE

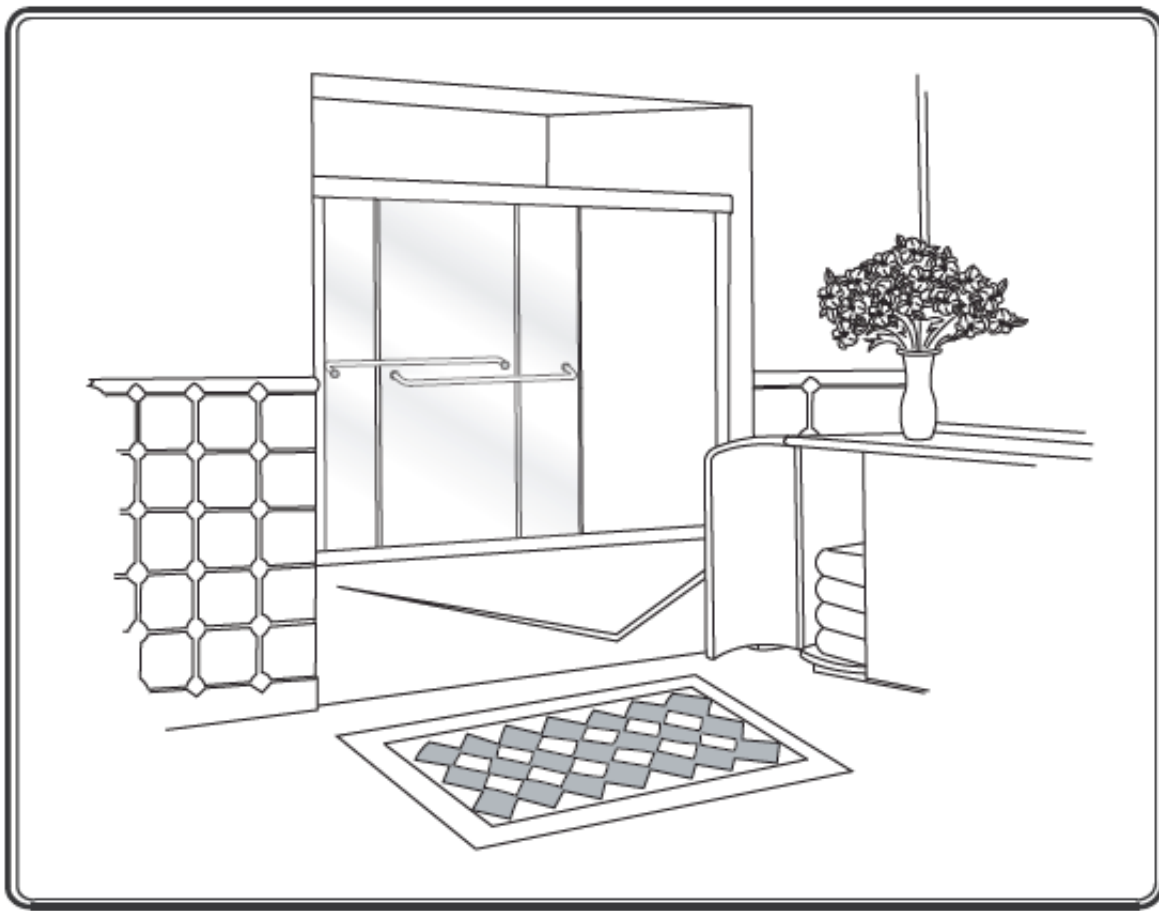

Tools:

To install your New Shower Enclosure, you may need the following:

- Pencil
- Low Tack Tape
- Tape Measure
- 4' & 6' Levels
- #2 Phillips Screwdriver
- Drill
- 1/8" & 3/16" Drill Bit
- Center Punch
- Files
- Hack Saw
- Caulk Gun
- Clear Silicone Caulk
- Suction Cups

Safety Notes:

- This unit is best installed by two people.
- Handle the glass panels carefully and protect the edges. Safety tempered glass is very resistant to breakage, but the sharp corners of the panels can damage tile and flooring surfaces.
- The glass can break if unequal pressure is applied during installation.
- Please wear safety glasses whenever drilling or cutting. When drilling holes in ceramic tile or marble, use a center punch and hammer to carefully break the glazed surface to prevent skidding when drilling.

NOTE: Tempered glass cannot be cut.

Installation Notes:

- Proper blocking is required for every Heavy Glass unit prior to installation. At minimum 2x4 blocking is required at the location of any structural member of the unit including, but not limited to: hinges, clamps, and header brackets. All fasteners at these locations are required to be installed into the blocking.
- A minimum of 1 1/4" thread engagement is required of all fasteners into the blocking at these locations. Depending on the application the customer maybe required to supply the proper fasteners to ensure adequate engagement.
- U-Channel maybe installed using wall plugs where no backing is found.
- Use caution to not pierce plumbing or electric lines while installing door hardware.
- Cover the drain with tape prior to installation to prevent loss of small parts.
- Unpack your unit carefully and inspect for freight damage. Lay out and identify all parts using the instruction sheet as a reference. Before discarding the carton, check to see that no small hardware parts have fallen to the bottom of the box. If any parts are damaged or missing, refer to the description noted in the instructions when contacting your dealer for replacements.

Maintenance:

Caring for Redi Clear™ Treated Glass

In order to maintain your ten year warranty, please follow these care instructions:

Once or twice a week, wipe down your shower door to remove body oils, soaps and shampoos from the surfaces. The glass should be cleaned every few weeks using a damp microfiber cloth and a mild detergent or soap to remove any soap scum and grime from the glass. Do not use paper towels or any abrasive tool to clean the surface. The sealed surface is warranted with regular maintenance and without the use of any harsh chemicals or detergents.

Caring for Non-Treated Glass

After each use, rinse with water and wipe down your enclosure with a soft cloth/towel or squeegee to maintain that like-new look. The glass should be regularly cleaned using a damp microfiber cloth and a mild detergent or cleaner to remove any soap scum and grime from the glass. We recommend Lysol Bathroom Cleaner as safe for shower doors, but please test any commercial cleaning solutions on an inconspicuous area before applying to the entire enclosure. Be sure to rinse all surfaces completely and wipe dry. Never use any abrasive material or harsh chemicals to clean surfaces and do not allow cleaners to soak on surfaces.

PARTS LIST

ITEM	DESCRIPTION	QTY.
A	Wall Jamb	2
B	bottom Track (w/ Silencer)	1
C	Plastic Wall Anchor	6
D	#8 x 1 1/2" Truss Head Screws	6
E	Clear Jamb Bumper	6
F	Nylon T-Lock	2
G	Header	1
H	Hanger Bracket (Pre-Attached)	4
J	Glass Door Panel	2
K	Glass Hole Sleeve	4
M	Heavy Glass Roller	4
N	#8-32 x 3/8" Roller Screw	4
P	Back Plate	4
R	Clear Plastic Disc	8
S	Front Plate	
U	Towel Bar	2
V	Bottom Guide	3
W	#6 x 3/8" Pan Head Screw	3
X	Nylon Jamb Cover	2

*Quantities may vary.

**Support bar only included if necessary.

EXPLODED VIEW

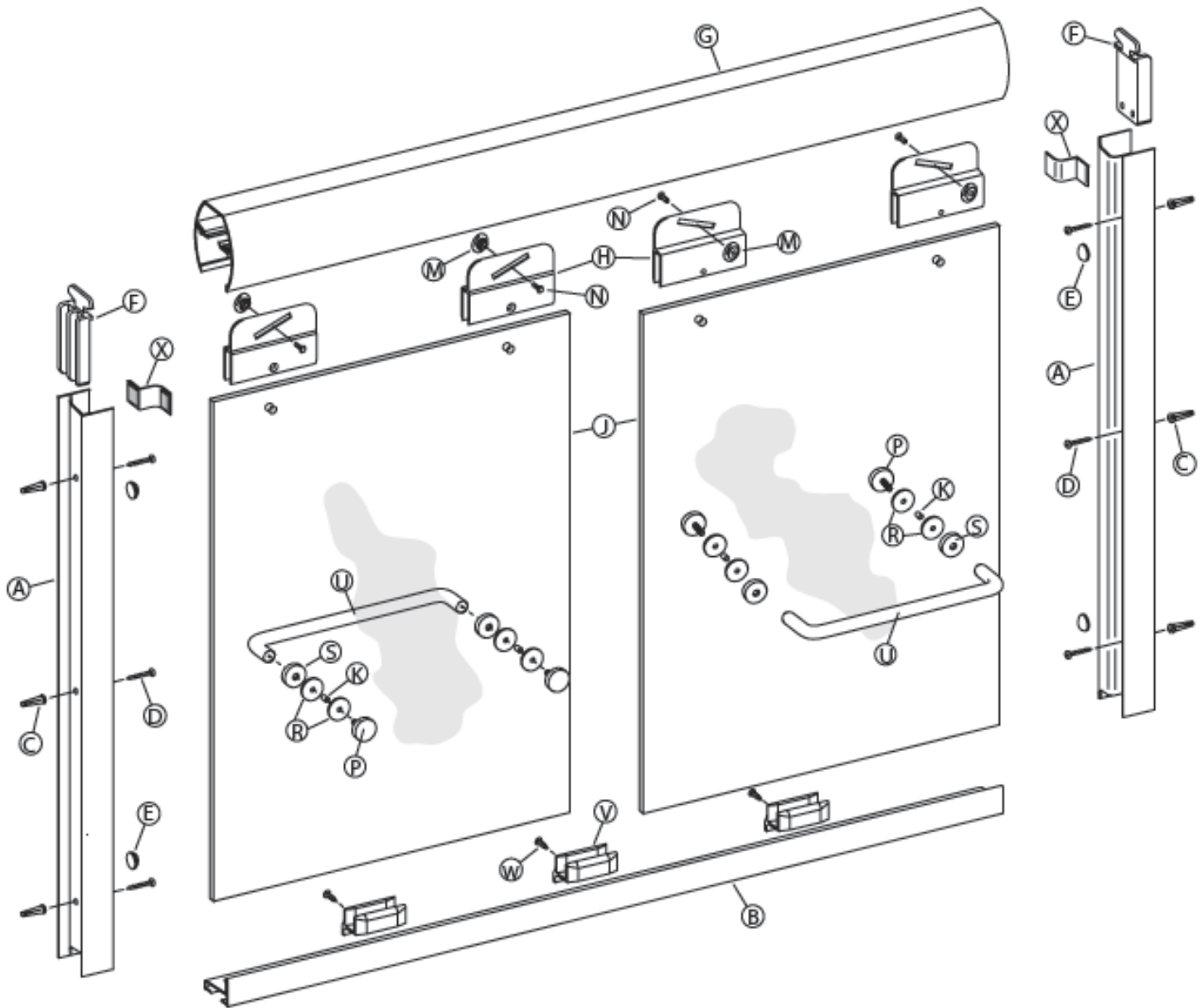

1 This frames bypass sliding enclosure is supplied with pocketed wall jambs [A]. The jambs are notched on both ends to fit over the bottom track. It is important to determine the proper orientation of the unit before marking and drilling the walls. For maximum waterproofing, position the “open” pocket of the wall jamb to the interior for the shower head wall. This will force the interior panel to be on the shower head side. (see illustration)

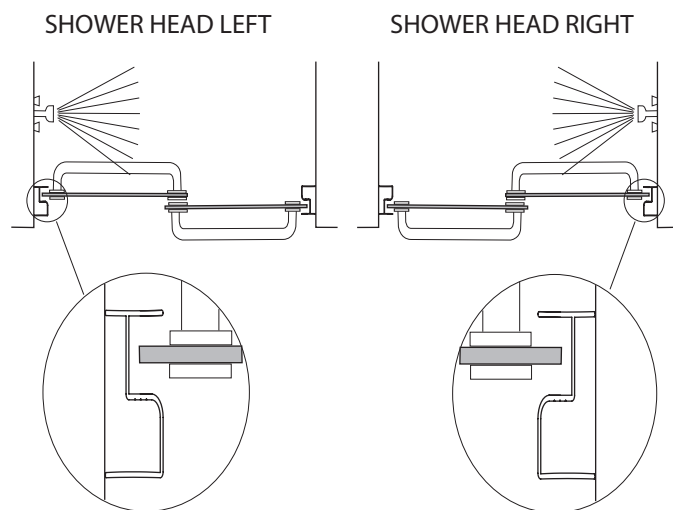

2 Measure the wall-to-wall opening along the center of the threshold at the bottom. Cut the bottom track (w/ vinyl silencer) [B] 1/16” short of that dimension.

Position the bottom track in the center of the threshold with the raised edge to the exterior. It may be necessary to file a radius on the ends of the track and wall jambs to match the corners of the opening.

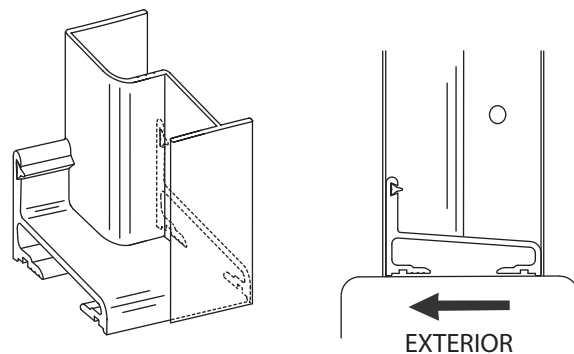

3 Place one wall jamb over the track and against the wall. Using a level, plumb the wall jamb and mark the hole locations on the wall with a pencil. Repeat this step for the other wall jamb. (Be sure that the curb does not move) Mark along both inside and outside of the track. Remove all parts and drill the holes.

Tile, marble or solid surface walls:

Drill 3/16” diameter holes into the walls and insert the plastic wall anchors [C].

Fiberglass or acrylic units can be done two different ways:

If the walls are not reinforced, drill 3/16” diameter holes and insert the plastic wall anchors. (Toggle bolts may be used instead but they are not provided).

If the walls are reinforced, only drill 1/8” diameter holes.

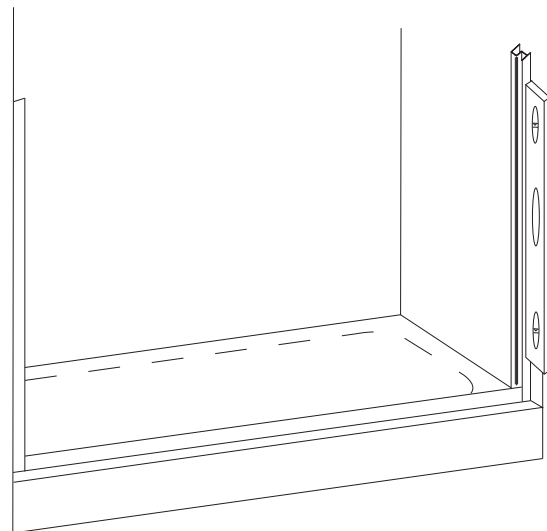

4 Before replacing the track, force a slight downward bow into it. This will ensure that the track fits tight to the threshold in the middle.

Run a bead of silicone on both flat surfaces on the bottom of the track. Then replace the track onto the threshold using the pencil marks from step #3 as a guide. Be sure the raised side is on the **exterior**.

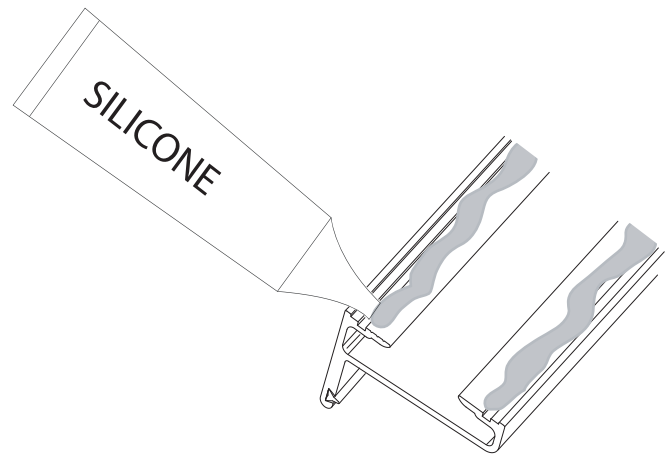

5 Replace one wall jamb and attach it to the wall with the #8 x 1 1/2" truss head screws [D]. Check the wall jamb for plumb and tighten the screws.

Repeat for the other wall jamb.

NOTE: Careful not to overtighten.

Peel the backing from four of the clear jamb bumpers [E] and attach them inside the pockets of the wall jambs. Place the bumpers approximately 1" above the bottom screw and 1" below the top screw.

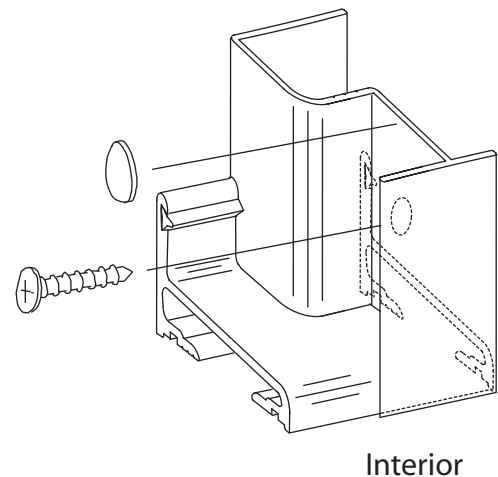

6 This enclosure is equipped with molded nylon T-Locks [F] for safety. When properly installed, the header is locked to the wall jambs and cannot be accidentally removed.

Measure the wall-to-wall opening at the top of the wall jambs. Cut the header 1/16" short of that dimension. Check for fit.

TIP: Use a miter box to ensure a straight cut

Slide one of the T-Locks into one end of the header. Set the header down onto the wall jamb with the T-Lock fitting into the space behind the wall jamb. Remove the top truss head screw. Pull the header and T-Lock down until the truss head screw can be replaced.

Repeat for the other T-Lock.

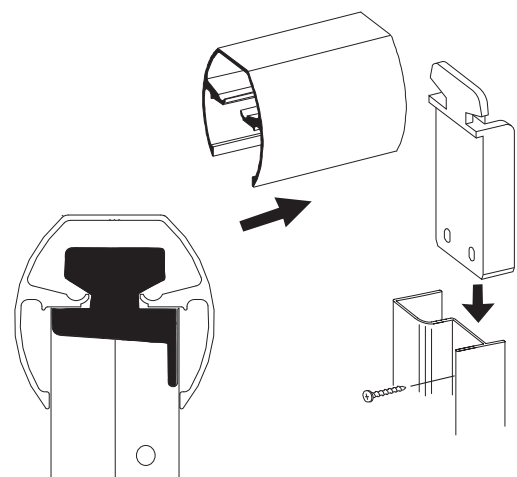

7 Attach the four black heavy-duty roller bearings [M] to the door hanger brackets [H] as shown using the #8-32 x 3/8" hex head screws [N]. The rollers should be approximately in the center of the slots of the bracket fins.

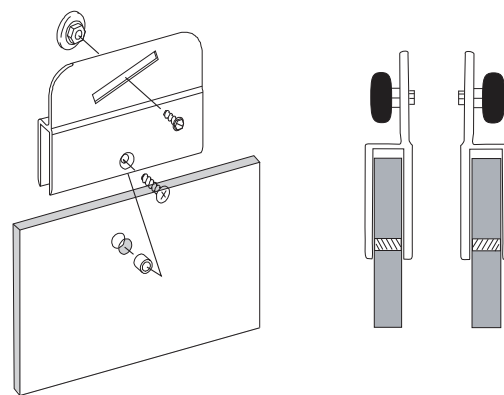

8 Place one panel [J] on the inside of the shower/tub with the rollers facing the back wall and the textured side of the panel facing the outside (if applicable). Set it on a drop cloth or piece of cardboard to protect the glass and the shower/tub surface.

From the outside of the shower/tub, grab the other panel with the rollers (and textured side of glass) facing you and lift the panel. Lower it into the shower/tub and then lift it into the header. Be sure the bracket fins and rollers are above the track groove. Carefully lower the panel until the rollers are seated into the groove.

Slide the panel to one side and step inside the shower/tub and step inside. Repeat the previous steps for the inside panel.

Check for alignment along the bottom and sides of each panel and adjust the rollers as necessary.

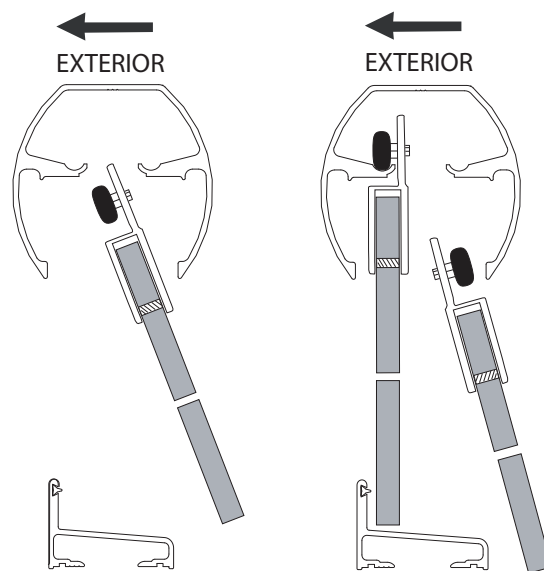

9 Slide one of the clear plastic discs [R], then a glass hole sleeve [K] onto the threaded back plate [P]. Push the assembly through the hole in the glass panel so that the glass hole sleeve is flush with the other side of the panel. Slide the other clear plastic disc onto the protruding threaded part of the back plate, and then slide on the front plate [S]. Repeat this for the second hole on the panel. While holding the towel bar [U] in place, and screw the back plates into the towel bar. Use the provided Allen wrench and the small hole drilled into the side of the back plate to fully tighten the towel bars.

**NOTE: Outer panel has towel bar facing Out.
Inner panel has towel bar facing In.
Refer to the diagram in step #1.**

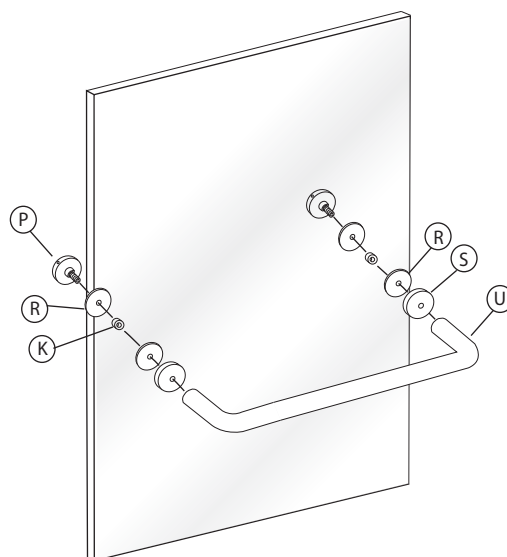

10 Place one of the clear bottom guides [V] in the middle of the tub track as shown. Using the hole in the back of the bottom guide, drill a 1/8" hole into the inside of the tub track.

Attach the bottom guide with a #6 x 3/8" pan head screw [W].

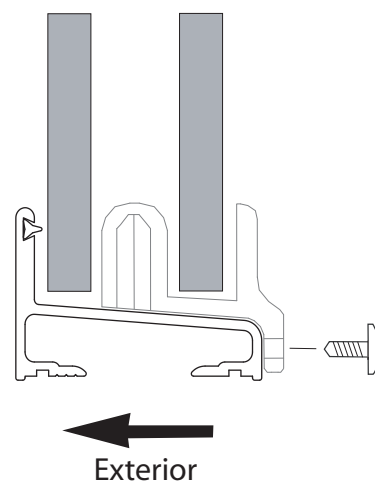

11 Remove the protective backing from the two squares of tape on the back side of the nylon jamb covers [X]. Place the jamb covers against the wall jambs at the top, inside of the header. Press in place.

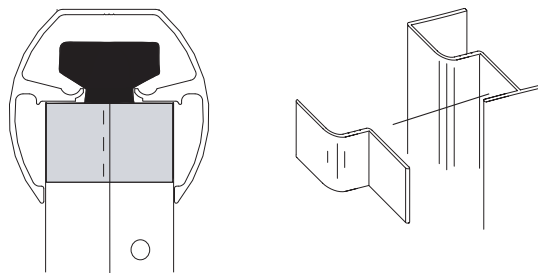

12 Peel the backing from two of the clear jamb bumpers [E] and place them against the wall jambs on the outside of the pockets, one on each wall jamb. Press them into place approximately in the vertical center of each wall jamb.

NOTE: The placement of these final two clear jamb bumpers may vary depending on any out-of-plumb conditions that may exist. Adjust accordingly.

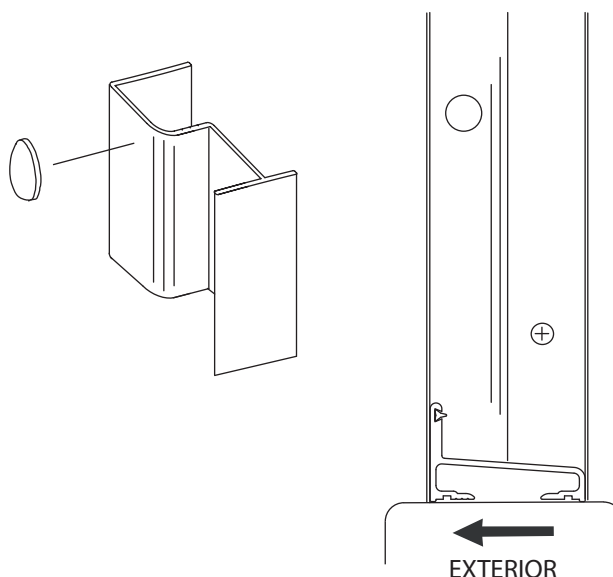

13 Neatly silicone each end of the tub track where it fits into the wall jambs as well as the seam between the wall and the wall jamb and the curb and threshold on the inside of the shower.

NOTE: Silicone on the exterior seam is optional.

NOTE: DO NOT USE the shower until the silicone is completely cured. Check the tube of silicone for the manufacturer recommended cure time.
(typically 24 - 48 hours)

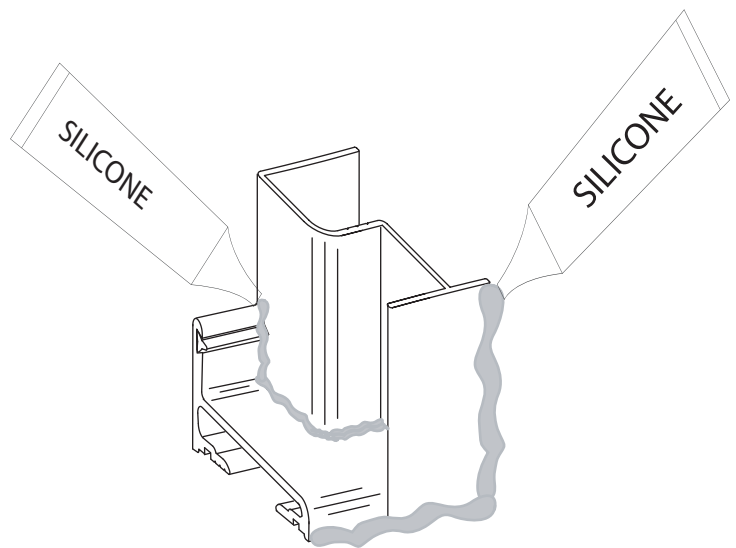

Tile Ready® Brand Shower Pan Installation Addendum

SPECIAL INSTRUCTIONS FOR REDI DOOR® ENCLOSURE INSTALLATIONS WITH TILE READY® BRAND SHOWER PANS

Designated screw pack for Tile Ready® Brand Shower Pans:

For Redi Door® enclosure installations with a Tile Ready® brand shower pan, a special screw pack containing eight (8) #8x $\frac{3}{4}$ " pan-head screws is included with your door. These #8x $\frac{3}{4}$ " screws replace curb screws included in the main hardware package, and their use is mandatory. Set drill stop at 5/8" to avoid piercing the shower pan curb.

FAILURE TO USE THE CORRECT SCREWS & FOLLOW THESE INSTRUCTIONS WILL VOID THE TILE READY® BRAND SHOWER PAN LIMITED WARRANTY.

1. Align the u-channel in the proper position on the curb/entrance
2. Mark and drill a 3/16" hole through the u-channel
3. Transfer this location to the tile and drill a 3/16" hole through the tile and grout only
4. Insert a dab of silicone caulking into the hole
5. Put the u-channel in place.
6. Using the provided #8 x $\frac{3}{4}$ " pan-head screw, fasten the u-channel in place on the curb.

Special instructions for Tile Ready® Brand Barrier Free entrances:

For Redi Door® enclosure installations on a Tile Ready® brand BARRIER FREE entrance, only silicone seal should be used to attach enclosure parts to the shower pan entrance. No screws or nails should be used to install enclosure hardware into the shower pan entrance.

THE USE OF SCREWS OR NAILS IN THE BARRIER FREE ENTRANCE WILL VOID THE TILE READY® BRAND SHOWER PAN LIMITED WARRANTY.