

Central Brass Company, Inc.

3325 S. Garfield Ave.
Commerce, CA 90040
(800) 321-8630
www.centralbrass.com

INSTALLATION

Tools:



Adjustable Wrench



Flat Head Screwdriver



Teflon Tape



Rags

Model Number: 3127-AN1, 3127-AVN1



Warnings and Notes:

Check with local plumbing code requirements before installation.

This product should be installed by a local listed plumber.

Do not use plumbers putty on threads.

Installation Steps:

Slow-Close Two Handle Lavatory Faucet

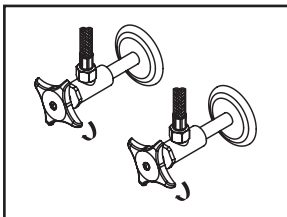

(1) Shut off water supplies. Remove old faucet. Clean mounting surface in preparation for new faucet.

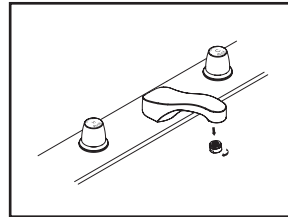

(6) Important: After installation is complete, remove aerator. Turn on water supplies, push down and hold the handle to allow both hot and cold water to run at least one minute each. While water is running, check for leaks. Release the handle and replace aerator.

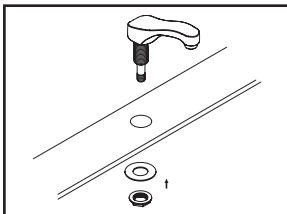

(2) Apply plumbers putty on the bottom of the spout, place spout in position on the sink, slide washer through spout shank from underneath of the sink, thread locknut onto spout shank and tighten the locknut.

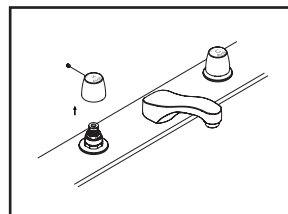

(7) The slow close cartridge is factory preset timing to 10 seconds@60 PSI. Depending on the inlet water pressure and water temperature this timing can vary. If timing need to be changed, remove the handle by loosening handle set screw.

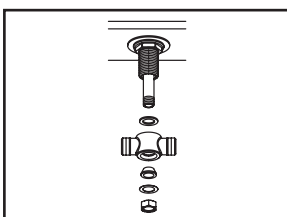

(3) slide "cross" connector, slip joint washer and brass washer through brass spout tube then thread hex nut onto brass spout tube and tighten hex nut.

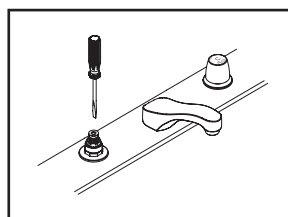

(8) With the help of flat head screwdriver, loosen the screw to decrease the timing and tighten the screw to increase the timing. The timing can be adjusted from 0 to 60 seconds depending on the inlet pressure and water temperature.

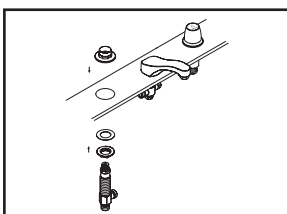

(4) Apply plumbers putty on the bottom of the escutcheon, slide locknut and gasket onto side valve, insert side valve through mounting hole from underneath of the sink, thread escutcheon from the top of the side valve, adjust side valve's height then tighten locknut from underneath with the help of a wrench. Repeat the same procedure to install the other side valve.

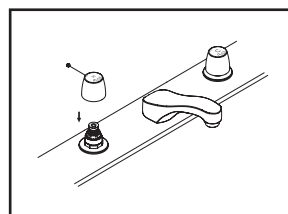

(9) Once the satisfactory timing has been adjusted, install the handle by tightening handle set screw.

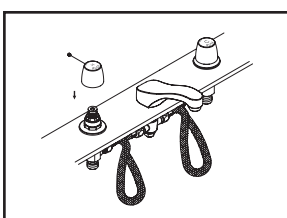

(5) Connect both side valves outlet to "cross" connector with supplied flex hose. Installed handle to side valve by tightening handle set screw.

Central Brass
COMPANY, Inc.

For more care information or trouble shooting inquiries about your Central Brass product, please call:

Central Brass Company, Inc. (800) 321-8630

Monday-Friday 8 AM to 8 PM EST (5 AM to 5 PM PST)

www.centralbrass.com