

Model: YJA1000101  
YJA1000102

Emrys Wall Bar

Top



Front

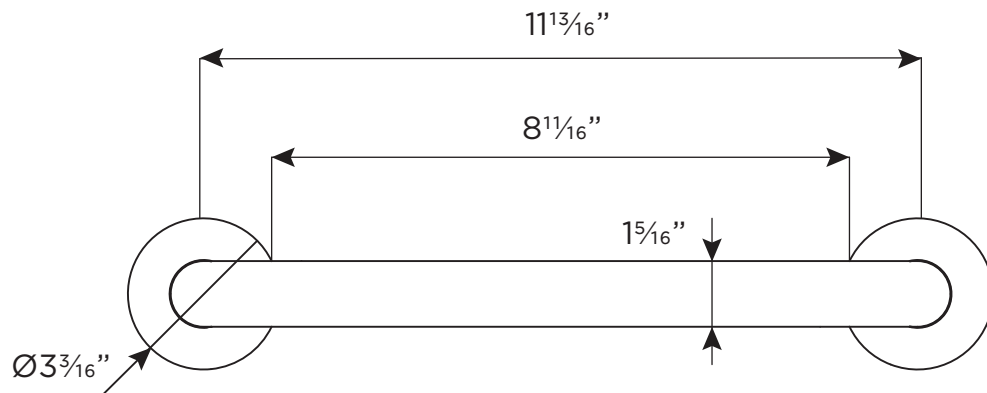

All measurements are approximate and may vary +/- 1/4"

# Maykke

[www.maykke.com](http://www.maykke.com)

## **Installation and Warranty Guide**



Wall Bars

YJA1000101 YJA1000102

**NOTICE:** Do not change or modify the product in any way. Doing so may compromise the products structural integrity and will void the warranty.

**NOTICE:** Installation instructions must be followed. Any diversions from the installations instructions may risk property damage and will void the warranty.

### IMPORTANT:

Observe all state and local building codes.

### WARNING:

Anchors are only to be used when installing into drywall. If you are installing into a wood beam do not use the anchors. If you are installing on ceramic tiles or any surface other than drywall, please consult your local home improvement store.

## PRE-INSTALLATION

### Tools Required

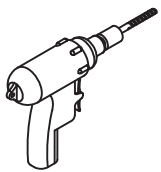

Drill



Safety goggles



Phillips  
screwdriver

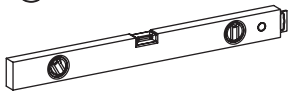

Level

### Parts Included

6 sets

A



B

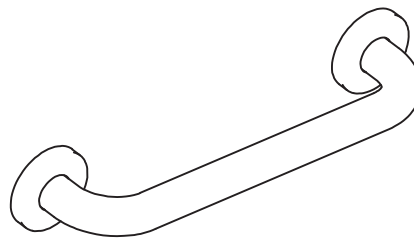
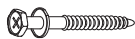

1. Mark your desired position on the wall, using a drill, drill pilot holes.

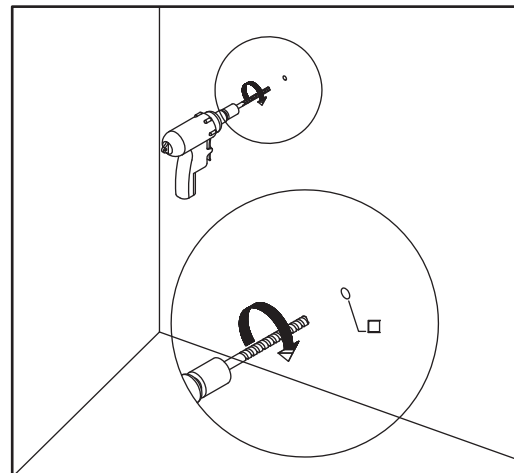

2. Insert the plastic wall anchors (part A) into the holes, making sure the anchor and the wall are even.

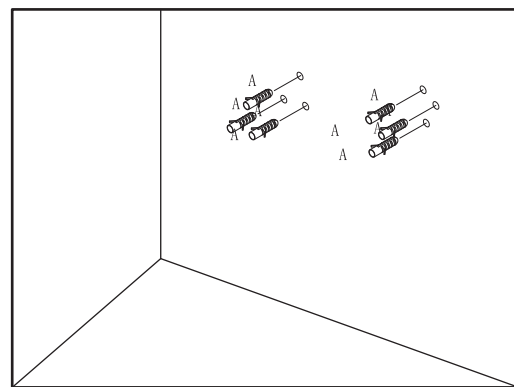

3. Screw part B through plate into the anchors. Place coverplate back to secure the plate.

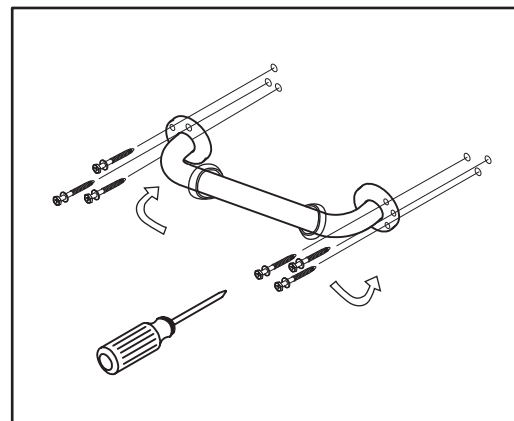

For warranty information please check [www.maykke.com](http://www.maykke.com)

For customer service concerns please email: [support@maykke.com](mailto:support@maykke.com)