

Venetian Oil Rubbed Bronze Long Dual Handle Wall Mount Faucet

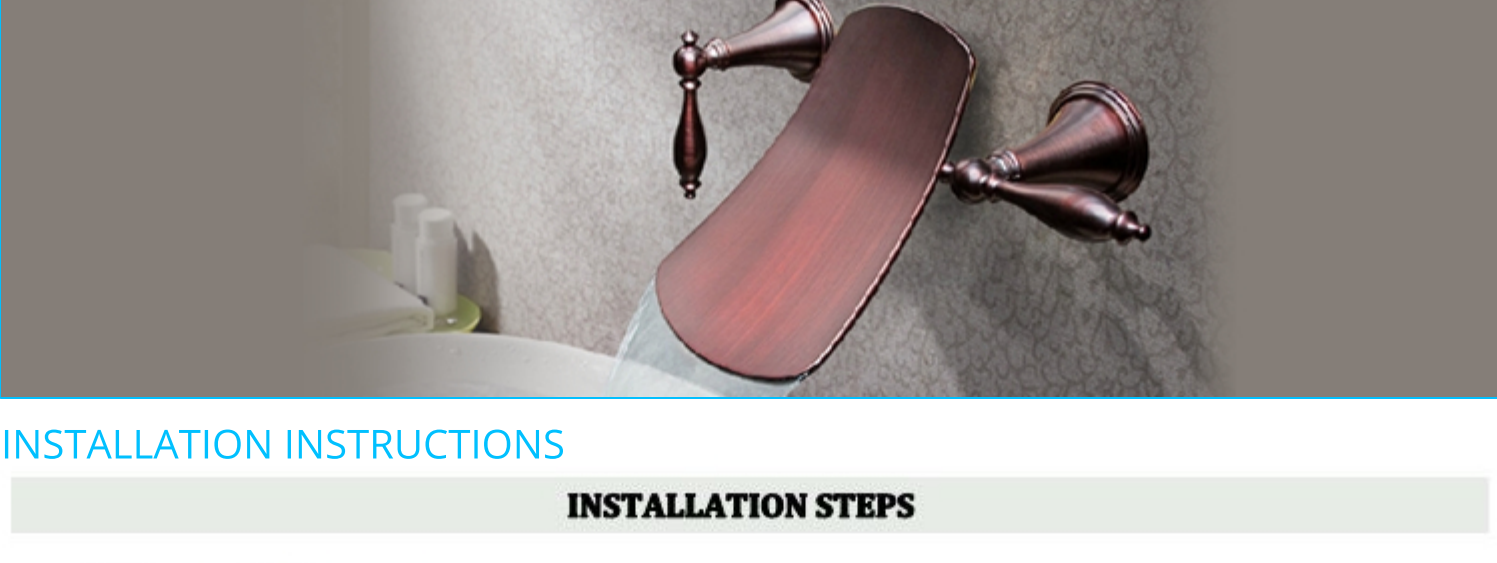

INSTALLATION INSTRUCTIONS

INSTALLATION STEPS

1. BEFORE PROCEEDING

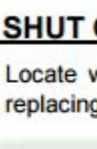

WARNING: Read all the instructions completely before proceeding. SUMERAIN recommends calling a professional if you are uncertain about installing this product! this product should be installed in accordance with all local and state plumbing and building codes.

2. SHUT OFF WATER SUPPLY

Locate water supply inlets and shut off the water supply valves. These are usually found near the water meter. if you are replacing an existing unit, remove the old unit and clean the mounting surface thoroughly.

TOOLS RECOMMENDED

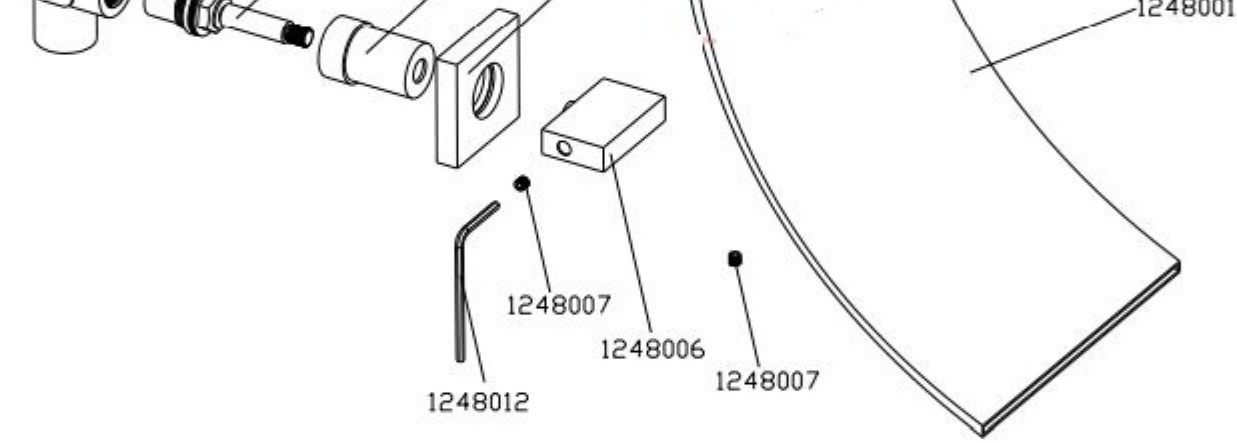
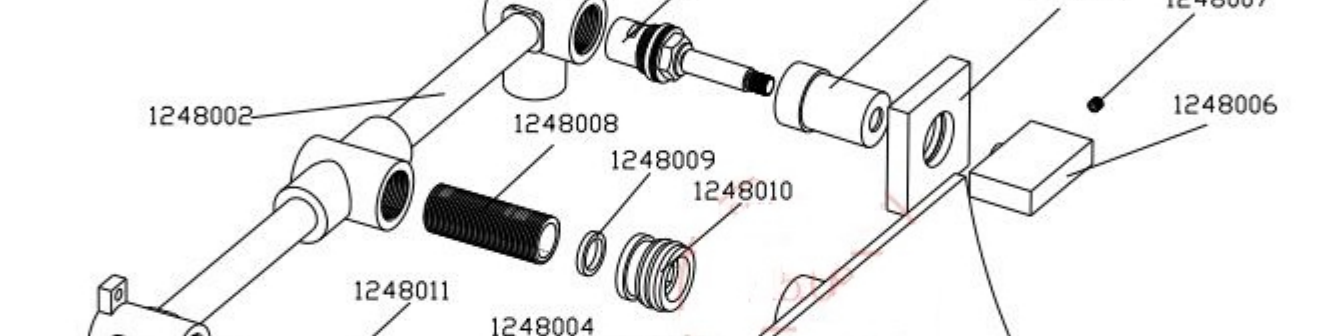

EXPLODE VIEW

CODE	ITEM NAME	QTY	CODE	ITEM NAME	QTY
1248001	Spout	1PCS	1248002	Rough-in valve body	1PCS
1248003	Cold disc cartridge	1PCS	1248004	Sleeve	2PCS
1248005	Escutcheon	2PCS	1248006	Knob	2PCS
1248007	Set screw	3PCS	1248008	Spout shank	1PCS
1248009	washer	1PCS	1248010	Spout Nipple	1PCS
1248011	Hot disc cartridge	1PCS	1248012	Allen wrench	1PCS

4. VALVE TRIM INSTALLATION

4.1 Make a mounting rack (normally use woods as materials) for preparing install the rough-in valve trim. The mounting board's face should be 54mm (2-1/8") at least behind the finish wall surface.

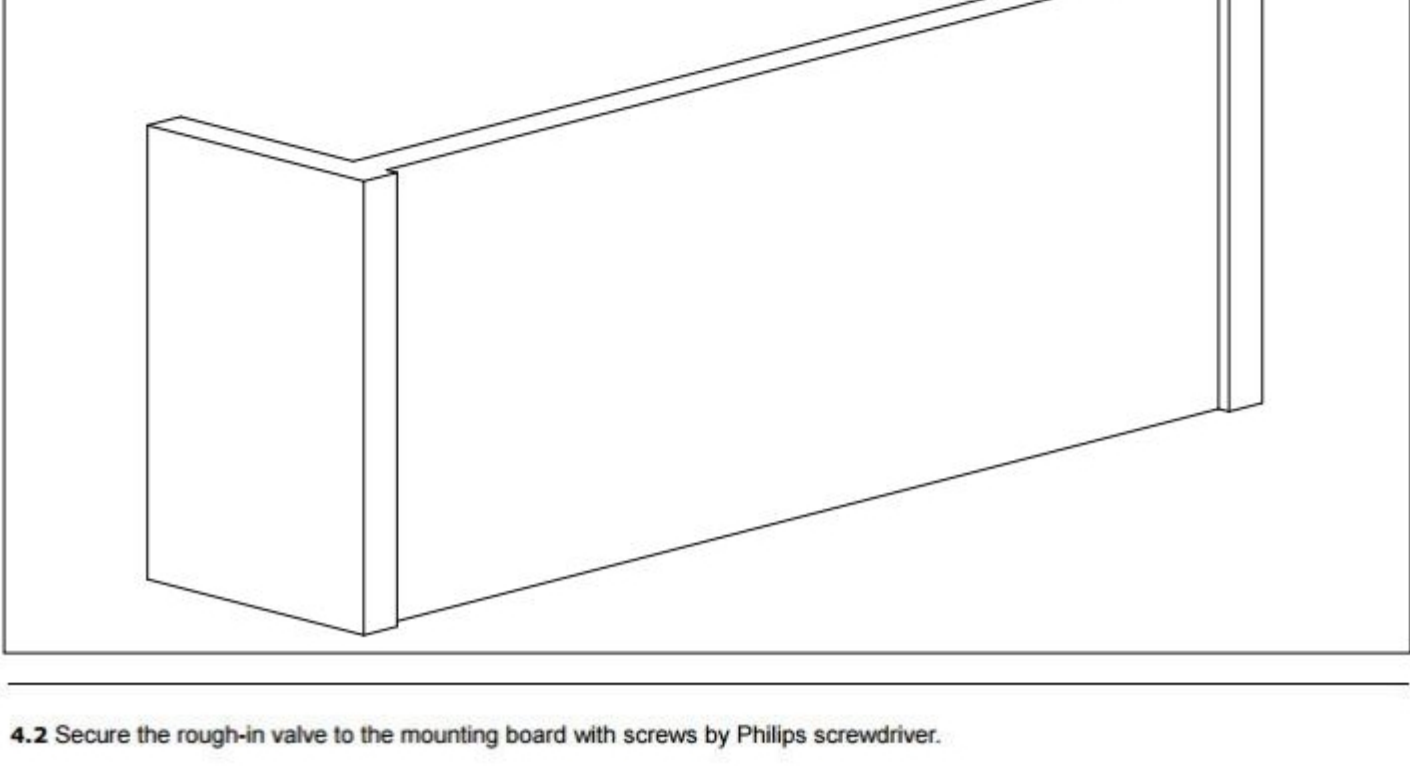

4.2 Secure the rough-in valve to the mounting board with screws by Philips screwdriver.

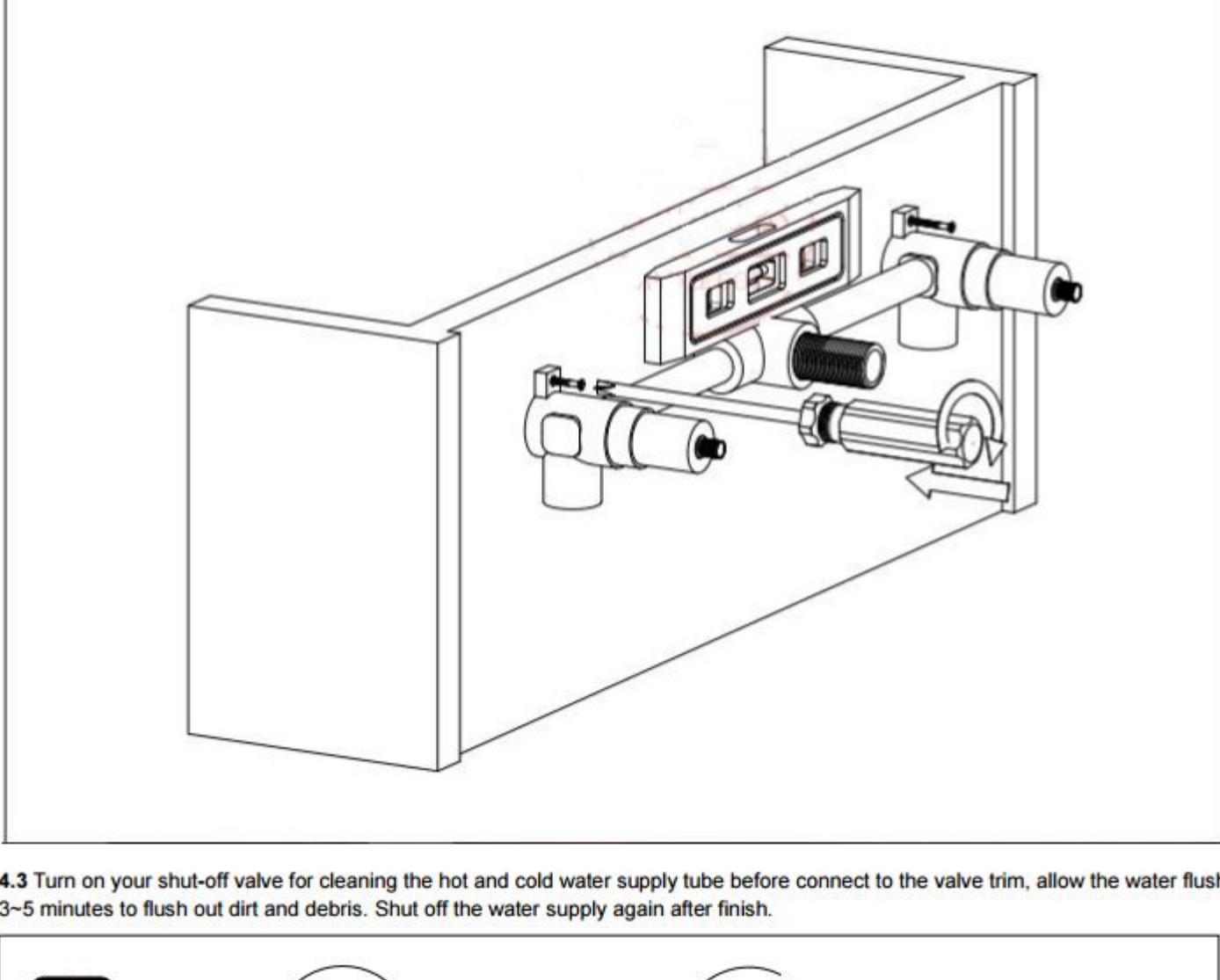

4.3 Turn on your shut-off valve for cleaning the hot and cold water supply tube before connect to the valve trim, allow the water flush 3~5 minutes to flush out dirt and debris. Shut off the water supply again after finish.

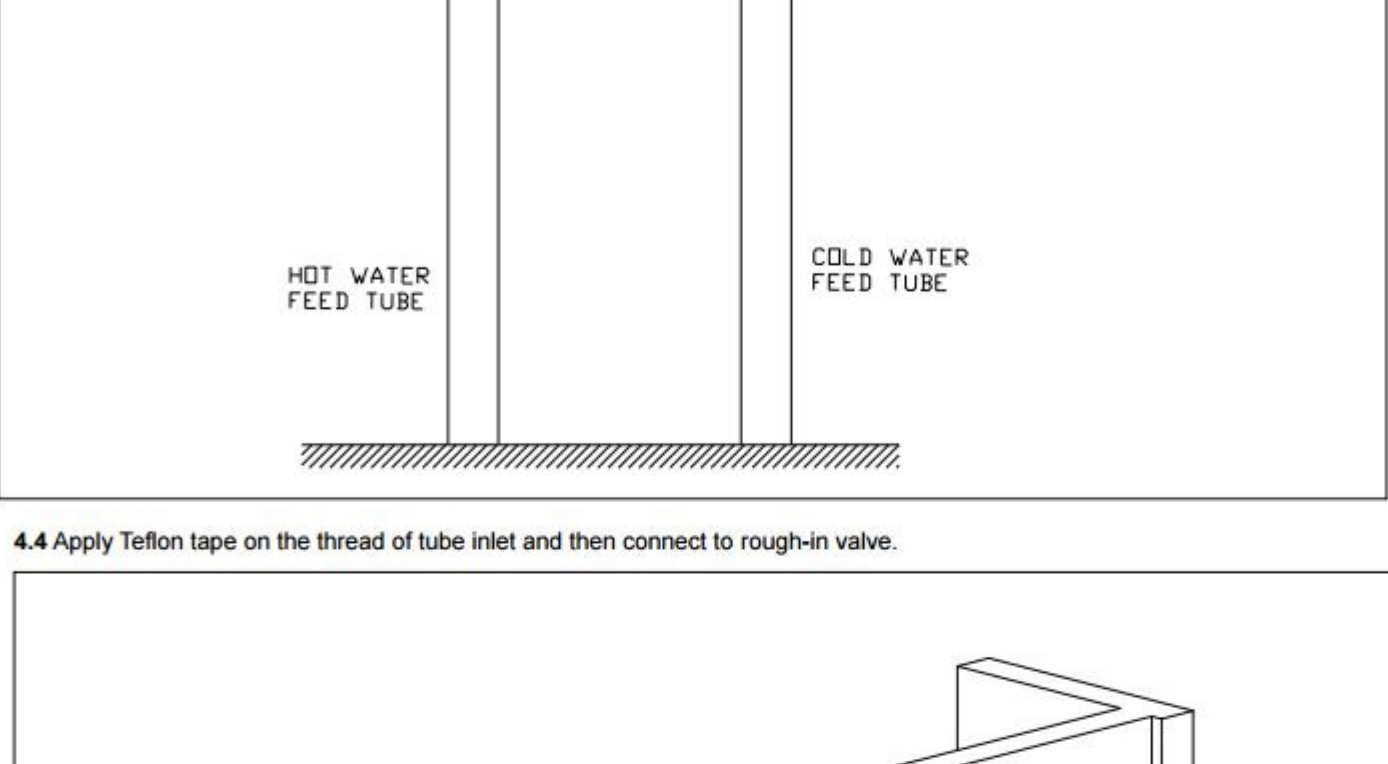

4.4 Apply Teflon tape on the thread of tube inlet and then connect to rough-in valve.

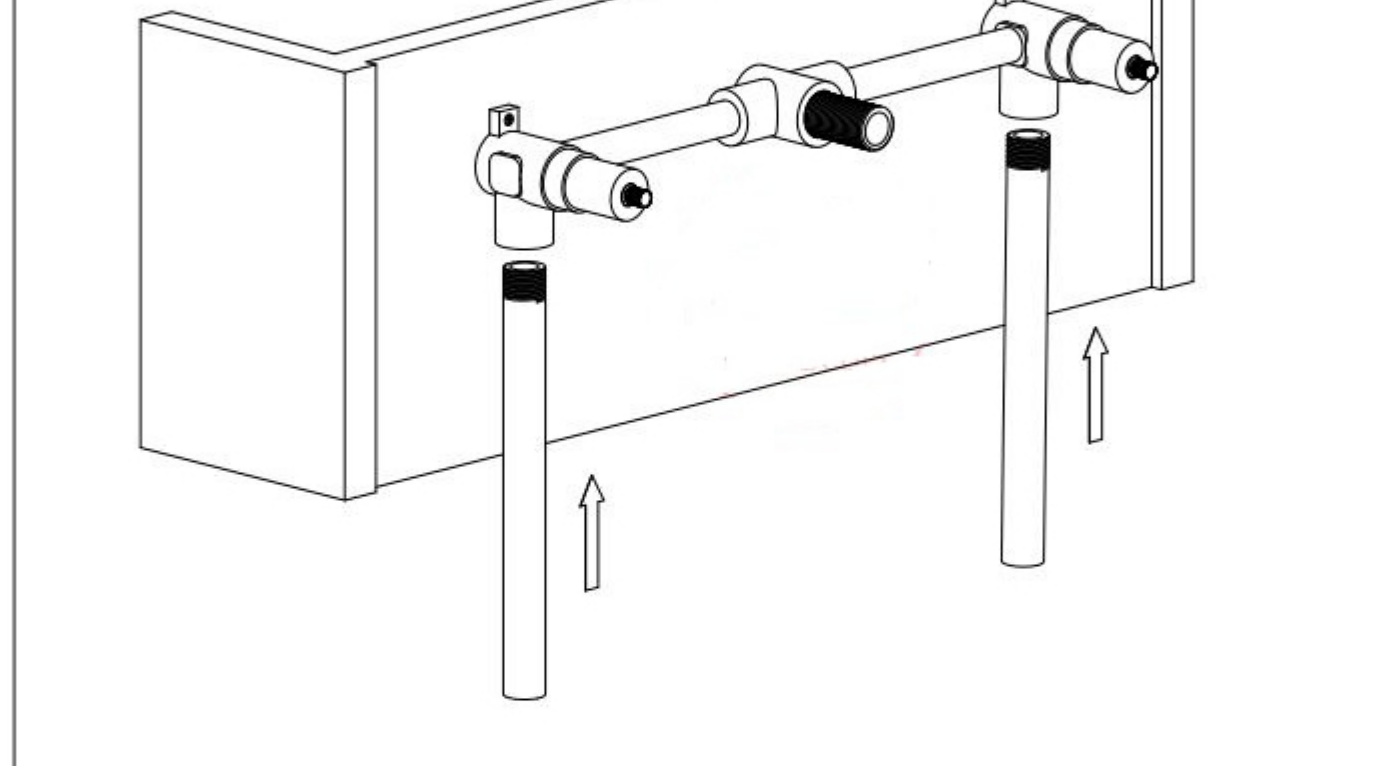

4.5 Install finish wall

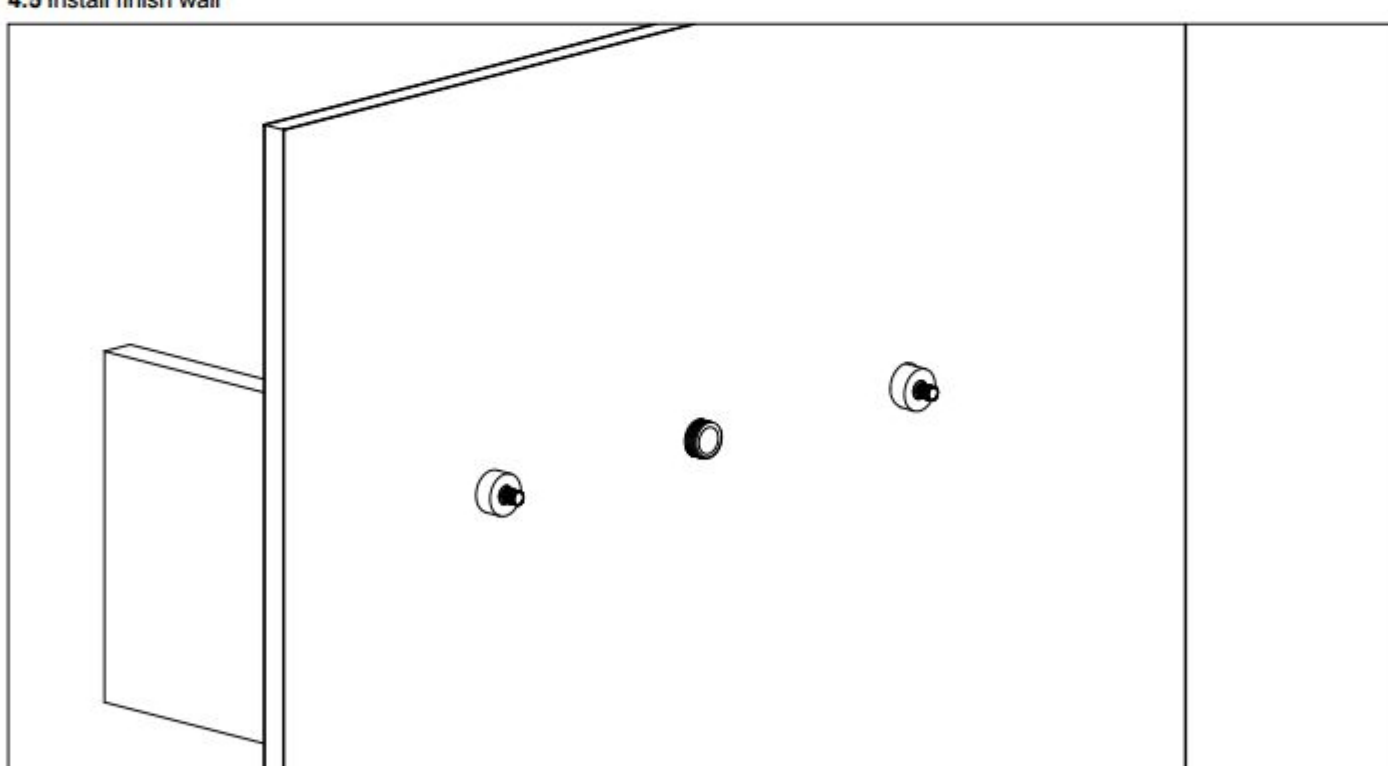

4.6 Attach nipple to shank of rough-in valve by Allen wrench.

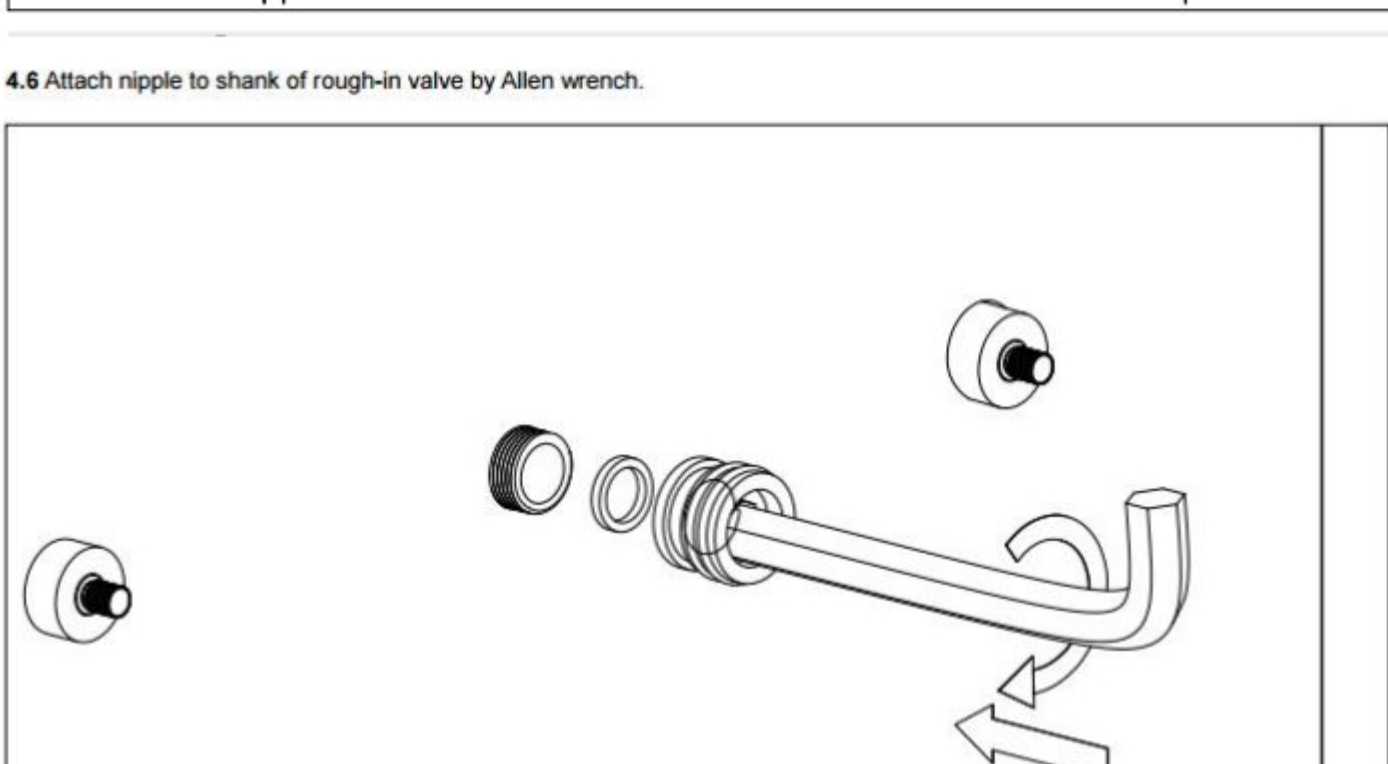

4.7 Secure spout to nipple with set screw with Allen wrench.

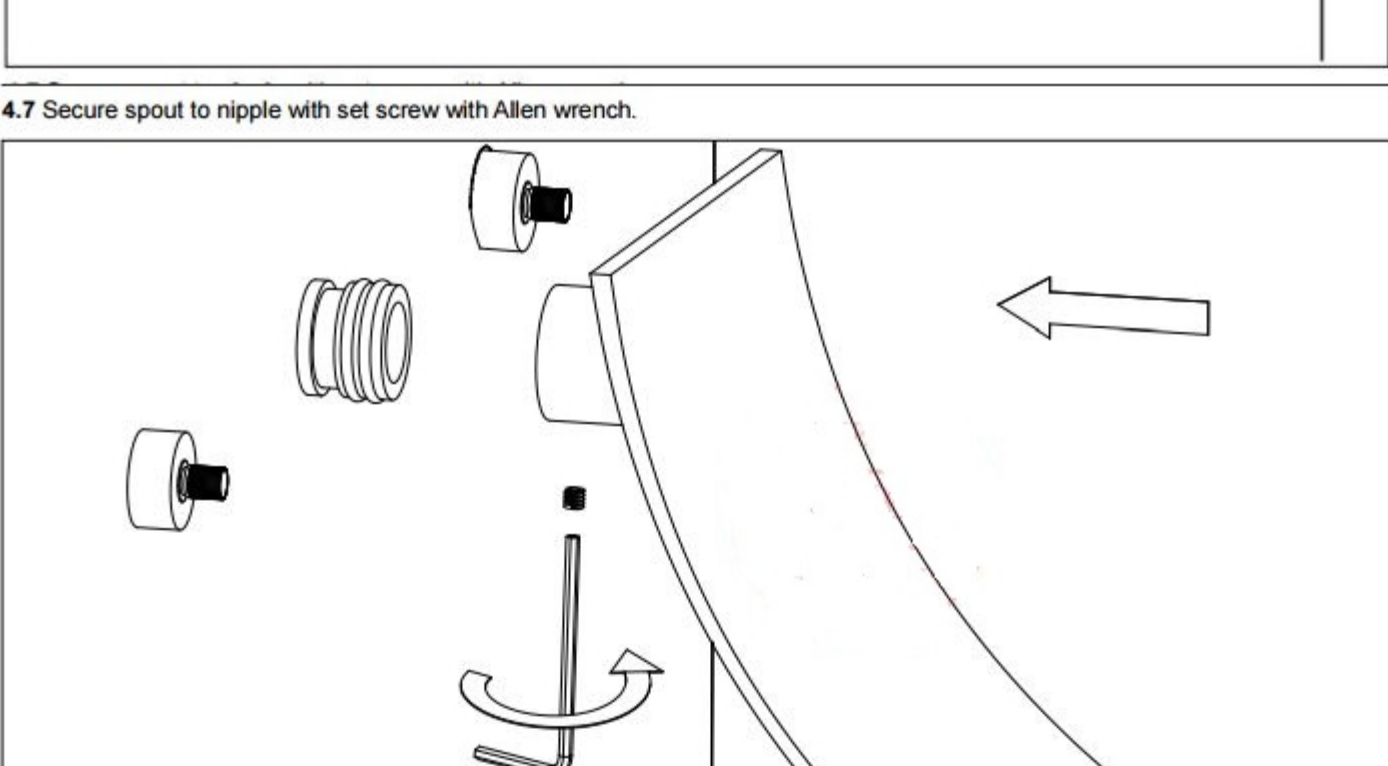

4.8 Install the Escutcheons.

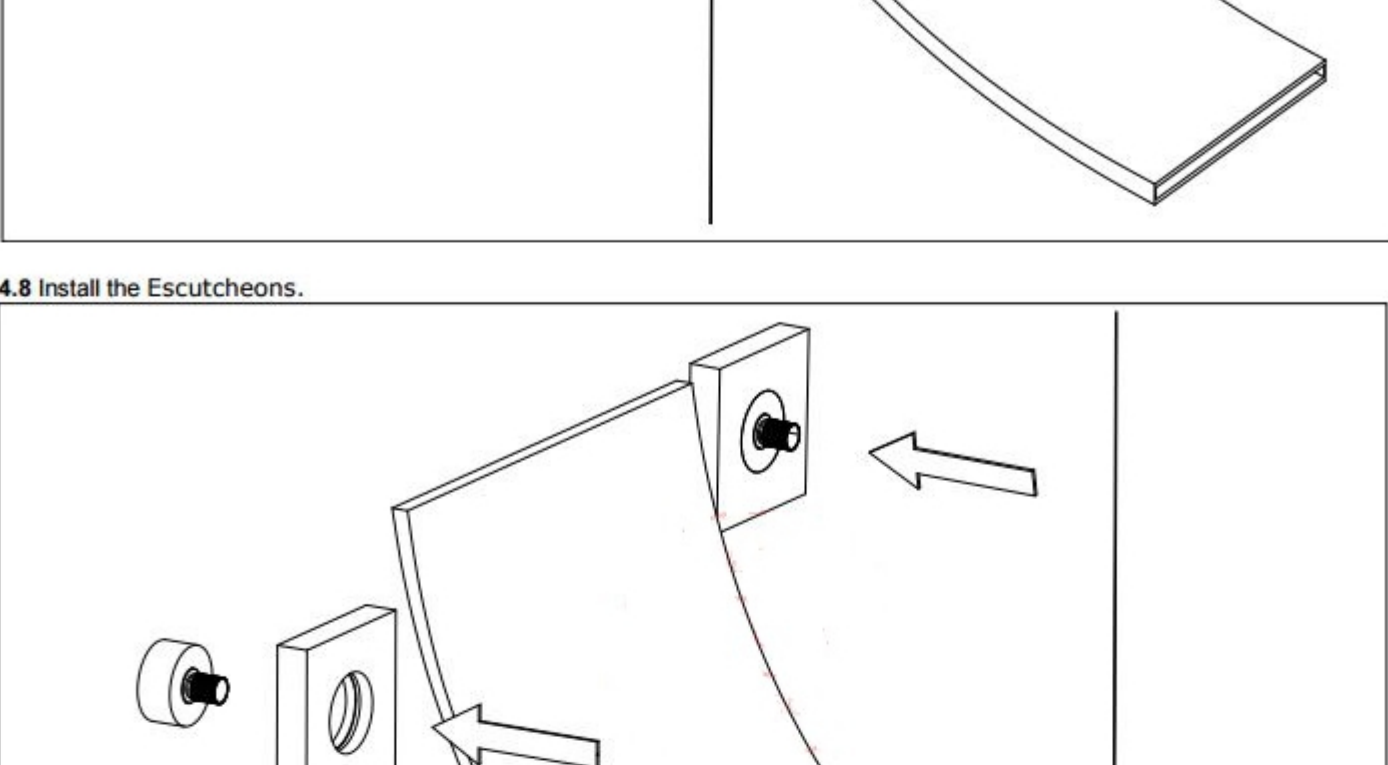

4.9 Secure the knobs to cartridge stem with screw by Allen wrench

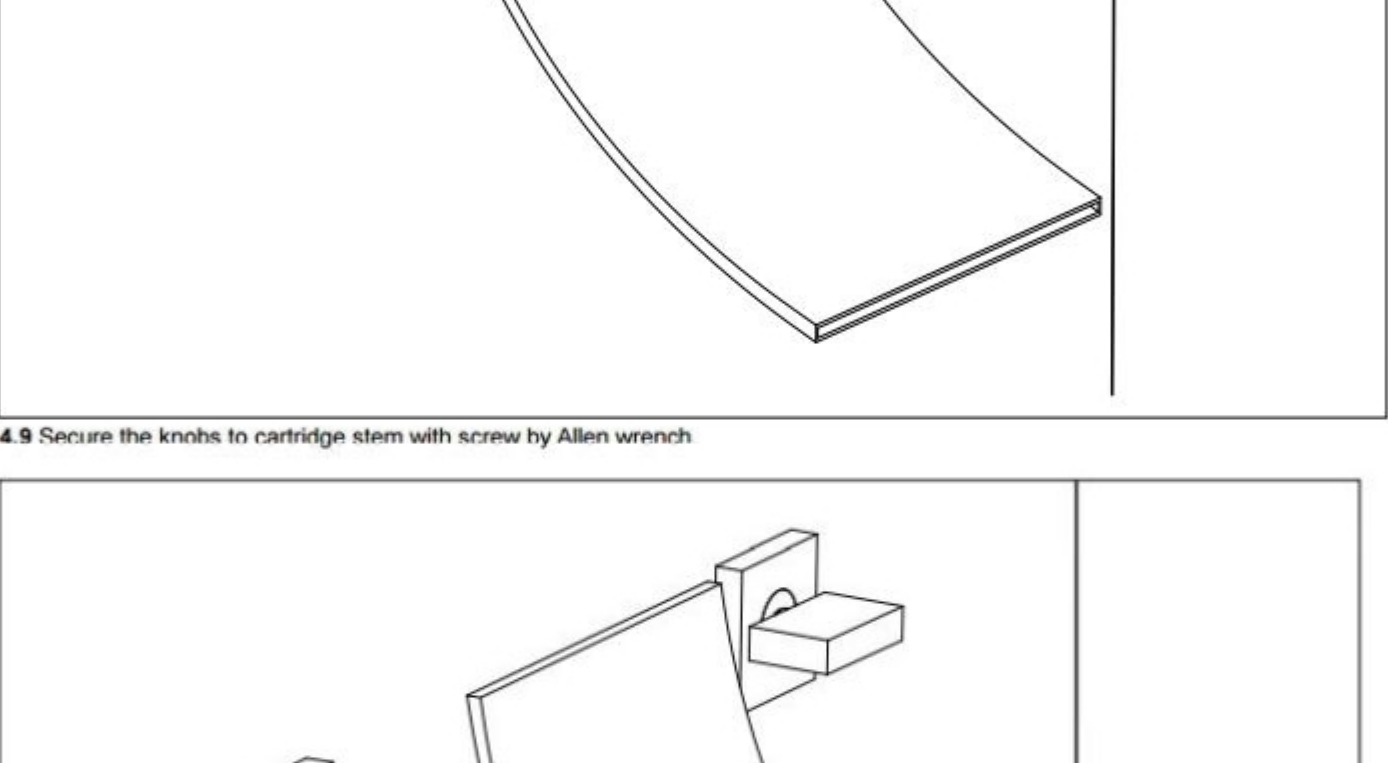

ASSEMBLE FINISHED

TROUBLESHOOTING

Symptom	Solution
Faucet leaks from the handle	A. Tighten the packing nut B. Replace the "O" ring or packing
The water pressure is too low	A. Make sure the water supply valves under the sink are turned on all the way B. Clean or replace the aerator C. Check plumbing system for water pressure problems
The spout sprays water all over	A. Clean or replace the aerator B. Replace the aerator washer
Water is leaking from the faucet under the sink	A. Check the water supply connections to the faucet B. Inspect the water supply lines or hoses for leaks
Handle is loose	A. Remove the cap and tighten the screw B. Locate and tighten the hex set screw C. Remove the handle and check for stripped teeth on the stem.

Cleaning instructions for faucets and showers

Please follow the cleaning material manufacturer's instructions. In addition, pay attention to the following points:

- Clean the faucets and showers as and when required.
- Use the amount of cleaning product and the amount of time recommended by the manufacturer. Do not leave the cleaner on the fixture longer than necessary.
- Regular cleaning can prevent calcification, if scale deposits are noticed on the faucet surface or the spout, you can clean it by a commercial limescale remover, such as Lime-Away® or CLR®. Dilute the remover according to the label instructions.
- The faucets might have some rusty if your faucet under hard water condition, please rub it with aluminum foil dipped in water until the surface is nice and smooth, and wipe it use a small amount of chrome polish or maybe something like car wax(such as Meguiar®, Turtle Wax®) or polish.
- For stainless steel faucet and spout both made of solid stainless, normally this finish has no protective coating on it(in particular waterfall spout inside),stainless steel is by its material nature very tarnish resistant, but by no means tarnish or stain proof. This finish might oxidize naturally over time and react to its environment, please rub it with aluminum foil dipped in water until the surface is nice and smooth, and wipe it use a small amount of chrome polish or maybe something like car wax(such as Meguiar®, Turtle Wax®) or polish.
- When using spray cleaners, spray first onto a soft cloth or sponge, never spray directly onto the faucet as droplets can enter openings and gaps and cause damage.
- After cleaning, rinse thoroughly with clean water to remove any cleaner residue.

Important

Residues of liquid soaps, shampoos, and shower foams can also cause damage, so rinse with clean water after using.

This General diagram and installation instructions are not intended for any specific model, but is presented as a general guideline for Installations!