

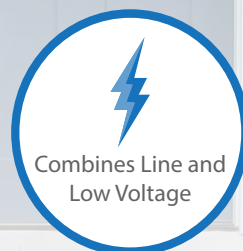

Patent
Pending



Paintable
Faceplate



Combines Line and
Low Voltage



ELECTRONIC DOOR CHIME **EDC - EDC1120WH1**

The patent-pending Electronic Door Chime (EDC) is a doorbell chime kit that can be installed in new construction homes or retrofitted in existing homes. It uniquely features a door chime that *fits in most single-gang junction boxes* and using the voltage divider, *combines both line and low voltage in one unit*. The EDC comes with the popular *Westminster chime option*, a *paintable faceplate* for a seamless look, and a *lighted doorbell button* to make your doorbell easily visible at night.

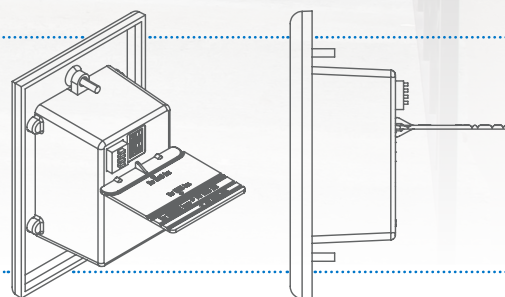

x1

Lighted Button
Included



Virtually **eliminate warranty callbacks** and **save installation time and cost** with NICOR's new Electronic Door Chime.



Paintable Faceplate

Paintable to match walls

Low Voltage

Doorbell Wires

Voltage Divider

Combine Line + Low Voltage

Line Voltage

Line + Neutral AC Input

1-Gang Junction Box

Fits in most 1-Gang J-Boxes



INSTALLATION INSTRUCTIONS

For detailed instructions, see instruction sheet inside box.

1. Carefully unpack fixture. Installation location must have access to both line voltage wiring for the EDC and low voltage wiring for the button.

2. Snap off excess material from the voltage divider to an appropriate length.

3. Press divider into the Chime, making sure it is fully engaged.

4. Connect line voltage wiring. Note: Cap off ground wire in junction box.

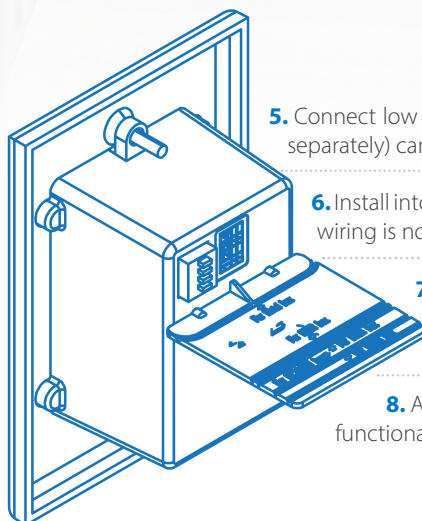

5. Connect low voltage doorbell wires. A second button (sold separately) can be installed for control from a second door.

6. Install into junction box with the provided screws. Ensure wiring is not pinched or interfering with the divider.

7. Attach doorbell button to chime wiring using screw terminals and mount doorbell button.

8. Apply power. The button should illuminate. Test functionality of the chime.