

CANOPY INSTALLATION INSTRUCTIONS

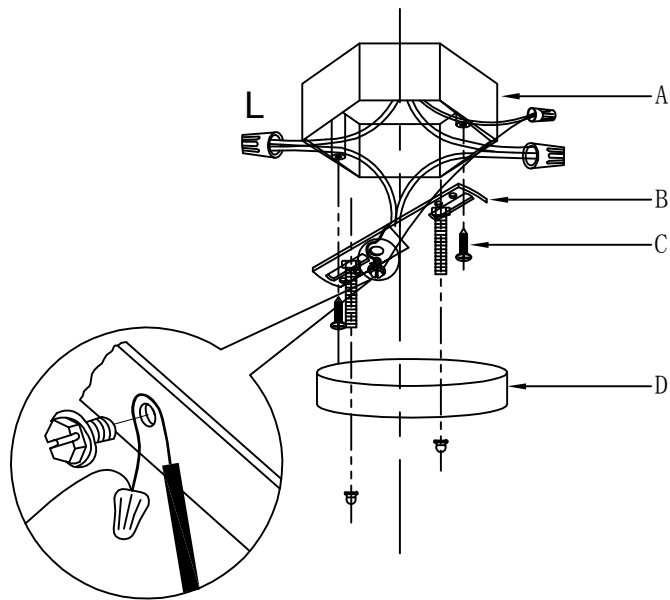

Attentions for lamp installation:

1. Please read the user manual carefully before the installation.
2. Please hire the professional electrician to install the lamp.
3. The load-bearing of the customer's ceiling must be over 3 times of the light weight.
4. The power must be cut off until the whole lamp is installed well.
5. To avoid getting an electric shock and cause the unnecessary hurt, please cut off the power when cleaning the lamp.

A. Existing Electrical Box

B. Crossbar

C. Crossbar Screws

D. Canopy

Light Bulb

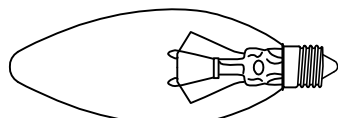

E12

USER MANUAL FOR MODEL# HG8883

Light Bulb:E12 light:E12*4

(Rated 110-130V/60Hz, bulb 60W maximum.)

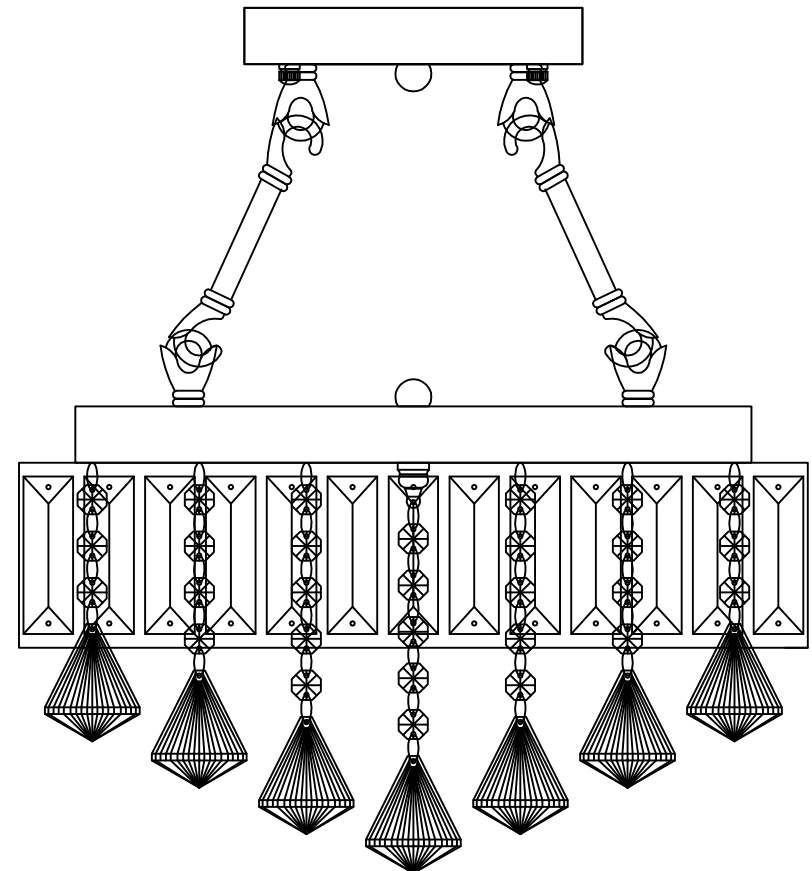

Please note: The parts in this table are completely unassembled, for illustrative purpose. In the actual product that you receive, some parts are assembled and attached together.

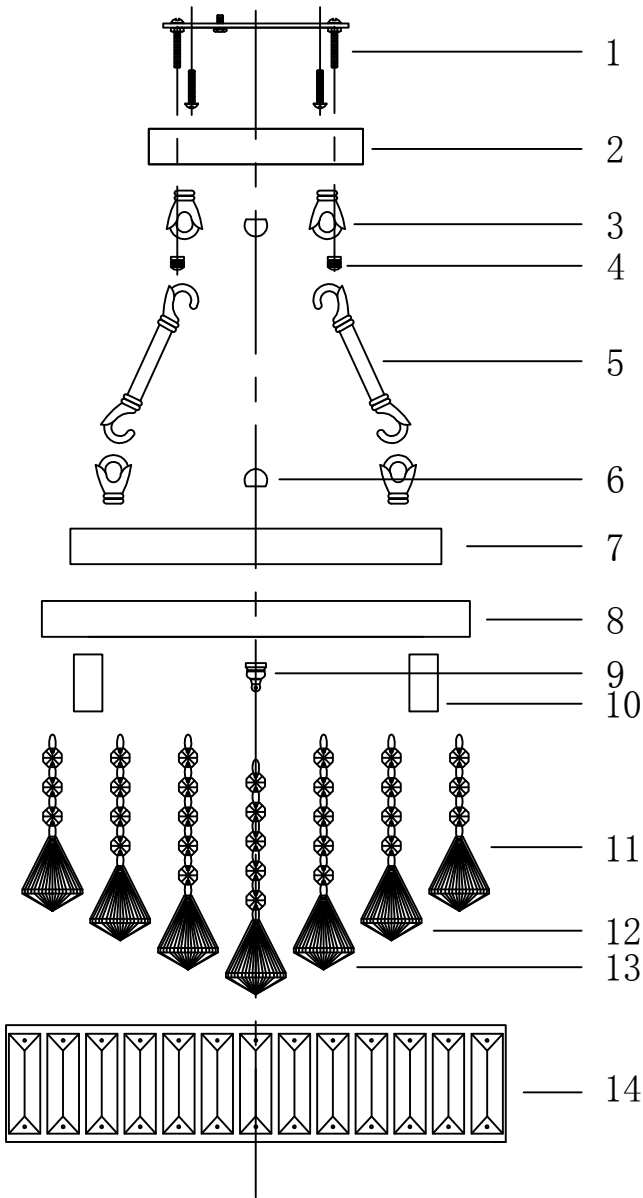

Products packing list

NO.	Picture	Quantity
1		1 pcs
2		1 pcs
3		6 pcs
4		2 pcs
5		3 pcs
6		2 pcs
7		1 pcs
8		1 pcs
9		1 pcs
10		4 pcs
11		18 pcs
12		12 pcs
13		7 pcs
14		1 pcs

Assembly and Installation Steps

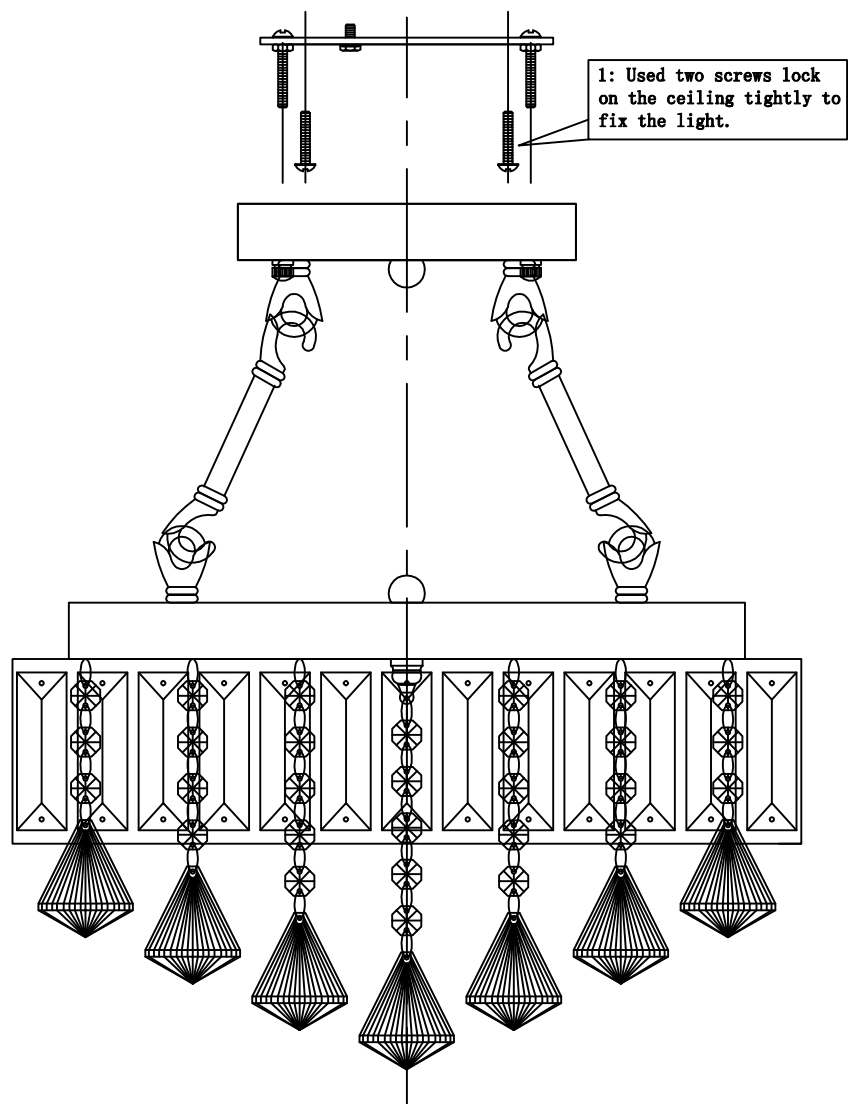

Product Size

