

HEADBOARD SET ASSEMBLY INSTRUCTION (TOTAL 1 BOX)

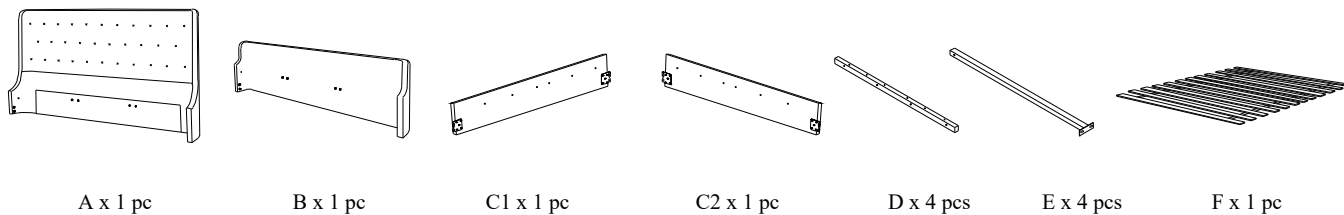

Please read over the instructions, it will be a time-saver in the long run.

Note: Before assembly, please be sure to work on a soft flat surface to avoid any damage to the finish.

Please leave bolts loosened until all bolts are placed before tightening completely.

Part#	Picture	Description	QTY	Location	Part#	Picture	Description	QTY	Location
G		Center leg	2	Wrapped in a non-woven bag	R		Spring Washer Ø8	24	Hardware Pack
K		Bolt Ø8x30mm	16	Already in Place	S		Flat Washer Ø8x25mm	16	Already in Place
L		Bolt Ø8x60mm	16	Hardware Pack				24	Hardware Pack
M		Bolt Ø8x70mm	4	Hardware Pack	X		Spanner Ø14	1	Hardware Pack
P		Nut Ø8	4	Hardware Pack	Z		Screws 4x30mm	24	Hardware Pack
O		"L" Wrenches Ø5	1	Hardware Pack					

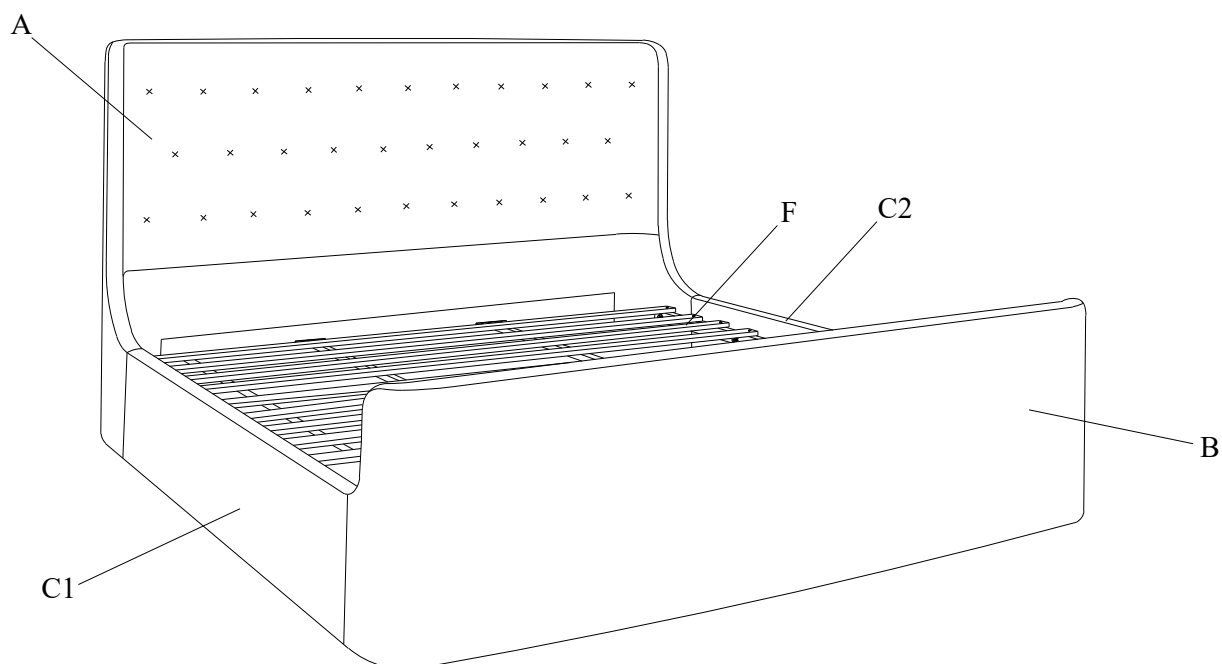

1

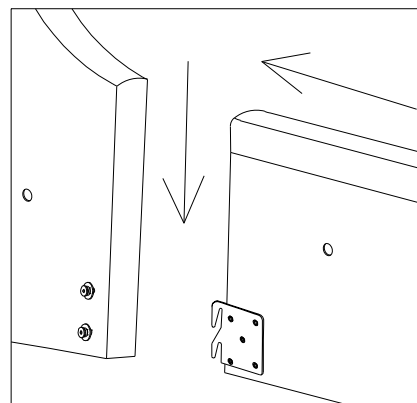
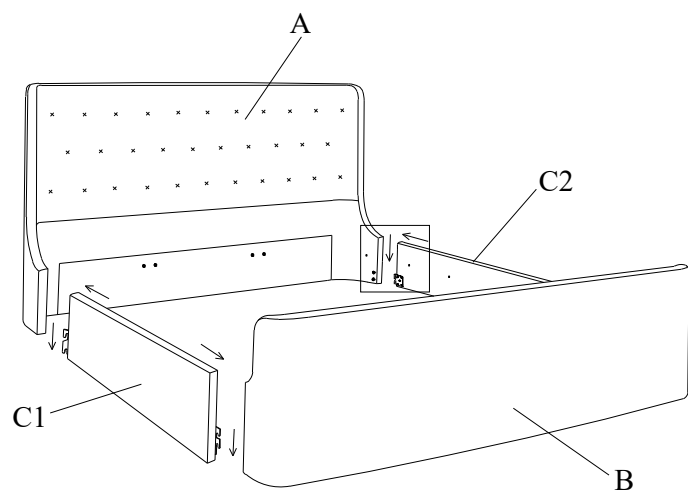

2

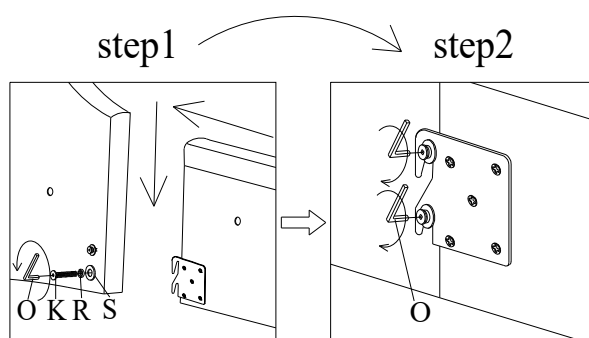
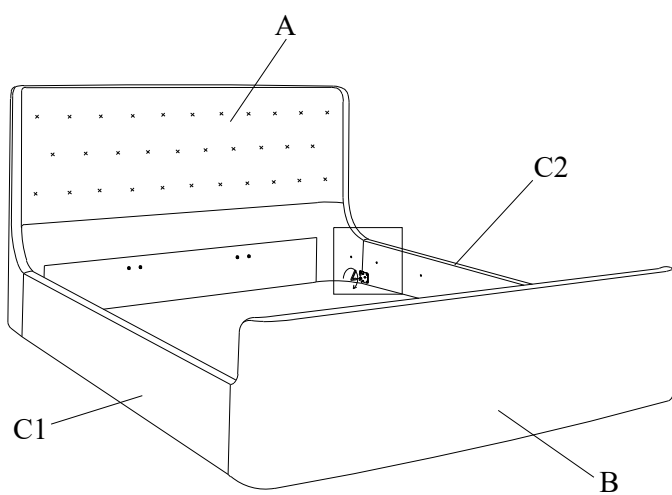

3

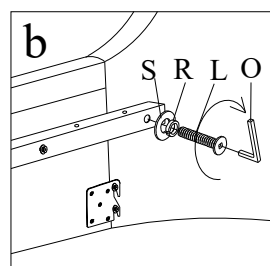
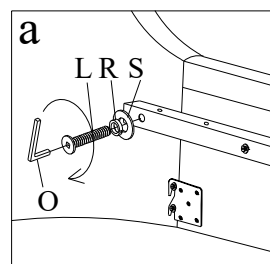
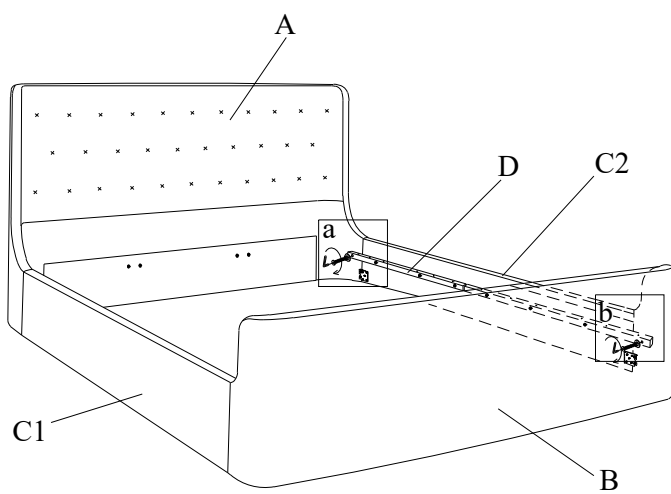

4

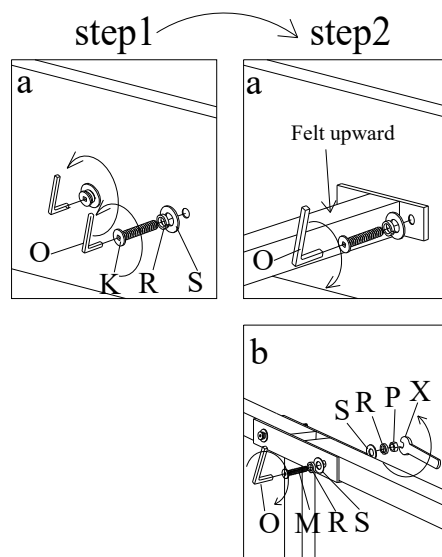
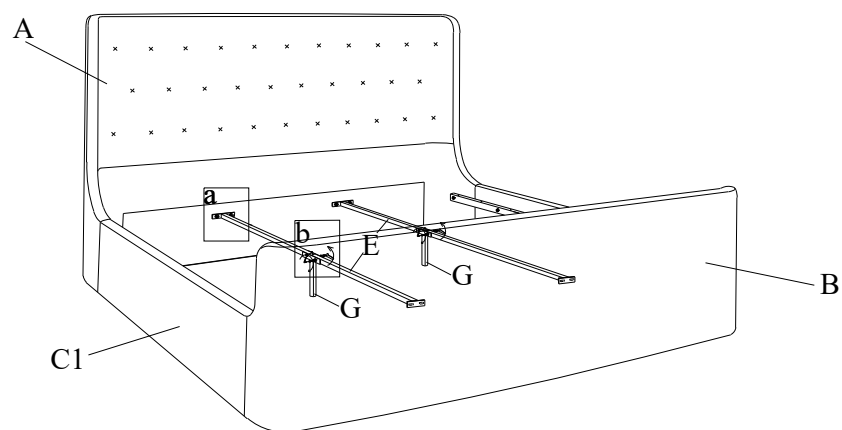

5

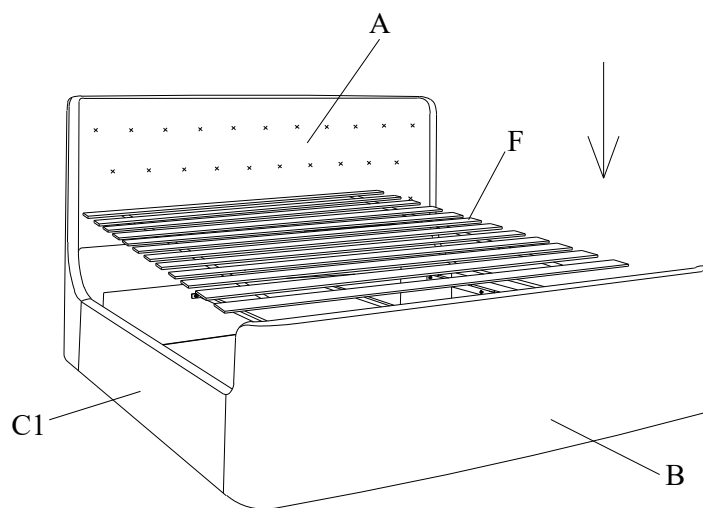

6

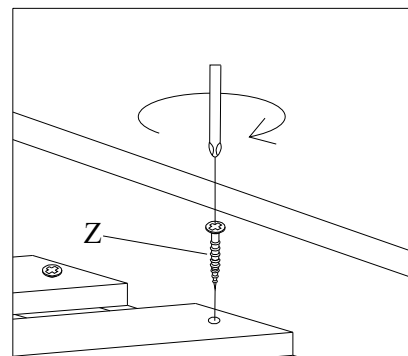
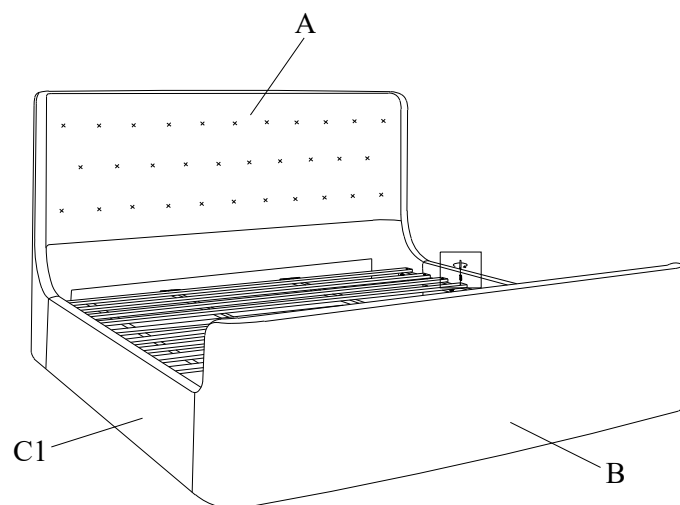

Screwdriver required, not included