

MOE'S

h o m e c o l l e c t i o n

ASSEMBLY INSTRUCTIONS.

CANTATA DINING CHAIR BLACK M2

ER-2040-02

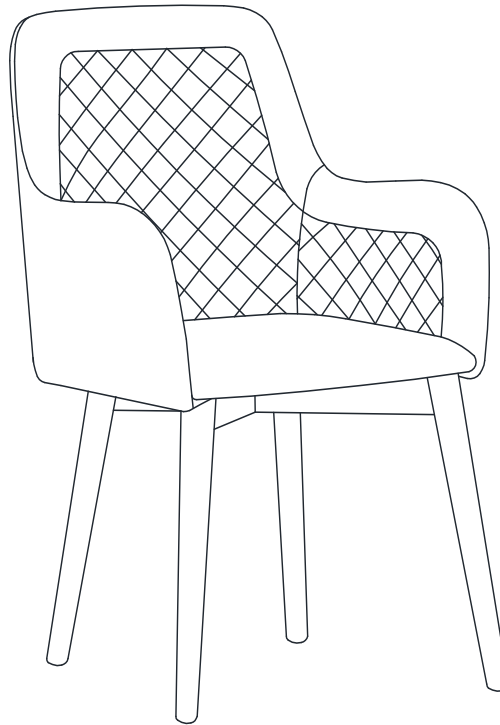

THANK YOU FOR YOUR PURCHASE!

PARTS AND HARDWARE.

1. SEAT x 1



2. CHAIR LEG x 2

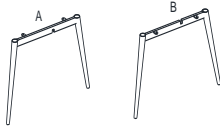

3. CROSS PART x 1

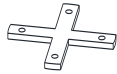

A. ALLEN KEY M4 x 1

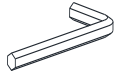

B. BOLT M6*15 x 4



C. FLAT WASHER DIA 16MM x 4



D. BOLT M6*10 x 4



NOTES.

Thank you for purchasing this quality product! Be sure to check all packing material carefully for small part that may have come loose inside the carton during shipping.

CAUTION: The item is heavy, assembly should be performed by two people.

STEP 1.

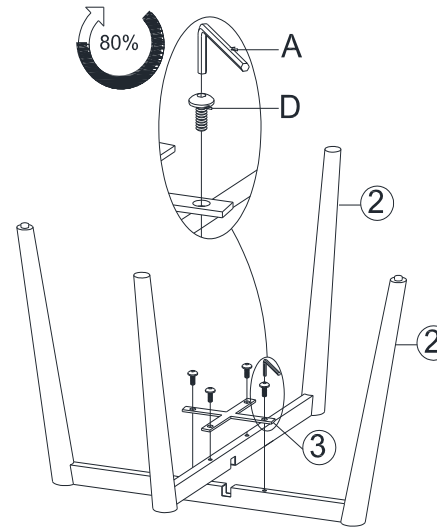

STEP 2.

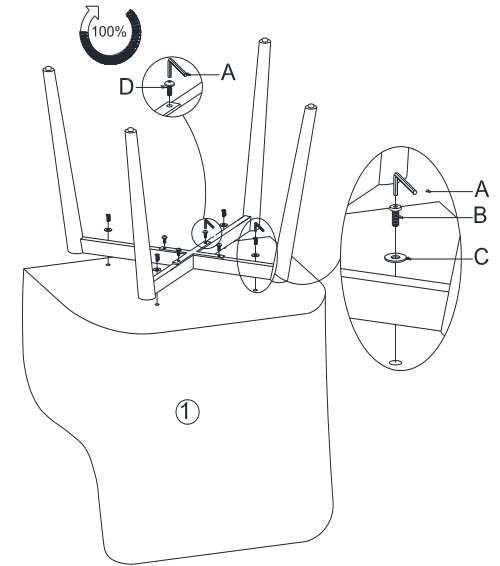

STEP 3.

