

## Parts Breakdown

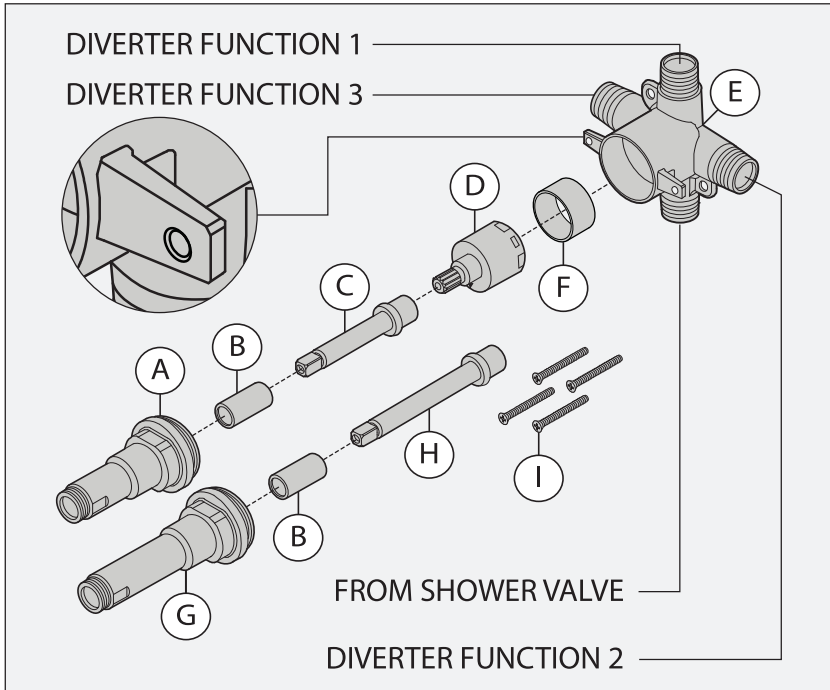

**Important:** Determine diverter valve style by date of purchase or positioning of diverter valve ears (see parts breakdowns below for illustrations).

### For diverter valves purchased before November, 2016



**Note:** For diverter valves purchased before November, 2016, retaining sleeve (F) must be inserted flush into diverter valve body (E) before installing cartridge (D).

### For diverter valves purchased after November, 2016

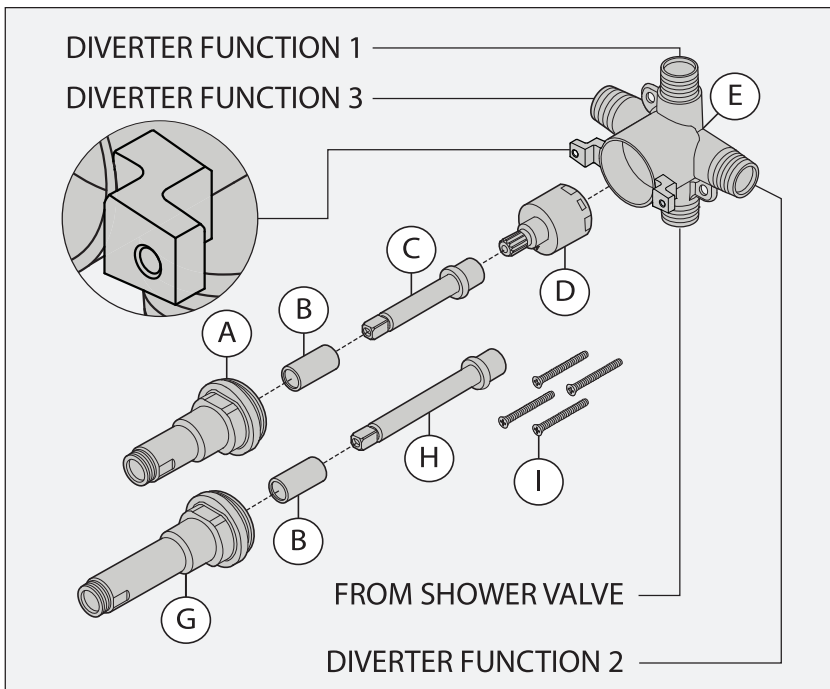

## Replacement Parts

Item	Description	Part Number
A	Cap Assembly	RTS-DIVCAP
C	Cartridge Extender	RTS-DIVEXT
D F	Cartridge Retaining Sleeve	RTS-3DIV
B G H I	Spacer 1" Cap Extender 1" Cartridge Extender 4" Mounting Screws	RTS-DIV-1EXT

## Tools Required

Adjustable Wrench	
Drill (optional)	
Plumber Tape	
Safety Glasses	
Solder	
Torch	

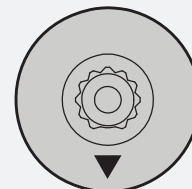

**Important:**  
Cartridge (D)  
must be installed  
with arrow  
facing down.