

Product Number: REA12J7248SDFS-A 72" x 48" x 25"



JETS: 12 Total

- 12 Classic Air Jets

1.0 Air Power 3-speed heated Air Pump
Quiet Pad Anti-Vibration Mounted Pump

Air Switch On/Off Control(s)

HydroCleanse

- Overflow: Integral Round: Included- Polished Chrome or Brushed Nickel.
Optional - White, Biscuit, Black, Polished Nickel, Oil Rubbed Bronze.
- Bath Drain: Pop up: Included- Polished Chrome or Brushed Nickel.
Optional - White, Biscuit, Black, Polished Nickel, Oil Rubbed Bronze.
- In Floor Drain EZ Fast Connect (**optional**)

- Deck Mount or Floor mount (not included)
- Access Panel recommended for Deck faucet (optional)
- Floor mount verify spout distance

EZ Level Base • FDA Recipe Non-Toxic Food & Beverage Grade
Plumbing (primarily) • 30 Point Quality Assurance Factory Test

6 1/2" or more space required to access equipment panel. Tub may also need to be shifted or disconnected in some situations.

Access panel equipment design and location may vary based on model.

Your licensed installer must water test and run all equipment before leaving your home to ensure proper operation and validate warranty.



Side drain
Pump Location(s): Standard #1 and #2 RF

(1) 115v 20AMP GFCI Circuits

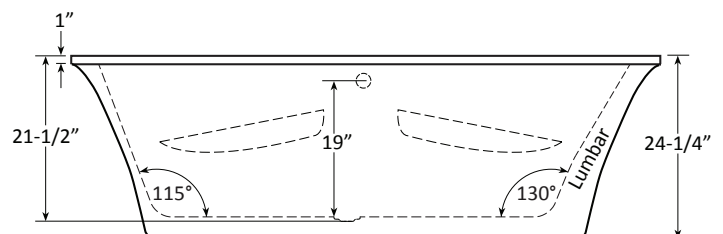
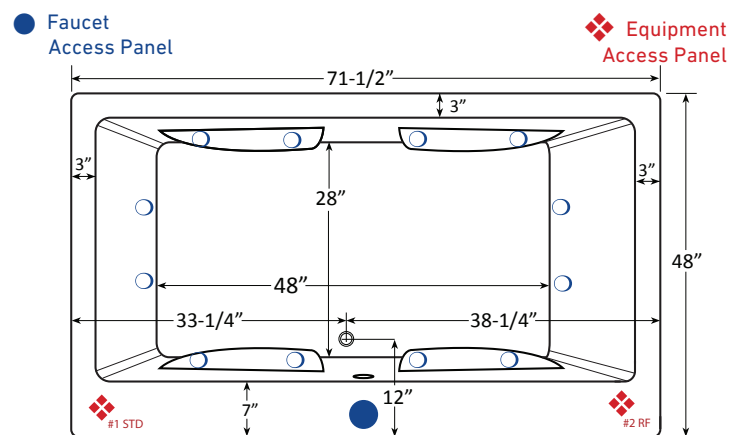

Specifications and features are subject to change without notice and are + .25". All final measurements should be taken from tub on site.
HydroMassage Products LLC • 303-341-1845 • Fax: 303-341-1850 • www.hydromassageproducts.com