

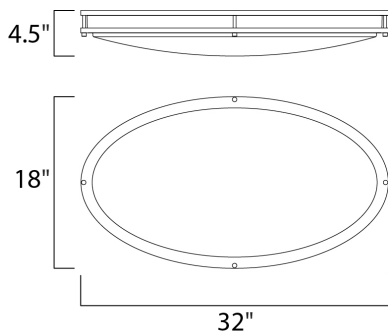

PRODUCT DESCRIPTION

Commercial grade energy efficient lighting featuring linear frames of metal finished in Satin Nickel diffused by an etched opal acrylic creating an updated energy efficient classic.



MEASUREMENTS

DIMENSION : 32" L x 18" W x 4.5" H
HANGING WEIGHT : 7.76 lb

LAMPING

INPUT VOLTAGE : 120-277V
LUMENS : 2,500 Rated
BULB : 1 x 35W LED PCB Integrated , 35W Total
BULB INCLUDED : (Integrated)
DIMMABLE : No
CRI : 90+ CRI
COLOR_TEMP : 3000K

FINISHES OPTION



Satin Nickel

GLASS

White WT

MATERIAL

Steel, Opal Acrylic

RATINGS

cETLus
Damp Location



ADDITIONAL

OPERATING TEMPERATURE:
-20°C (-4°F), 40°C (104°F)

Always consult a qualified electrician before installing any lighting product.



WESTERN DISTRIBUTION CENTER (HEADQUARTER)
253 NORTH VINELAND AVE | CITY OF INDUSTRY, CA 91746

EASTERN DISTRIBUTION CENTER
4200 SHIRLEY DR. | ATLANTA, GA 30336

P. 626.956.4200 | F. 626.956.4225 | maximlighting.com