

Brio Square Ceiling Shower Head Set with 6 Shower Body Jets



Shower System Installation Instructions

Before installing, read entire Widespread Faucet Installation Instructions. Observe all local building and safety codes.

For the following installation instructions for your new Widespread Faucet it is assumed that any old fixtures have been removed and any repairs or modifications to the water supply have been completed.

Unpack and inspect the product for any shipping damages. If you find damages, do not install.

Contact Customer Service at 800-684-4489. If you need assistance or have questions while installing your Widespread Faucet, contact Customer Service.

We recommend consulting a professional if you are unfamiliar with installing bathroom fixtures.

TOOLS AND MATERIALS:

Adjustable Wrench

Silicone Sealant

Damp Cloth

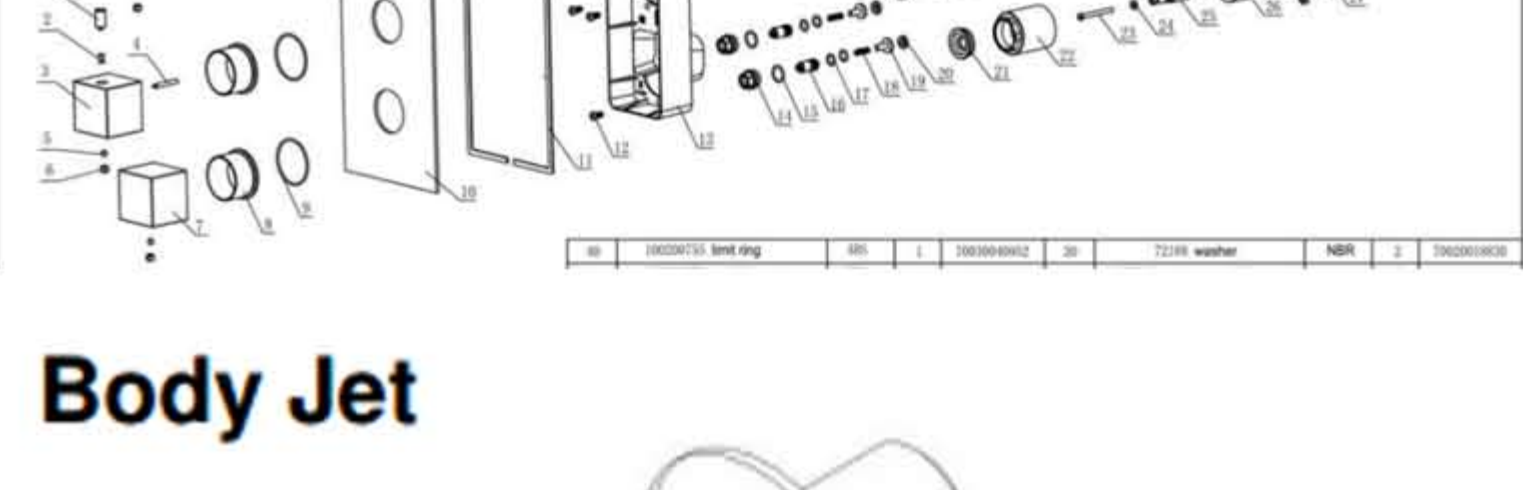
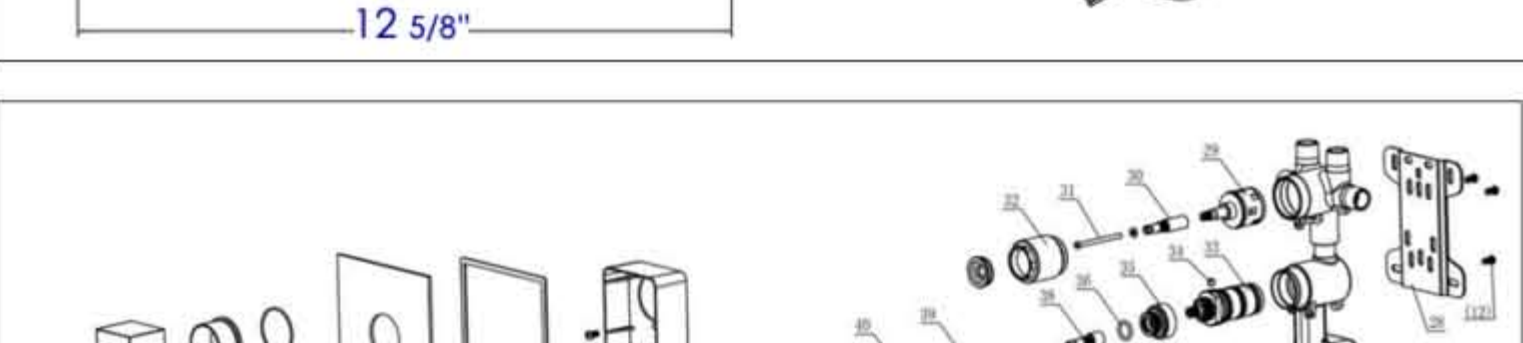

Body Jet

Fitting Instructions & Content list

BODY JET INSTALLATION

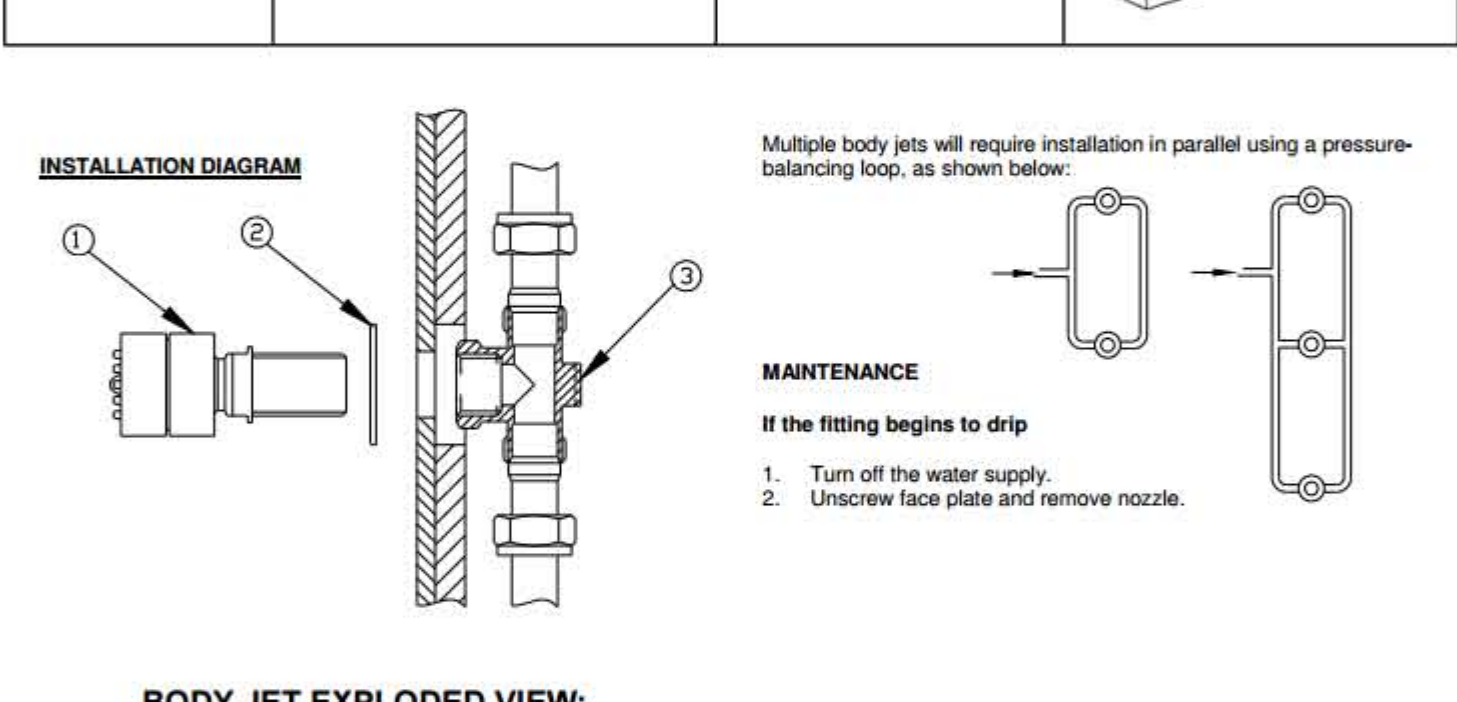

INSTALLATION DIAGRAM

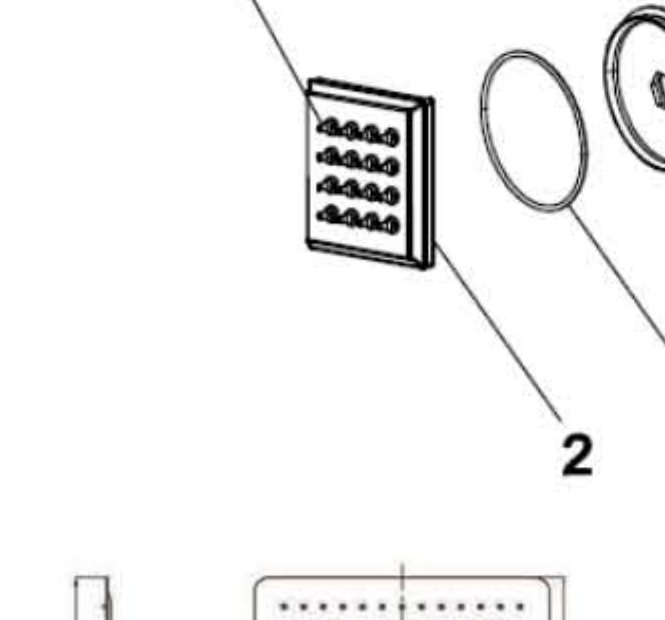

Multiple body jets will require installation in parallel using a pressure-balancing loop, as shown below:

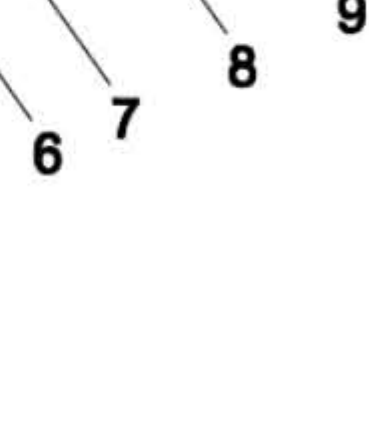

MAINTENANCE

- If the fitting begins to drip
- 1. Turn off the water supply.
- 2. Unscrew face plate and remove nozzle.

BODY JET EXPLODED VIEW:

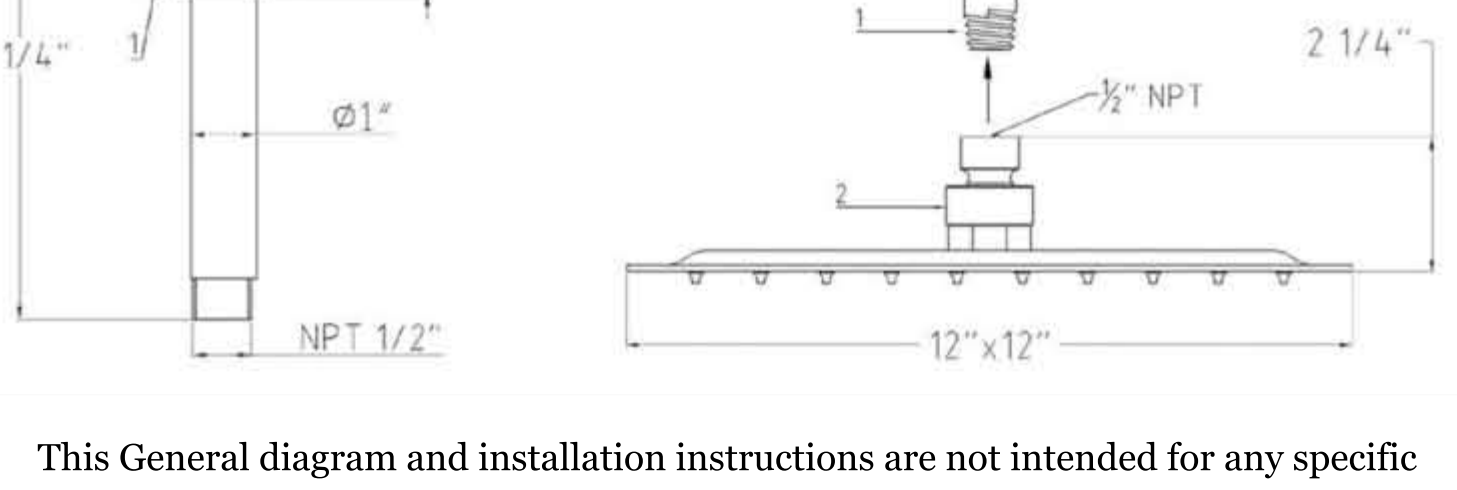
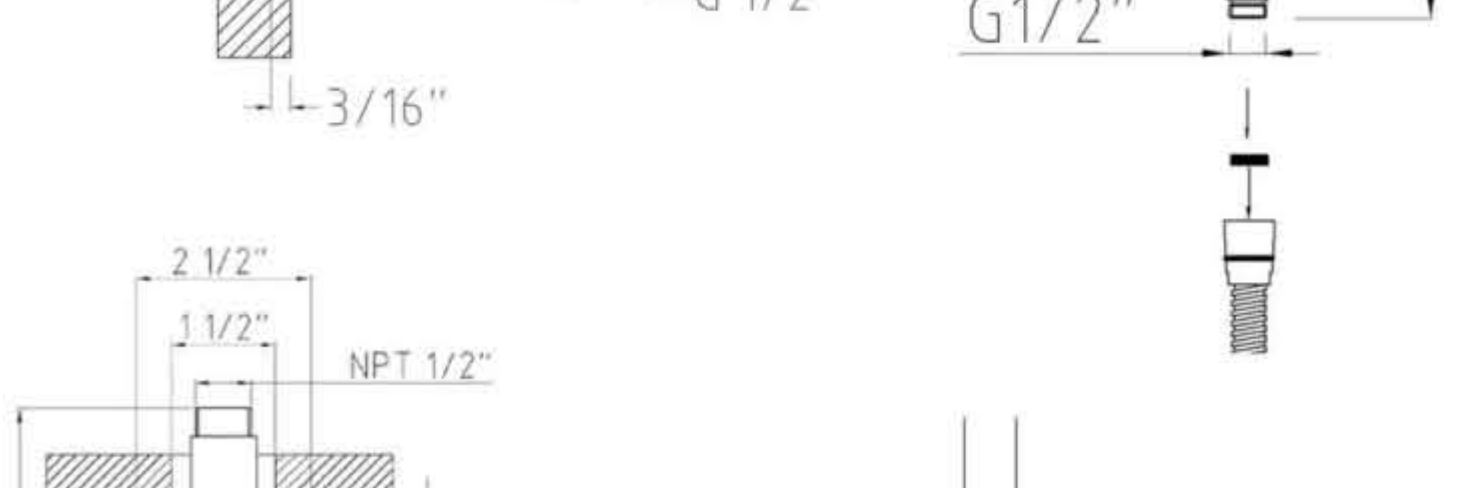
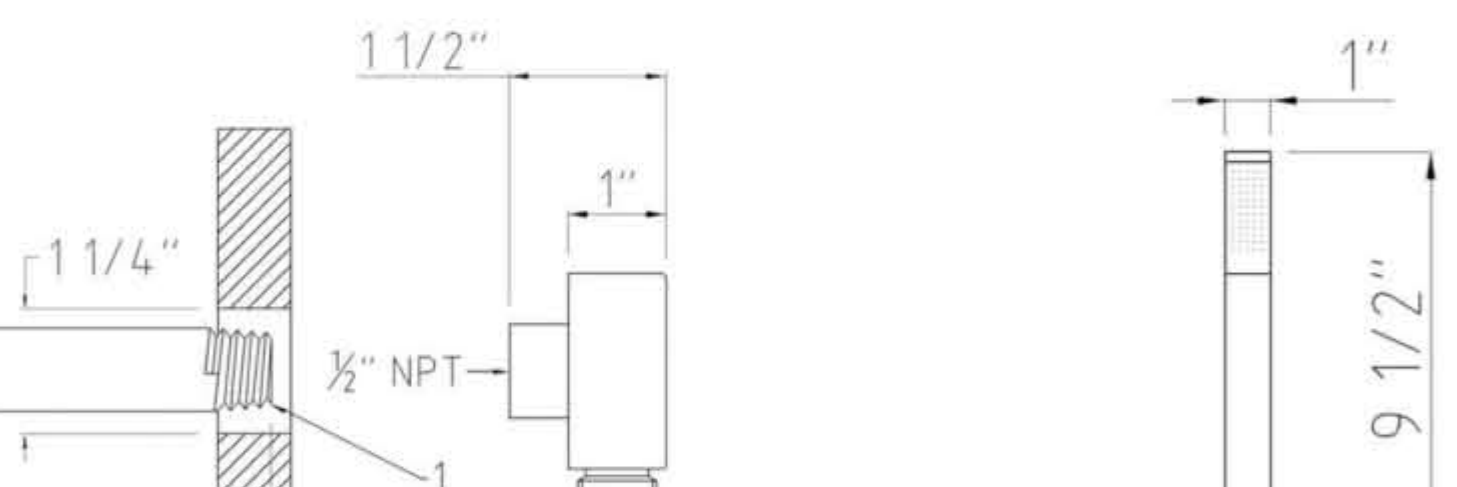
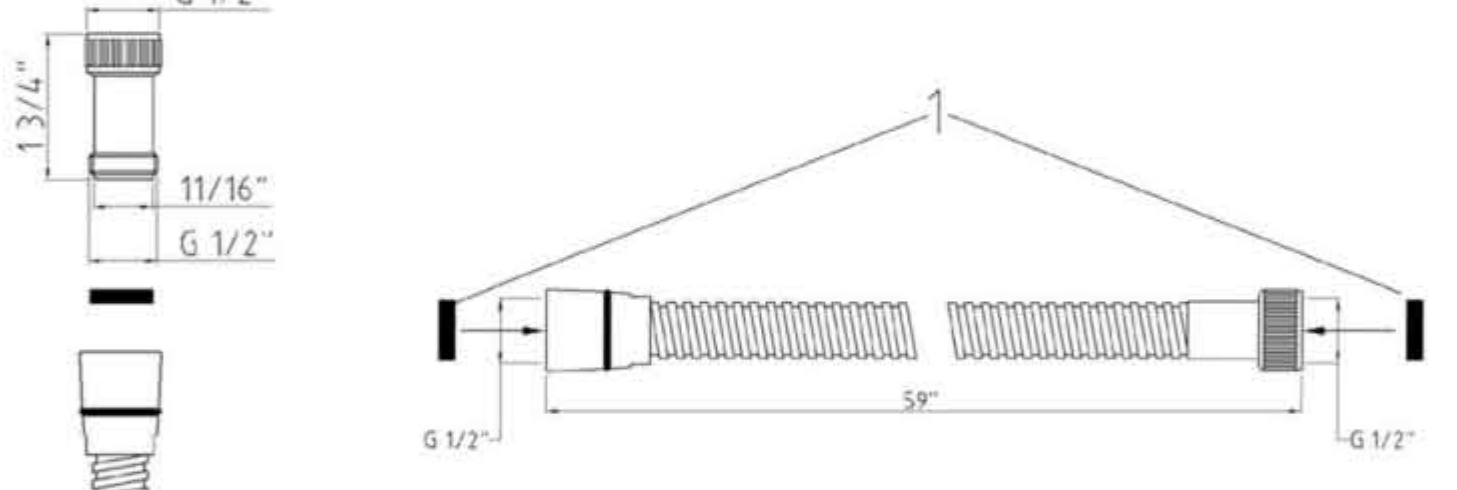
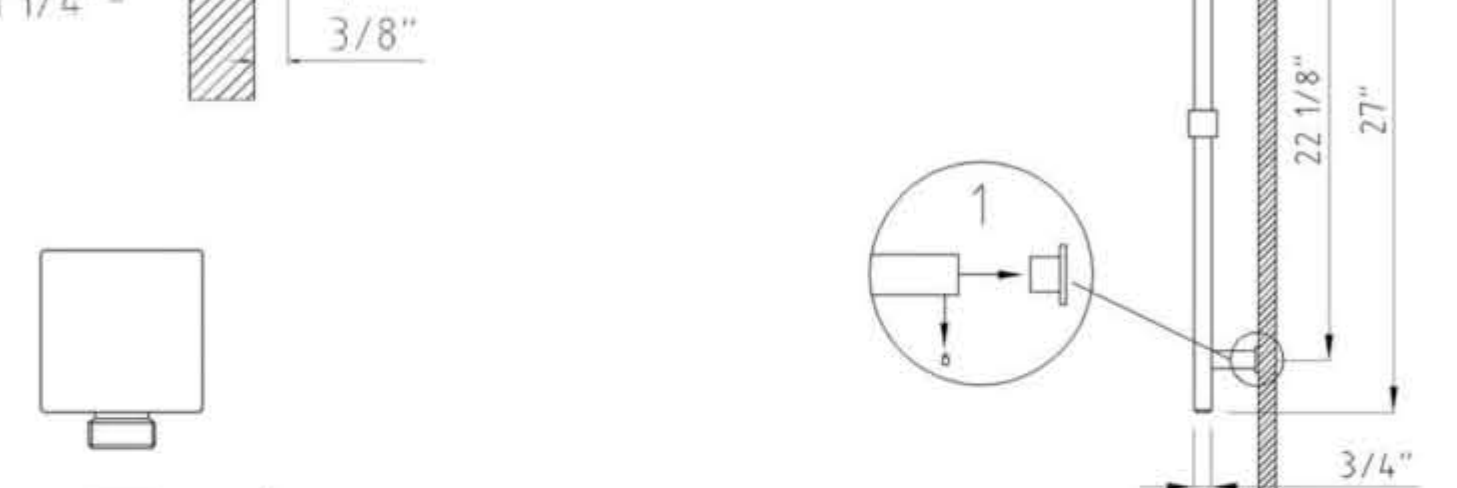
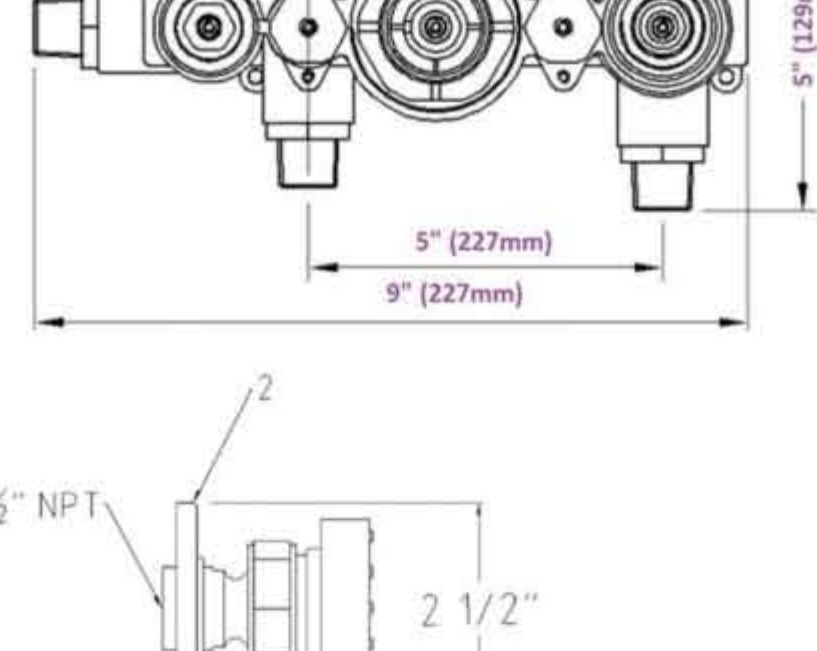
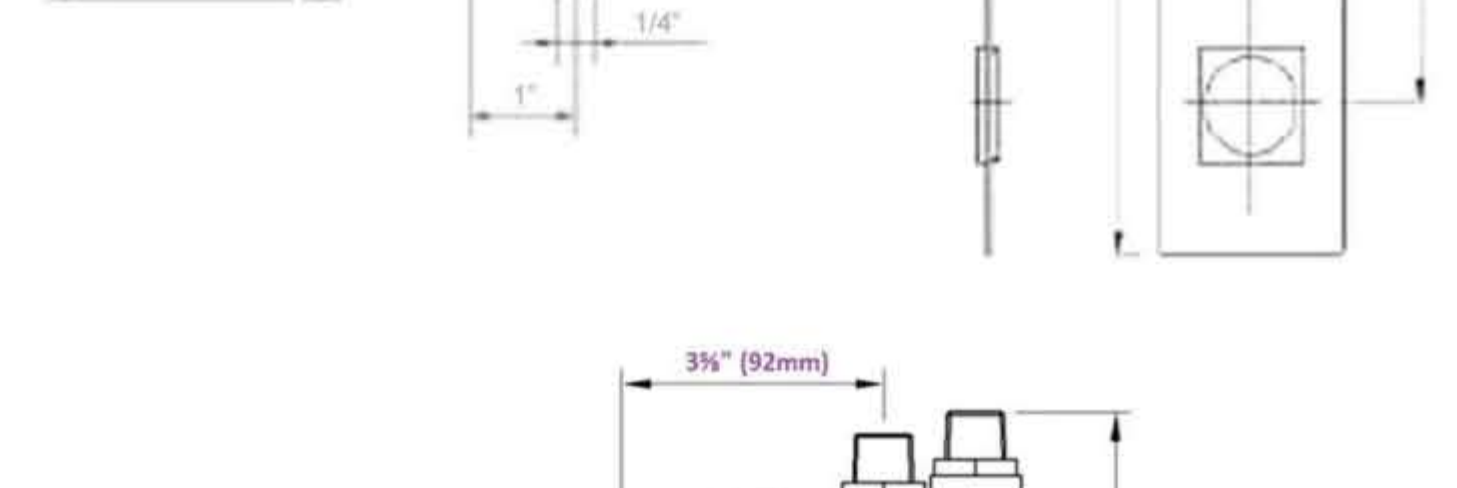
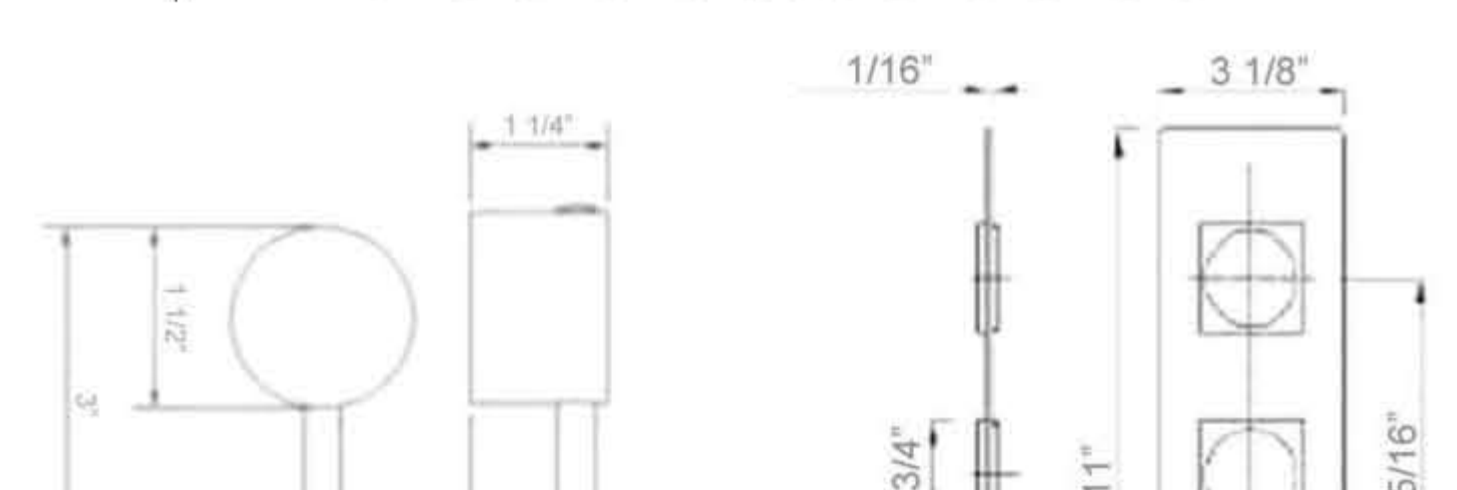
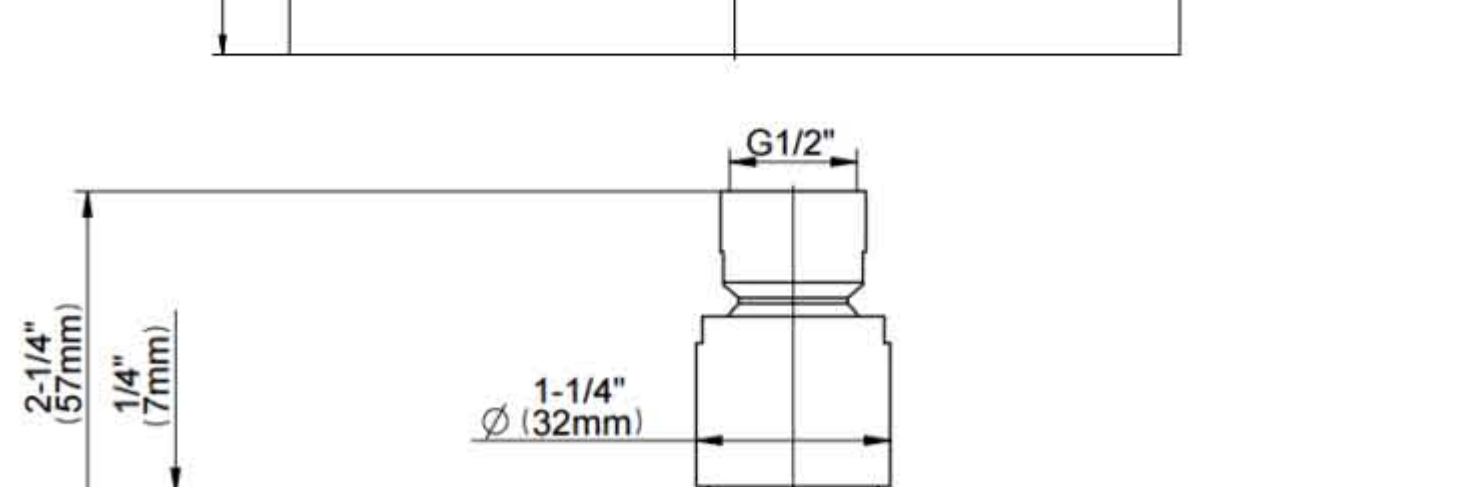
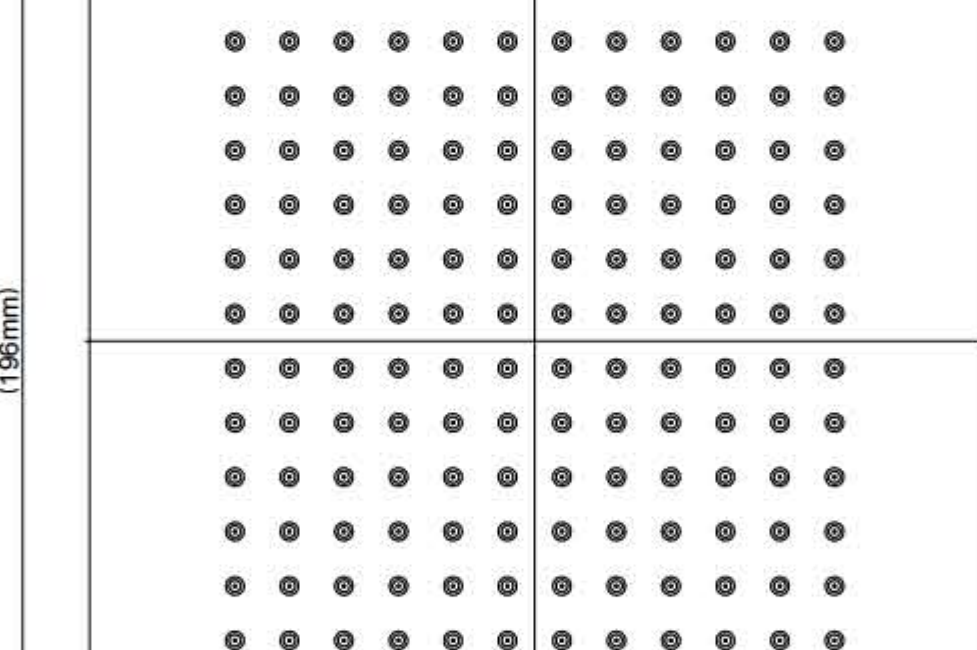
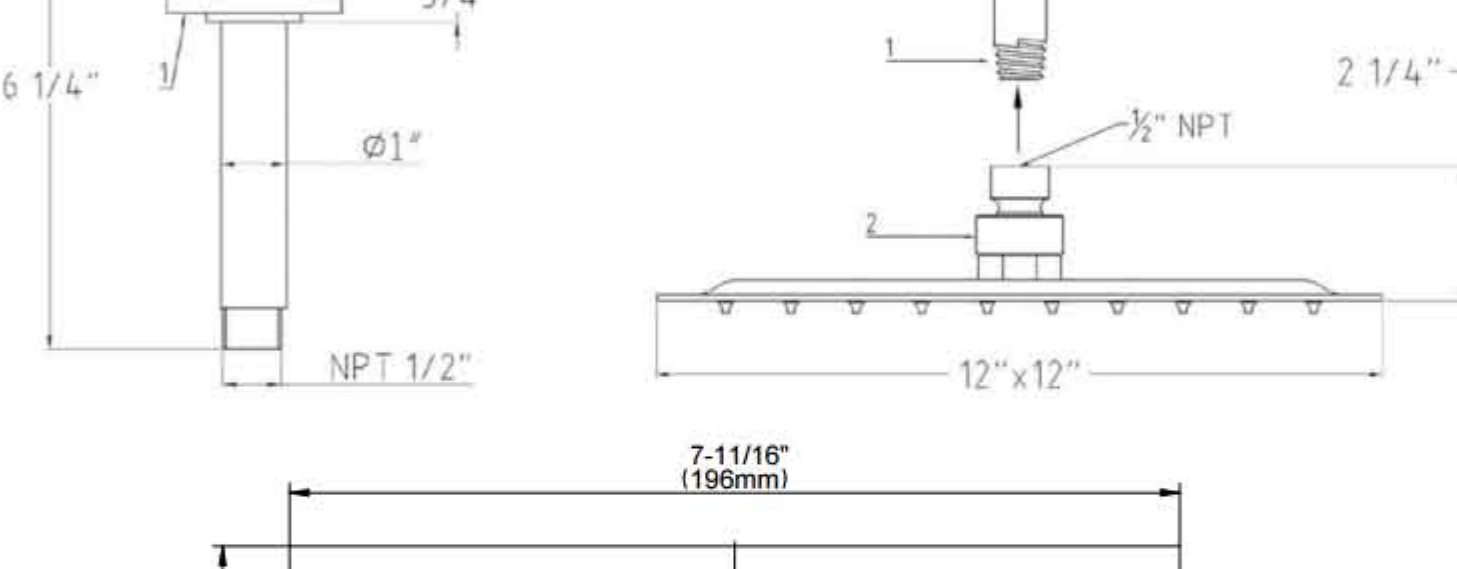
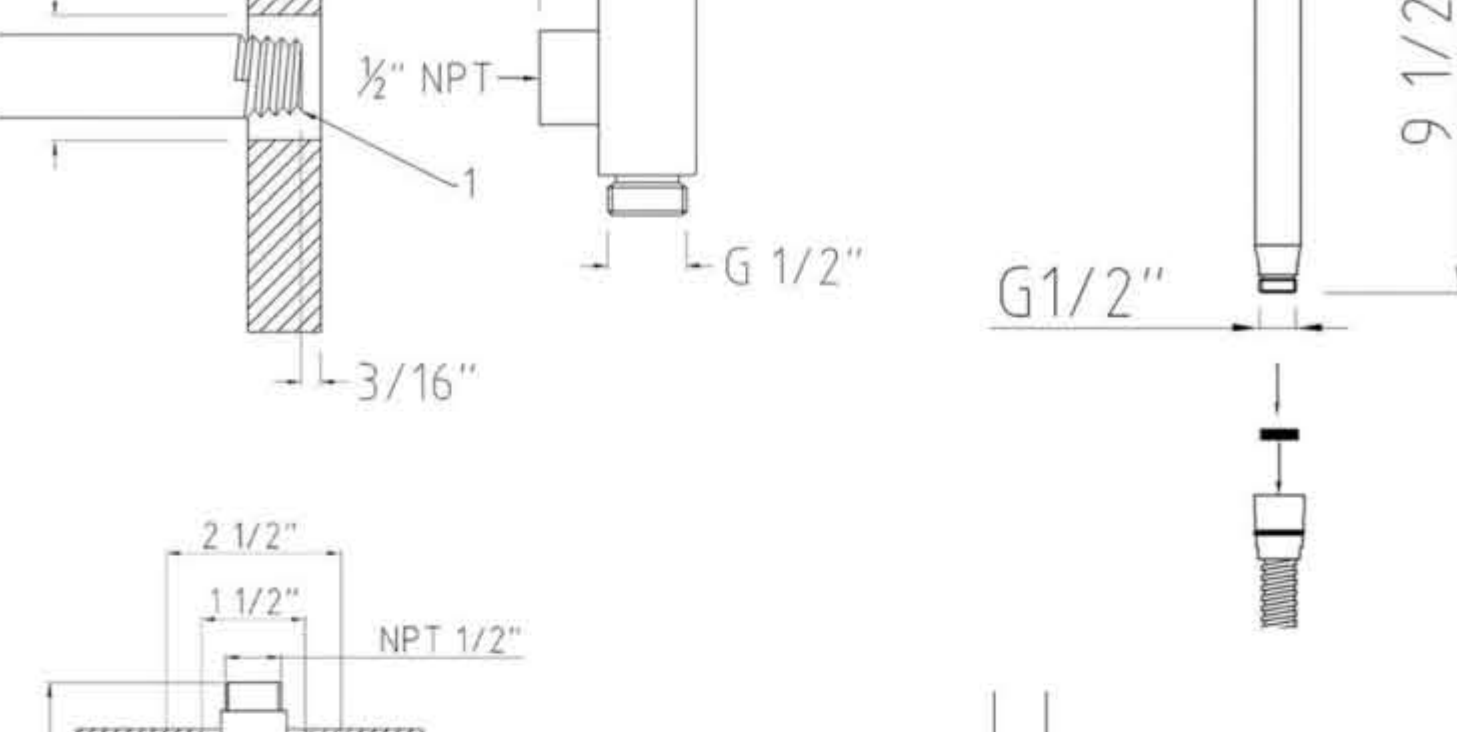
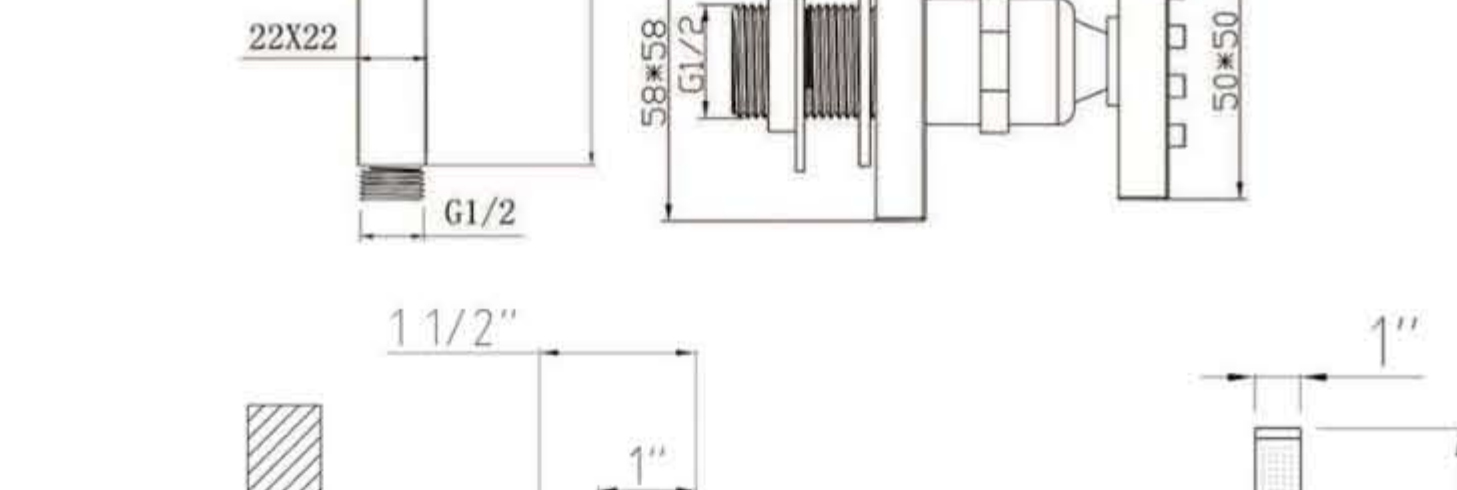
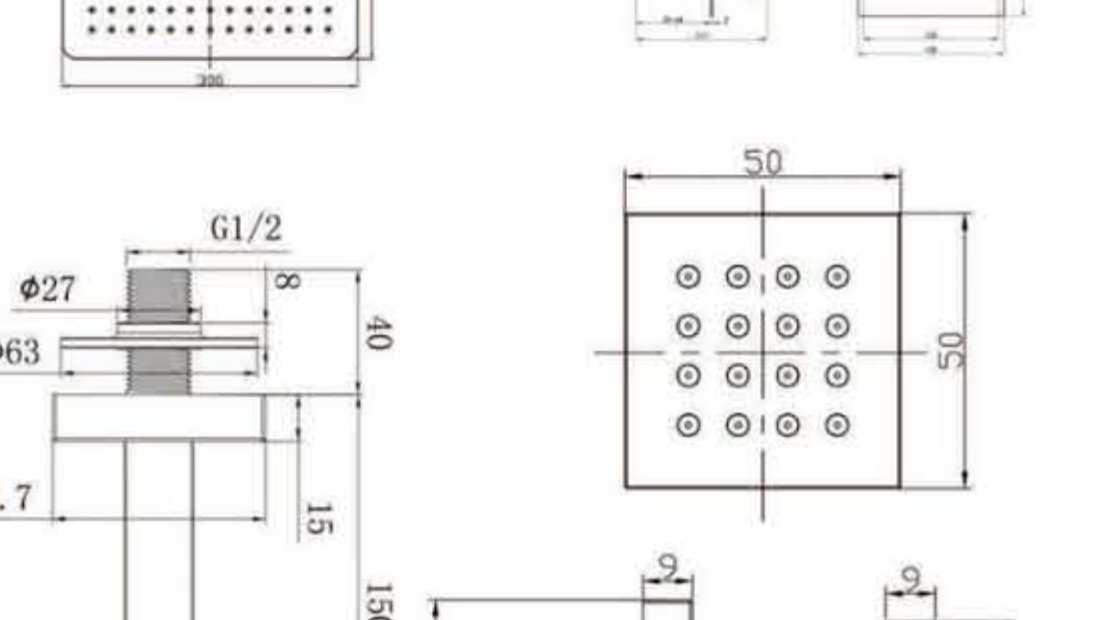

This General diagram and installation instructions are not intended for any specific model, but is presented as a general guideline for Installations!