



Liberty Furniture
INDUSTRIES, INC

LIBERTY FURNITURE

ASSEMBLY INSTRUCTION

ITEM # 505-BR23HL/23FS/23RSP

505-BR24HL/24FS/24RSP

DESCRIPTION Leather Bed

Thank you for purchasing this quality product. Be sure to check all packing materials carefully for small parts which may have come loose inside the carton during shipment. Identify and count all parts and compare with the parts List Below.

PARTS LIST

NO.	SKETCH	DESCRIPTION	Q'TY
A		Headboard	1pc
B		Footboard	1pc
C		Side Rails	2pcs
D		Slat roll (8 pcs)	Queen King
E		Slat support	Queen King
F		Cross bar	1pc

HARDWARE LIST

NO.	SKETCH	HARDWARE	Q'TY
a		5/16"x18x2-3/4"	8pcs
b			8pcs
c		5/16"	8pcs
d		5/16"x18x2-1/4"	4pcs
e		5/16"x18x1-1/2"	2pcs
f		5/16"x12 mm	6pcs
g		5/16"x19 mm	6pcs
h		12 mm	1pc
i		#8x1"	6pcs

Assembly steps:

Step 1. Assemble the Post to the Headboard (A) using Bolt (d), spring washer (f), flat washer (g) and wrench (h).

Step 2. Assemble the Cross bar to the Headboard (A) using Bolt (e), spring washer (f), flat washer (g) and wrench (h).

Step 3. Attach the Side rail (D) to the Headboard (A) using set-screw (a), washer (b), nut (c) and wrench (h).

Step 4. Attach the Slat support (F) to the Slat roll(E)

Step 5. Screw slat roll (E) in place.

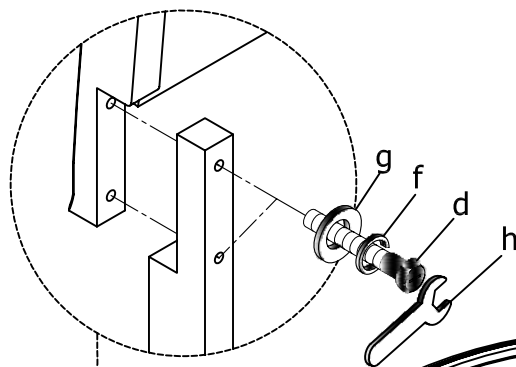

Step 1

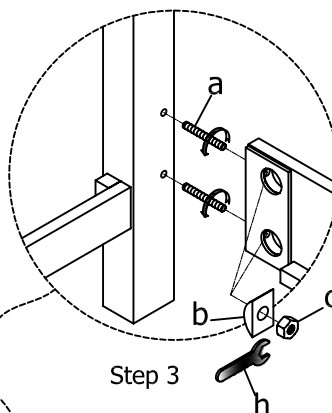

Step 3

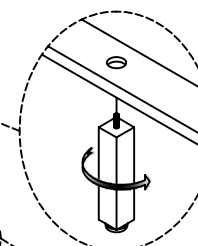

Step 4

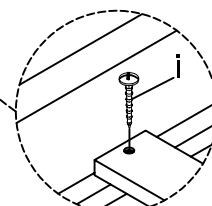

Step 5

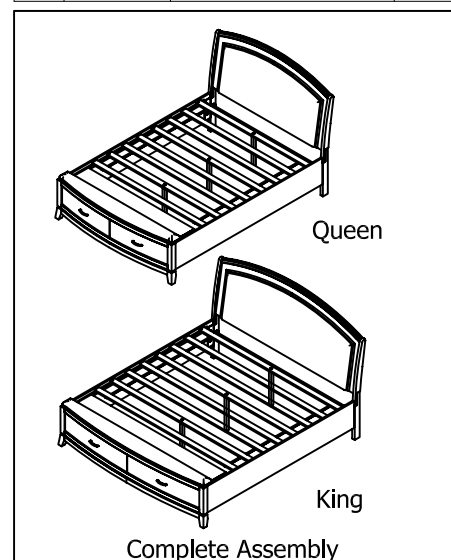

Complete Assembly

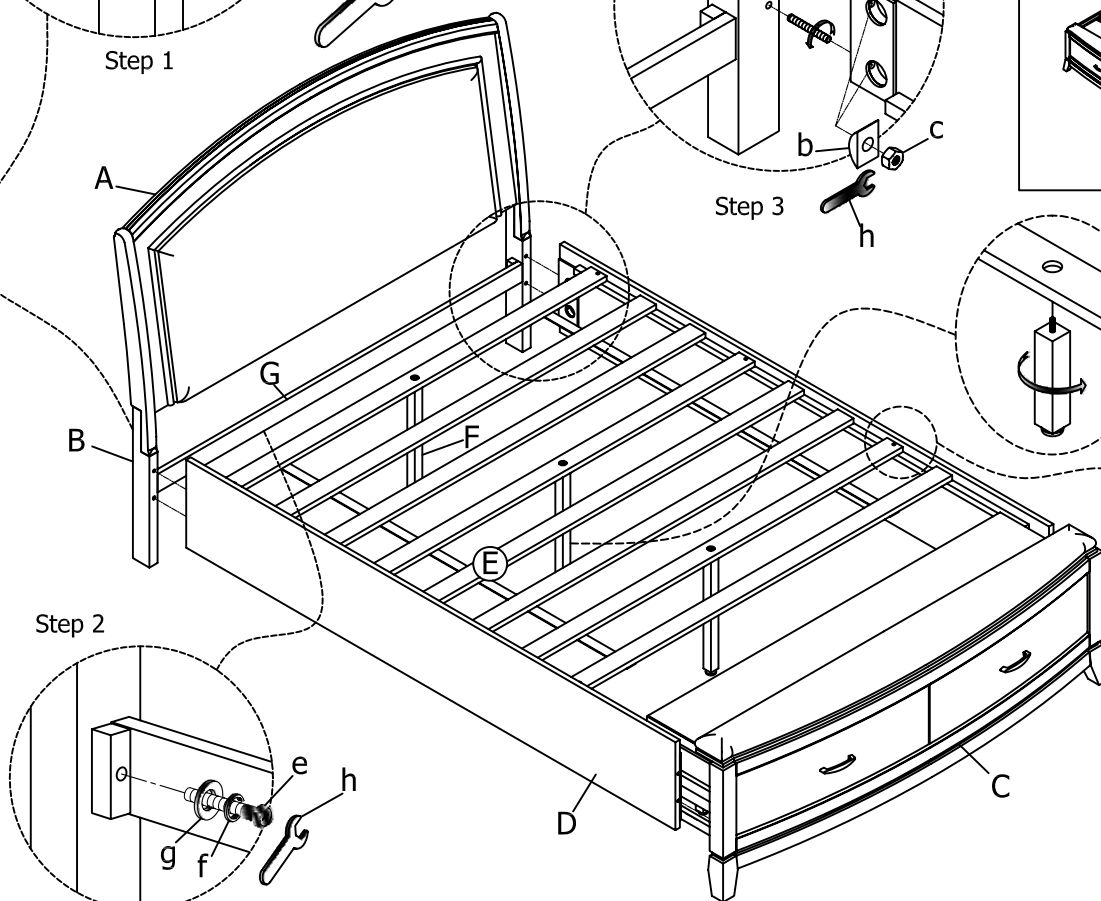

MADE IN VIETNAM