

Solid Brass Rain ShowerSet Single Handle Oil Rubbed Bronze
W/ Hand Shower Sprayer



INSTALLATION INSTRUCTIONS

Before you begin, read the installation instructions below. Observe all local building and safety codes.

Unpack and inspect for any shipping damages. If you find any damages, do not install. Contact Customer Service. If you need assistance while installing your shower system, call our Customer Service number.

We recommend consulting a professional if you are unfamiliar with installing bathroom fixtures and plumbing.

TOOLS AND MATERIALS:

- Screwdriver
- Teflon Tape
- Adjustable Wrench
- Smooth Joint Pliers
- Soft Cloth
- Silicone Sealant



Installation Instructions

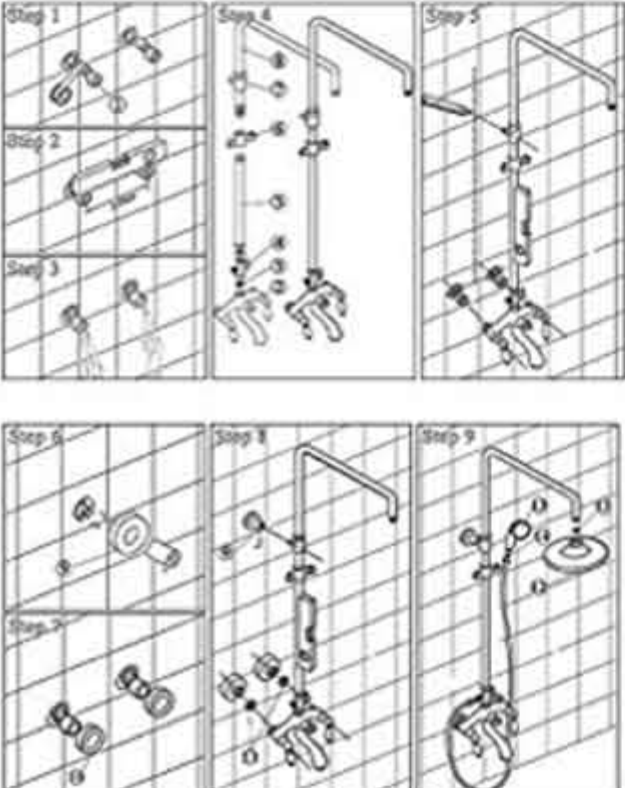

- Step 1:Connect the brass adapter provided to water supply line.
- Step 2:Adjust lever and distance to fit faucet body
- Step 3:Turn water valve on for a while to let the dust and impurities out.
- Step 4:Assemble the shower set
- Step 5:Place pre-assembled shower in the wall to find proper position and then mark the mounting hole need to be drilled
- Step 6:Drill a hole for the upper part shower bar bracket ,screw it.
- Step 7:Place the decoration cover to the brass adapters
- Step 8:Install the pre-assembled shower to the connections.
- Step 9:Connect shower hose,handheld shower and rain shower head.

- | | | | |
|-----------------|----------------------|--------------------|-------------------|
| ① Brass Adapter | ⑤ Shower bar | ⑨ Mounting base | ⑬ Handheld shower |
| ② Facet body | ⑥ Hand shower holder | ⑩ Decoration cover | ⑭ Washers |
| ③ Washers | ⑦ Shower bar bracket | ⑪ Washers | ⑮ Washers |
| ④ Diverter | ⑧ Shower bar | ⑫ Rain shower head | |



This part may be different, but the installation is the same.

This General diagram and installation instructions are not intended for any specific model, but is presented as a general guideline for Installations!