 **Warnings and Cautions**

Turn off electricity at circuit breaker or main fuse box before installation. Consult a licensed electrician if in doubt.

These instructions are provided for your safety. It is very important you read them completely before installing the fixture. We strongly recommend that a licensed, professional electrician perform the installation.

STEP 1 - Install Crossbar

STEP 3 - Fixture Mounting

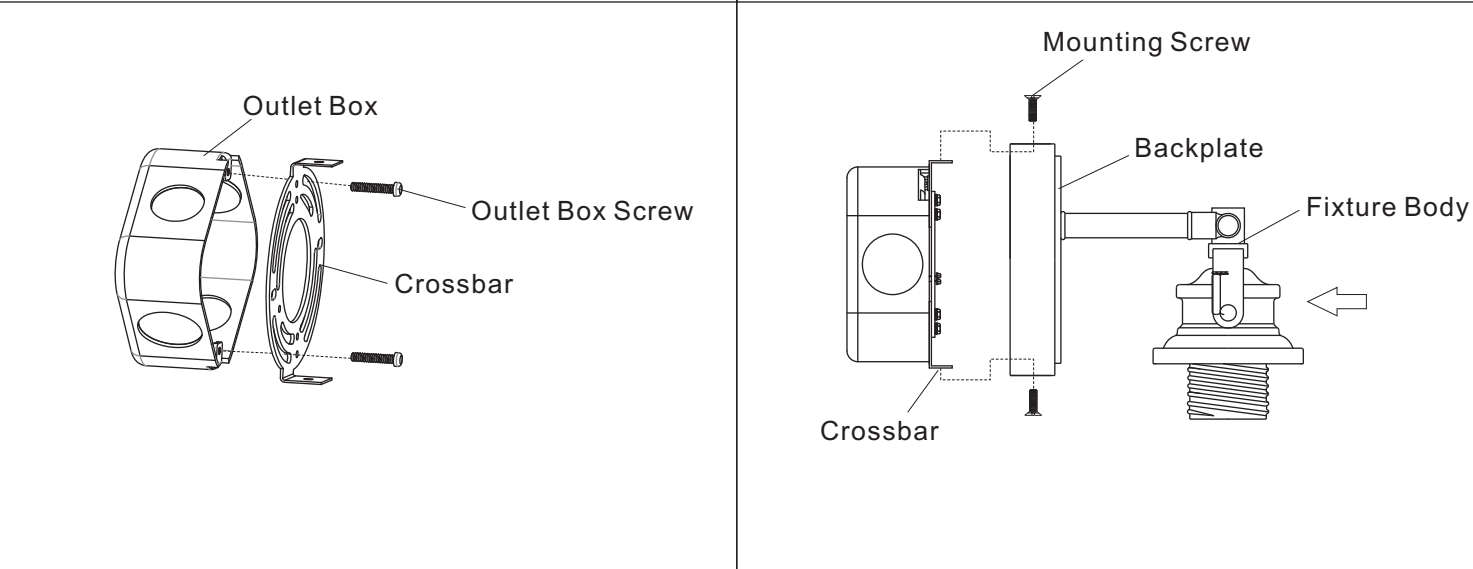

STEP 2 - Wiring

STEP 4 - Install Shades and Bulbs

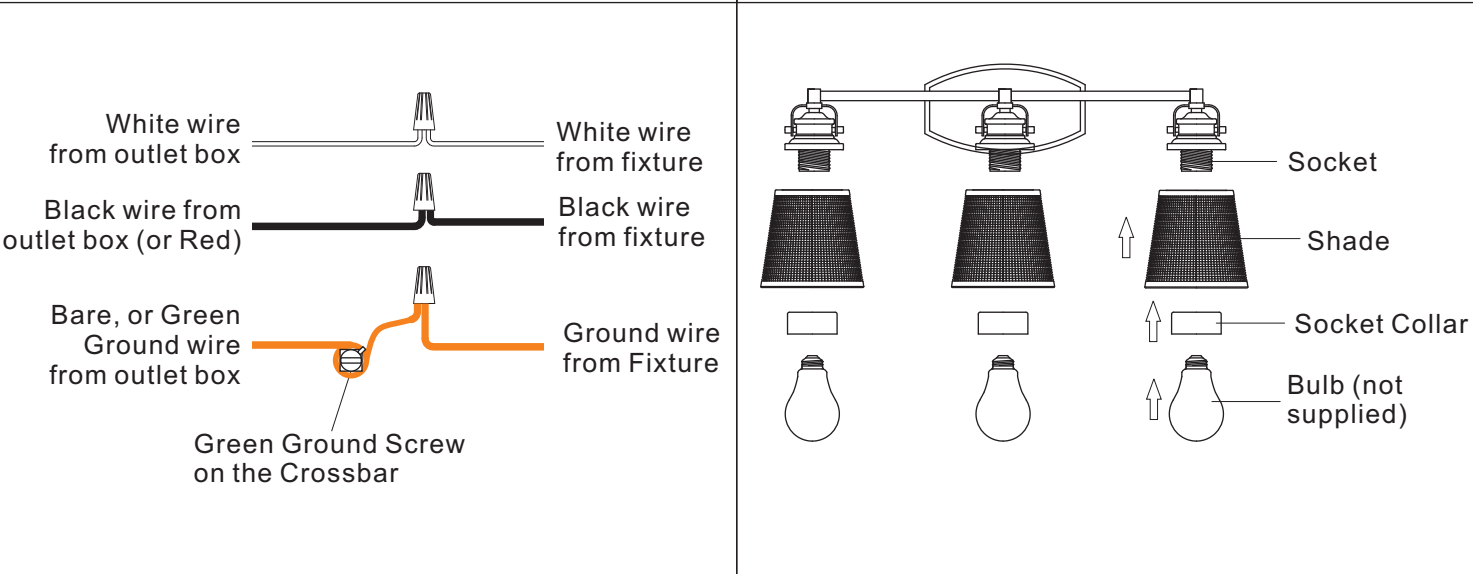

Warranty

This product is provided with a 1 year limited warranty that it will be free from defects in material and workmanship and subject to certain conditions and exclusions from the date of purchase.

Email customercare@ashleyharbour.com for warranty service.