



Accord®

48" Shower stall with seat and center drain
72280100



Features

- Alcove installation
- 3-1/2" threshold
- Solid Vikrell material
- Durable high-gloss finish
- Center drain
- Three-piece, tongue-and-groove walls with snap-together installation
- No caulk required
- Removable seat

Included Components

Product consists of:

72281100 48" Seated Shower Base

72284100 48" Complete Wall Set

72286104 Removable bath seat for Series 7228 and 7229



Codes/Standards

HUD, UM Bulletin 73



**Warranty – Bathing Fixtures (and)
Kitchen and Utility Sinks Made of Solid
Vikrell® Material**

**STERLING® Warranty - Bathing &
Showering Seats**

See website for detailed warranty information.

Available Colors/Finishes

Color tiles intended for reference only.

Color	Code	Description
	0	White
	96	KOHLER Biscuit

1-800-STERLING (1-800-783-7546)

Kohler Co. reserves the right to make revisions without notice to product specifications.

For the most current Specification Sheet, go to www.sterlingplumbing.com.

9-24-2019 05:30 - US

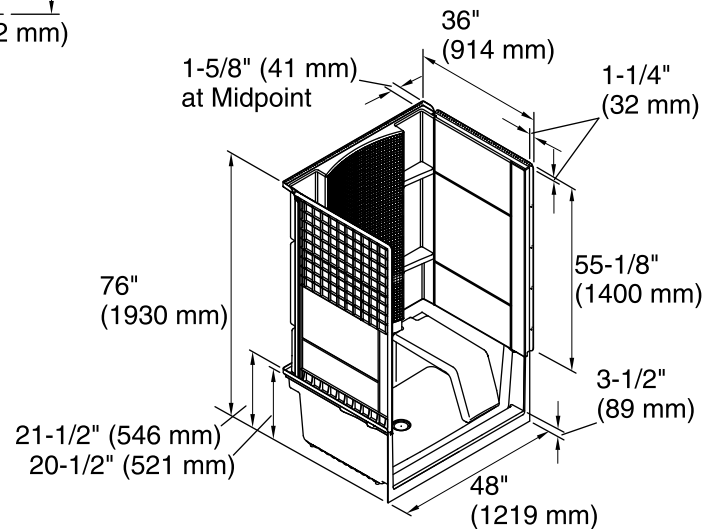
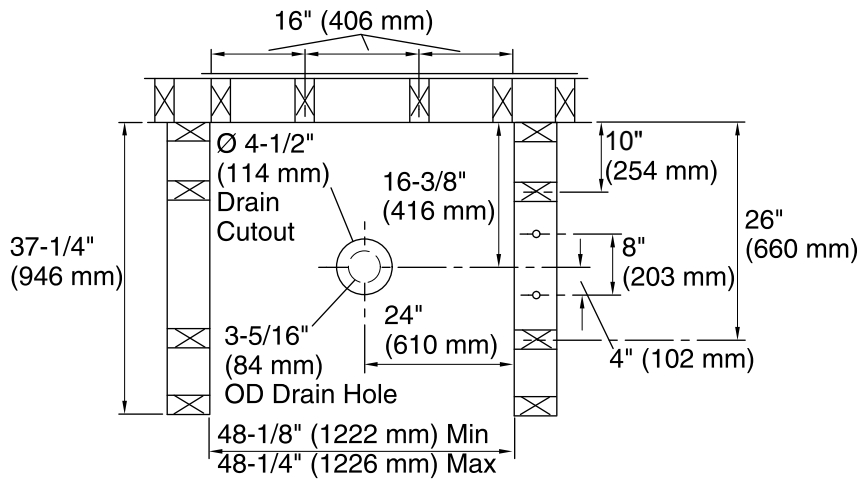

Technical Information

All product dimensions are nominal.

Installation: Three-wall alcove

Drain location: Center

Minimum flat for door: 3-1/4" (83 mm)

Threshold height: 3-1/2" (89 mm)

Maximum door height: 70-5/8" (1794 mm)

Maximum door width: 44-5/8" (1133 mm)

Notes

Install this product according to the installation instructions.

Studs should be positioned roughly as shown.

Double studding is recommended for pivot shower door installations.

Base cannot be installed without the wall surround.